

2006 Honda Insight

2000-06 ACCESSORIES & EQUIPMENT Power Mirrors - Insight

2000-06 ACCESSORIES & EQUIPMENT

Power Mirrors - Insight

COMPONENT LOCATION INDEX

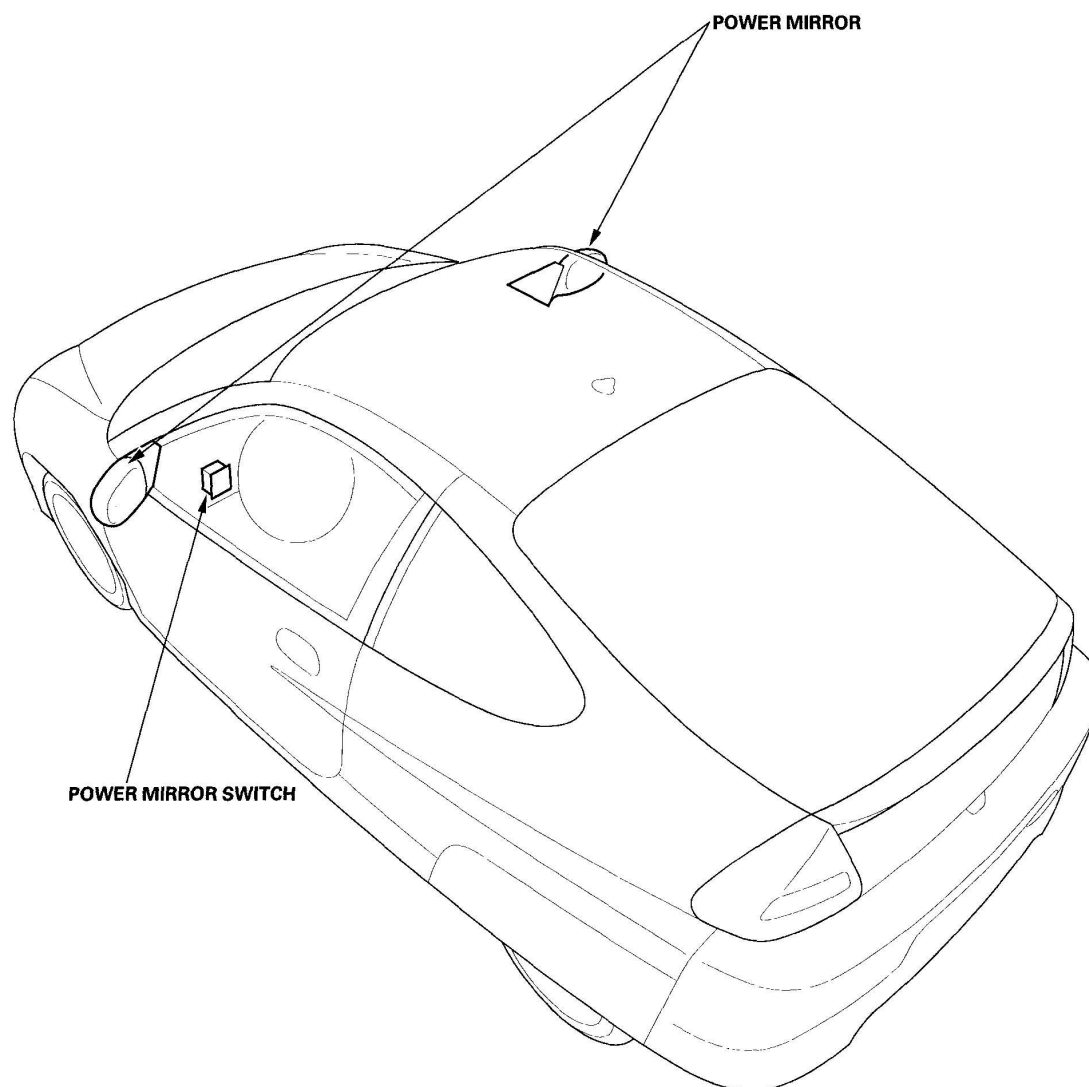

G03682979

Fig. 1: Identifying Power Mirrors Components Location
Courtesy of AMERICAN HONDA MOTOR CO., INC.

CIRCUIT DIAGRAM

2006 Honda Insight

2000-06 ACCESSORIES & EQUIPMENT Power Mirrors - Insight

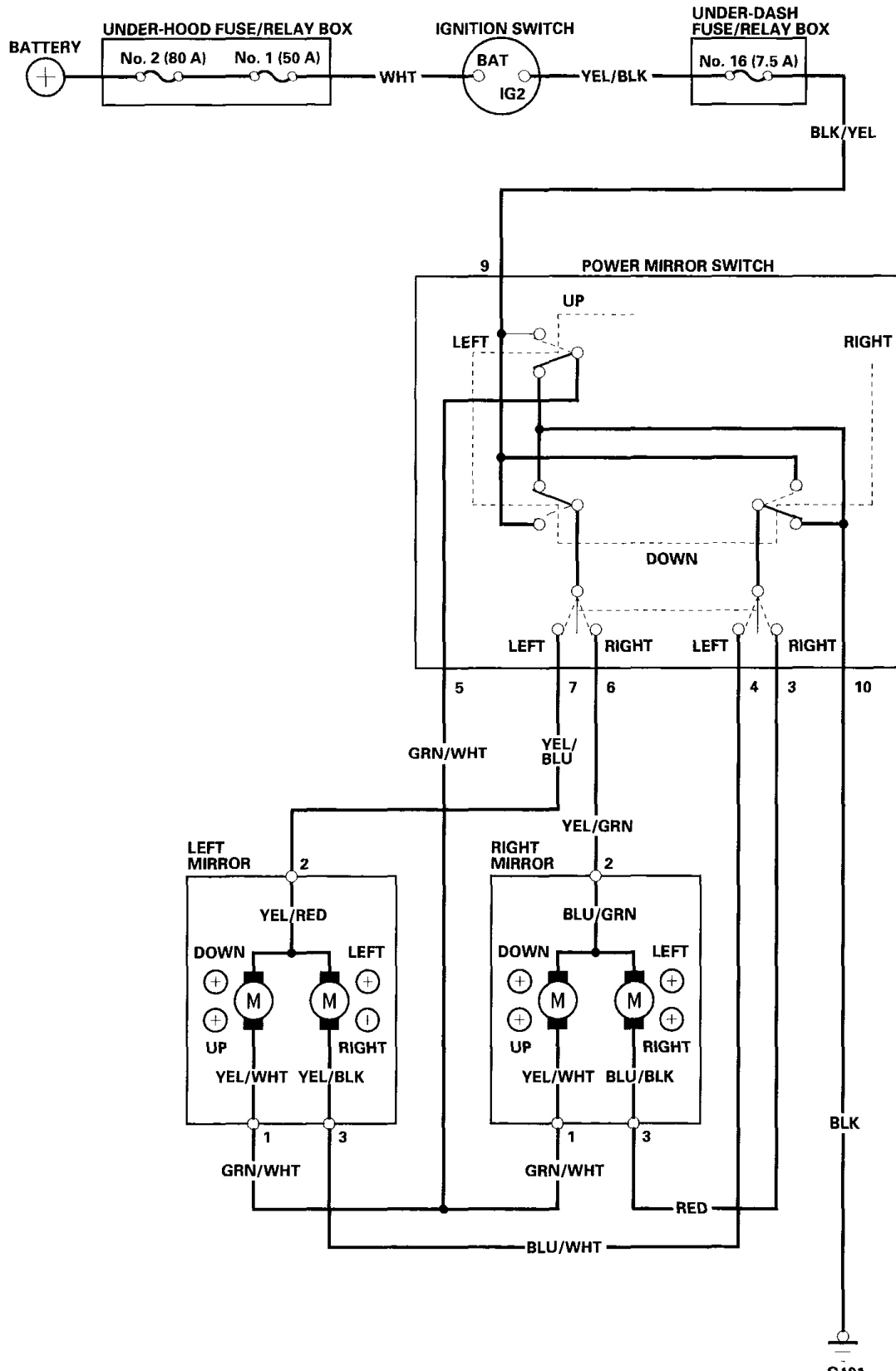
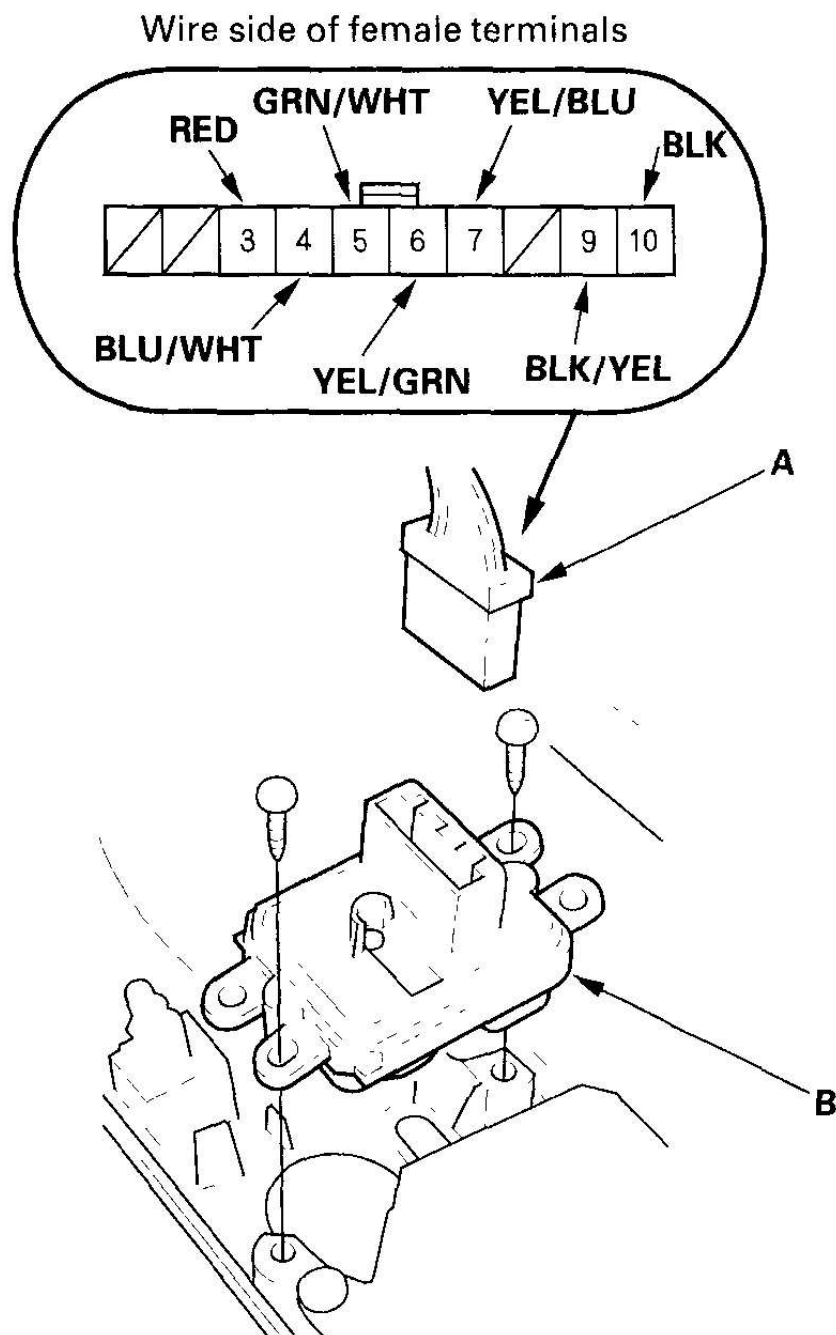

Fig. 2: Circuit Diagram - Power Mirrors

Courtesy of AMERICAN HONDA MOTOR CO., INC.

FUNCTION TEST

1. Remove the instrument panel (see **INSTRUMENT PANEL REMOVAL/INSTALLATION**).
2. Disconnect the 10P connector (A) from the power mirror switch (B).



G03682981

Fig. 3: Disconnecting 10P Connector From Power Mirror Switch
 Courtesy of AMERICAN HONDA MOTOR CO., INC.

3. Choose the appropriate test based on the symptom:

- Both mirrors don't work, go to step 4.
- Left mirror doesn't work, go to step 6 .
- Right mirror doesn't work, go to step 7 .

BOTH MIRRORS

4. Check for voltage between the No. 9 terminal and body ground with the ignition switch ON (II). There should be battery voltage.

- If there is no battery voltage, check for:
 - Blown No. 16 (7.5 A) fuse in the under-dash fuse/relay box.
 - An open in the BLK/YEL wire.
- If there is battery voltage, go to step 5.

5. Check for continuity between the No. 10 terminal and body ground.

There should be continuity.

- If there is no continuity, check for:
 - An open in the BLK wire.
 - Poor ground (G401, G402).
- If there is continuity, check both mirrors individually as described in steps 6 and 7 .

LEFT MIRROR

6. Connect the No. 9 terminal to the No. 7 terminal, and the No. 5 (or No. 4) terminal to body ground with jumper wires. The left mirror should tilt down (or swing left) with the ignition switch ON (II).

- If the mirror does not tilt down (or does not swing left), check for an open in the GRN/WHT (or BLU/ WHT) wire between the left mirror and the 10P connector. If the wire is OK, check the left mirror actuator.
- If the mirror neither tilts down nor swings left, repair the YEL/BLU wire.
- If the mirror works properly, check the mirror switch.

RIGHT MIRROR

7. Connect the No. 9 terminal to the No. 6 terminal, and the No. 5 (or No. 3) terminal to body ground with jumper wires. The right mirror should tilt down (or swing left) with the ignition switch ON (II).

- If the mirror does not tilt down (or does not swing left), check for an open in the GRN/WHT (or RED) wire between the right mirror and the 10P connector. If the wire is OK, check the right mirror actuator.
- If the mirror neither tilts down nor swings left, repair the YEL/GRN wire.
- If the mirror works properly, check the mirror switch.

POWER MIRROR SWITCH TEST/ REPLACEMENT

1. Remove the instrument panel (see **INSTRUMENT PANEL REMOVAL/INSTALLATION**).
2. Disconnect the 10P connector (A) from the power mirror switch (B).

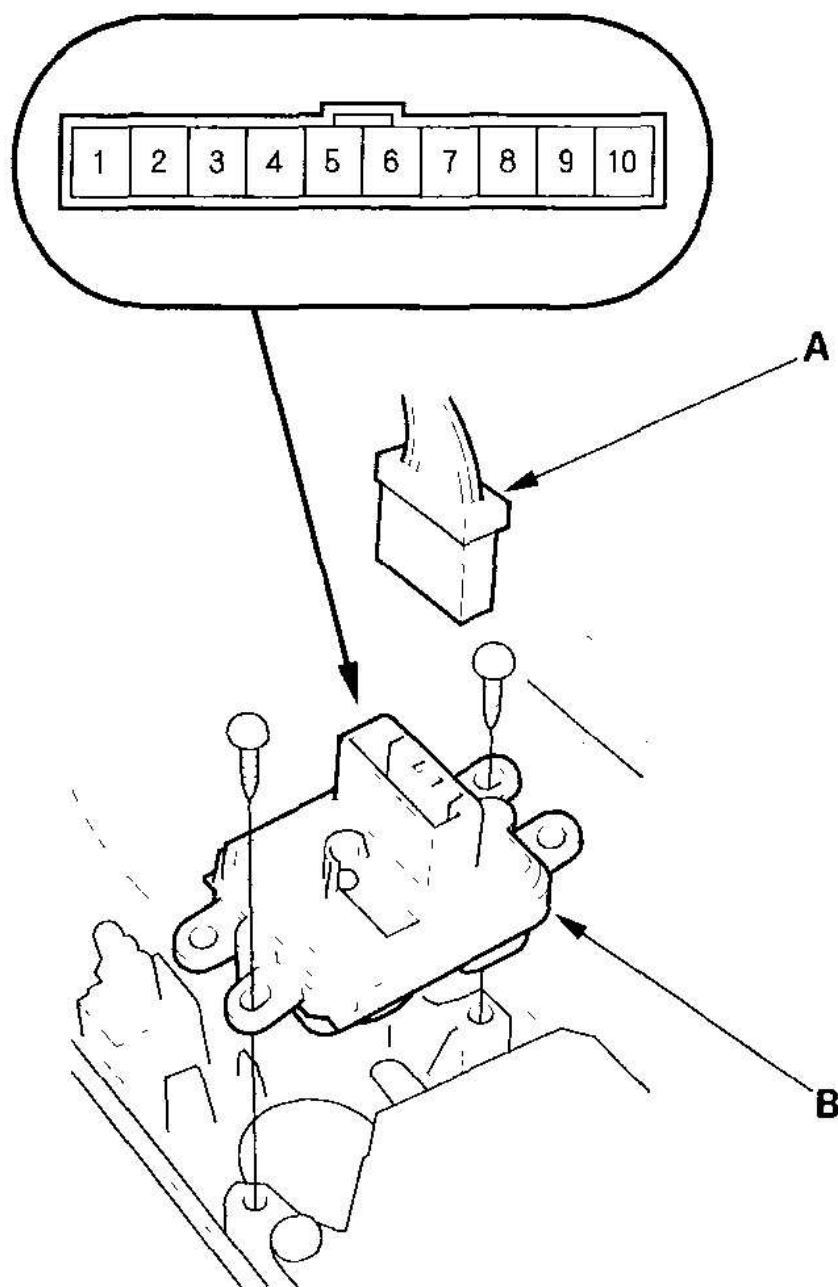

G03682982

Fig. 4: Disconnecting 10P Connector From Power Mirror Switch
Courtesy of AMERICAN HONDA MOTOR CO., INC.

- Check for continuity between the terminals in each switch position according to the table.

Terminal Position		3	4	5	6	7	9	10
R	OFF	○		○	○			○
	UP			○			○	
	DOWN	○			○		○	
	LEFT			○	○		○	
	RIGHT	○					○	
				○	○			○
L	OFF		○	○		○		○
	UP			○			○	
	DOWN		○			○	○	
	LEFT			○		○	○	
	RIGHT		○				○	
				○		○		○

G03682983

Fig. 5: Power Mirror Switch Terminals Continuity Checking Reference Table

Courtesy of AMERICAN HONDA MOTOR CO., INC.

4. If the continuity is not as specified, remove the two screws and replace the switch.

POWER MIRROR ACTUATOR TEST



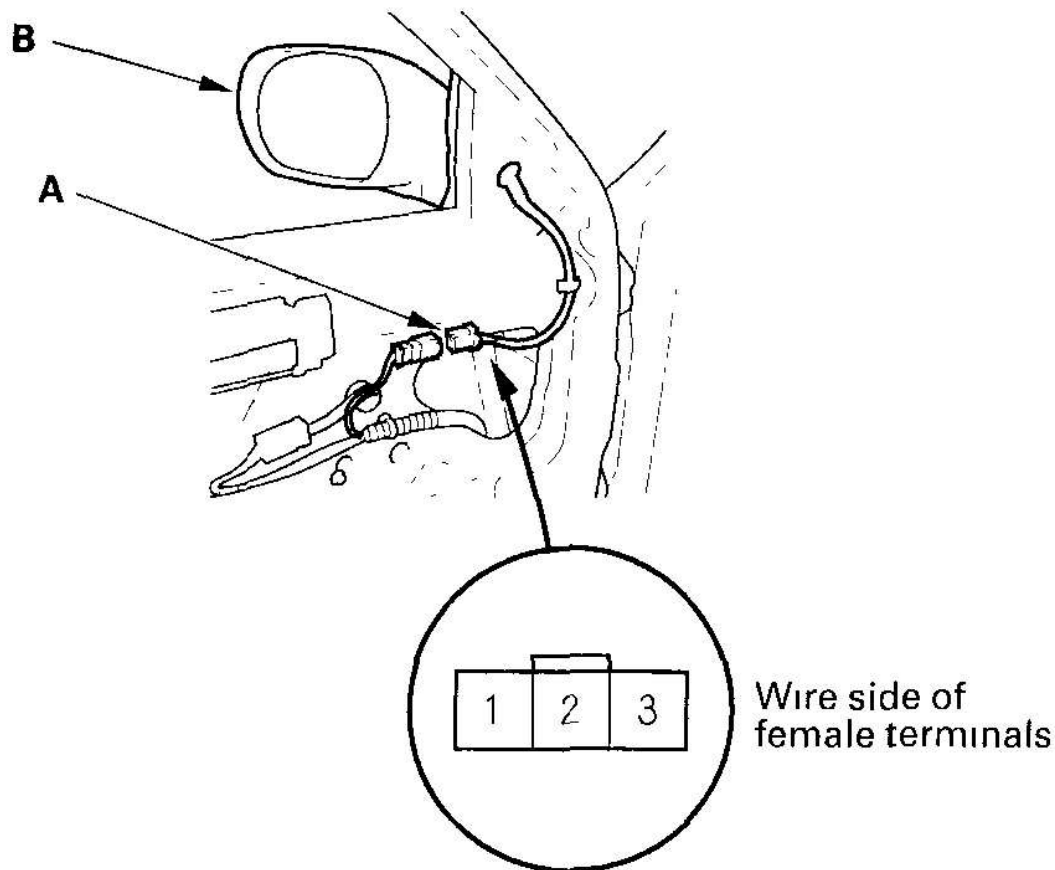



1. Remove the door panel (see **DOOR OUTER HANDLE REPLACEMENT**).
2. Disconnect the 3P connector (A) from the power mirror (B).

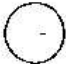

G03682984

Fig. 6: Disconnecting 3P Connector From Power Mirror
Courtesy of AMERICAN HONDA MOTOR CO., INC.

3. Check actuator operation by connecting battery power and ground according to the table.

Terminal Position	1	2	3
TILT UP			
TILT DOWN			
SWING LEFT			
SWING RIGHT			

G03682985

Fig. 7: Actuator Operation Checking Reference Table
Courtesy of AMERICAN HONDA MOTOR CO., INC.

4. If the actuator does not operate as specified, replace it.

POWER MIRROR ACTUATOR REPLACEMENT

1. Remove the power mirror (see **POWER MIRROR REPLACEMENT**), and disconnect the connector.
2. Cut the wire harness with wire cutters.

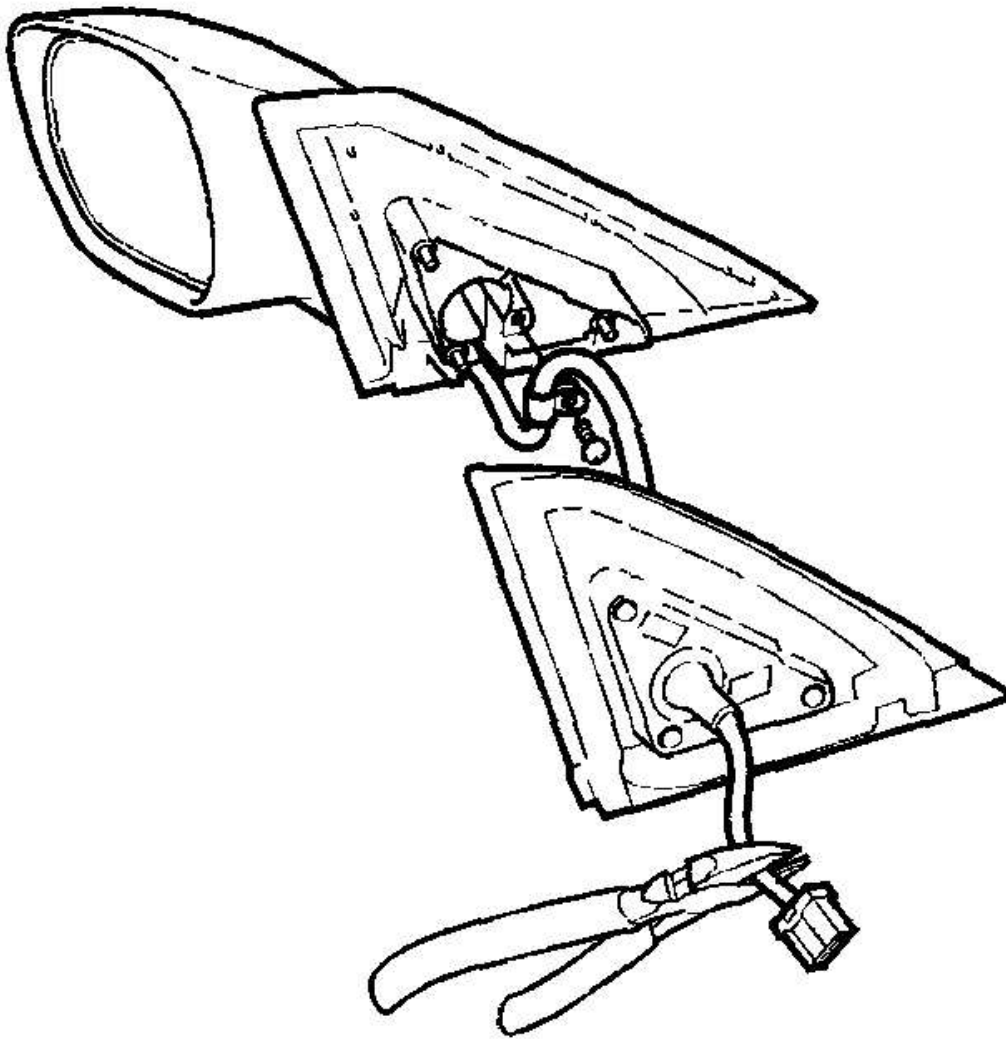

G03682986

Fig. 8: Cutting Wire Harness Using Wire Cutters
Courtesy of AMERICAN HONDA MOTOR CO., INC.

3. Record the terminal locations and wire colors.
4. Remove the three screws, and separate the mirror housing (A) from the bracket (B).

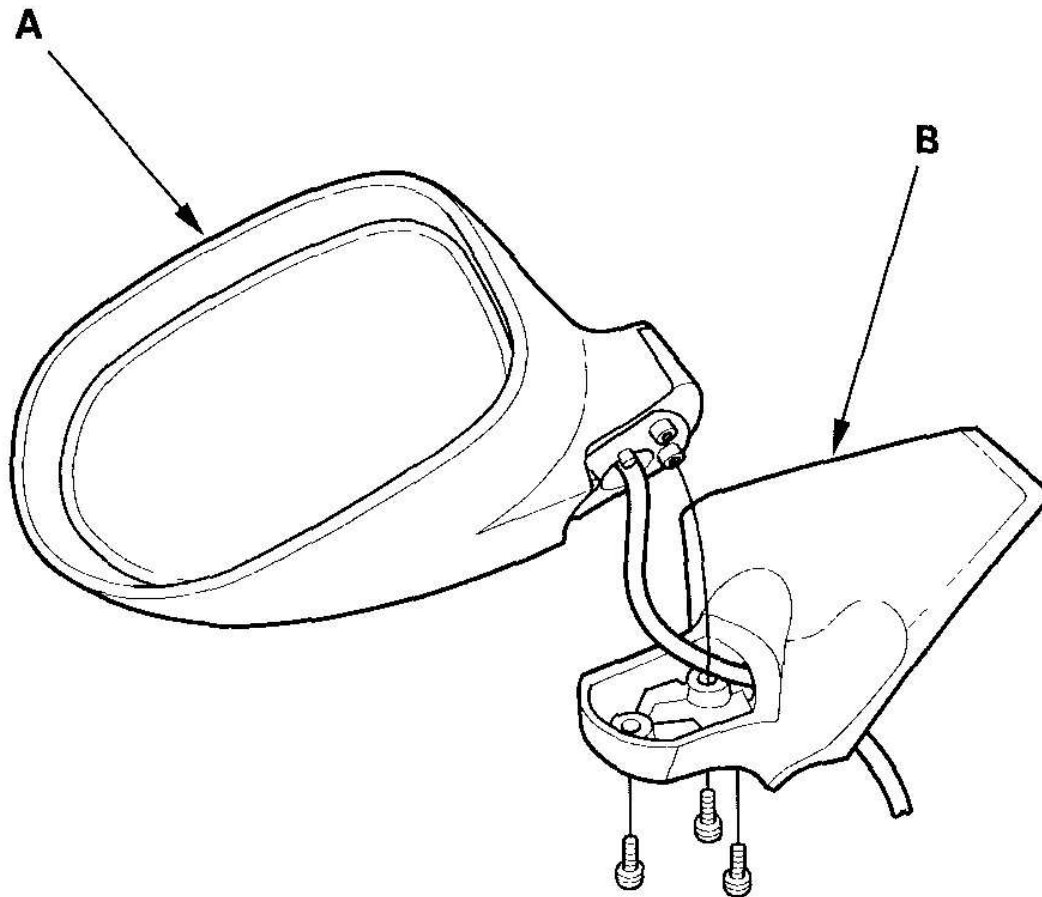

G03682987

Fig. 9: Separating Mirror Housing From Bracket
Courtesy of AMERICAN HONDA MOTOR CO., INC.

5. Carefully remove the mirror holder (A) from the mirror housing (B). Gently pull it out by hand.

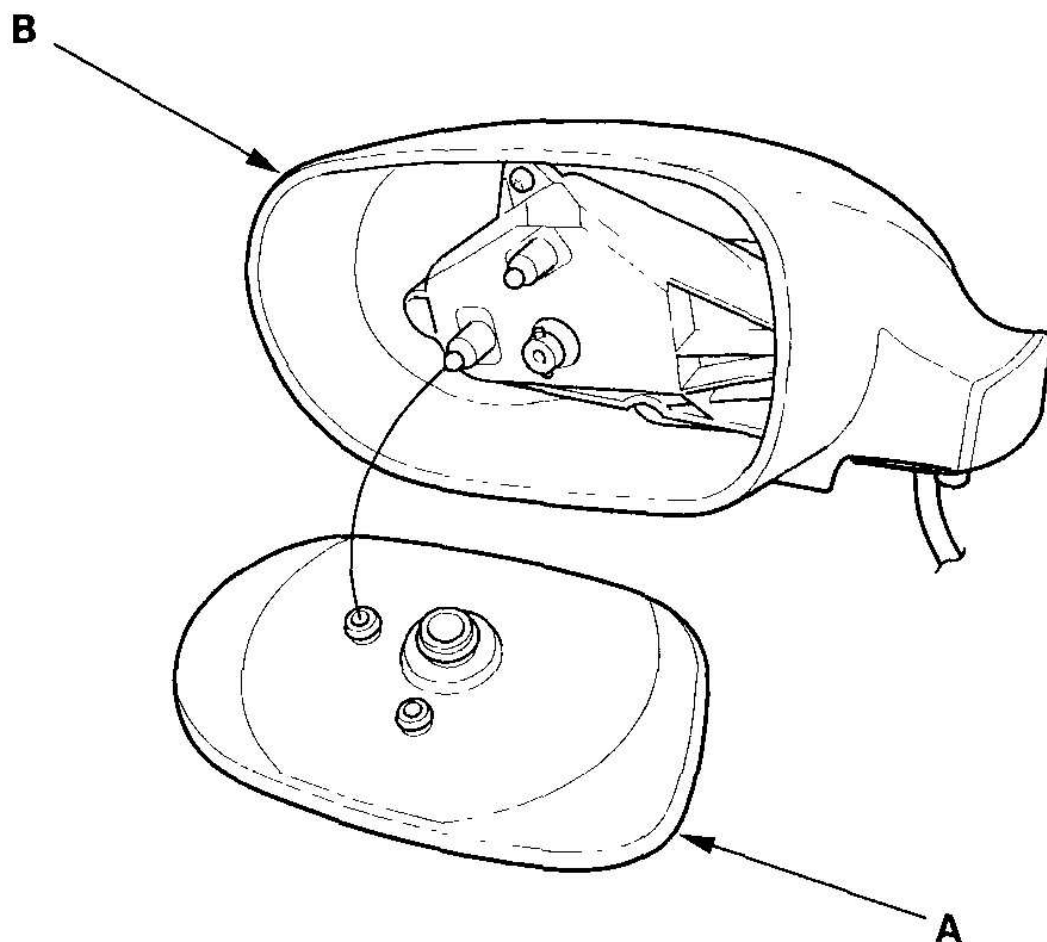

G03682988

Fig. 10: Removing Mirror Holder From Mirror Housing
Courtesy of AMERICAN HONDA MOTOR CO., INC.

6. Remove the three screws and the actuator (A).

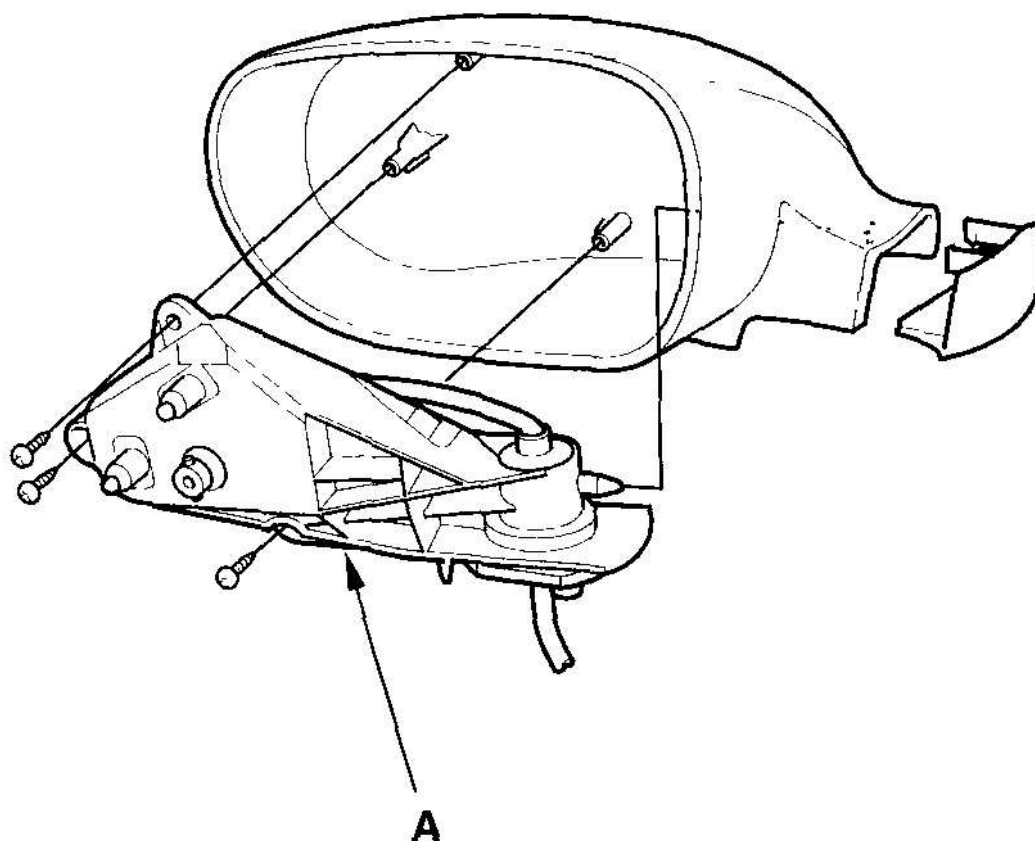

G03682989

Fig. 11: Removing Actuator

Courtesy of AMERICAN HONDA MOTOR CO., INC.

7. Route the wire harness (A) of the new actuator through the hole in the bracket (B).

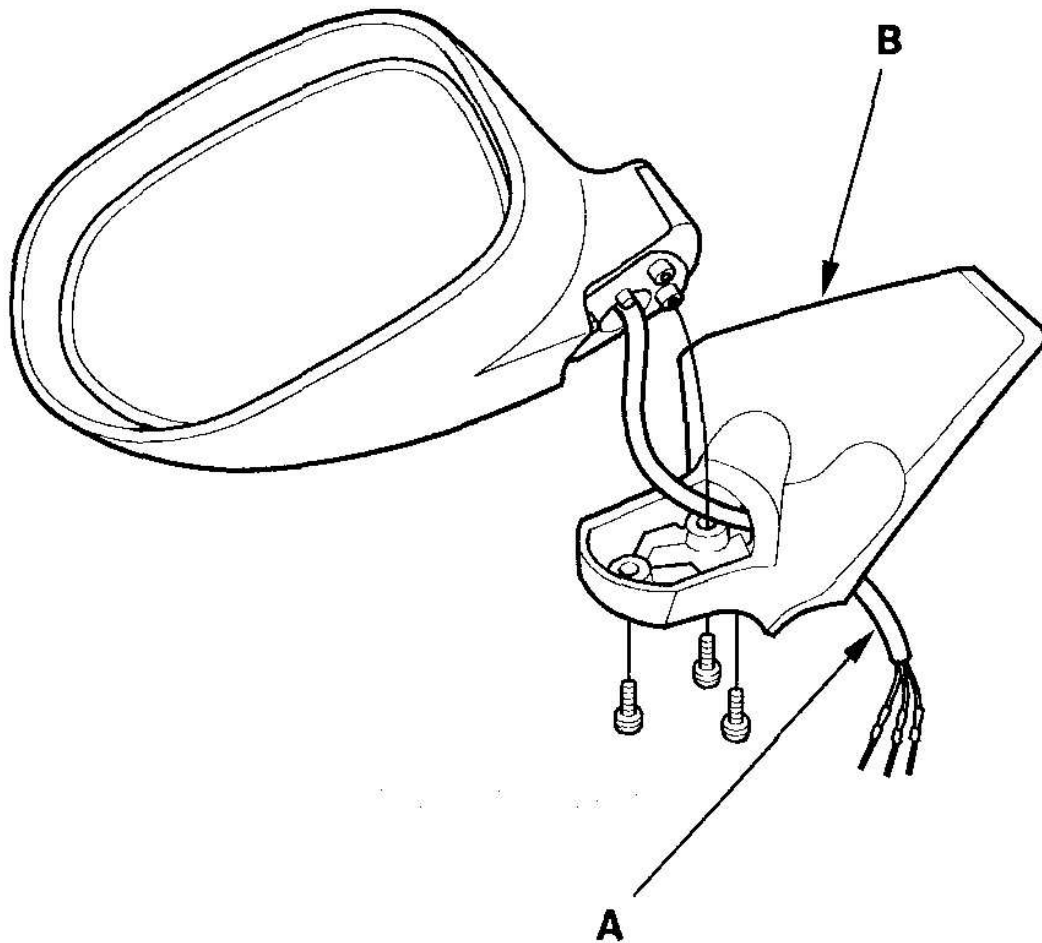

G03682990

Fig. 12: Routing Wire Harness Of New Actuator Through Hole In Bracket
Courtesy of AMERICAN HONDA MOTOR CO., INC.

8. Install in the reverse of removal. Replace the three screws with new ones.
9. Insert the new actuator terminals into the connector in the original arrangement as shown.

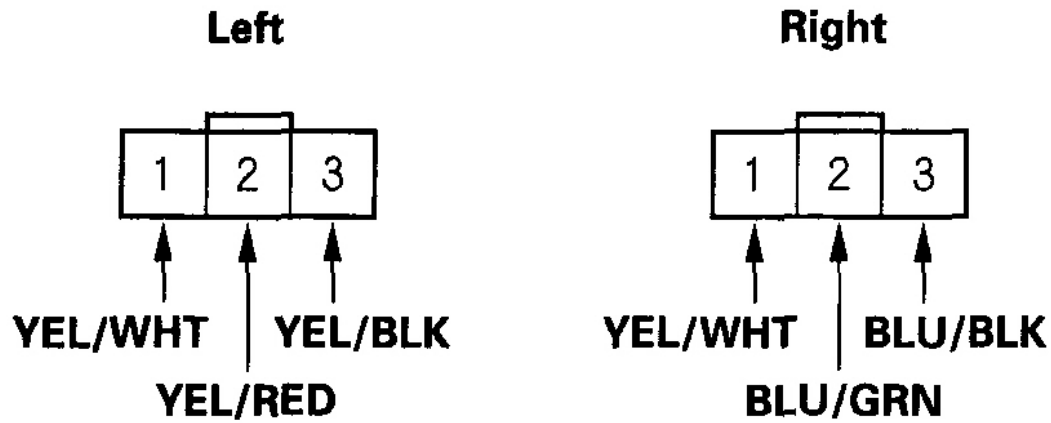

Wire side of female terminal

G03682991

Fig. 13: Identifying New Actuator Connector Terminals Original Arrangement

Courtesy of AMERICAN HONDA MOTOR CO., INC.

10. Operate the power mirror to check that the actuator works smoothly.