

2000-06 ACCESSORIES & EQUIPMENT

Doors - Insight

COMPONENT LOCATION INDEX

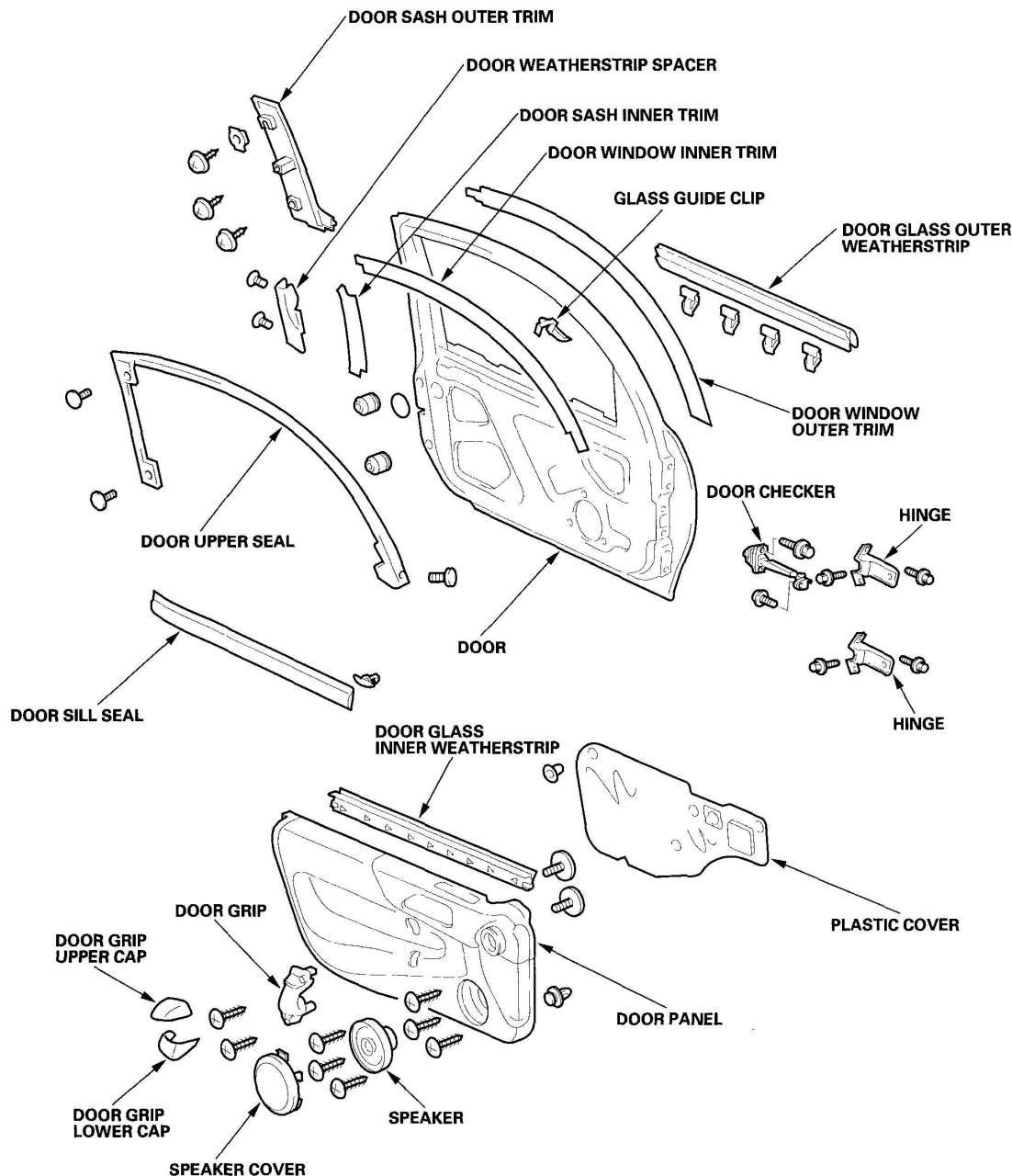

G03682527

**Fig. 1: Identifying Doors Components Location (1 Of 2)**  
**Courtesy of AMERICAN HONDA MOTOR CO., INC.**

## 2006 Honda Insight

2000-06 ACCESSORIES & EQUIPMENT Doors - Insight

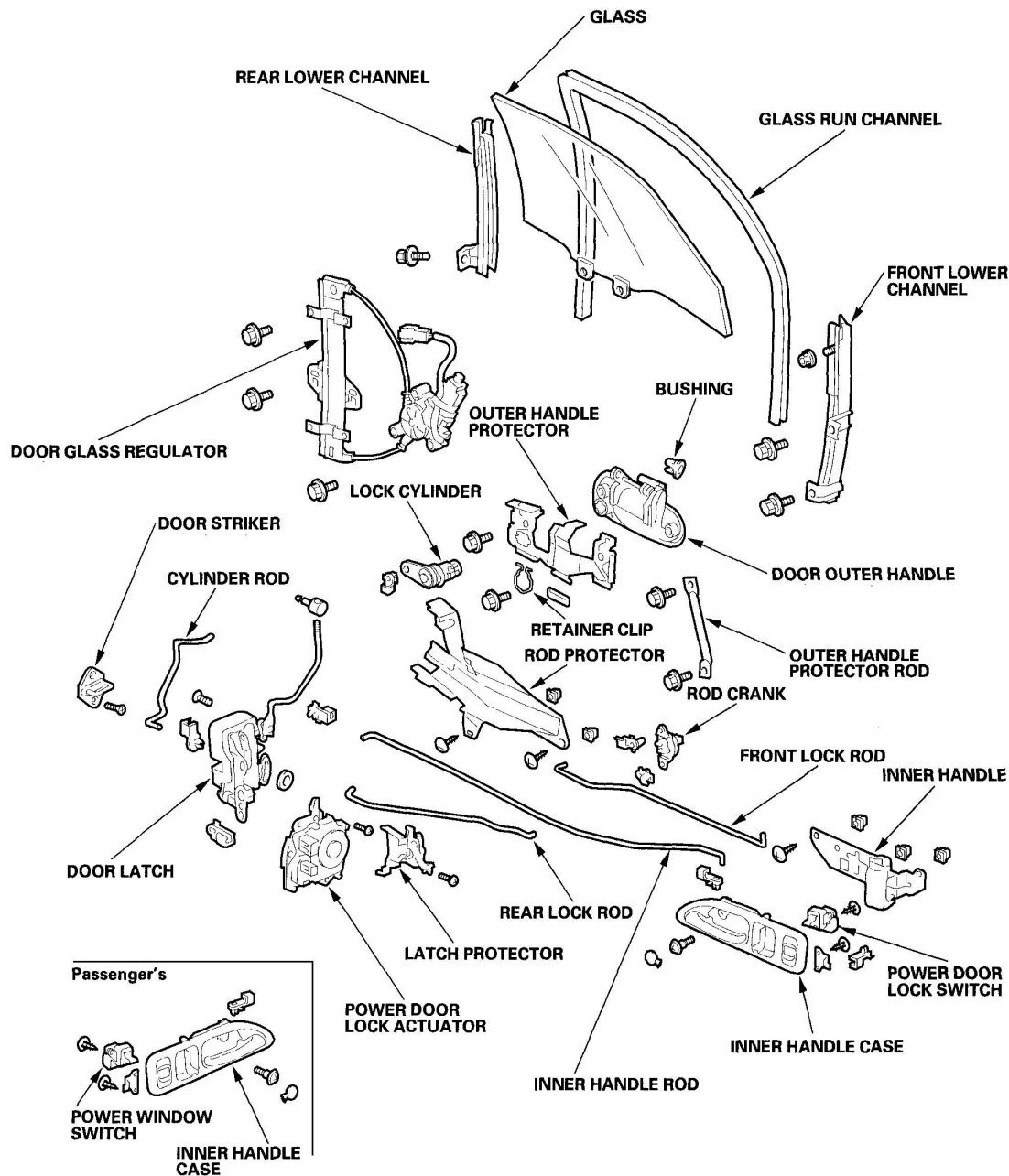

G03682528

**Fig. 2: Identifying Doors Components Location (2 Of 2)**  
Courtesy of AMERICAN HONDA MOTOR CO., INC.

### DOOR PANEL REMOVAL/INSTALLATION

**Special Tools Required**

- KTC trim tool set SOJATP2014 \*
- Trim pad remover Snap-on A 177A or equivalent, commercially available

\* Available through the American Honda Tool and Equipment Program; call 888-424-6857

**NOTE:**

- **Take care not to scratch the door panel and door.**
- **Use the appropriate tool from the KTC trim tool set to avoid damage when prying components.**

1. Remove the mirror mount cover (see **POWER MIRROR REPLACEMENT** ).
2. Remove the door panel in the numbered sequence. Remove the door panel with as little bending as possible to avoid creasing or breaking it.
3. Install the panel in the reverse order of removal, and note these items:
  - Check for damaged or stress-whitened clips, and replace them with new ones.
  - Make sure the connectors are plugged in properly.
  - Check the window and power door lock operations.

## 2006 Honda Insight

2000-06 ACCESSORIES & EQUIPMENT Doors - Insight

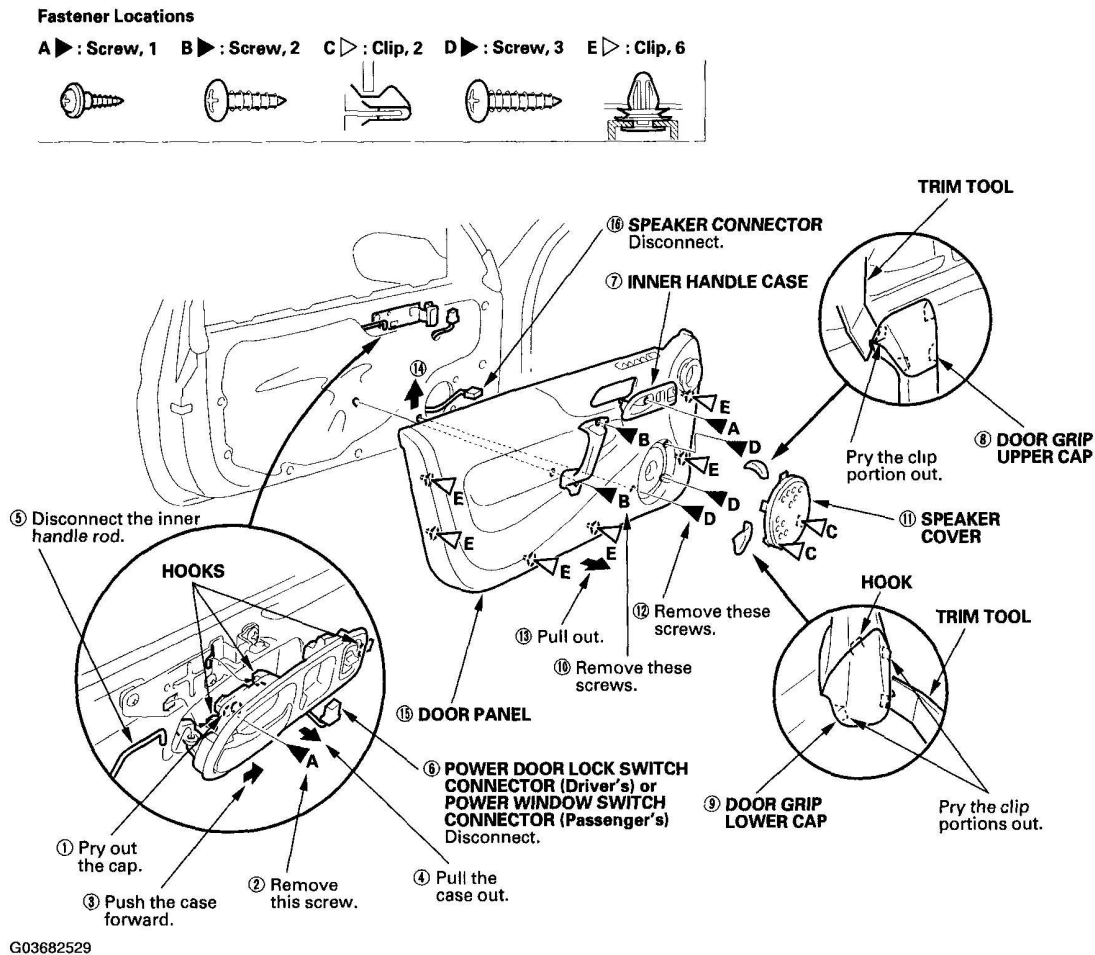

**Fig. 3: Identifying Removal Sequence Of Door Panel**  
Courtesy of AMERICAN HONDA MOTOR CO., INC.

### DOOR OUTER HANDLE REPLACEMENT

#### NOTE:

- Put on gloves to protect your hands.
- Take care not to scratch the door.
- Take care not to bend each rod.

1. Raise the glass fully, and remove these items:
  - Door panel (see **DOOR PANEL REMOVAL/INSTALLATION**)
  - Plastic cover, as necessary (see **COMPONENT LOCATION INDEX**)
2. Remove the door outer handle in the numbered sequence.

3. Install the handle in the reverse order of removal, and note these items:

- When installing the lock cylinder, leave the outer handle bolts loose so the outer handle protector does not interfere with the lock cylinder installation, then tighten the handle bolts.
- Install the retainer clip on the outer handle, then install the lock cylinder. Be sure the retainer clip is fully seated in the slot on the lock cylinder.
- Make sure the door locks and opens properly.
- When reinstalling the door panel, make sure the plastic cover is installed properly and sealed around its perimeter.

Fastener Locations

A ► : Screw, 2 B ► : Screw\*, 3 C ► : Bolt\*, 1

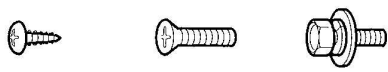

\*: CORROSION-RESISTANT HARDWARE

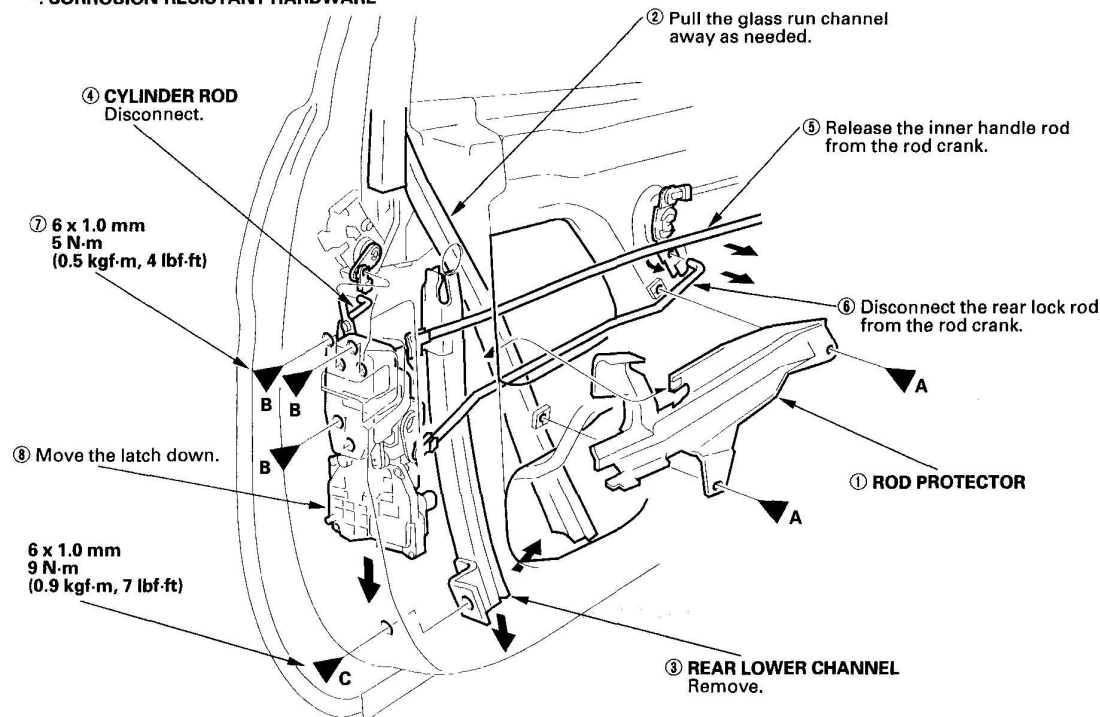

G03682530

**Fig. 4: Identifying Removal Sequence Of Door Outer Handle (1 Of 2)**  
 Courtesy of AMERICAN HONDA MOTOR CO., INC.

Fastener Locations

D ▶: Bolt\*, 4

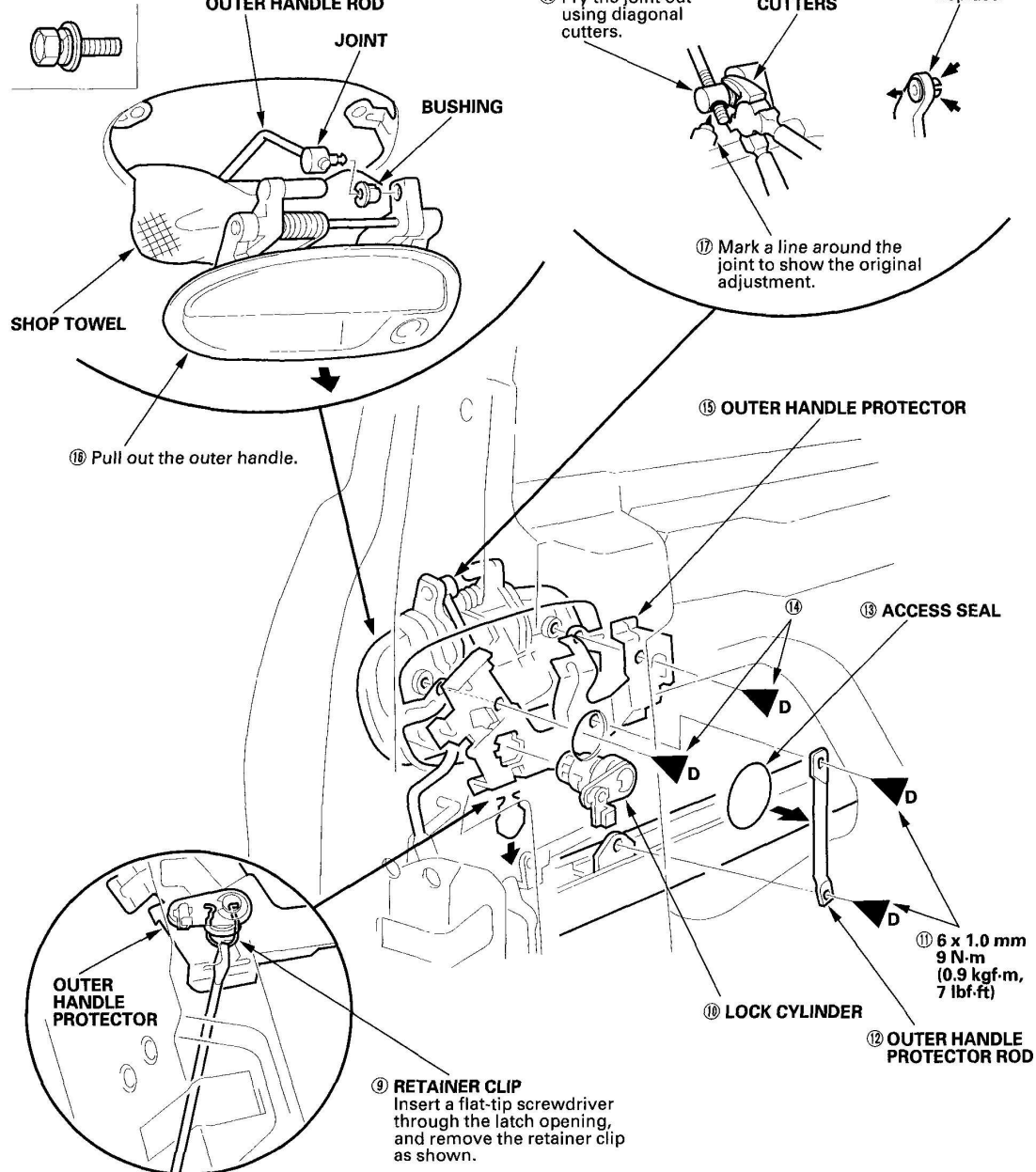

\*: CORROSION-RESISTANT BOLT

G03682531

**Fig. 5: Identifying Removal Sequence Of Door Outer Handle (2 Of 2)**  
Courtesy of AMERICAN HONDA MOTOR CO., INC.

**DOOR LATCH REPLACEMENT**



**NOTE:**

- Put on gloves to protect your hands.
- Take care not to scratch the door.
- Take care not to bend each rod.

1. Remove the outer handle (see **DOOR OUTER HANDLE REPLACEMENT** ).
2. Remove the door latch in the numbered sequence.
3. Install the latch in the reverse order of removal, and note these items:
  - Make sure the actuator connectors are plugged in properly, and each rod is connected securely.
  - Make sure the door locks and opens properly.
  - When reinstalling the door panel, make sure the plastic cover is installed properly and sealed around its perimeter.

**Fastener Locations**

A ►: Screw, 3

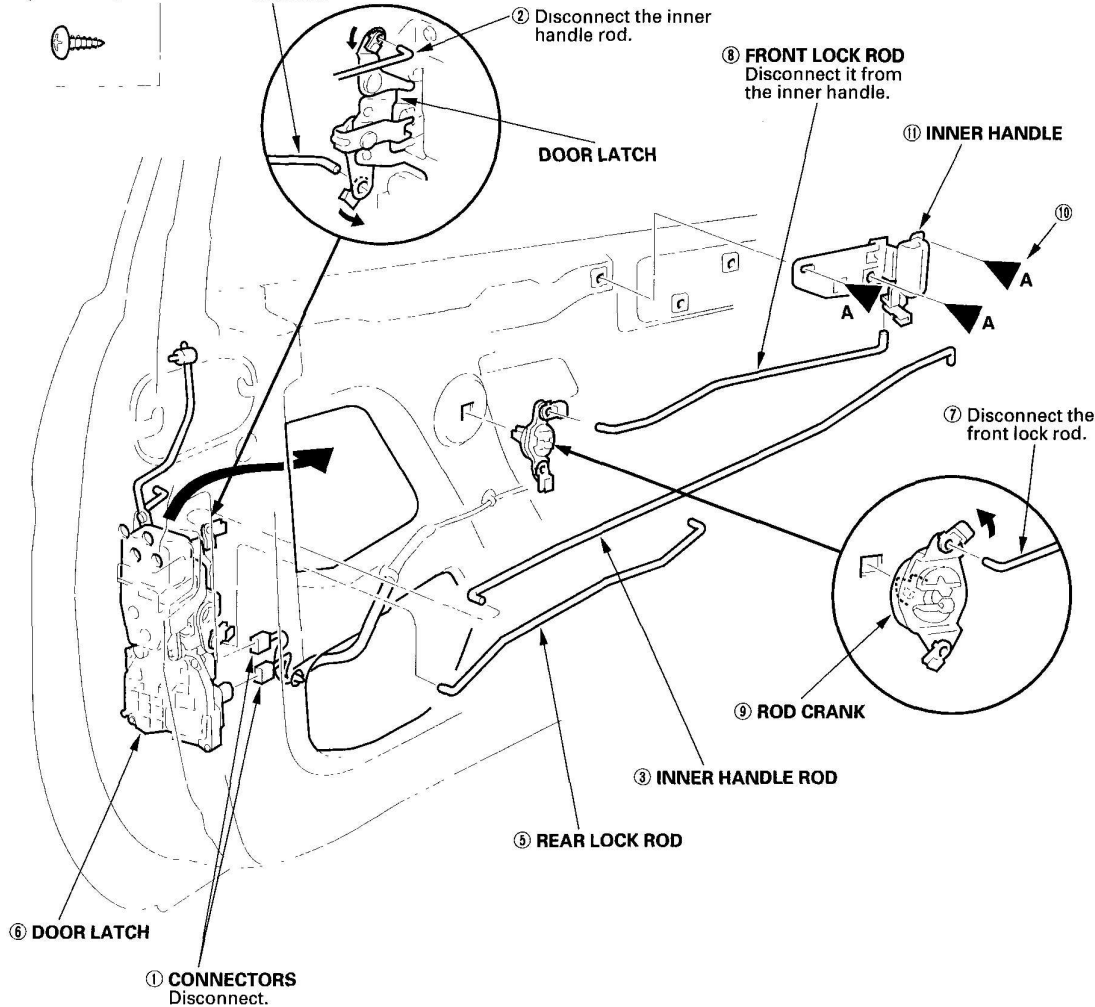

G03682532

**Fig. 6: Identifying Removal Sequence Of Door Latch**  
Courtesy of AMERICAN HONDA MOTOR CO., INC.

## DOOR GLASS AND REGULATOR REPLACEMENT

**NOTE:**

- Put on gloves to protect your hands.
- Take care not to scratch the door.
- Take care not to drop the window glass inside the door.

1. Remove these items:



- Door panel (see **DOOR PANEL REMOVAL/INSTALLATION** )
  - Plastic cover (see **COMPONENT LOCATION INDEX** )
2. Remove the door glass and regulator in the numbered sequence.
  3. Install the door glass and regulator in the reverse order of removal, and note these items:
    - Before installing the regulator, apply multipurpose grease to all the sliding surfaces of the regulator.
    - Make sure the connector is plugged in properly.
    - Roll the glass up and down to see if it moves freely without binding.
    - Make sure that there is no clearance between the glass and glass run channel when the glass is closed.
    - Adjust the position of the glass as necessary (see **DOOR GLASS ADJUSTMENT** ).
    - Check for water leaks (see step 7 ).
    - Test-drive and check for wind noise and rattles.
    - When reinstalling the door panel, make sure the plastic cover is installed properly and sealed around its perimeter.

## 2006 Honda Insight

### 2000-06 ACCESSORIES & EQUIPMENT Doors - Insight

#### Fastener Locations

A ► : Bolt, 2

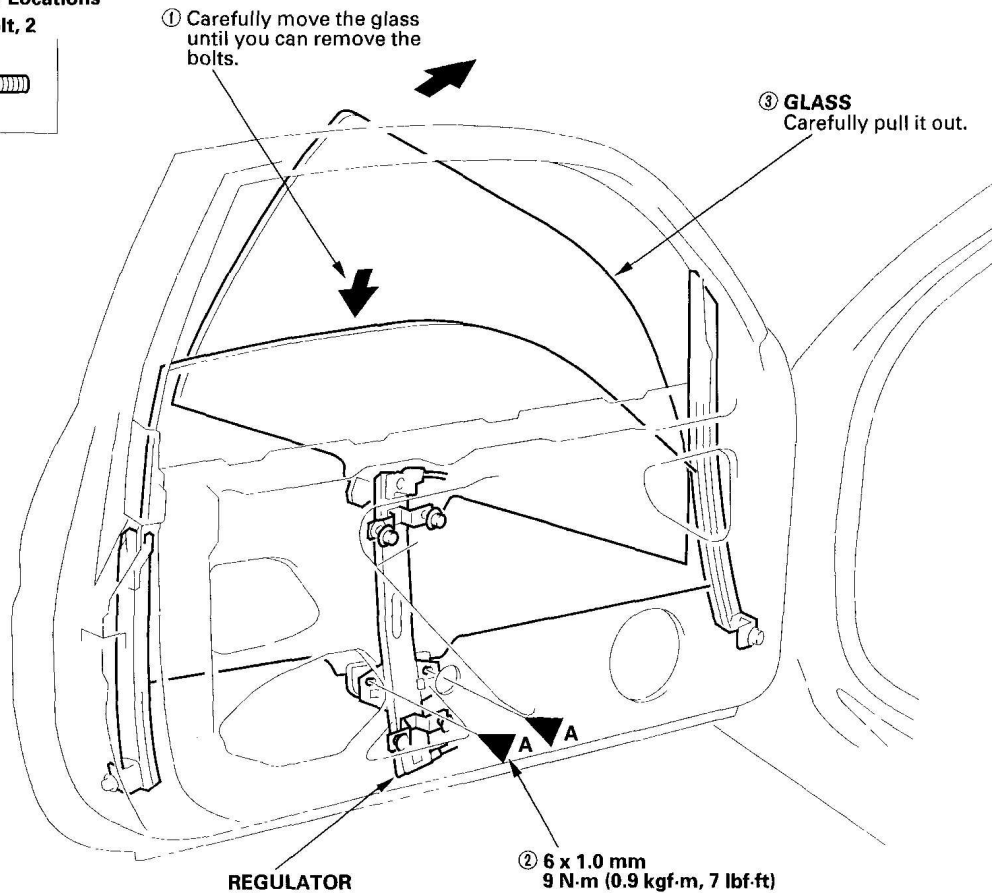

G03682533

**Fig. 7: Identifying Removal Sequence Of Door Glass And Regulator With Specified Torques (1 Of 2)**

**Courtesy of AMERICAN HONDA MOTOR CO., INC.**

## 2006 Honda Insight

2000-06 ACCESSORIES & EQUIPMENT Doors - Insight

### Fastener Locations

B ► : Bolt\*, 3    C ► : Bolt\*, 4



\*: CORROSION-RESISTANT BOLT

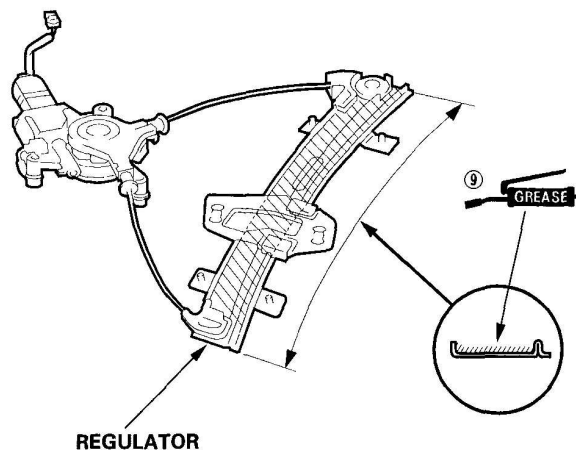
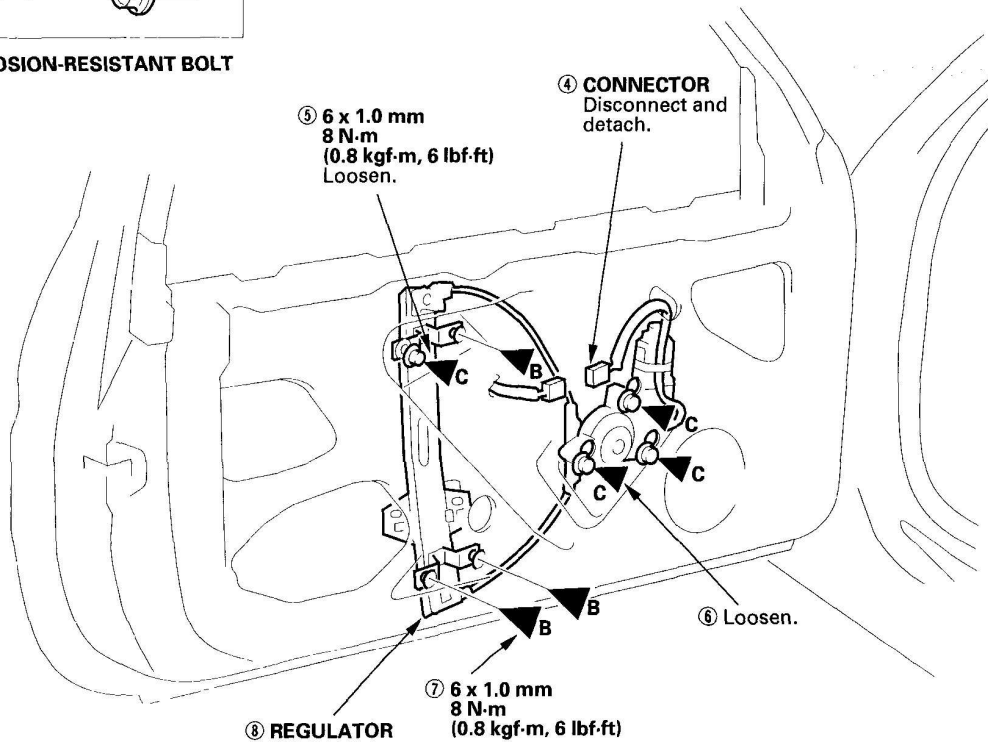

G03682534

**Fig. 8: Identifying Removal Sequence Of Door Glass And Regulator With Specified Torques (2 Of 2)**

**Courtesy of AMERICAN HONDA MOTOR CO., INC.**

## DOOR GLASS ADJUSTMENT

### NOTE:

- Check the weatherstrips and glass run channel for damage or deterioration, and replace them if necessary.
- Wipe the run channel clean with a shop towel.
- Lubricate the run channel with Shin-Etsu silicone grease P/N 08798-9013.

1. Place the vehicle on a firm, level surface.
2. Remove these items:
  - Door panel (see **DOOR PANEL REMOVAL/INSTALLATION** )
  - Plastic cover (see **COMPONENT LOCATION INDEX** )
3. Carefully move the glass (A) until you can see the glass mounting bolts (B), then loosen them.

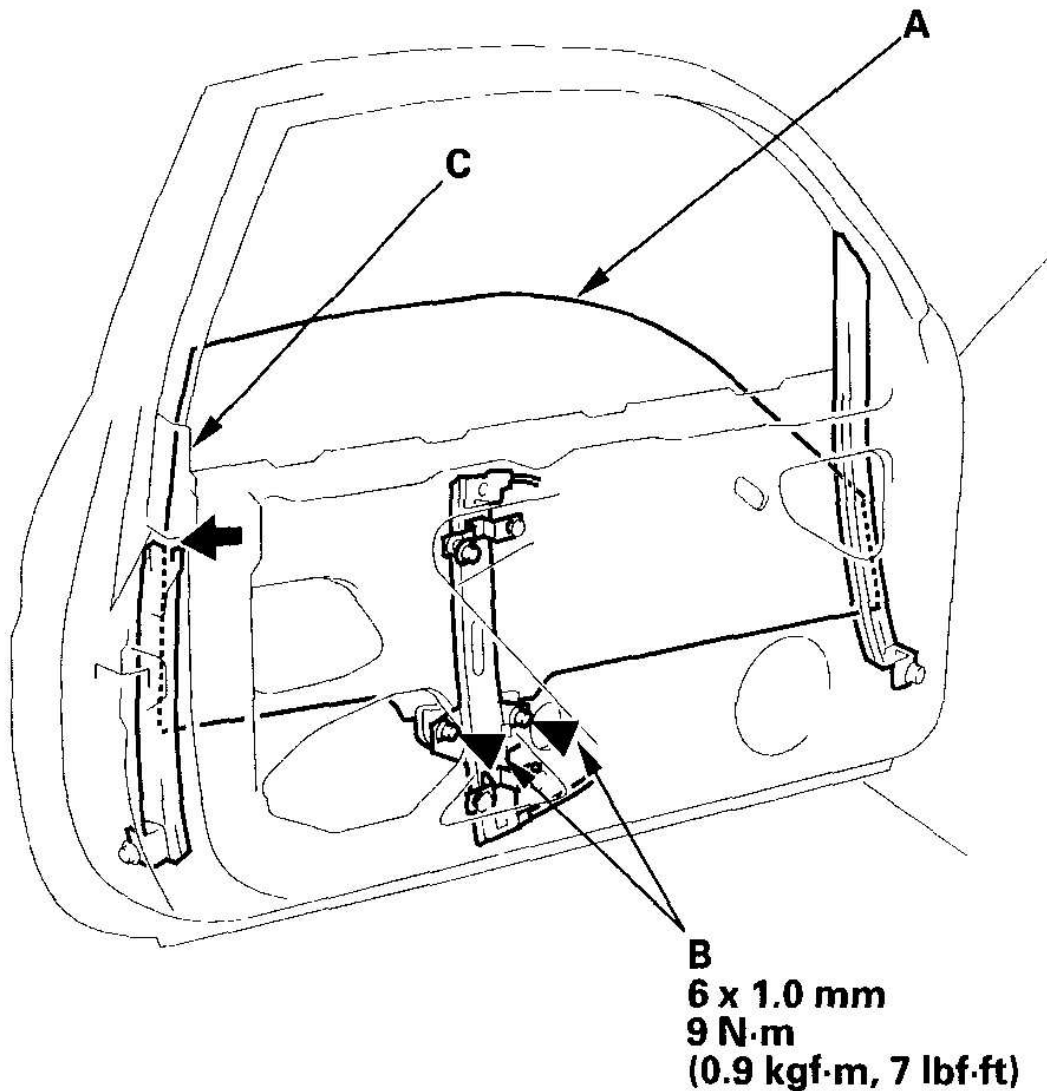

G03682535

**Fig. 9: Loosening Glass Mounting Bolts And Torque Specifications**  
**Courtesy of AMERICAN HONDA MOTOR CO., INC.**

4. Push the glass against the rear channel (C), then tighten the glass mounting bolts.
5. Check that the glass moves smoothly.
6. Raise the glass fully, and check for gaps. Check that the glass (A) contacts the glass run channel (B) evenly.

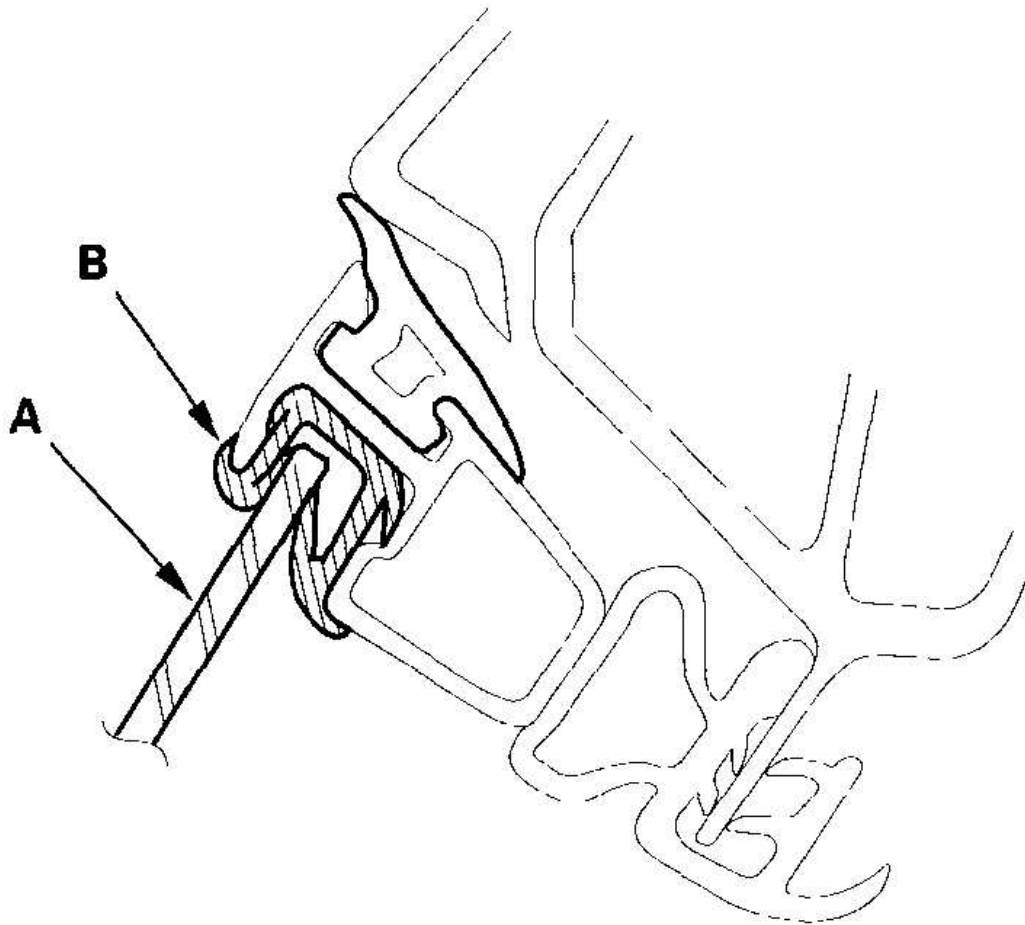

G03682536

**Fig. 10: Checking Glass Run Channel Evenly**  
**Courtesy of AMERICAN HONDA MOTOR CO., INC.**

7. Check for water leaks. Run water over the roof and on the sealing area as shown, and note these items:
  - Use a 12 mm (1/2 in.) diameter hose (A).
  - Adjust the rate of water flow as shown (B).
  - Do not use a nozzle.
  - Hold the hose about 300 mm (12 in.) away from the door (C).



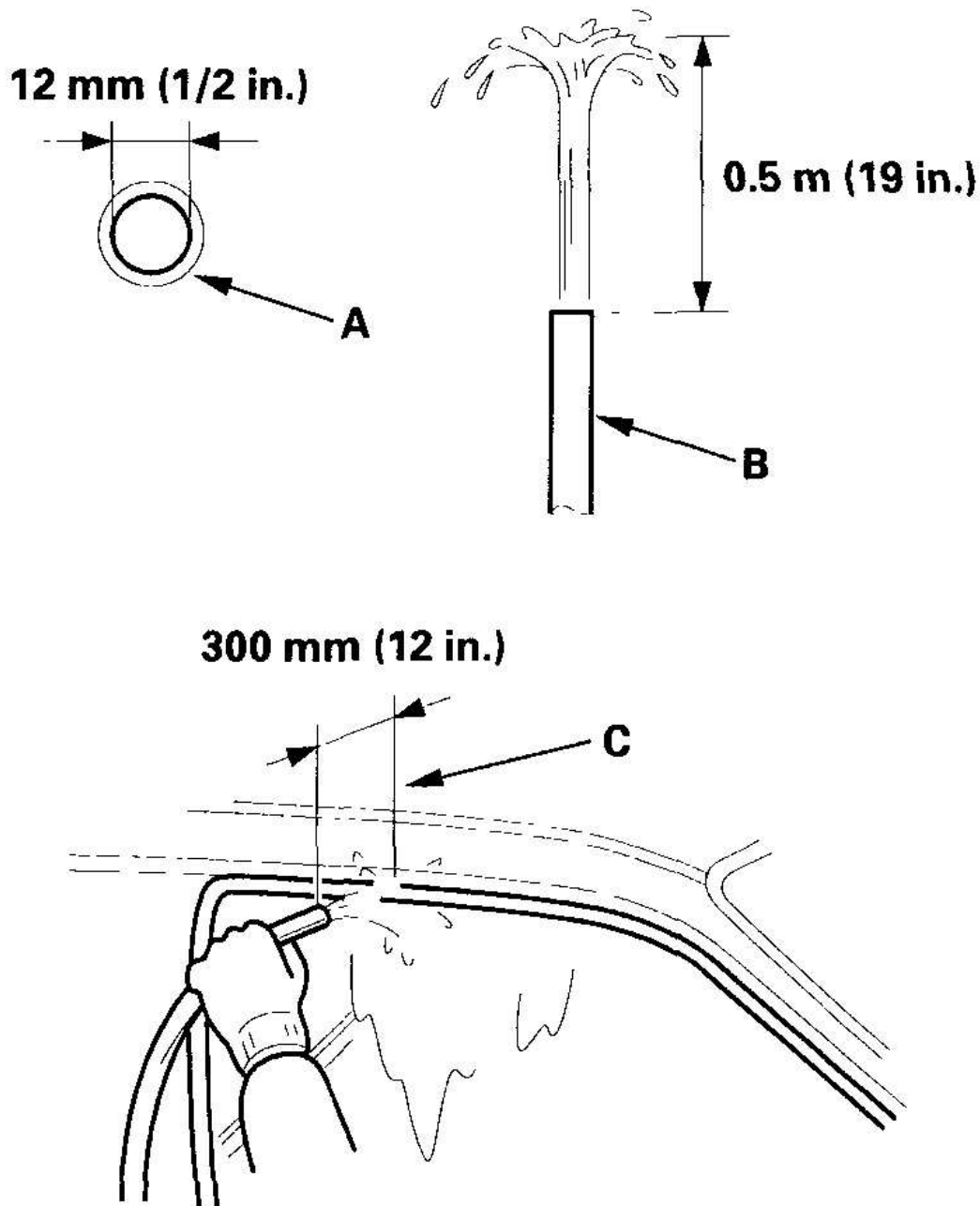

G03682537

**Fig. 11: Running Water Over Roof And On Sealing Area For Checking Water Leaks**

**Courtesy of AMERICAN HONDA MOTOR CO., INC.**

8. Attach the plastic cover, and reinstall the door panel (see **DOOR PANEL REMOVAL/INSTALLATION** ).
9. Test-drive and check for wind noise.

## **DOOR SASH OUTER TRIM REPLACEMENT**

- NOTE:**
- **Take care not to scratch the door and trim.**
  - **Use a clip remover to remove the door upper seal clips.**

1. Remove the door sash outer trim as shown.
2. Install the trim in the reverse order of removal, and note these items:
  - Install the bottom of the trim into the door molding securely.
  - Check for damaged or stress-whitened clips, and replace them with new ones.

**Fastener Locations**

A ▴ : Clip, 2    B ▴ : Screw, 3

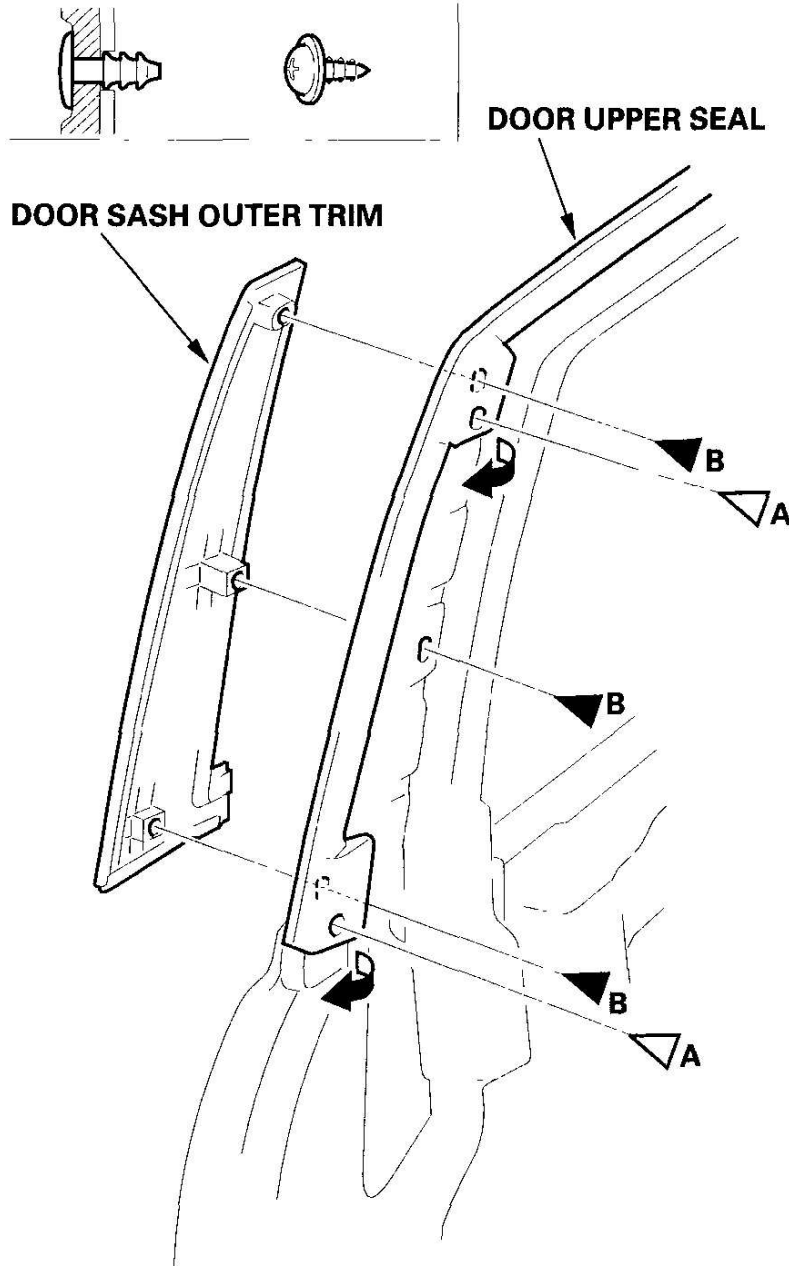

G03682538

**Fig. 12: Removing Door Sash Outer Trim**  
Courtesy of AMERICAN HONDA MOTOR CO., INC.

## **DOOR GLASS OUTER WEATHERSTRIP REPLACEMENT**

- NOTE:**
- Put on gloves to protect your hands.
  - Take care not to scratch the door and molding.

1. Remove these items:
  - Door sash outer trim
  - Power mirror (see **POWER MIRROR REPLACEMENT** )
2. Starting at the rear, pry the door glass outer weatherstrip (A) up, and detach the clips (B).

### Fastener Locations

B ▷ : Clip, 4

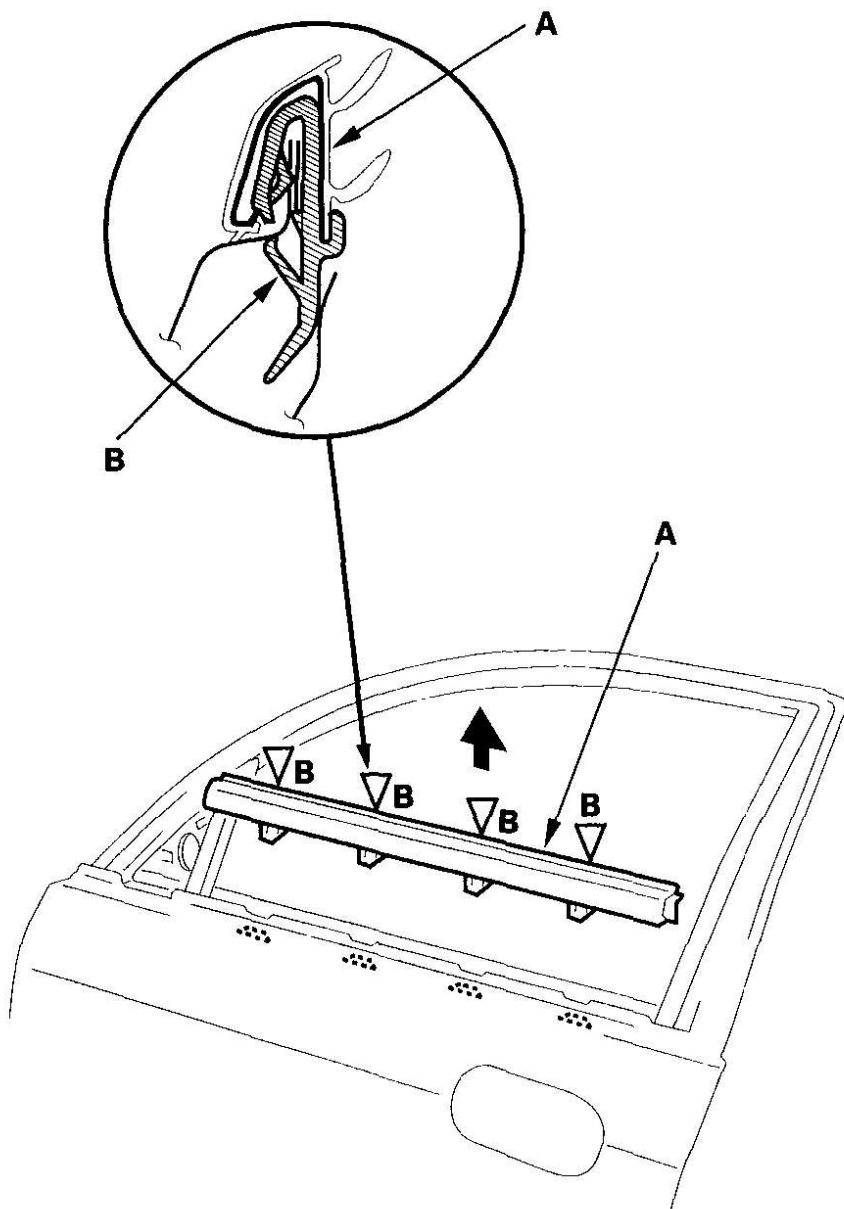

G03682539

**Fig. 13: Removing Door Glass Outer Weatherstrip And Clips**  
Courtesy of AMERICAN HONDA MOTOR CO., INC.

3. Install the weatherstrip in the reverse order of removal, and check for damaged or stress-whitened clips, and replace them with new ones.

## DOOR SEAL AND DOOR WEATHERSTRIP SPACER REPLACEMENT

### NOTE:

- Take care not to scratch the door.
- Use a clip remover to remove the clips.

1. Remove these items:

- Before removing the door upper seal, remove the door panel (see **DOOR PANEL REMOVAL/INSTALLATION** ) and door sash outer trim (see **DOOR SASH OUTER TRIM REPLACEMENT** ).
- Before removing the door weatherstrip spacer, remove the door panel (see **DOOR PANEL REMOVAL/INSTALLATION** ).

2. Remove the door upper seal, door still seal, and door weatherstrip spacer as shown.
3. Install the seals and spacer in the reverse order of removal, and note these items:
  - Check for damaged or stress-whitened clips, and replace them with new ones.
  - If the old upper seal and spacer are to be reinstalled, scrape off all traces of old butyl tapes, EPT sealer, and adhesive tape, then clean the upper seal and spacer surfaces with alcohol. Attach the new butyl tapes, EPT sealer, and adhesive tape to the door upper seal and door weatherstrip spacer.
  - Press the butyl tape and adhesive tape portions to make the adhesive stick.
  - Check for water leaks (see step 7 ).
  - Test-drive and check for wind noise.



**Fastener Locations**

A ▷ : Clip, 5    B ▷ : Clip, 7    C ▷ : Clip, 2

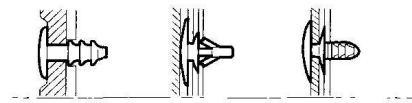

**BUTYL TAPES**

Thickness: 0.5 mm (0.02 in.)  
Width: 5 mm (0.2 in.)

**EPT SEALER**

Thickness: 3 mm (0.12 in.)  
Width: 5 mm (0.2 in.)

**BUTYL TAPE**

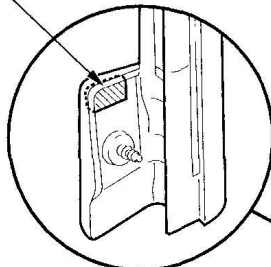

**DOOR UPPER SEAL**

**DOOR WEATHERSTRIP SPACER**

**ADHESIVE TAPE**

Thickness: 0.4 mm (0.016 in.)  
Width: 7 mm (0.28 in.)

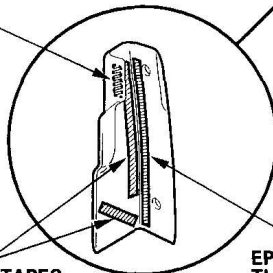

**BUTYL TAPES**

Thickness: 0.5 mm (0.02 in.)  
Width: 5 mm (0.2 in.)

**EPT SEALER**

Thickness: 3 mm (0.12 in.)  
Width: 5 mm (0.2 in.)

**DOOR SILL SEAL**

G03682540

**Fig. 14: Removing Door Upper Seal, Door Still Seal And Door Weatherstrip Spacer**

Courtesy of AMERICAN HONDA MOTOR CO., INC.

**DOOR POSITION AND DOOR STRIKER ADJUSTMENT**

**NOTE:**

- After installing the door, check for a flush fit with the body, then check for equal gaps between the front, rear, and bottom door edges and the body. Check that the door and body edges are parallel.
- Place the vehicle on a firm, level surface when

adjusting the door.

- Place a shop towel on the jack to prevent damage to the door when holding the door.

1. Slightly loosen the striker mounting screws (A).

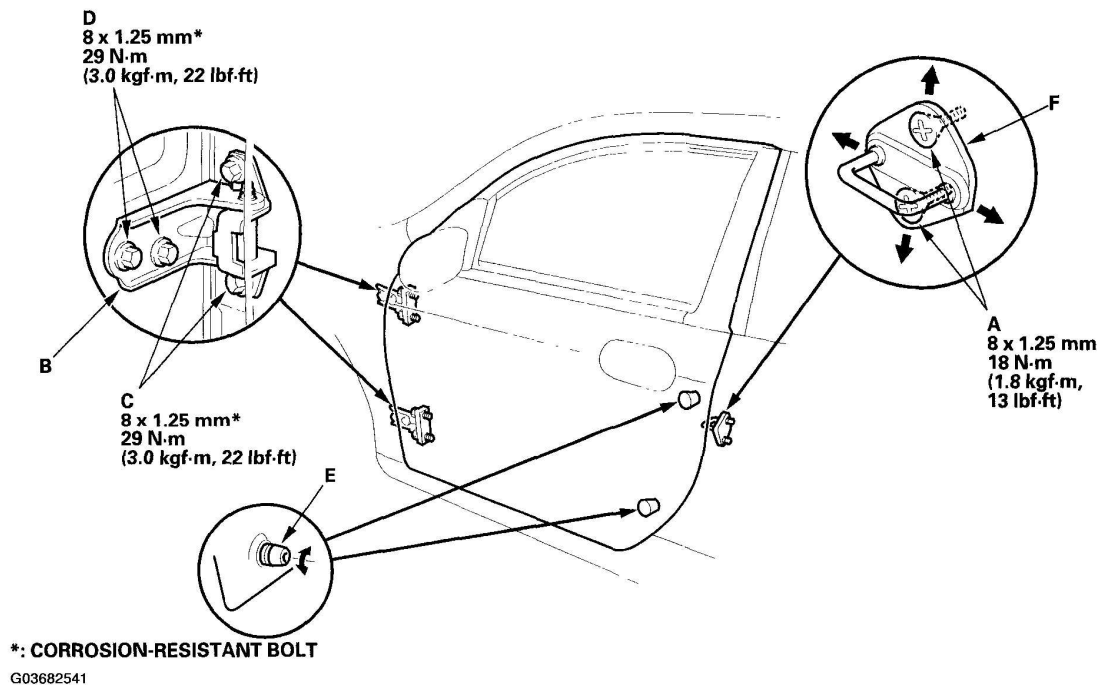
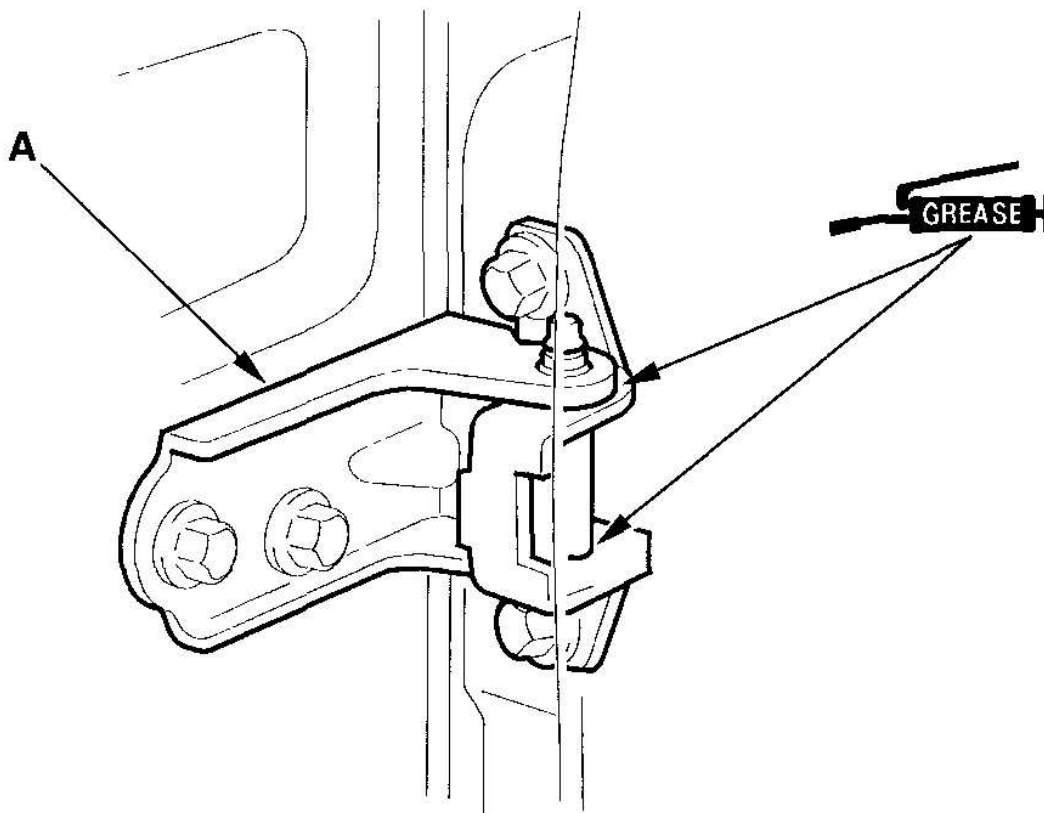

**Fig. 15: Adjusting Door Position And Door Striker**  
Courtesy of AMERICAN HONDA MOTOR CO., INC.

2. Adjust the door alignment in this sequence:

- Adjust at the hinges (B):
  - Loosen the door mounting bolts (C) slightly, and move the door in or out until it's flush with the body.
  - Remove the front inner fender (see **FRONT INNER FENDER REPLACEMENT**), then slightly loosen the hinge mounting bolts (D), and move the door backward or forward, up or down as necessary to equalize the gaps.
- Turn the door cushions (E), as necessary, to make the rear of the door flush with the body.

3. Make sure the door and body edges are parallel, and the door is flush with the body. Tighten the door and hinge mounting bolts, and recheck.
4. Adjust the striker (F):
  - Move the striker in or out to make the latch fit tighter or looser.
  - Move the striker up or down to align it with the latch opening.
5. Make sure the door latches properly. Tighten the striker mounting screws, and recheck.
6. Apply multipurpose grease to the pivot portions of the hinges (A) indicated by the arrows.



G03682542

**Fig. 16: Applying Multipurpose Grease To Pivot Portions Of Hinges**  
Courtesy of AMERICAN HONDA MOTOR CO., INC.

<b>2006 Honda Insight</b>
2000-06 ACCESSORIES & EQUIPMENT Doors - Insight

7. Apply touch-up paint to the hinge and door mounting bolts, and around the hinges.
8. Check for water leaks (see step 7 ).
9. Test-drive and check for wind noise.