

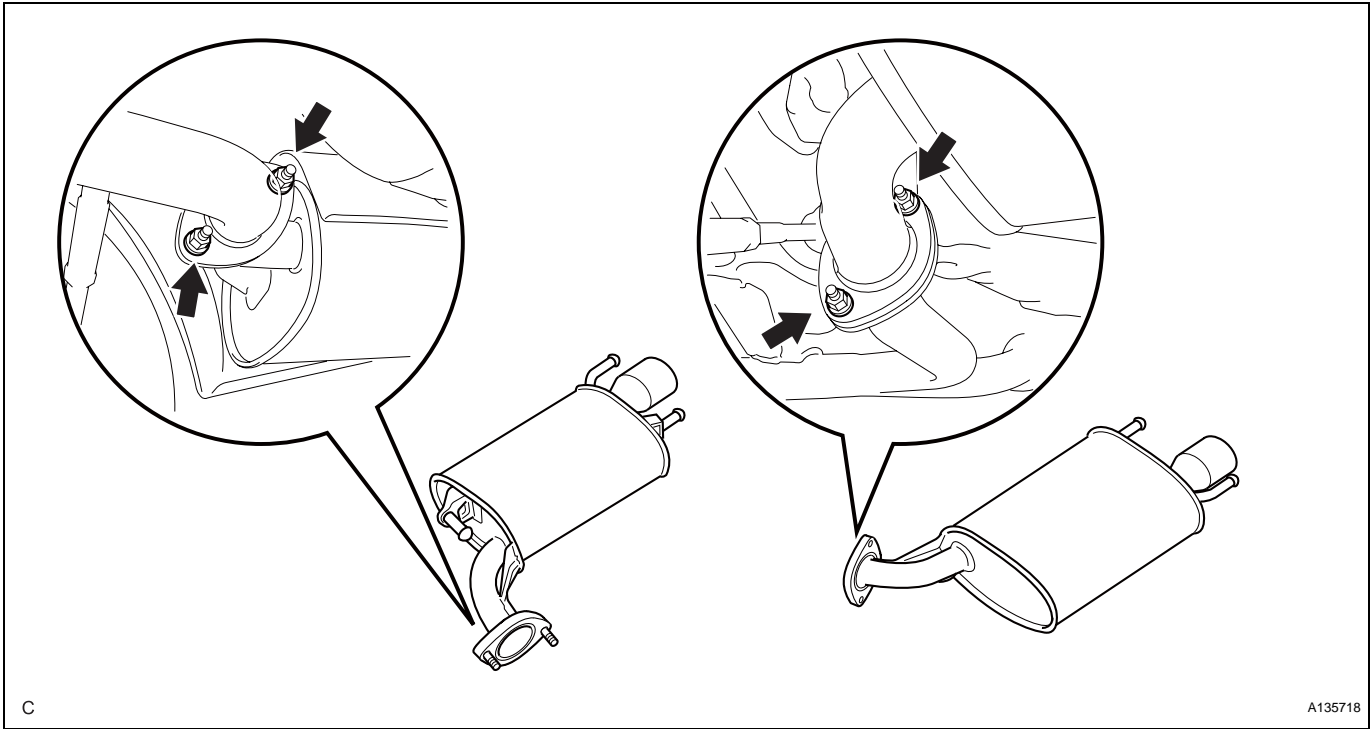

## REMOVAL

### 1. REMOVE EXHAUST TAIL PIPE ASSEMBLY

- (a) Remove the 4 nuts and 2 exhaust tail pipes.



- (b) Remove the 2 gaskets from the exhaust center pipe assembly.

### 2. REMOVE EXHAUST CENTER PIPE ASSEMBLY

- (a) Remove the 2 bolts, 2 nuts and exhaust center pipe assembly.

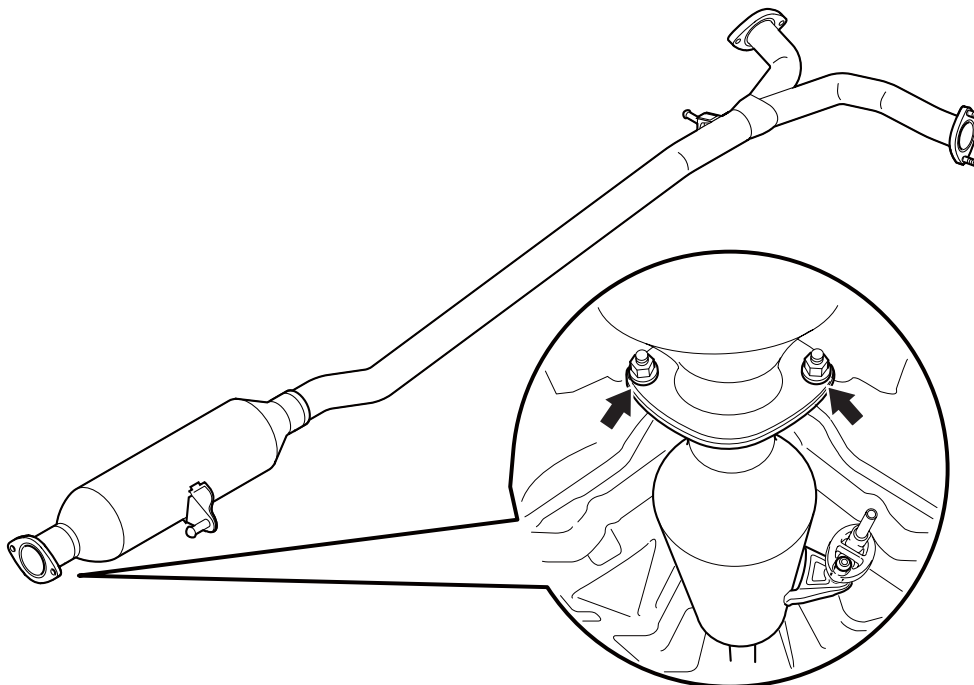

- (b) Remove the gasket from the exhaust pipe assembly.

**3. REMOVE FRONT EXHAUST PIPE NO. 1 SUPPORT BRACKET**

- (a) Remove the 2 nuts and front support brackets.

**4. REMOVE EXHAUST FRONT PIPE ASSEMBLY**

- (a) Disconnect the 2 heated oxygen sensor (bank 1, 2 sensor 2) connectors.  
 (b) Remove the 2 nuts from the exhaust front pipe (left bank exhaust manifold side).

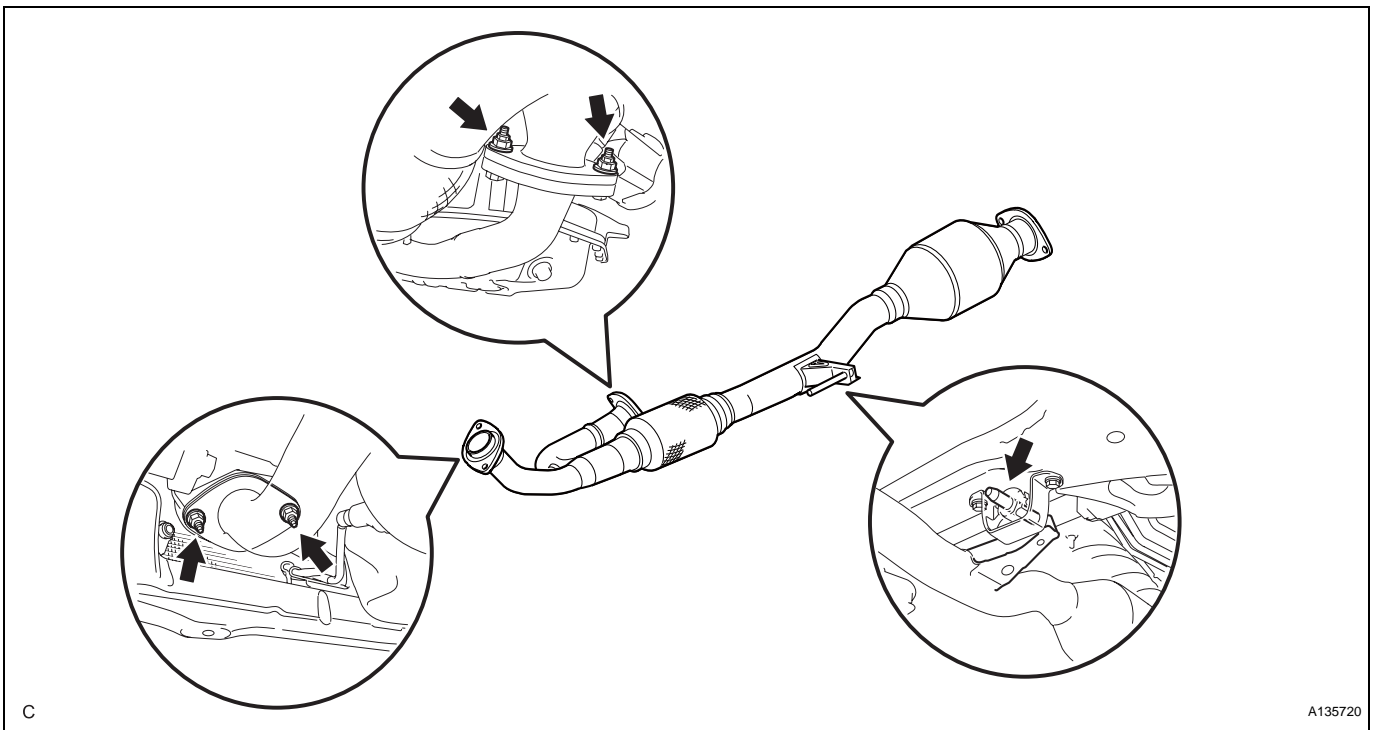
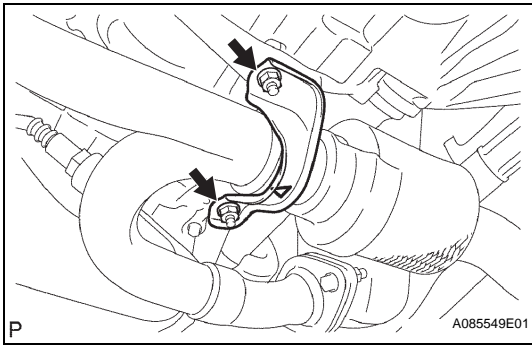

- (c) Remove the 2 nuts from the exhaust front pipe (right bank exhaust pipe manifold side).  
 (d) Remove the exhaust front pipe.  
 (e) Remove the 2 gaskets from the exhaust front pipe.

**5. REMOVE HEATED OXYGEN SENSOR (See page EC-21)**

**6. REMOVE REAR EXHAUST PIPE NO. 1 SUPPORT BRACKET**

- (a) Remove the 2 bolts and rear support bracket.

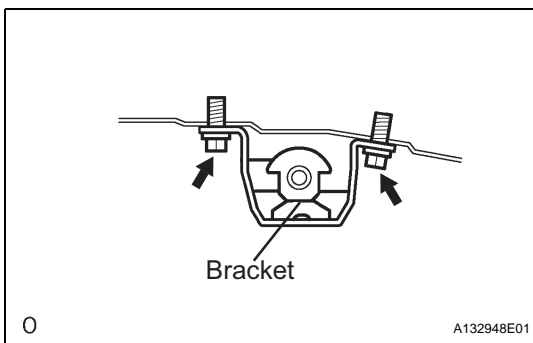

## INSTALLATION

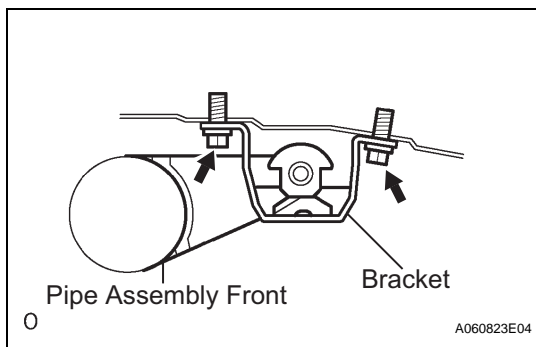

### 1. INSTALL REAR EXHAUST PIPE NO. 1 SUPPORT BRACKET

- (a) Install the rear support bracket with the 2 bolts.

**Torque: 33 N\*m (337 kgf\*cm, 24 ft.\*lbf)**

**NOTICE:**

**Be sure to install the bracket in the correct direction.**

### 2. INSTALL HEATED OXYGEN SENSOR (See page EC-21)

### 3. INSTALL EXHAUST FRONT PIPE ASSEMBLY

- (a) Install 2 new gaskets to the exhaust front pipe.

- (b) Install the exhaust front pipe to the exhaust manifolds with the 4 nuts.

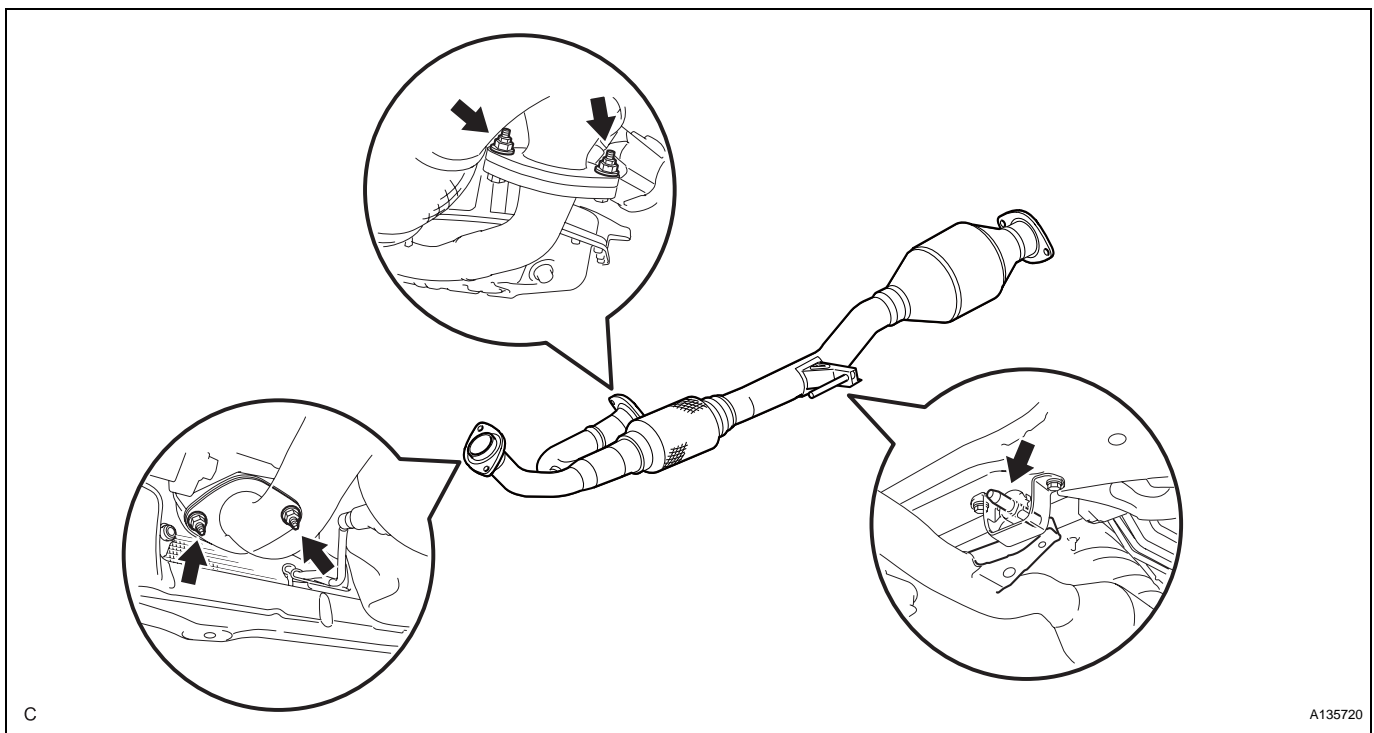

**Torque: 62 N\*m (632 kgf\*cm, 46 ft.\*lbf)**

### 4. INSTALL FRONT EXHAUST PIPE NO. 1 SUPPORT BRACKET

- (a) Install the front support brackets with the 2 nuts.

**Torque: 33 N\*m (337 kgf\*cm, 24 ft.\*lbf)**

**NOTICE:**

**Be sure to install the support brackets in the correct direction.**

### 5. INSTALL EXHAUST CENTER PIPE ASSEMBLY

- (a) Install a new gasket to the exhaust center pipe assembly.

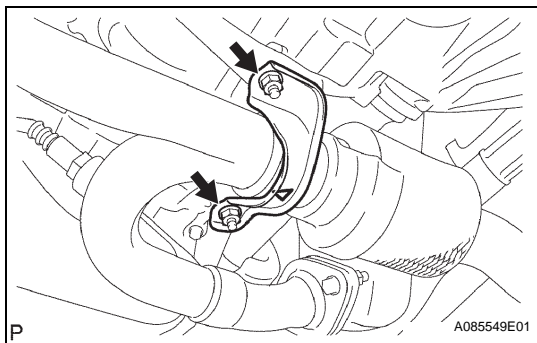

- (b) Install the exhaust center pipe to the exhaust front pipe with the 2 nuts and 2 bolts.

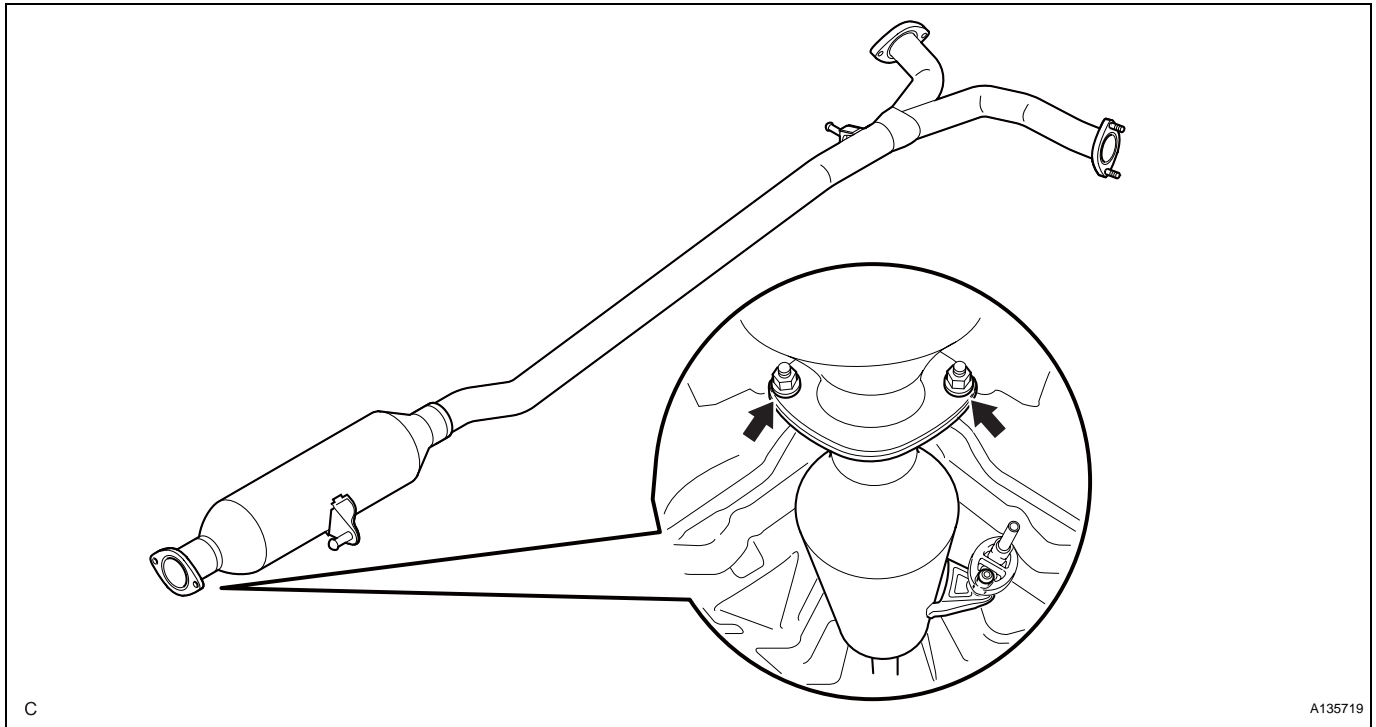

**Torque: 56 N\*m (571 kgf\*cm, 41 ft.\*lbf)**

#### 6. INSTALL EXHAUST TAIL PIPE ASSEMBLY

- (a) Install 2 new gaskets to the exhaust tail pipes.  
 (b) Install the 2 exhaust tail pipes with the 4 nuts.

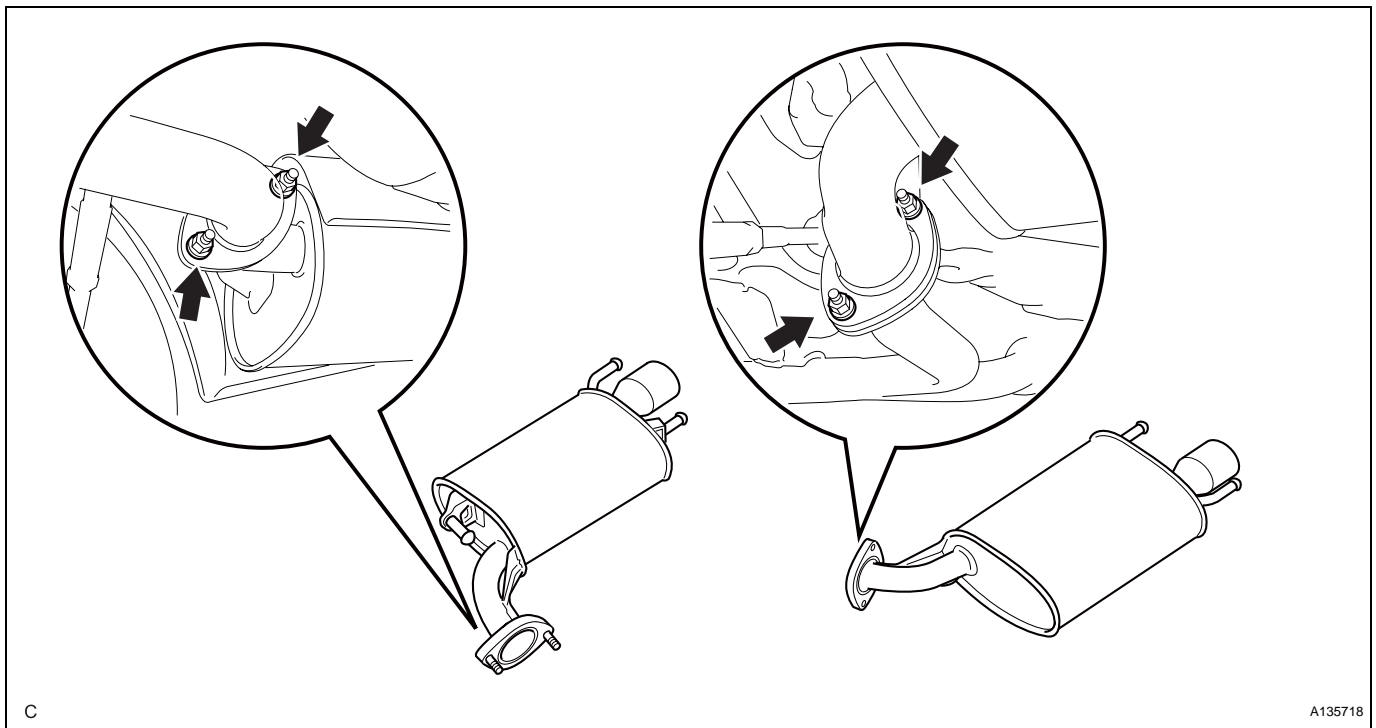

**Torque: 43 N\*m (438 kgf\*cm, 32 ft.\*lbf)**

#### 7. CHECK FOR EXHAUST GAS LEAKS

If gas is leaking, tighten the areas necessary to stop the leak. Replace the damaged parts as necessary.