

## REMOVAL

### 1. REMOVE FUEL TANK ASSEMBLY

- (a) Remove the fuel tank (see page [FU-39](#)).

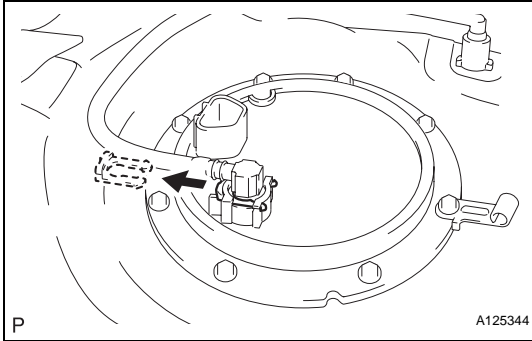

### 2. REMOVE FUEL TANK MAIN TUBE SUB-ASSEMBLY

- (a) Remove the joint clip and fuel tank main tube.

#### CAUTION:

- Before removing the tube joint clip, check for foreign matter around the clip. Clean if necessary.
- Keep the O-ring free of foreign matter, as it becomes contaminated easily.
- Do not use any tools in this procedure.
- Do not forcefully bend or twist the tube.
- Put the tube in a plastic bag to prevent damage and contamination.
- If the fuel suction plate and tube are stuck together, pinch the tube and turn it carefully to disconnect it.
- Be careful not to damage the clip. If the clip is damaged, replace it.

FU

### 3. REMOVE FUEL TANK VENT TUBE SET PLATE

- (a) Remove the 8 bolts and set plate.

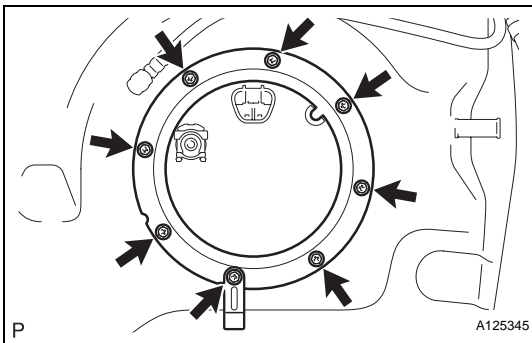

### 4. REMOVE FUEL SUCTION WITH PUMP ASSEMBLY

- (a) Disconnect the fuel hose and remove the fuel pump from the fuel tank.

#### NOTICE:

Do not damage the fuel pump.

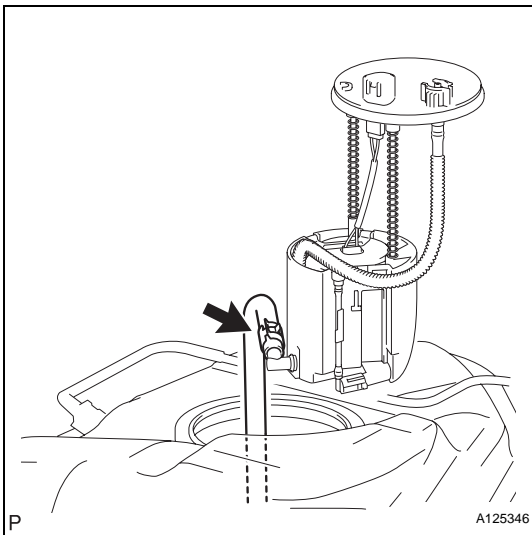

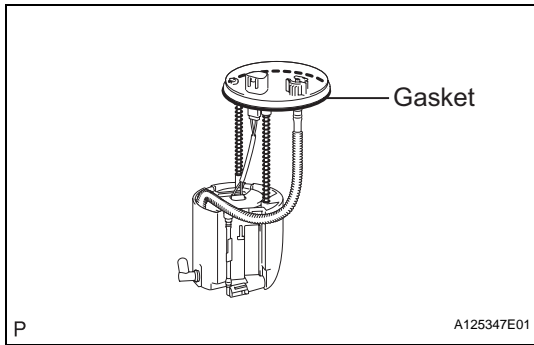

(b) Remove the gasket from the fuel pump.

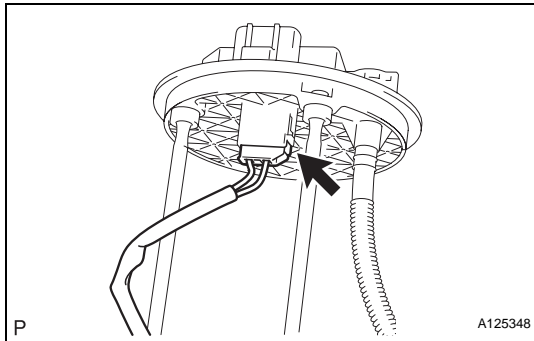

## 5. REMOVE FUEL SUB-TANK ASSEMBLY

(a) Disconnect the wire harness.

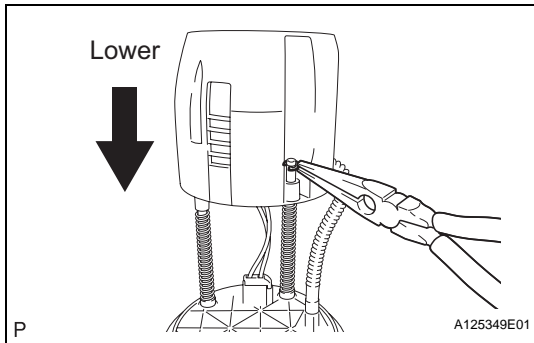

(b) Using needle nose pliers, remove the E-ring.  
HINT:  
Slightly lower the sub-tank to remove the E-ring.

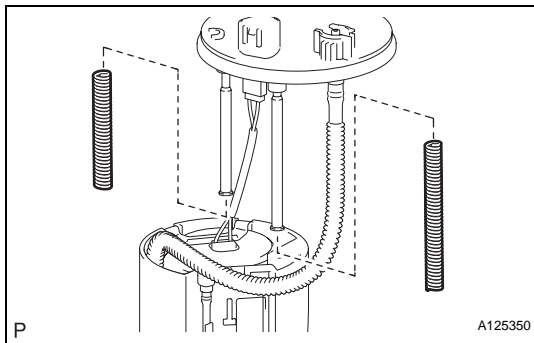

(c) Remove the 2 springs from the 2 shaft.

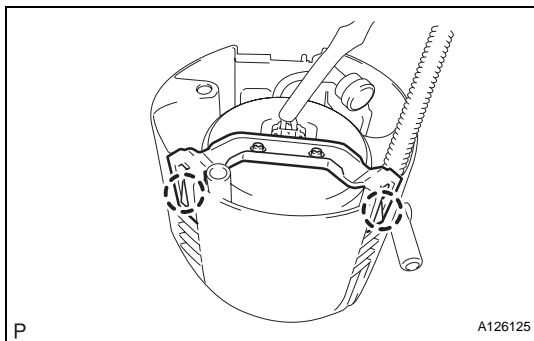

(d) Detach the 2 claws and remove the sub-tank.

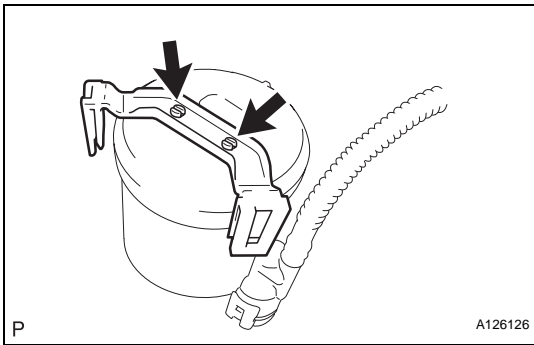
**6. REMOVE BRACKET**

- (a) Using a screwdriver, detach the 2 claws and remove the bracket.

HINT:

Tape the screwdriver tip before use.

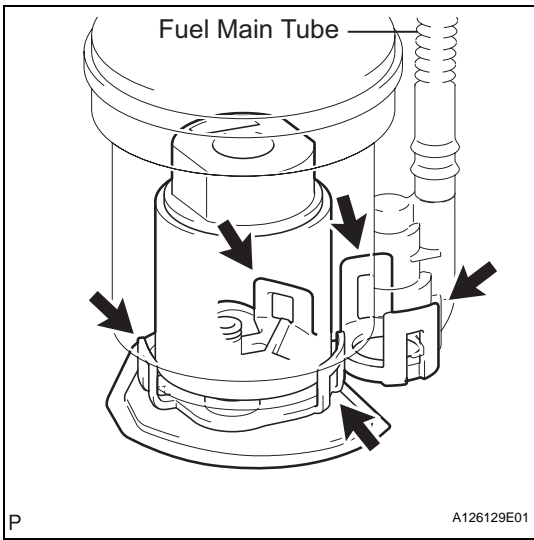
**7. REMOVE FUEL PUMP ASSEMBLY**

- (a) Detach the 5 claws on the filter and remove the fuel pump from the fuel filter.

HINT:

When removing the claw, do not disconnect the fuel main tube.

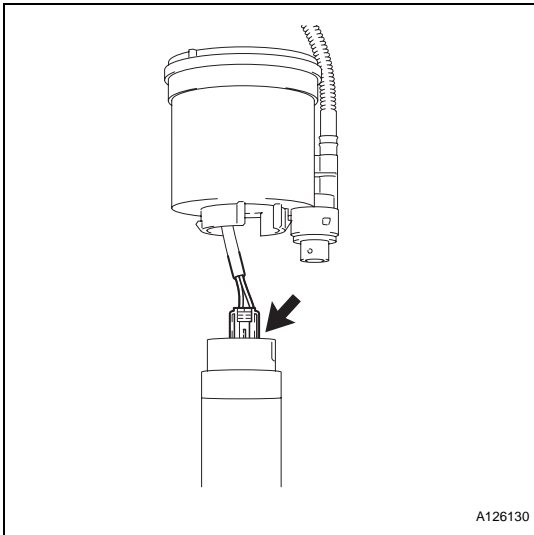

- (b) Disconnect the fuel pump connector.

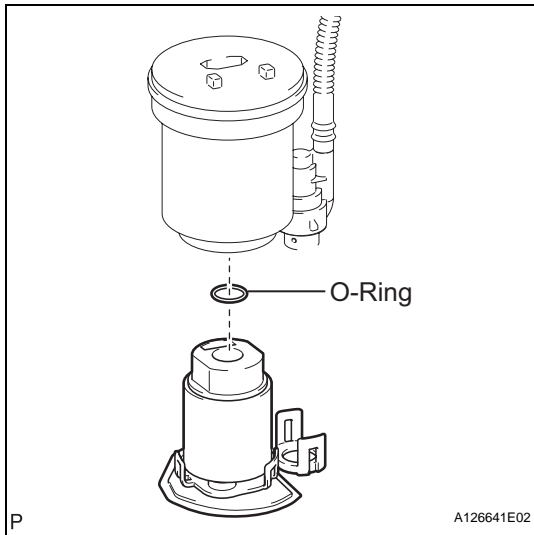

(c) Remove the O-ring from the fuel filter.

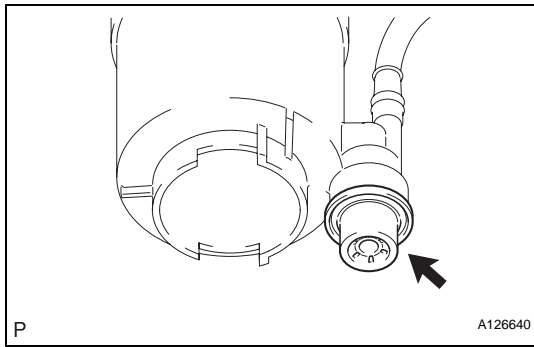

## 8. REMOVE FUEL PRESSURE REGULATOR ASSEMBLY

- (a) Remove the fuel pressure regulator from the fuel filter.
- (b) Remove the 2 O-rings.

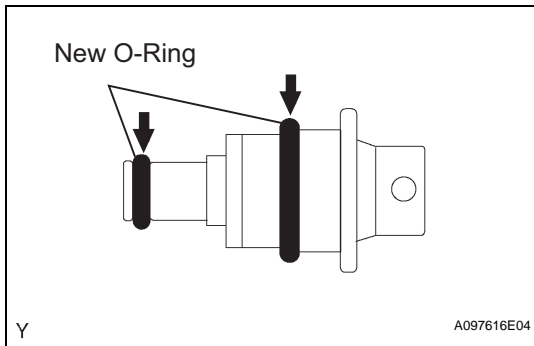

## INSTALLATION

### 1. INSTALL FUEL PRESSURE REGULATOR ASSEMBLY

- (a) Apply a light coat of gasoline to 2 new O-rings, and install them onto the fuel pressure regulator.

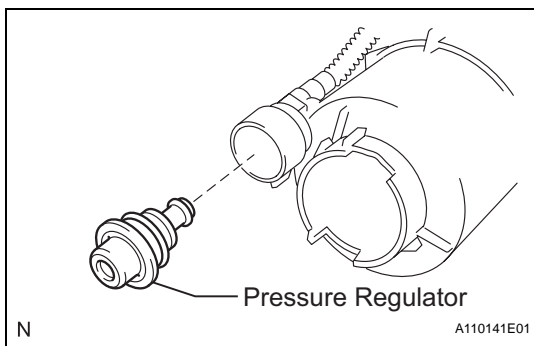

- (b) Install the fuel pressure regulator to the fuel filter.

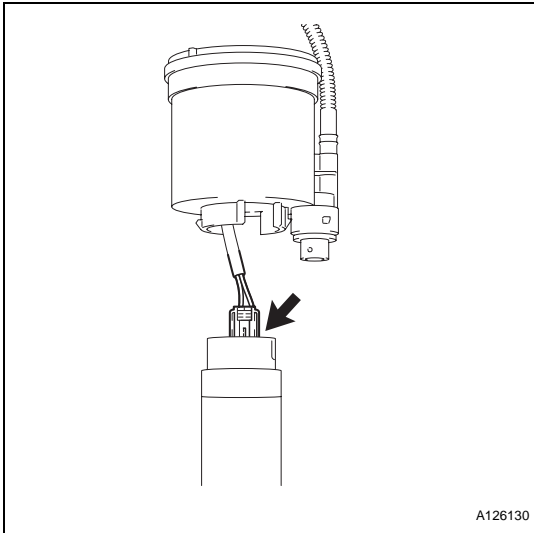
**2. INSTALL FUEL PUMP ASSEMBLY**

- (a) Connect the pump harness connector.

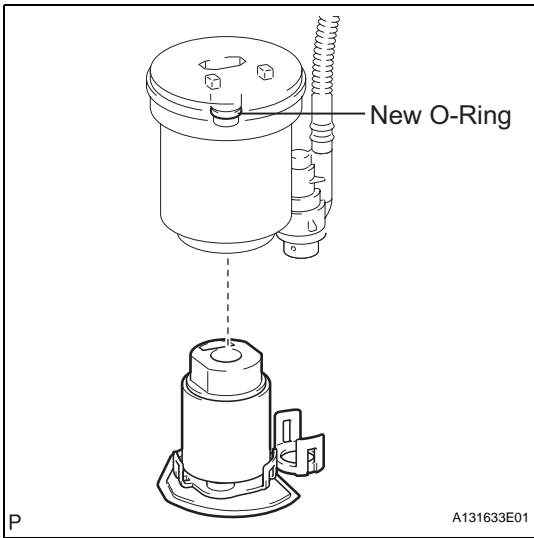

- (b) Apply gasoline to a new O-ring and install the O-ring to the fuel filter.

- (c) Attach the 5 claws to the claw holes and install the fuel pump.

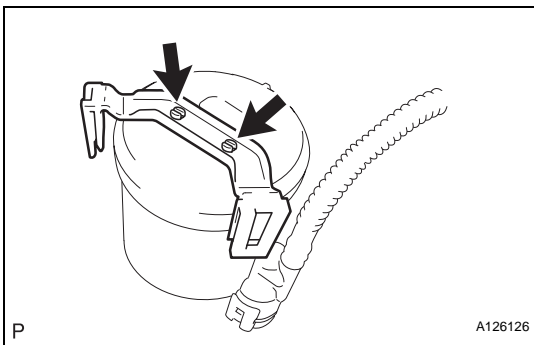
**3. INSTALL BRACKET**

- (a) Attach the 2 claws to the claw holes and install the bracket.

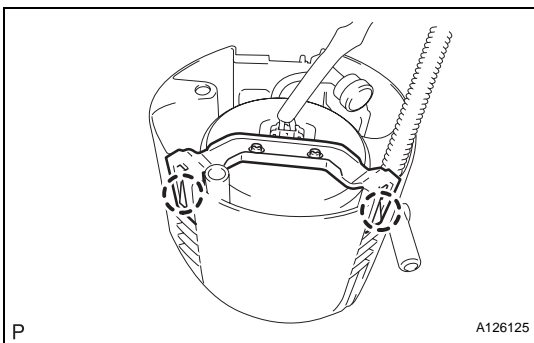
**4. INSTALL FUEL SUB-TANK ASSEMBLY**

- (a) Attach the 2 claws to the claw holes and install the fuel sub-tank.

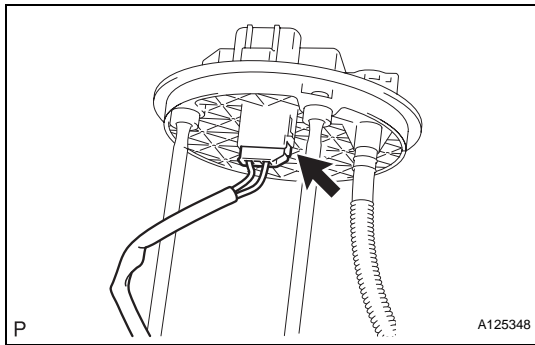

(b) Connect the wire harness.

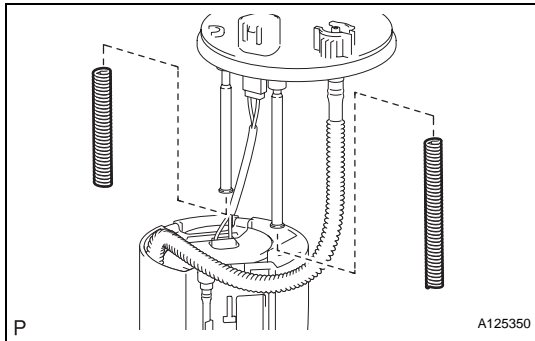

(c) Install the spring to the fuel suction plate shaft and install it to the sub-tank.

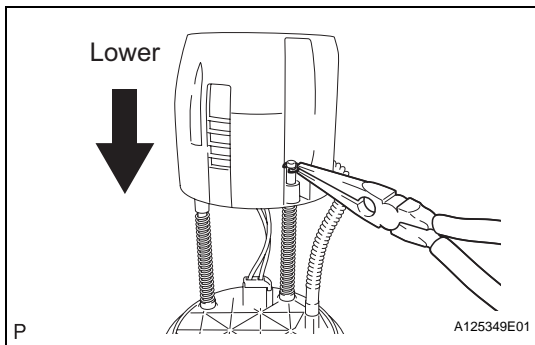

(d) Using needle-nose pliers, install a new E-ring.  
HINT:  
Slightly lower the sub-tank to install the E-ring.

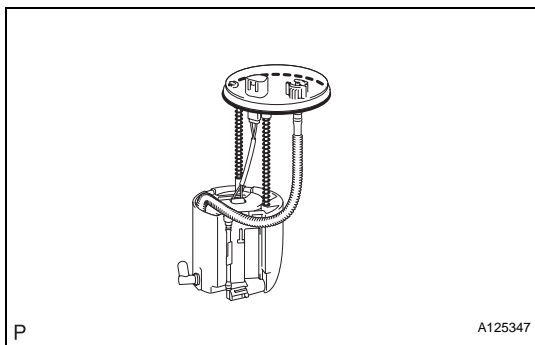

## 5. INSTALL FUEL SUCTION WITH PUMP ASSEMBLY

(a) Install a new gasket onto the fuel pump.

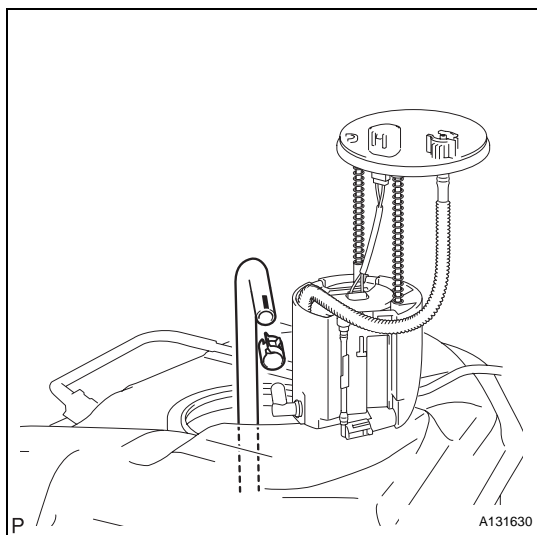

- (b) Connect the fuel hose and install the fuel pump into the fuel tank.

**NOTICE:**

**Do not damage the fuel pump filter.**

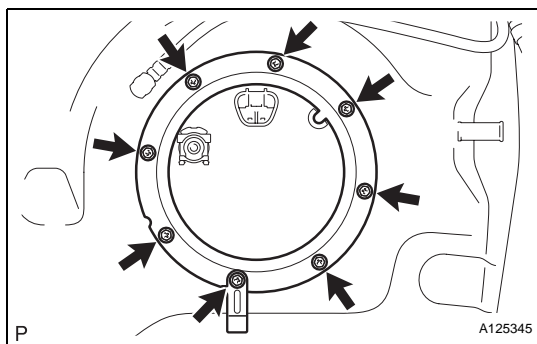

**6. INSTALL FUEL TANK VENT TUBE SET PLATE**

- (a) Install the set plate with the 8 bolts.

**Torque: 4.0 N\*m (41 kgf\*cm, 35 in.\*lbf)**

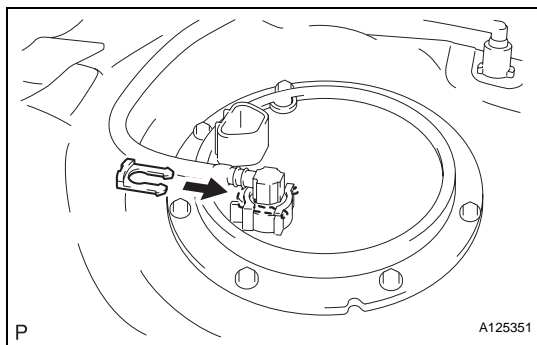

**7. INSTALL FUEL TANK MAIN TUBE SUB-ASSEMBLY**

- (a) Install the fuel tube with the joint clips.

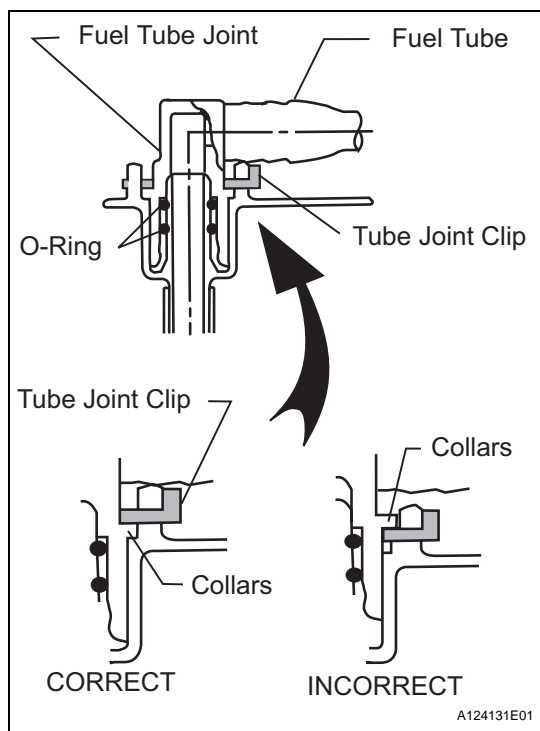
**CAUTION:**

- Check that there are no scratches or foreign objects on the connecting parts.
- Check that the fuel tube joint is inserted securely.
- Check that the fuel tube joint clip is on the collars of the fuel tube joint.
- After installing the tube joint clip, check that the fuel tube joint has not been pulled off.
- Be careful not to damage the clip. If the clip is damaged, replace it.

**8. INSTALL FUEL TANK ASSEMBLY**

- (a) Install the fuel tank (see page [FU-44](#)).