

CANISTER COMPONENTS

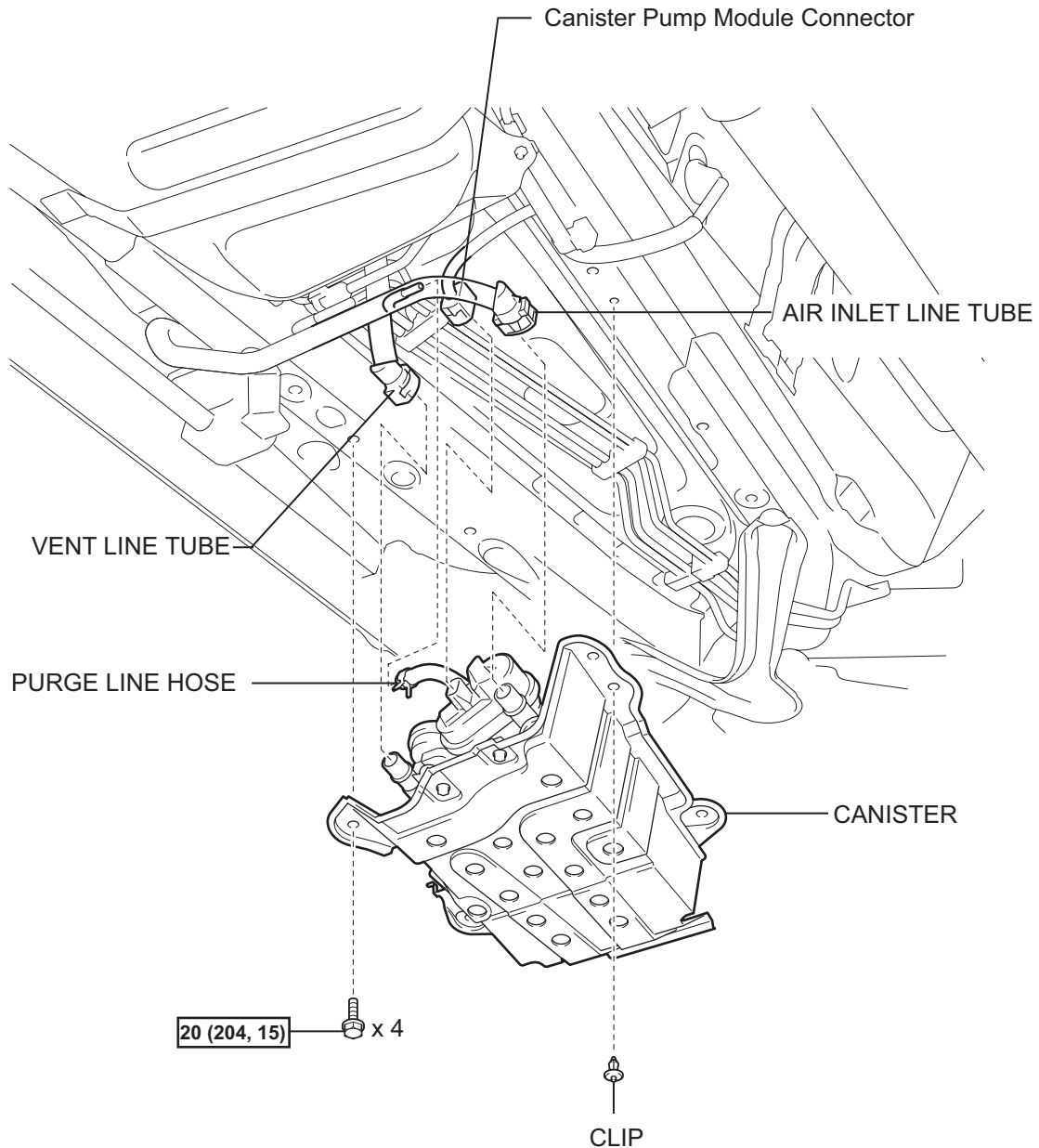

EC

$\boxed{\text{N*m (kgf*cm, ft.*lbf)}}$: Specified torque

REMOVAL

1. DISCONNECT CABLE FROM NEGATIVE BATTERY TERMINAL

CAUTION:

Wait at least 90 seconds after disconnecting the cable from the negative (-) battery terminal to prevent airbag and seat belt pretensioner activation.

2. REMOVE CANISTER

(a) Disconnect the 2 tubes, hose and connector.

(1) Using a screwdriver, pry up the retainer.

HINT:

Do not remove the retainer.

(2) Disconnect the purge line hose.

(3) Disconnect the air inlet line tube from the canister.

(4) Disconnect the vent line tube from the canister (leak detection pump).

(5) Disconnect the connector from the canister (leak detection pump).

NOTICE:

- Remove any dirt or foreign objects on the fuel tube connector before performing this work.

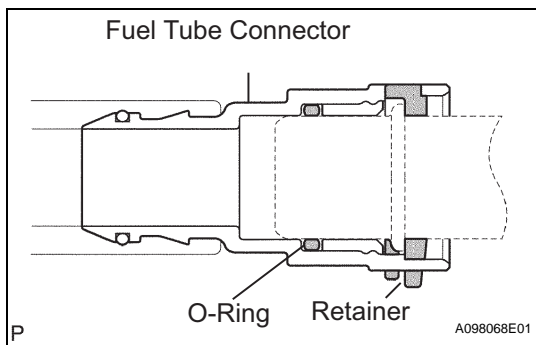
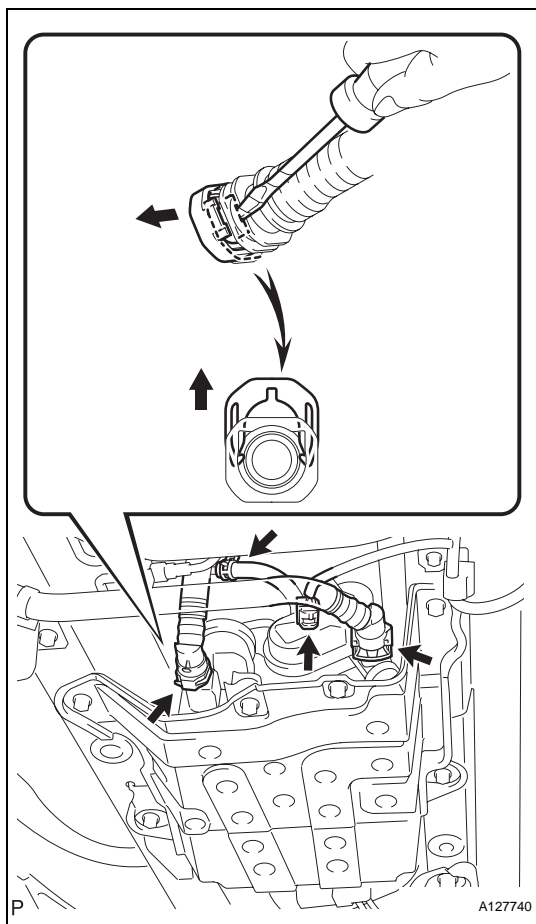

- Do not allow any scratches or foreign objects on the parts when disconnecting as the fuel tube connector has the O-ring that seals the pipe.
- Perform this work by hand. Do not use any tools.
- Do not forcibly bend, twist or turn the nylon tube.
- Protect the disconnected part by covering it with a plastic bag after disconnecting the fuel tank vent hose.
- If the fuel tube connector and pipe are stuck, push and pull to release them.