

<b>Last Modified:</b> 12-04-2024	6.11:8.1.0	<b>Doc ID:</b> RM10000002BJML
<b>Model Year Start:</b> 2023	<b>Model:</b> Prius Prime	<b>Prod Date Range:</b> [03/2023 - ]
<b>Title:</b> SUPPLEMENTAL RESTRAINT SYSTEMS: CENTER AIRBAG SENSOR ASSEMBLY: REMOVAL; 2023 - 2024 MY Prius Prius Prime [03/2023 - ]		

## REMOVAL

### CAUTION / NOTICE / HINT

The necessary procedures (adjustment, calibration, initialization or registration) that must be performed after parts are removed and installed, or replaced during airbag ECU assembly removal/installation are shown below.

#### **Necessary Procedures After Parts Removed/Installed/Replaced**

REPLACED PART OR PERFORMED PROCEDURE	NECESSARY PROCEDURE	EFFECT/INOPERATIVE FUNCTION WHEN NECESSARY PROCEDURE NOT PERFORMED	LINK
Airbag ECU assembly	ECU configuration	Vehicle Control History (RoB) are stored	<a href="#">INFO</a>
	Update ECU security key	Vehicle Control History (RoB) are stored	<a href="#">INFO</a>
	Write the VIN/Vehicle Identification Number	-	<a href="#">INFO</a>
	Switch the specification information	-	<a href="#">INFO</a>
	Perform "Calibration"*	<ul style="list-style-type: none"> <li>• DTCs are stored</li> <li>• ABS warning light illuminates</li> <li>• Brake system warning light (yellow indicator) illuminates</li> <li>• Slip indicator light illuminates</li> <li>• Electronically controlled brake system disabled or malfunctions</li> </ul>	<a href="#">INFO</a>
<b>w/ Occupant Classification System:</b>  Zero point calibration (Occupant classification system)	<ul style="list-style-type: none"> <li>• Occupant Classification System</li> <li>• Passenger airbag ON/OFF indicator</li> <li>• Airbag System (Front passenger side)</li> <li>• Seat Belt Warning System (Front passenger)</li> </ul>	<a href="#">INFO</a>	
*: Even when not replacing the part, it is necessary to perform the specified necessary procedures after installation.			

### CAUTION / NOTICE / HINT

#### **HINT:**

When the cable is disconnected / reconnected to the auxiliary battery terminal, systems temporarily stop operating. However, each system has a function that completes learning the first time the system is used.

#### **Learning completes when vehicle is driven**

EFFECT/INOPERATIVE FUNCTION WHEN NECESSARY PROCEDURE NOT PERFORMED	NECESSARY PROCEDURE	LINK
Front Camera System	Drive the vehicle straight ahead at 35 km/h (22 mph) or more for 5 seconds or more.	<a href="#">INFO</a>

### Learning completes when vehicle is operated normally

EFFECT/INOPERATIVE FUNCTION WHEN NECESSARY PROCEDURE NOT PERFORMED	NECESSARY PROCEDURE	LINK
Power Door Lock Control System*1 <ul style="list-style-type: none"> <li>Back door opener</li> </ul>	Perform door unlock operation with door control switch or electrical key transmitter sub-assembly switch.	<a href="#">INFO</a>
Power Back Door System*2	Reset back door close position	<a href="#">INFO</a>
Air Conditioning System	<p><b>for HEV Model:</b></p> <p>After the ignition switch is turned to ON, the servo motor standard position is recognized.</p> <p><b>for PHEV Model:</b></p> <p>After the ignition switch is turned to ON, the servo motor and expansion valve standard position is recognized.</p>	-
*1: w/o Power Back Door System		
*2: w/ Power Back Door System		

## CAUTION / NOTICE / HINT

### COMPONENTS (REMOVAL)

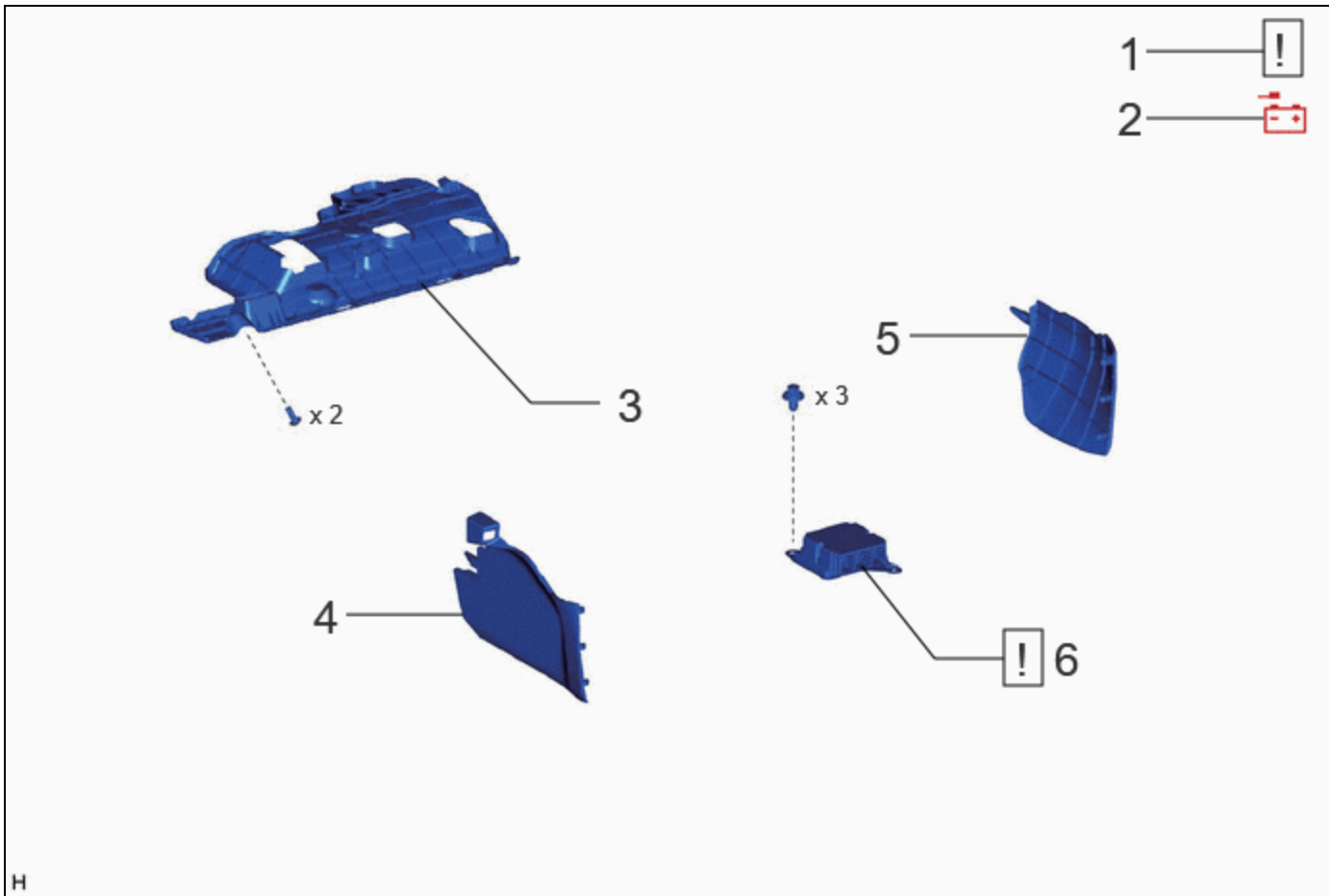

PROCEDURE		PART NAME CODE			
1	PRECAUTION	-	INFO	-	-
2	DISCONNECT CABLE FROM NEGATIVE AUXILIARY BATTERY TERMINAL	-	INFO	-	-
3	NO. 1 INSTRUMENT PANEL UNDER COVER SUB-ASSEMBLY	55606	-	-	-
4	FRONT NO. 1 CONSOLE BOX INSERT	58816D	-	-	-
5	FRONT NO. 2 CONSOLE BOX INSERT	58817A	-	-	-
6	AIRBAG ECU ASSEMBLY	89170A	INFO	-	-

## PROCEDURE

### 1. PRECAUTION

	<p><b>CAUTION:</b></p> <p>Be sure to read Precaution thoroughly before servicing.</p>
--	---



Click here [INFO](#)

**NOTICE:**

After the ignition switch is turned off, there may be a waiting time before disconnecting the negative (-) auxiliary battery terminal.

Click here [INFO](#)

## 2. DISCONNECT CABLE FROM NEGATIVE AUXILIARY BATTERY TERMINAL

**CAUTION:**

Wait at least 60 seconds after disconnecting the cable from the negative (-) auxiliary battery terminal to disable the SRS system.

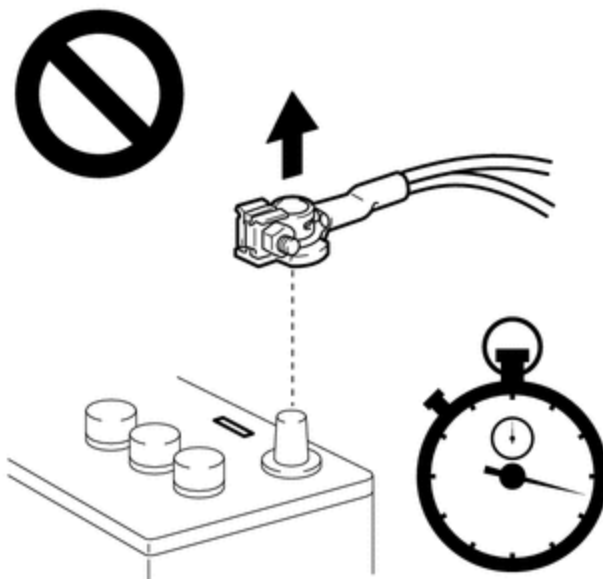

- for M20A-FXS:

Click here [INFO](#)

- for 2ZR-FXE:

Click here [INFO](#)

## 3. REMOVE NO. 1 INSTRUMENT PANEL UNDER COVER SUB-ASSEMBLY

Click here [INFO](#)

#### 4. REMOVE FRONT NO. 1 CONSOLE BOX INSERT

Click here [INFO](#)

#### 5. REMOVE FRONT NO. 2 CONSOLE BOX INSERT

Click here [INFO](#)

#### 6. REMOVE AIRBAG ECU ASSEMBLY

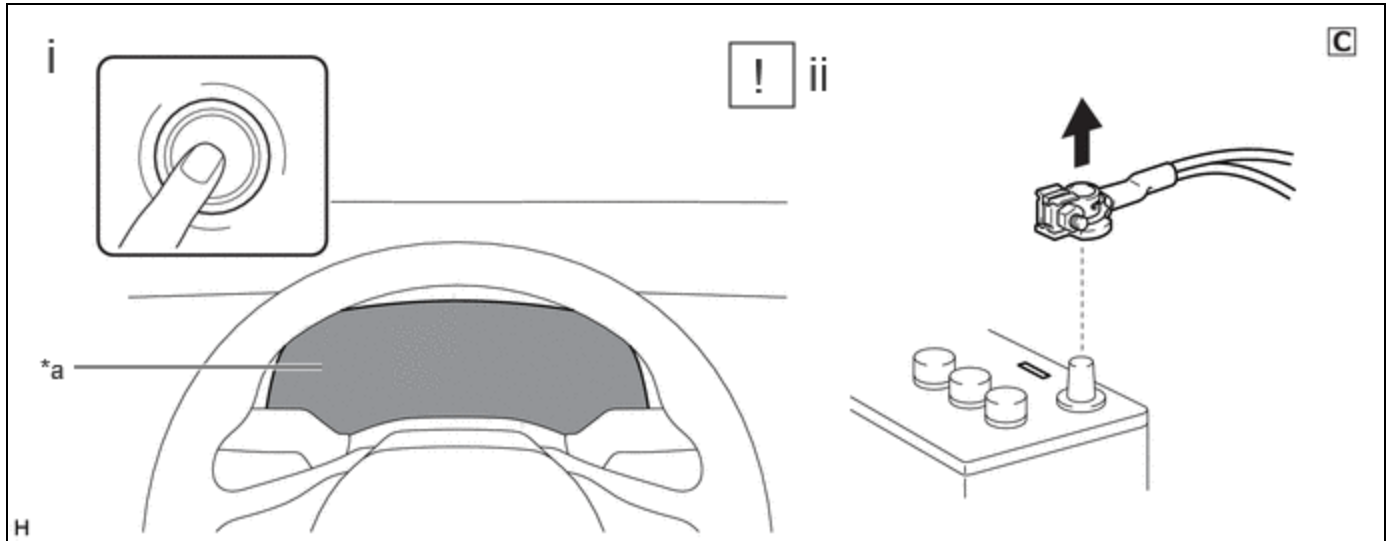

*a	Illumination off	-	-
----	------------------	---	---

- (1) Check that the ignition switch is off.
- (2) Check that the cable is disconnected from the negative (-) auxiliary battery terminal.

**CAUTION:**

Wait at least 60 seconds after disconnecting the cable from the negative (-) auxiliary battery terminal to disable the SRS system.

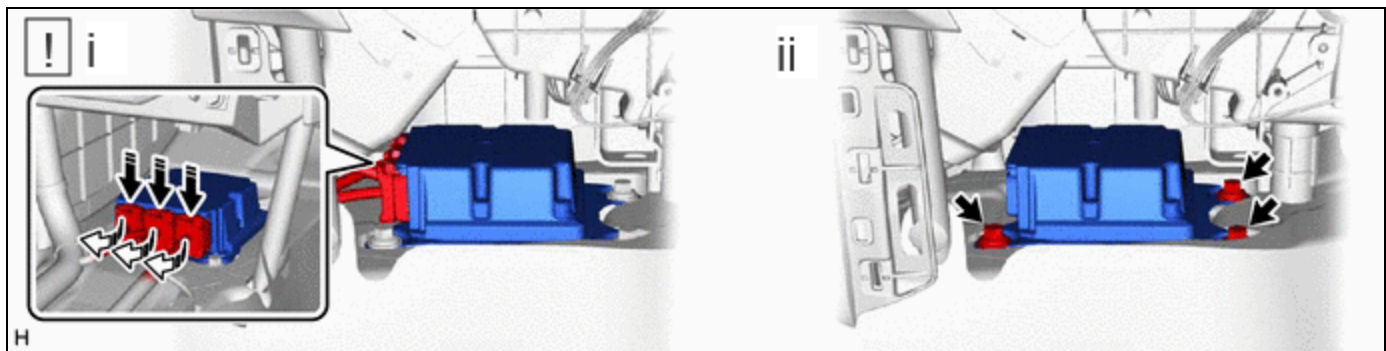

	Release the lock		Disconnect the connector
--	------------------	--	--------------------------

- (1) Release the lock, and then disconnect the connectors.

**NOTICE:**

When disconnecting any airbag connector, take care not to damage the airbag wire harness.

(2) Remove the 3 bolts and airbag ECU assembly.

