

<b>Last Modified:</b> 12-04-2024	6.11:8.1.0	<b>Doc ID:</b> RM10000002BJBY
<b>Model Year Start:</b> 2023	<b>Model:</b> Prius Prime	<b>Prod Date Range:</b> [03/2023 - ]
<b>Title:</b> EXTERIOR PANELS / TRIM: WINDSHIELD OUTSIDE MOULDING: REMOVAL; 2023 - 2024 MY Prius Prius Prime [03/2023 - ]		

## REMOVAL

### CAUTION / NOTICE / HINT

The necessary procedures (adjustment, calibration, initialization or registration) that must be performed after parts are removed and installed, or replaced during windshield glass removal/installation are shown below.

### CAUTION / NOTICE / HINT

#### Necessary Procedures After Parts Removed/Installed/Replaced

REPLACED PART OR PERFORMED PROCEDURE	NECESSARY PROCEDURES	EFFECT/INOPERATIVE FUNCTION WHEN NECESSARY PROCEDURES ARE NOT PERFORMED	LINK
Windshield glass*	Adjust forward recognition camera	<ul style="list-style-type: none"> <li>Front Camera System</li> <li>Automatic High Beam System</li> <li>Traffic Jam Assist System</li> </ul>	One Time Recognition: <a href="#">INFO</a> Driving Adjustment: <a href="#">INFO</a>
*: Even when not replacing the part, it is necessary to perform the specified necessary procedures after installation.			

### CAUTION / NOTICE / HINT

#### HINT:

- Use the same procedure for the RH side and LH side.
- The following procedure is for the LH side.

### CAUTION / NOTICE / HINT

#### COMPONENTS (REMOVAL)

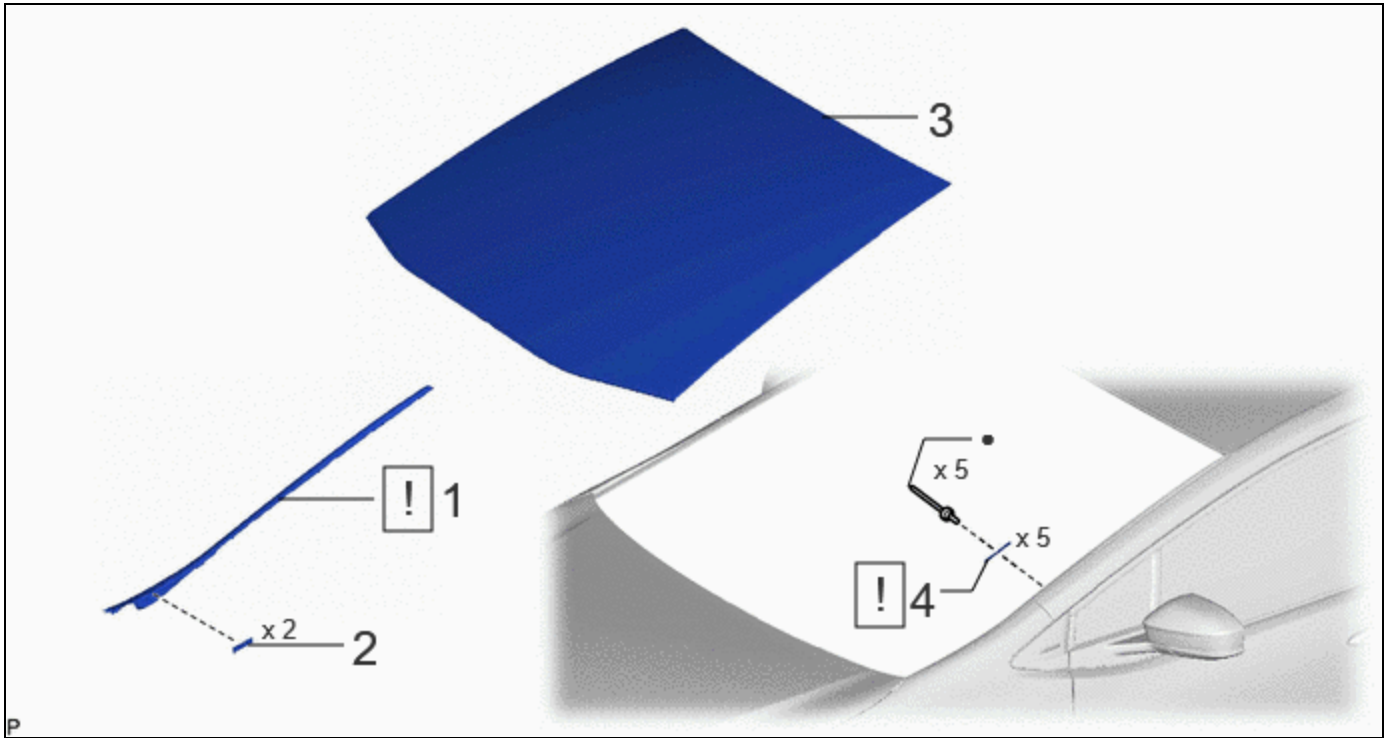

	PROCEDURE	PART NAME CODE			
1	WINDSHIELD LOWER OUTSIDE MOULDING	75536D	<a href="#">INFO</a>	-	-
2	NO. 2 WINDSHIELD OUTSIDE MOULDING CLIP	75546B	-	-	-
3	WINDSHIELD GLASS SUB-ASSEMBLY	-	-	-	-
4	NO. 1 WINDSHIELD OUTSIDE MOULDING CLIP	75545B	<a href="#">INFO</a>	-	-

•	Non-reusable part	-	-
---	-------------------	---	---

## PROCEDURE

### 1. REMOVE WINDSHIELD LOWER OUTSIDE MOULDING

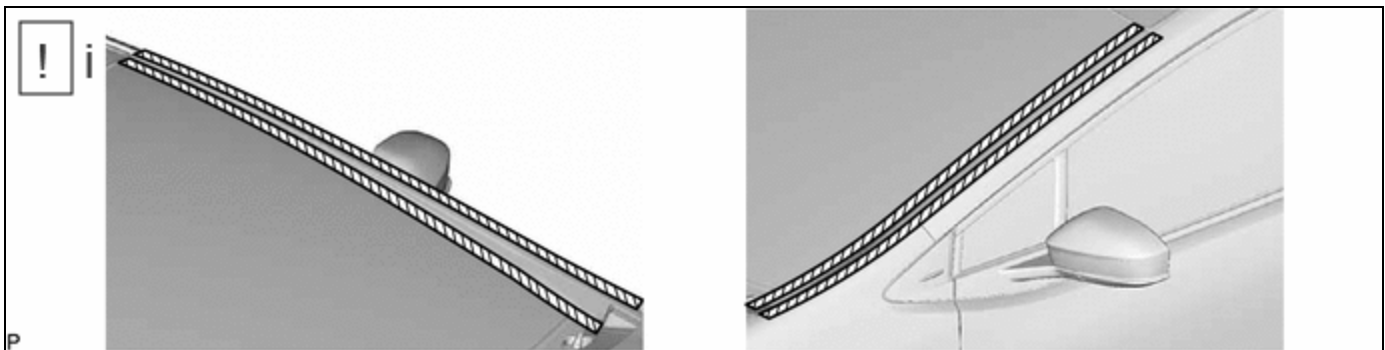

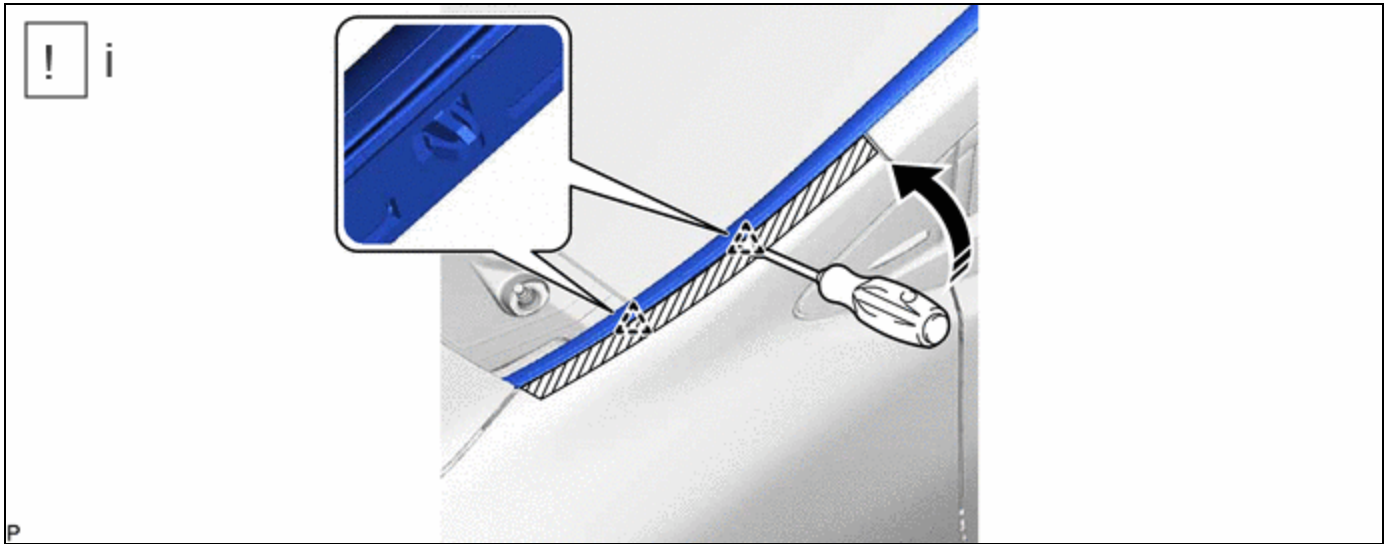

(1) Apply protective tape around the windshield lower outside moulding as shown in the illustration.

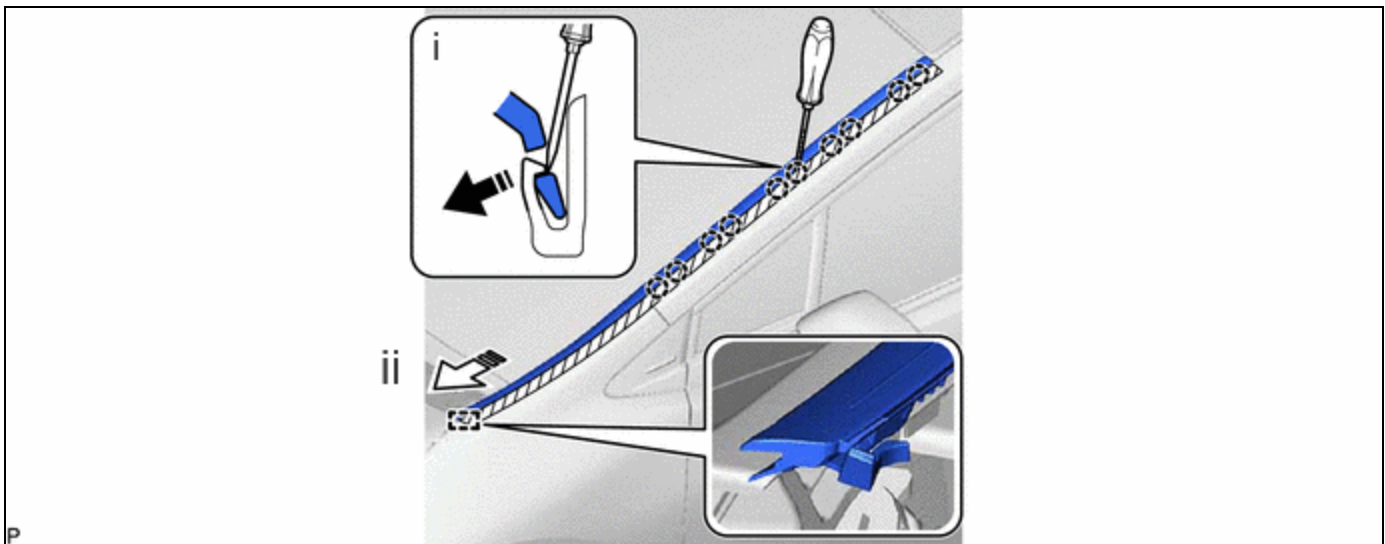

	Remove in this Direction	-	-
---	--------------------------	---	---

(1) Using a clip remover, disengage the 2 clips as shown in the illustration.



	Remove in this Direction (1)		Remove in this Direction (2)
---	------------------------------	---	------------------------------

(1) Using a screwdriver with its tip wrapped with protective tape, disengage the 10 claws as shown in the illustration.

(2) Disengage the guide and remove the windshield lower outside moulding as shown in the illustration

**2. REMOVE NO. 2 WINDSHIELD OUTSIDE MOULDING CLIP**

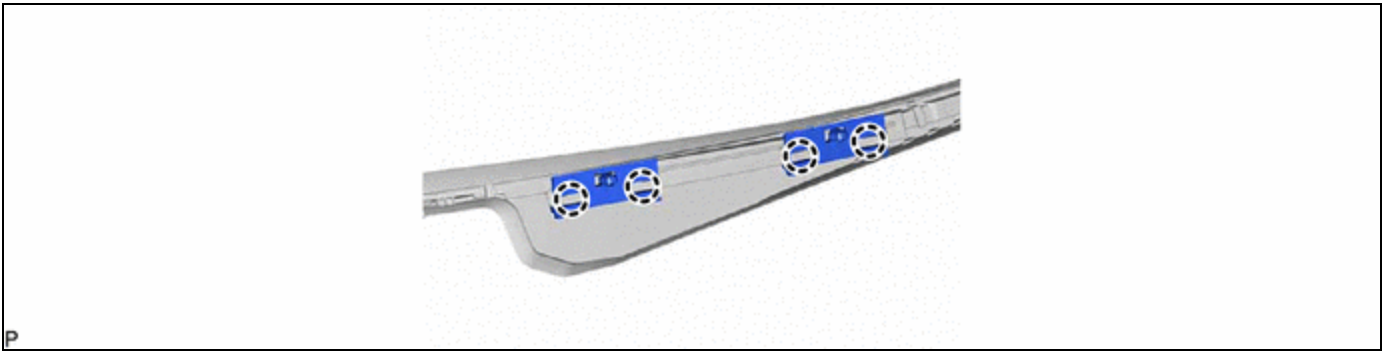

### 3. REMOVE WINDSHIELD GLASS SUB-ASSEMBLY

**HINT:**

Perform the following procedure only when replacement of the No. 1 windshield outside moulding clip is necessary.

Click here [INFO](#)

### 4. REMOVE NO. 1 WINDSHIELD OUTSIDE MOULDING CLIP

**HINT:**

Perform the following procedure only when replacement of the No. 1 windshield outside moulding clip is necessary.

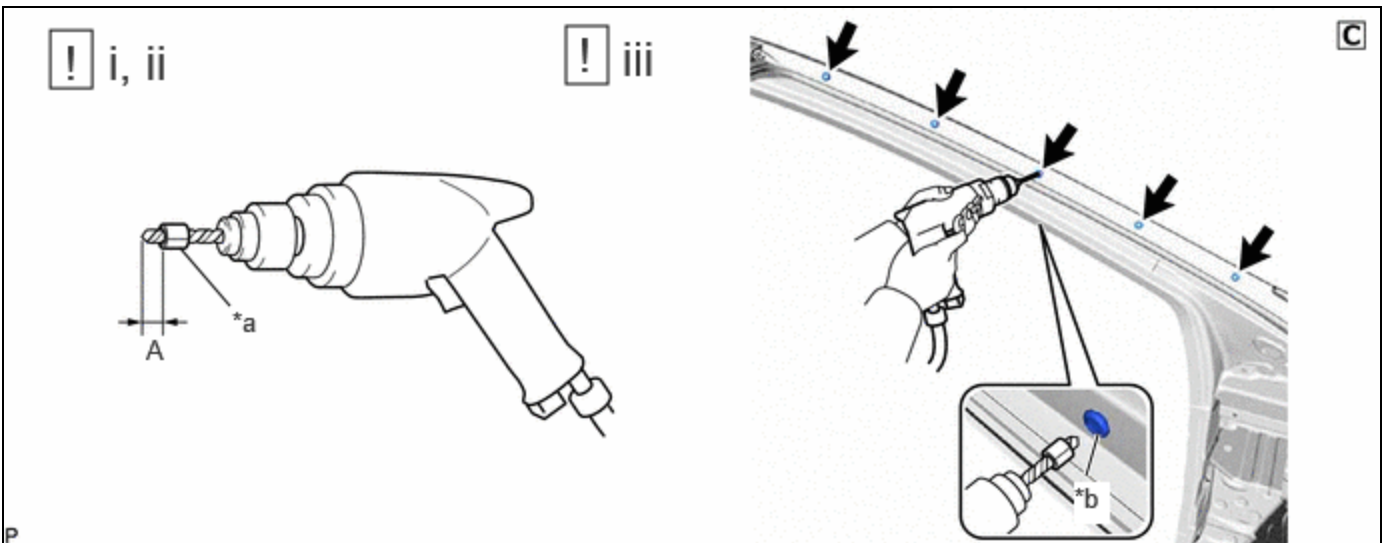

*a	Tape	*b	Flange
----	------	----	--------

- (1) Insert a 4.0 mm (0.157 in.) drill bit into a drill.
  - (2) Tape the 4.0 mm (0.157 in.) drill bit 5.0 mm (0.197 in.) from the tip as shown in the illustration.
- Standard Measurement:

AREA	MEASUREMENT	AREA	MEASUREMENT
A	5.0 mm (0.197 in.)	-	-

**NOTICE:**

Tape the 4.0 mm (0.157 in.) drill bit to prevent the drill bit from going too deep.

- (3) Lightly press the drill against the rivets to drill off the rivet flanges, and remove the 5 rivets.

**CAUTION:**

Be careful of the drilled rivets, as they may be hot.

**NOTICE:**

- Pressing the drill too firmly will cause the rivet to turn and result in the rivet not being drilled through.
- Prying the rivets with the drill may damage the rivet installation holes or drill bit.

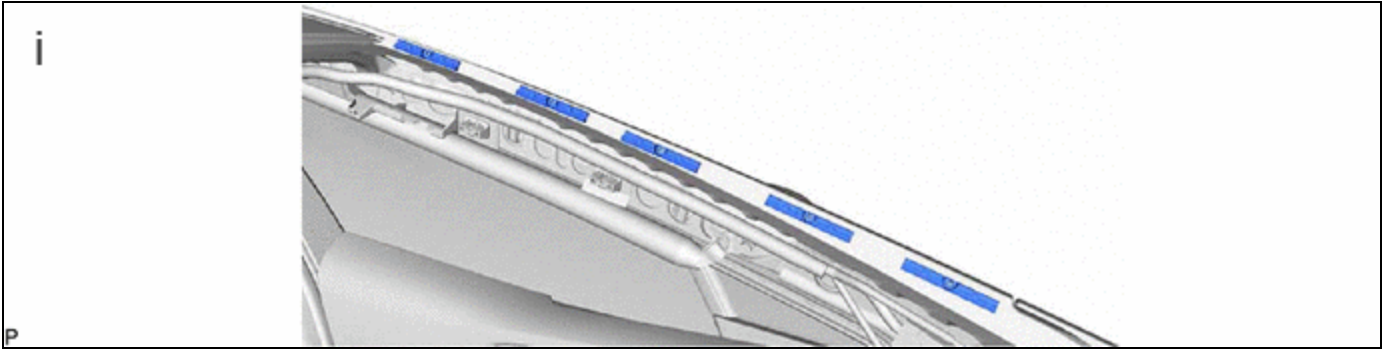

(1) Remove the 5 No. 1 windshield outside moulding clips.

