

Last Modified: 12-04-2024	6.11:8.1.0	Doc ID: RM100000002B1HE
Model Year Start: 2023	Model: Prius Prime	Prod Date Range: [03/2023 -]
Title: EXTERIOR PANELS / TRIM: NAME PLATE: INSTALLATION; 2023 - 2024 MY Prius Prius Prime [03/2023 -]		

INSTALLATION

CAUTION / NOTICE / HINT

COMPONENTS (INSTALLATION)

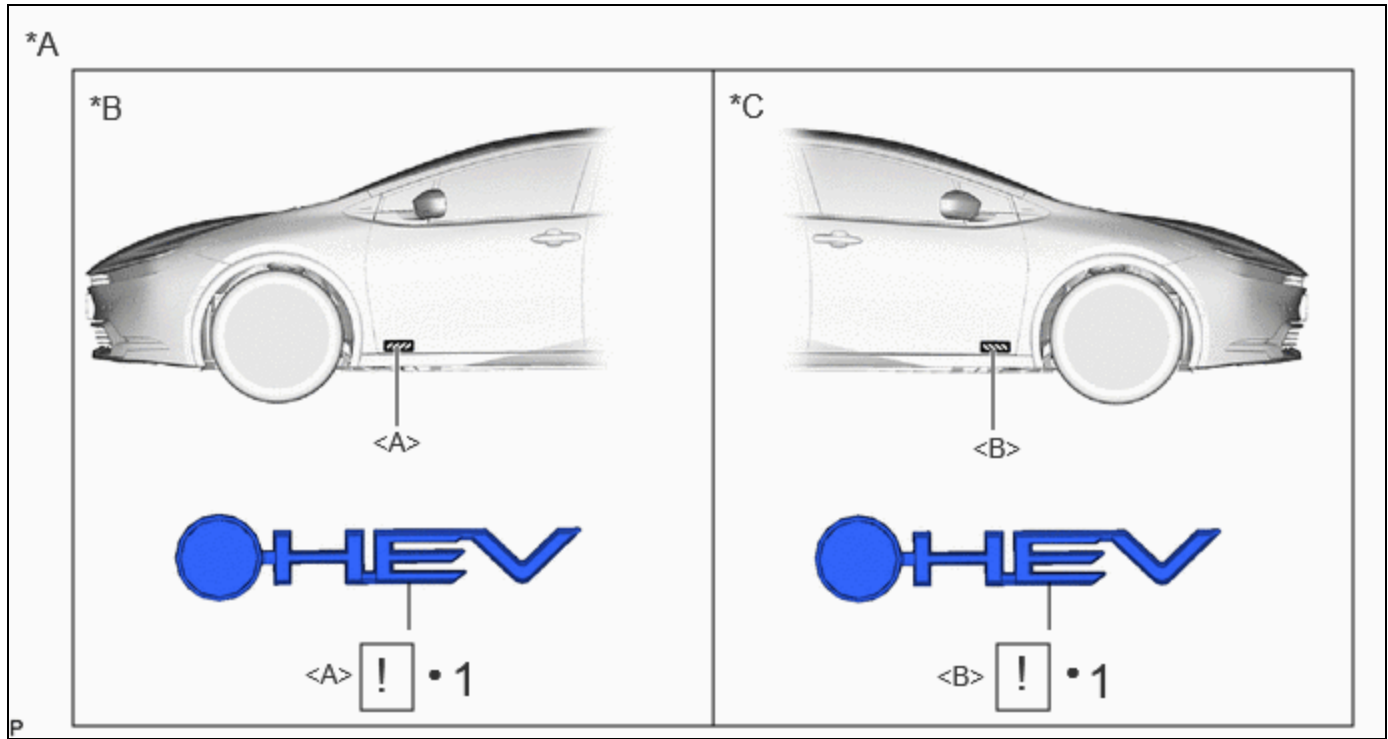

	PROCEDURE	PART NAME CODE			
1	SIDE PANEL EMBLEM	75374	INFO	-	-

*A	w/ Side Panel Emblem	*B	for LH Side
*C	for RH Side	-	-
•	Non-reusable part	-	-

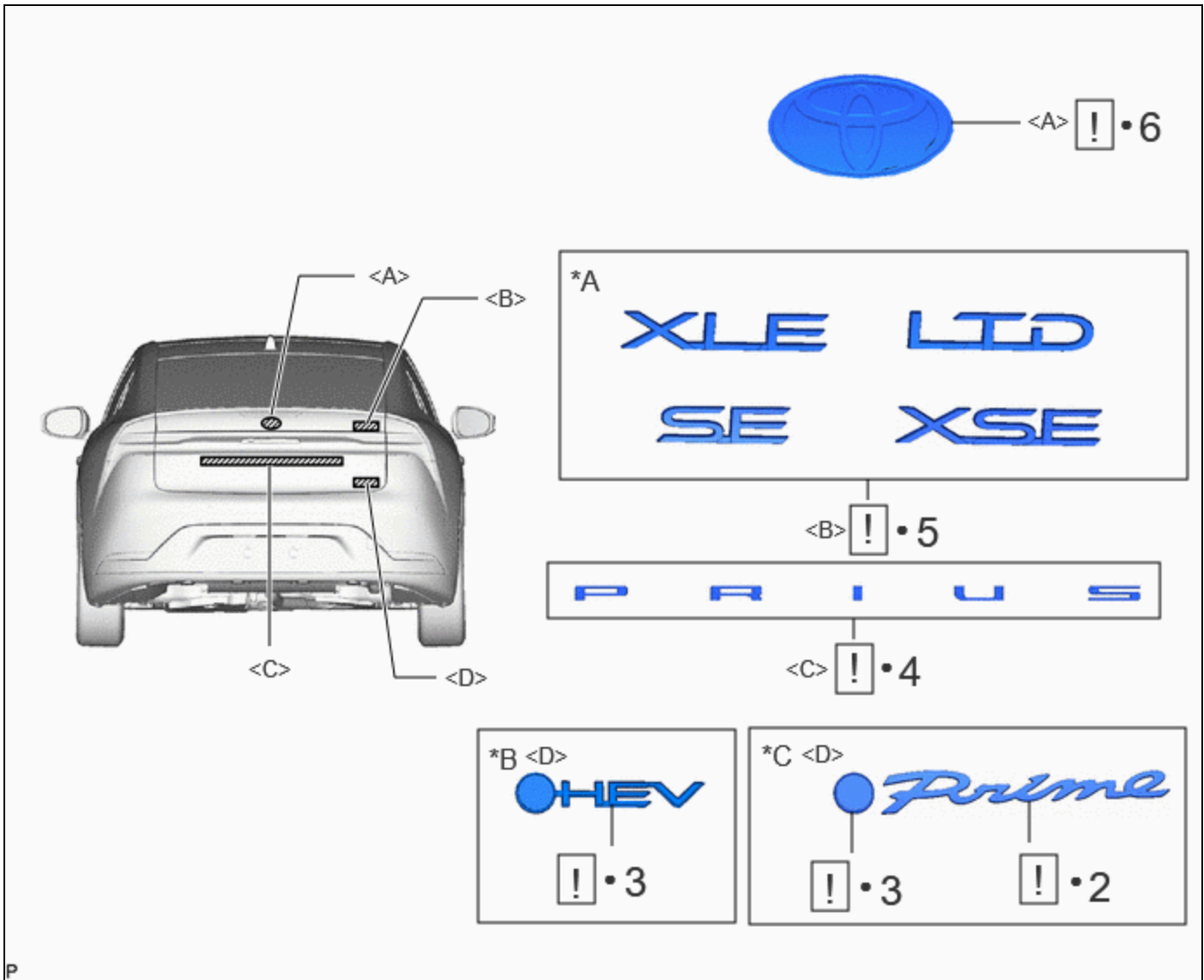

PROCEDURE		PART NAME CODE	!		
2	NO. 2 BACK DOOR NAME PLATE	75442A	INFO	-	-
3	NO. 3 BACK DOOR EMBLEM	75443	INFO	-	-
4	NO. 1 BACK DOOR NAME PLATE	75441E	INFO	-	-
5	NO. 4 BACK DOOR NAME PLATE	75444A	INFO	-	-
6	NO. 1 BACK DOOR EMBLEM	75431A	INFO	-	-

*A	w/ No. 4 Back Door Name Plate	*B	for HEV Model
*C	for PHEV Model	-	-
•	Non-reusable part	-	-

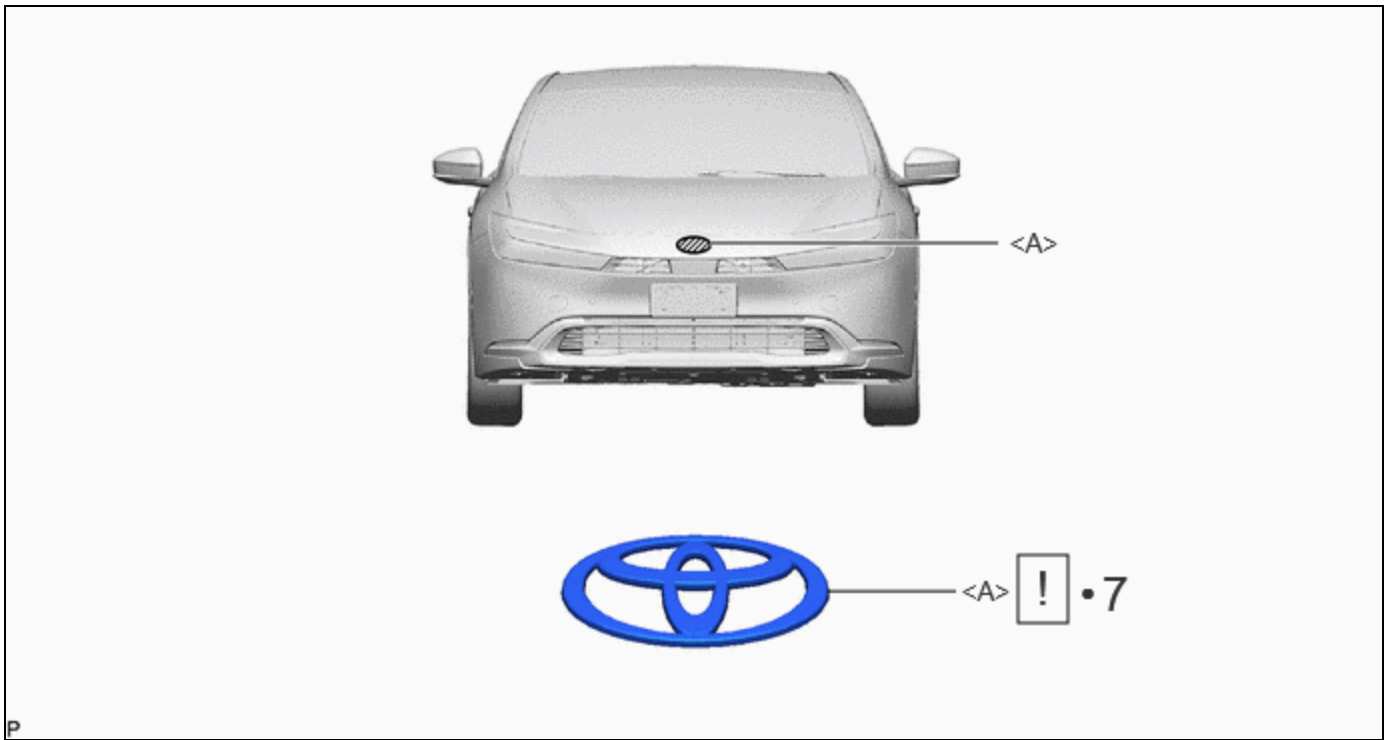

PROCEDURE		PART NAME CODE			
7	RADIATOR GRILLE (OR FRONT PANEL) EMBLEM	75311	INFO	-	-



•	Non-reusable part	-	-
---	-------------------	---	---

PROCEDURE

1. INSTALL SIDE PANEL EMBLEM (w/ Side Panel Emblem)

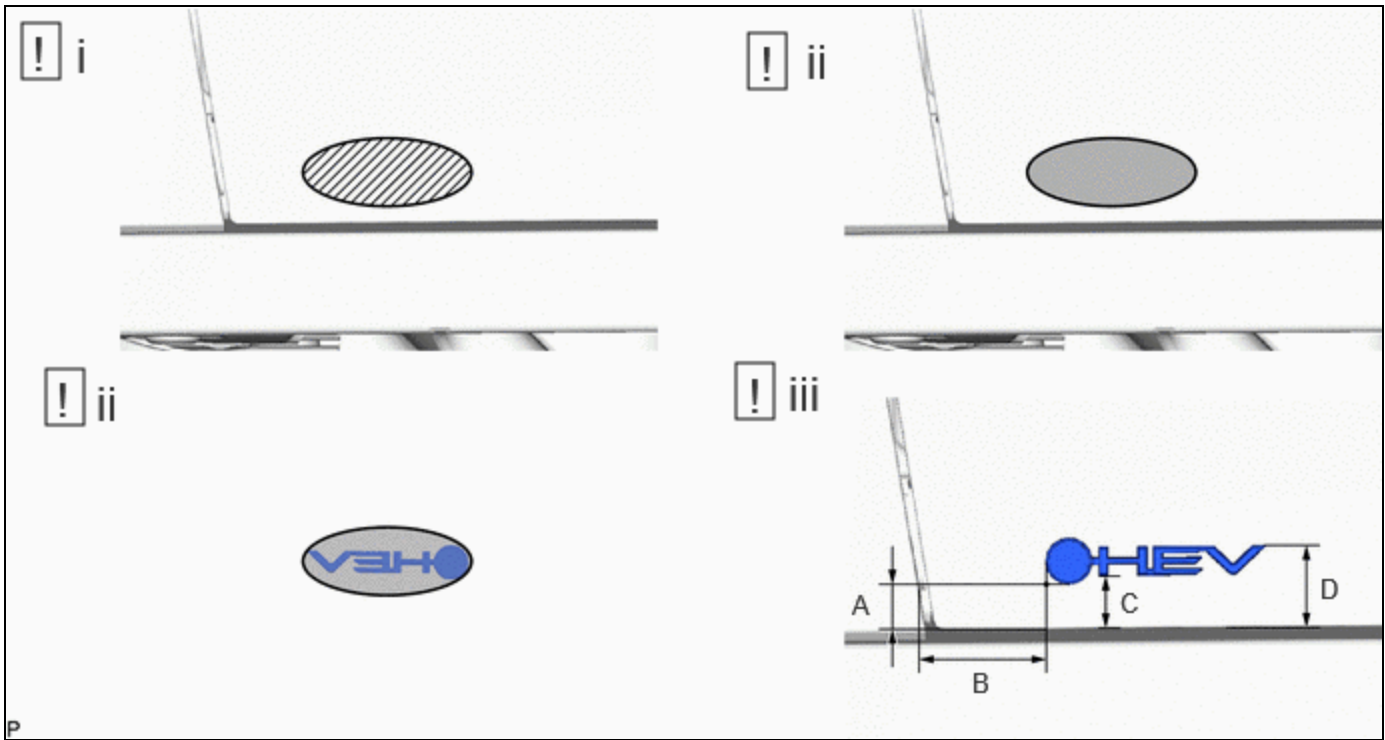
(a) for LH Side:



	Cleaning Area		Heating Area
-----------------------------------------------------------------------------------	---------------	-----------------------------------------------------------------------------------	--------------

Standard Measurement:

AREA	MEASUREMENT	AREA	MEASUREMENT
A	19.5 mm (0.768 in.)	B	52.1 mm (2.05 in.)
C	23.2 mm (0.913 in.)	D	36.7 mm (1.44 in.)

(1) Clean the front door panel surface.

- Using a heat light, heat the double-sided tape remaining on the front door panel and side panel emblem.

Heating Temperature

AREA	TEMPERATURE	AREA	TEMPERATURE
Front Door Panel	40 to 60°C (104 to 140°F)	Side Panel Emblem	20 to 30 °C (68 to 86 °F)

CAUTION:

- Do not touch the heat light and heated parts, touching the heat light may result in burns.
- Touching heated parts for a long time may result in burns.

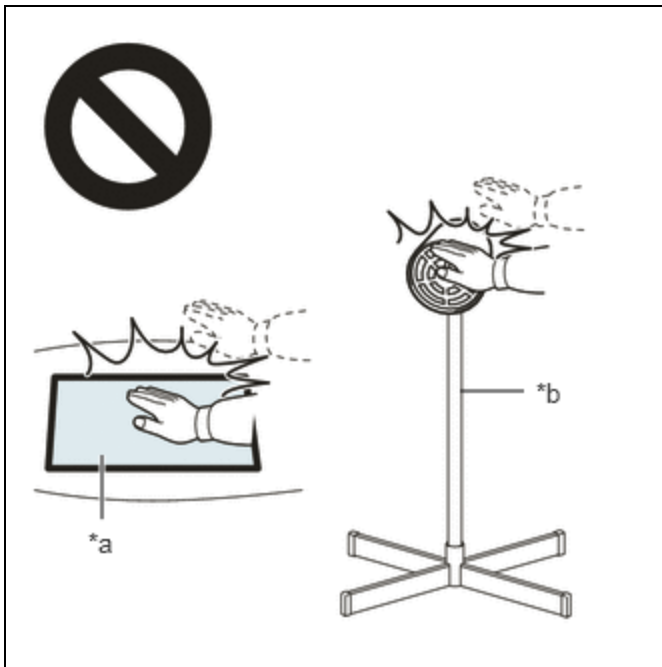

*a	Heated Part
*b	Heat Light

NOTICE:

Do not heat the front door panel excessively.

2. Remove any remaining double-sided tape from the front door panel.
 3. Wipe off any tape adhesive residue with cleaner.
- (2) Using a heat light, heat the front door panel and a new side panel emblem.
- (3) Install a new side panel emblem.
1. Using a heat light, heat the front door panel surface.
 2. Remove the release paper from the side panel emblem.

HINT:

After removing the release paper, keep the exposed adhesive free from foreign matter.

3. Install the side panel emblem as shown in the illustration.

HINT:

Press the side panel emblem firmly to install it.

(b) for RH Side:

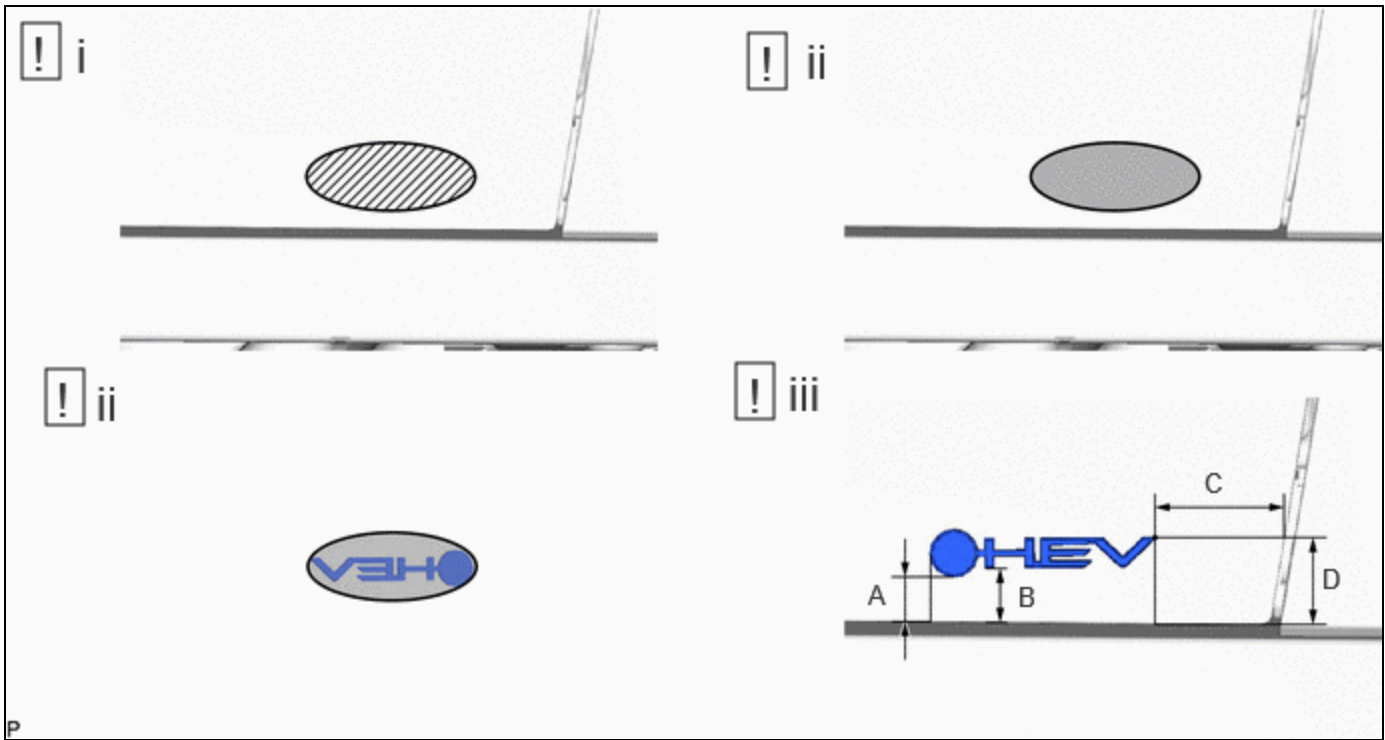

	Cleaning Area		Heating Area
--	---------------	--	--------------

Standard Measurement:

AREA	MEASUREMENT	AREA	MEASUREMENT
A	18.8 mm (0.74 in.)	B	22.9 mm (0.902 in.)
C	54.8 mm (2.16 in.)	D	37.6 mm (1.48 in.)

(1) Clean the front door panel surface.

1. Using a heat light, heat the double-sided tape remaining on the front door panel and side panel emblem.

Heating Temperature

AREA	TEMPERATURE	AREA	TEMPERATURE
Front Door Panel	40 to 60°C (104 to 140°F)	Side Panel Emblem	20 to 30 °C (68 to 86 °F)

CAUTION:

- Do not touch the heat light and heated parts, touching the heat light may result in burns.
- Touching heated parts for a long time may result in burns.

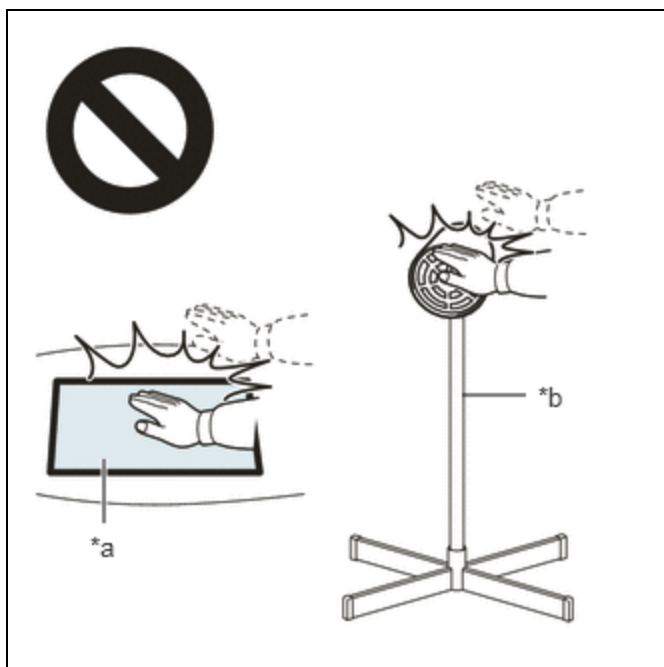

*a	Heated Part
*b	Heat Light

NOTICE:

Do not heat the front door panel excessively.

2. Remove any remaining double-sided tape from the front door panel.
 3. Wipe off any tape adhesive residue with cleaner.
- (2) Using a heat light, heat the front door panel and a new side panel emblem.
- (3) Install a new side panel emblem.
1. Using a heat light, heat the front door panel surface.
 2. Remove the release paper from the side panel emblem.

HINT:

After removing the release paper, keep the exposed adhesive free from foreign matter.



3. Install the side panel emblem as shown in the illustration.

HINT:

Press the side panel emblem firmly to install it.

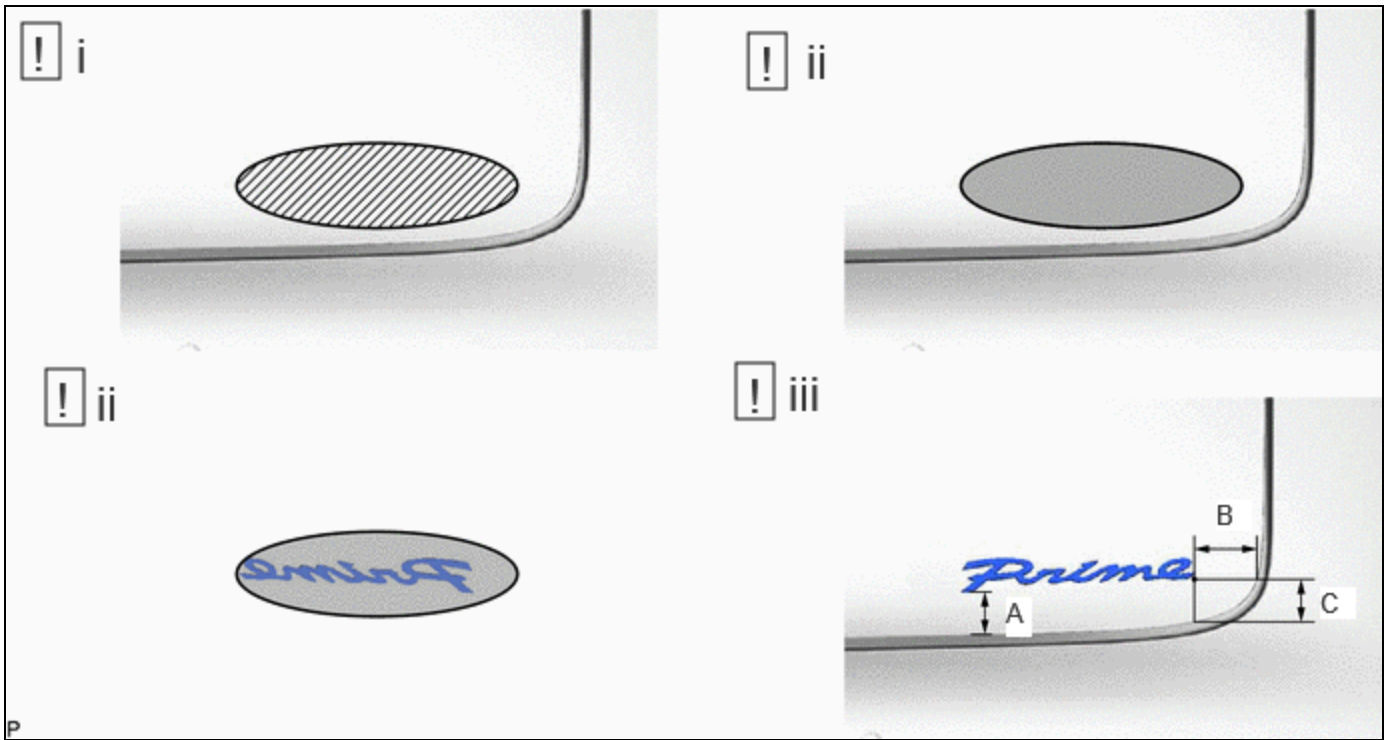
2. INSTALL NO. 2 BACK DOOR NAME PLATE (for PHEV Model)



	Cleaning Area		Heating Area
-----------------------------------------------------------------------------------	---------------	-----------------------------------------------------------------------------------	--------------

Standard Measurement:

AREA	MEASUREMENT	AREA	MEASUREMENT
A	29.8 mm (1.17 in.)	B	39.5 mm (1.56 in.)
C	28.7 mm (1.13 in.)	-	-

(1) Clean the back door panel surface.

- Using a heat light, heat the double-sided tape remaining on the back door panel and No. 2 back door name plate.

Heating Temperature

AREA	TEMPERATURE	AREA	TEMPERATURE
Back Door Panel	40 to 60°C (104 to 140°F)	No. 2 Back Door Name Plate	20 to 30 °C (68 to 86 °F)

CAUTION:

- Do not touch the heat light and heated parts, touching the heat light may result in burns.
- Touching heated parts for a long time may result in burns.

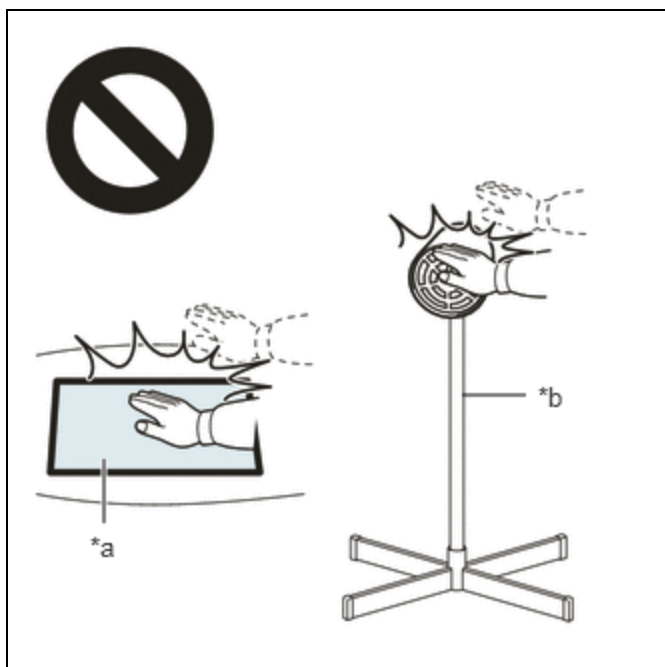

*a	Heated Part
*b	Heat Light

NOTICE:

Do not heat the back door panel excessively.

2. Remove any remaining double-sided tape from the back door panel.
 3. Wipe off any tape adhesive residue with cleaner.
- (2) Using a heat light, heat the back door panel and a new No. 2 back door name plate.
- (3) Install a new No. 2 back door name plate.
1. Using a heat light, heat the back door panel surface.
 2. Remove the release paper from the No. 2 back door name plate.

HINT:

After removing the release paper, keep the exposed adhesive free from foreign matter.

3. Install the No. 2 back door name plate as shown in the illustration.



HINT:

Press the No. 2 back door name plate firmly to install it.

3. INSTALL NO. 3 BACK DOOR EMBLEM

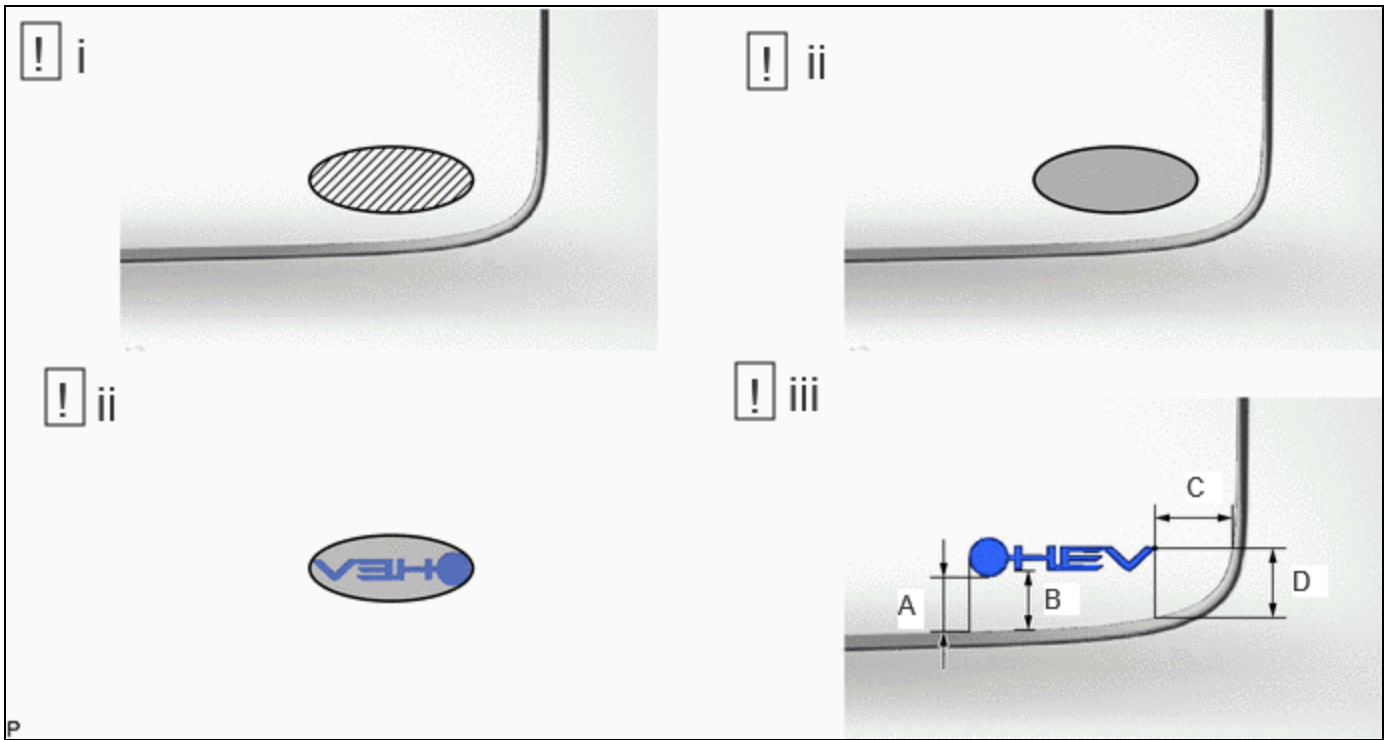
(a) for HEV Model:



	Cleaning Area		Heating Area
-----------------------------------------------------------------------------------	---------------	-----------------------------------------------------------------------------------	--------------

Standard Measurement:

AREA	MEASUREMENT	AREA	MEASUREMENT
A	30.2 mm (1.19 in.)	B	33.0 mm (1.3 in.)
C	39.7 mm (1.56 in.)	D	39.0 mm (1.54 in.)

(1) Clean the back door panel surface.

- Using a heat light, heat the double-sided tape remaining on the back door panel and No. 3 back door emblem.

Heating Temperature

AREA	TEMPERATURE	AREA	TEMPERATURE
Back Door Panel	40 to 60°C (104 to 140°F)	No. 3 Back Door Emblem	20 to 30 °C (68 to 86 °F)

CAUTION:

- Do not touch the heat light and heated parts, touching the heat light may result in burns.
- Touching heated parts for a long time may result in burns.

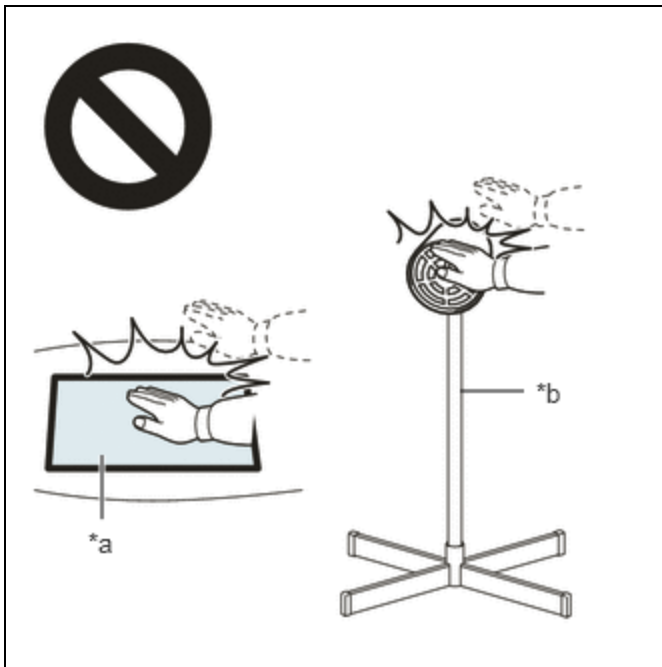

*a	Heated Part
*b	Heat Light

NOTICE:

Do not heat the back door panel excessively.

2. Remove any remaining double-sided tape from the back door panel.
 3. Wipe off any tape adhesive residue with cleaner.
- (2) Using a heat light, heat the back door panel and a new No. 3 back door emblem.
- (3) Install a new No. 3 back door emblem.
1. Using a heat light, heat the back door panel surface.
 2. Remove the release paper from the No. 3 back door emblem.

HINT:

After removing the release paper, keep the exposed adhesive free from foreign matter.



3. Install the No. 3 back door emblem as shown in the illustration.

HINT:

Press the No. 3 back door emblem firmly to install it.

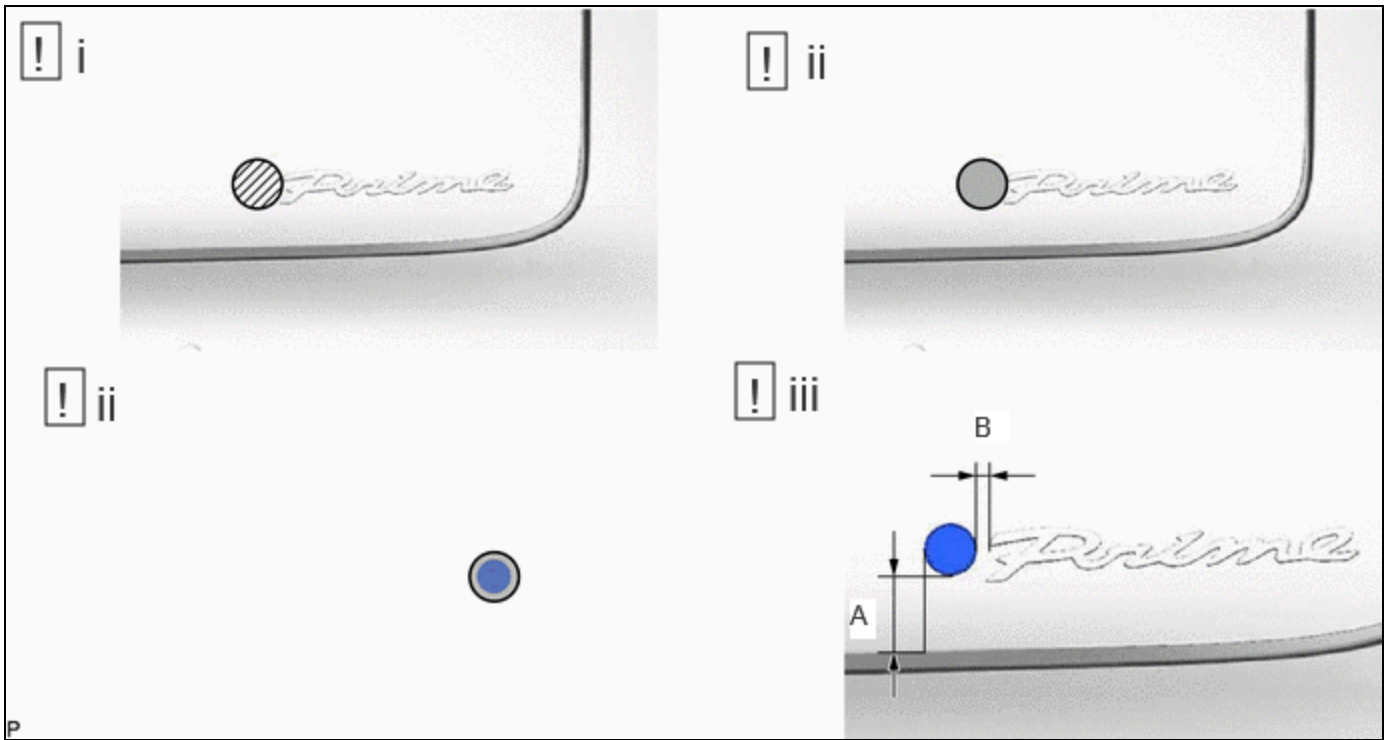
(b) for PHEV Model:



	Cleaning Area		Heating Area
-----------------------------------------------------------------------------------	---------------	-----------------------------------------------------------------------------------	--------------

Standard Measurement:

AREA	MEASUREMENT	AREA	MEASUREMENT
A	31.6 mm (1.24 in.)	B	4.9 mm (0.193 in.)

(1) Clean the back door panel surface.

- Using a heat light, heat the double-sided tape remaining on the back door panel and No. 3 back door emblem.

Heating Temperature

AREA	TEMPERATURE	AREA	TEMPERATURE
Back Door Panel	40 to 60°C (104 to 140°F)	No. 3 Back Door Emblem	20 to 30 °C (68 to 86 °F)

CAUTION:

- Do not touch the heat light and heated parts, touching the heat light may result in burns.
- Touching heated parts for a long time may result in burns.

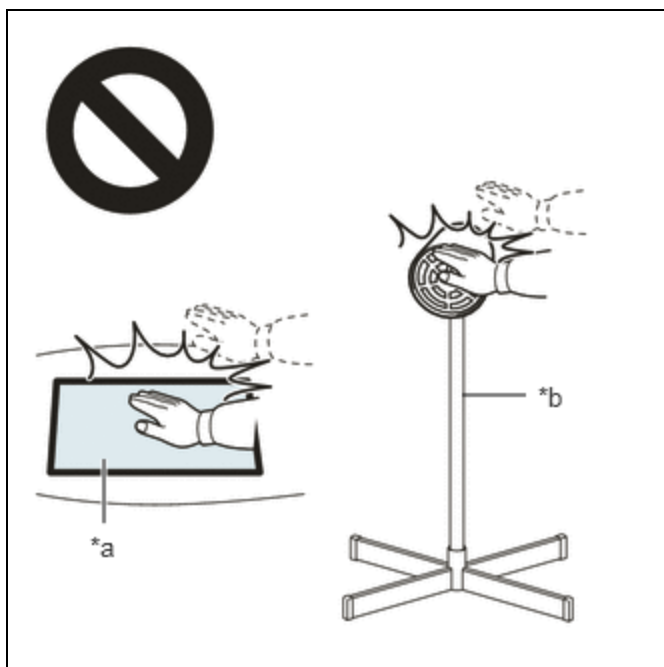

*a	Heated Part
*b	Heat Light

NOTICE:

Do not heat the back door panel excessively.

2. Remove any remaining double-sided tape from the back door panel.
 3. Wipe off any tape adhesive residue with cleaner.
- (2) Using a heat light, heat the back door panel and a new No. 3 back door emblem.
- (3) Install a new No. 3 back door emblem.
1. Using a heat light, heat the back door panel surface.
 2. Remove the release paper from the No. 3 back door emblem.

HINT:

After removing the release paper, keep the exposed adhesive free from foreign matter.



3. Install the No. 3 back door emblem as shown in the illustration.

HINT:

Press the No. 3 back door emblem firmly to install it.

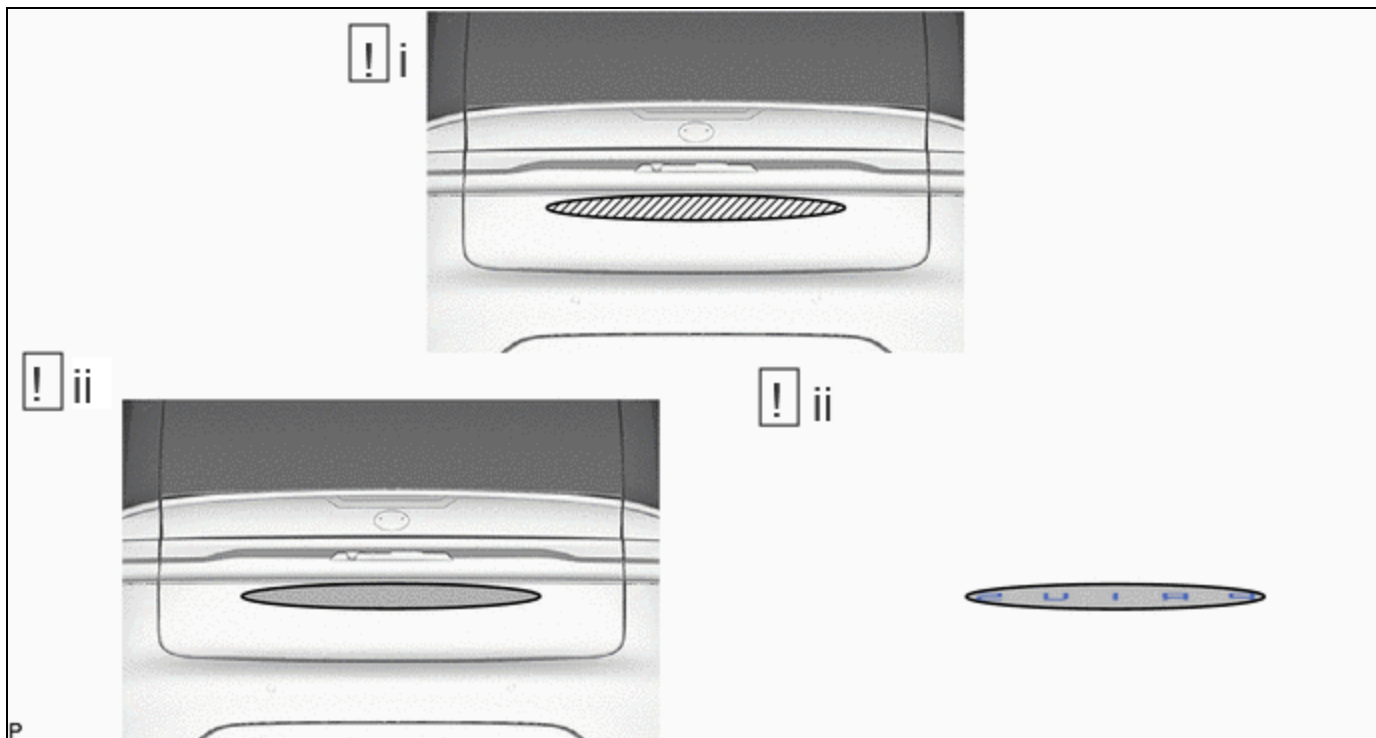
4. INSTALL NO. 1 BACK DOOR NAME PLATE



	Cleaning Area		Heating Area
-----------------------------------------------------------------------------------	---------------	-----------------------------------------------------------------------------------	--------------

(1) Clean the back door panel surface.

- Using a heat light, heat the double-sided tape remaining on the back door panel and No. 1 back door name plate.

Heating Temperature

AREA	TEMPERATURE	AREA	TEMPERATURE
Back Door Panel	40 to 60°C (104 to 140°F)	No. 1 Back Door Name Plate	20 to 30 °C (68 to 86 °F)

CAUTION:

- Do not touch the heat light and heated parts, touching the heat light may result in burns.
- Touching heated parts for a long time may result in burns.

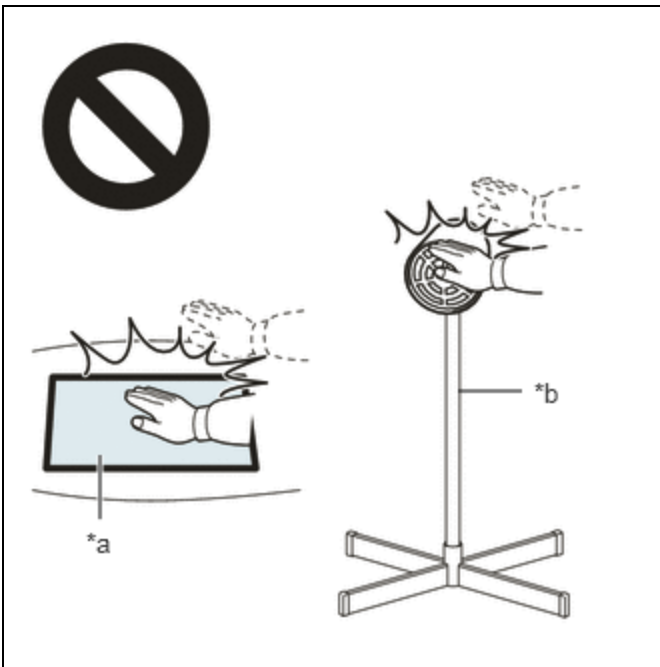

*a	Heated Part
*b	Heat Light

NOTICE:

Do not heat the back door panel excessively.

2. Remove any remaining double-sided tape from the back door panel.
3. Wipe off any tape adhesive residue with cleaner.

(2) Using a heat light, heat the back door panel and a new No. 1 back door name plate.

(b) Install a new No. 1 back door name plate.

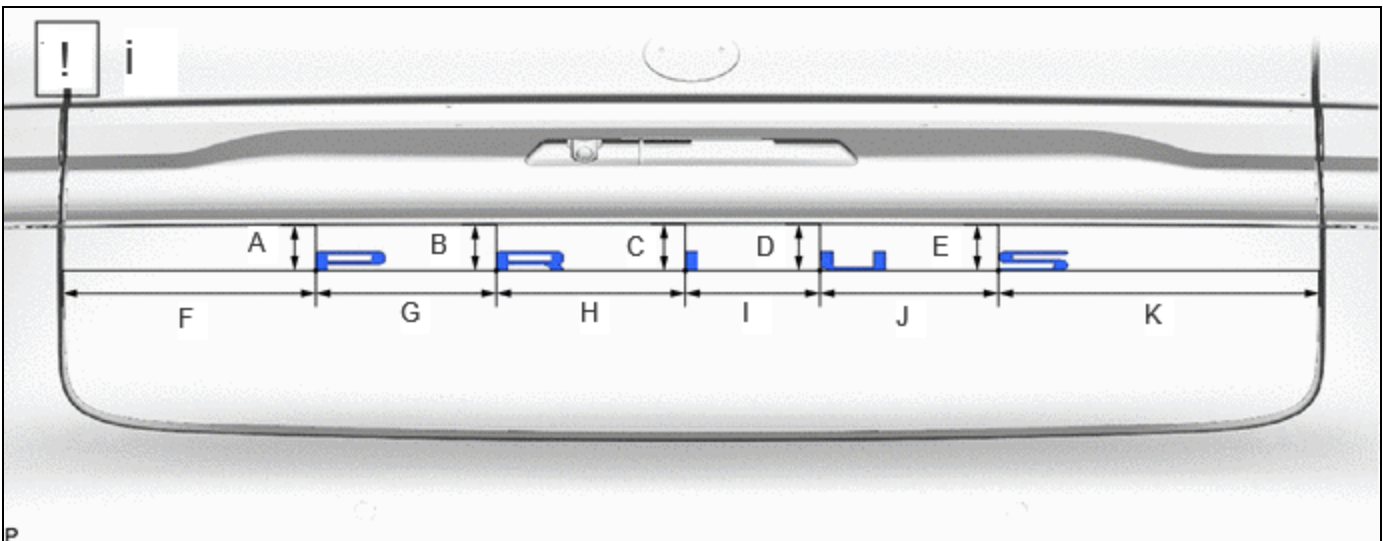

Standard Measurement:

AREA	MEASUREMENT	AREA	MEASUREMENT
A	35.8 mm (1.41 in.)	B	36.2 mm (1.43 in.)
C	36.4 mm (1.43 in.)	D	36.3 mm (1.43 in.)
E	36.0 mm (1.42 in.)	F	213.6 mm (8.41 in.)

AREA	MEASUREMENT	AREA	MEASUREMENT
G	152.6 mm (6.01 in.)	H	159.6 mm (6.28 in.)
I	114.8 mm (4.52 in.)	J	150.1 mm (5.91 in.)
K	272.1 mm (10.7 in.)	-	-

- (1) 1. Using a heat light, heat the back door panel surface.
2. Remove the release paper from the No. 1 back door name plate.

HINT:

After removing the release paper, keep the exposed adhesive free from foreign matter.

3. Install the No. 1 back door name plate as shown in the illustration.



HINT:

Press the No. 1 back door name plate firmly to install it.

5. INSTALL NO. 4 BACK DOOR NAME PLATE (w/ No. 4 Back Door Name Plate)

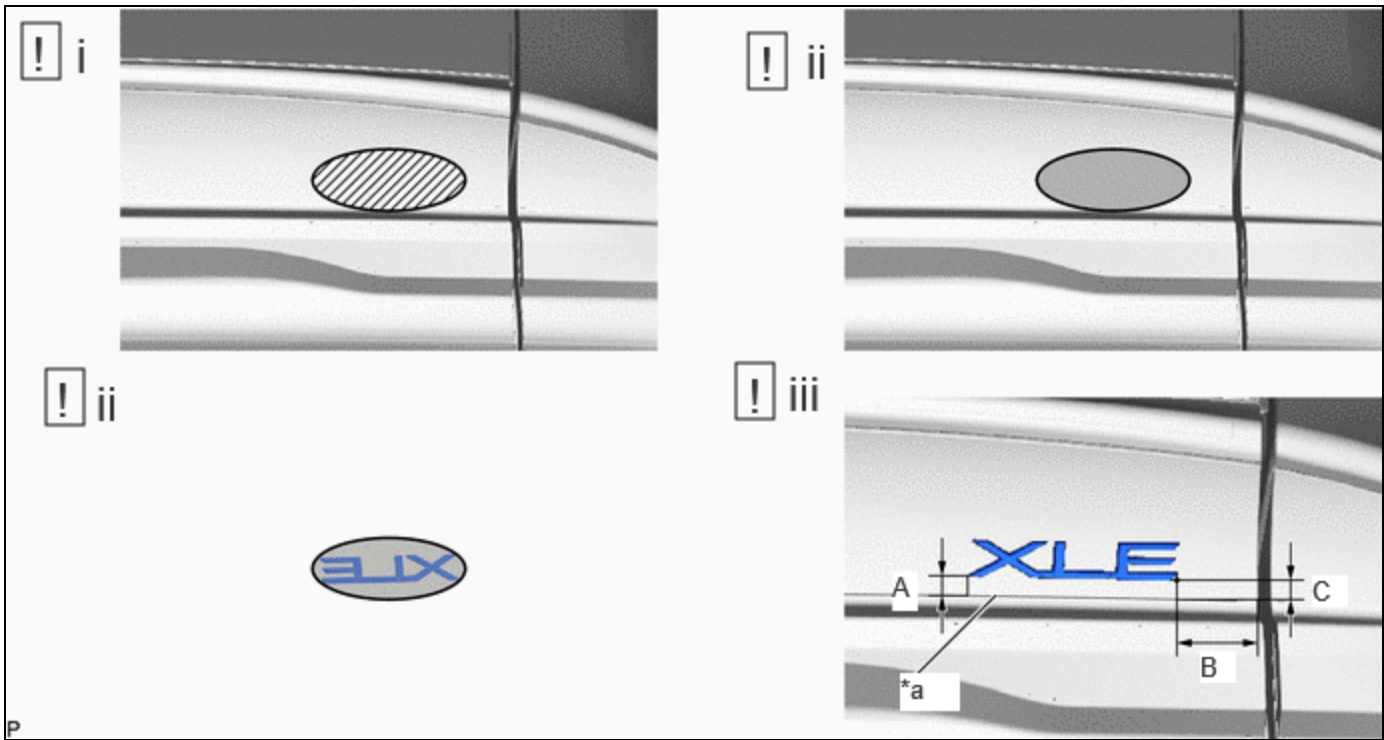
(a) for XLE Plate:



*a	R End	-	-
	Cleaning Area		Heating Area

Standard Measurement:

AREA	MEASUREMENT	AREA	MEASUREMENT
A	6.7 mm (0.264 in.)	B	36.9 mm (1.45 in.)
C	7.1 mm (0.28 in.)	-	-

- (1) Clean the No. 4 back door name plate surface.

- Using a heat light, heat the double-sided tape remaining on the rear light assembly and No. 4 back door name plate.

Heating Temperature

AREA	TEMPERATURE	AREA	TEMPERATURE
Rear Light Assembly	20 to 30 °C (68 to 86 °F)	No. 4 Back Door Name Plate	20 to 30 °C (68 to 86 °F)

CAUTION:

- Do not touch the heat light and heated parts, touching the heat light may result in burns.
- Touching heated parts for a long time may result in burns.

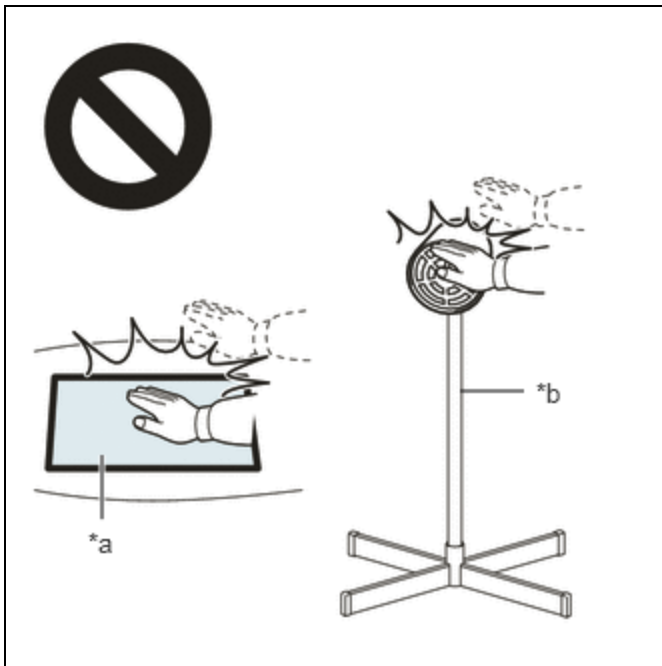

*a	Heated Part
*b	Heat Light

NOTICE:

Do not heat the back door name plate excessively.

- Remove any remaining double-sided tape from the rear light assembly.
 - Wipe off any tape adhesive residue with cleaner.
- (2) Using a heat light, heat the rear light assembly and a new No. 4 back door name plate.
- (3) Install a new No. 4 back door name plate.
- Using a heat light, heat the back door name plate surface.
 - Remove the release paper from the No. 4 back door name plate.

HINT:

After removing the release paper, keep the exposed adhesive free from foreign matter.



- Install the No. 4 back door name plate as shown in the illustration.

HINT:

Press the No. 2 back door emblem firmly to install it.

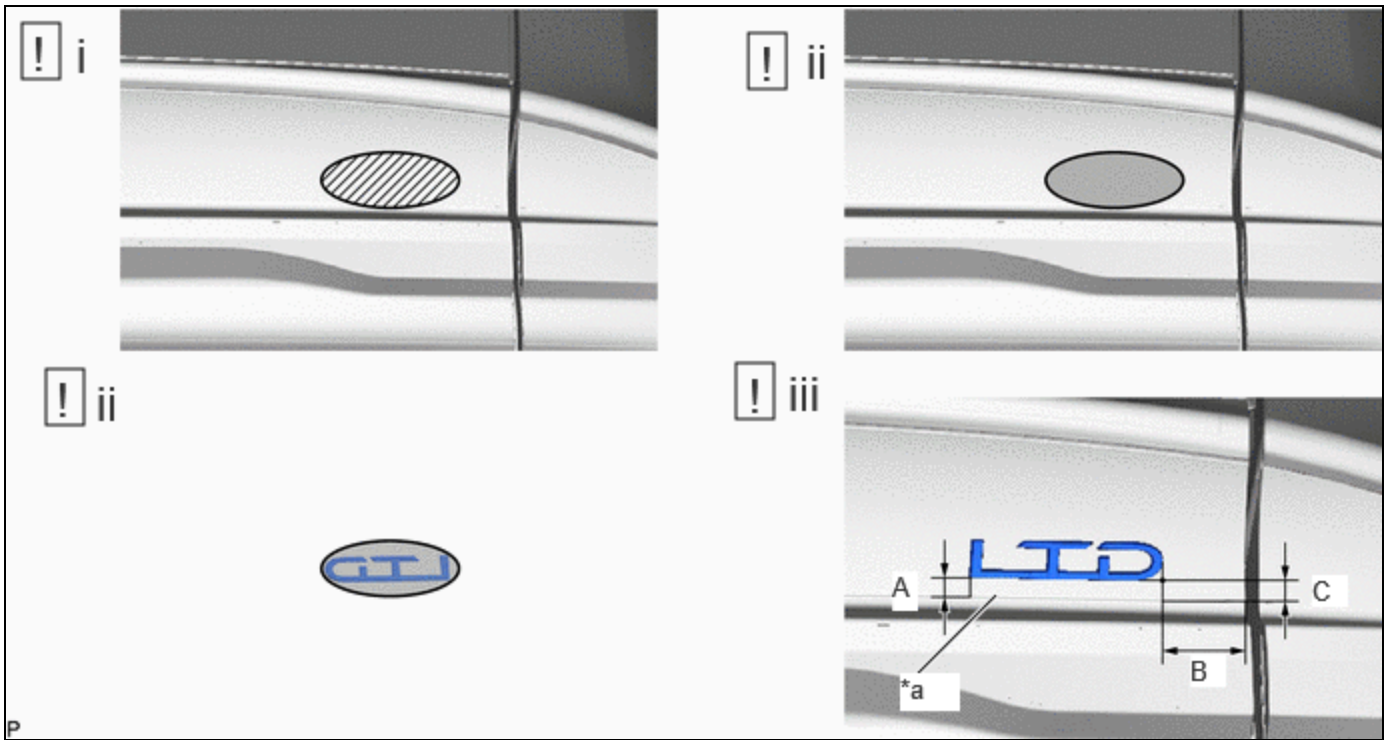
- (b) for LTD Plate:



*a	R End	-	-
	Cleaning Area		Heating Area

Standard Measurement:

AREA	MEASUREMENT	AREA	MEASUREMENT
A	6.7 mm (0.264 in.)	B	36.9 mm (1.45 in.)
C	7.1 mm (0.28 in.)	-	-

(1) Clean the No. 4 back door name plate surface.

- Using a heat light, heat the double-sided tape remaining on the rear light assembly and No. 4 back door name plate.

Heating Temperature

AREA	TEMPERATURE	AREA	TEMPERATURE
Rear Light Assembly	20 to 30 °C (68 to 86 °F)	No. 4 Back Door Name Plate	20 to 30 °C (68 to 86 °F)

CAUTION:

- Do not touch the heat light and heated parts, touching the heat light may result in burns.
- Touching heated parts for a long time may result in burns.

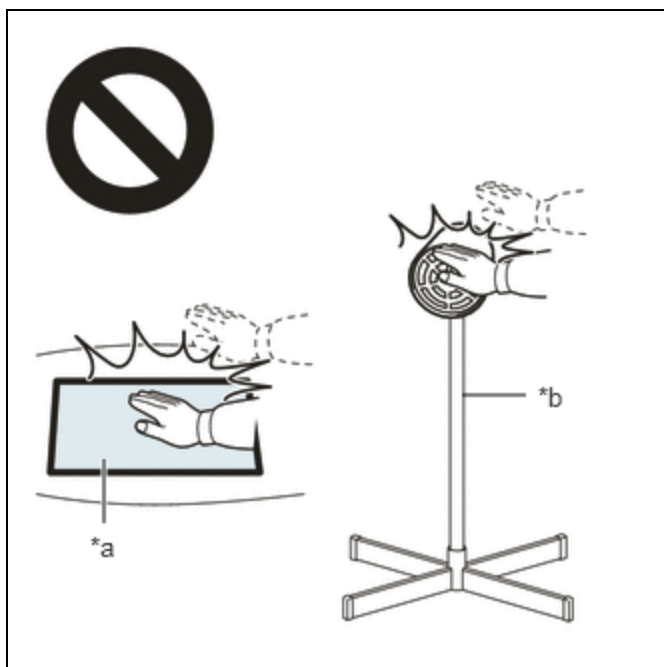
**NOTICE:**

Do not heat the back door name plate excessively.

2. Remove any remaining double-sided tape from the rear light assembly.
 3. Wipe off any tape adhesive residue with cleaner.
- (2) Using a heat light, heat the rear light assembly and a new No. 4 back door name plate.
- (3) Install a new No. 4 back door name plate.
1. Using a heat light, heat the back door name plate surface.
 2. Remove the release paper from the No. 4 back door name plate.

HINT:

After removing the release paper, keep the exposed adhesive free from foreign matter.

3. Install the No. 4 back door name plate as shown in the illustration.

HINT:

Press the No. 2 back door emblem firmly to install it.

(c) for SE Plate:

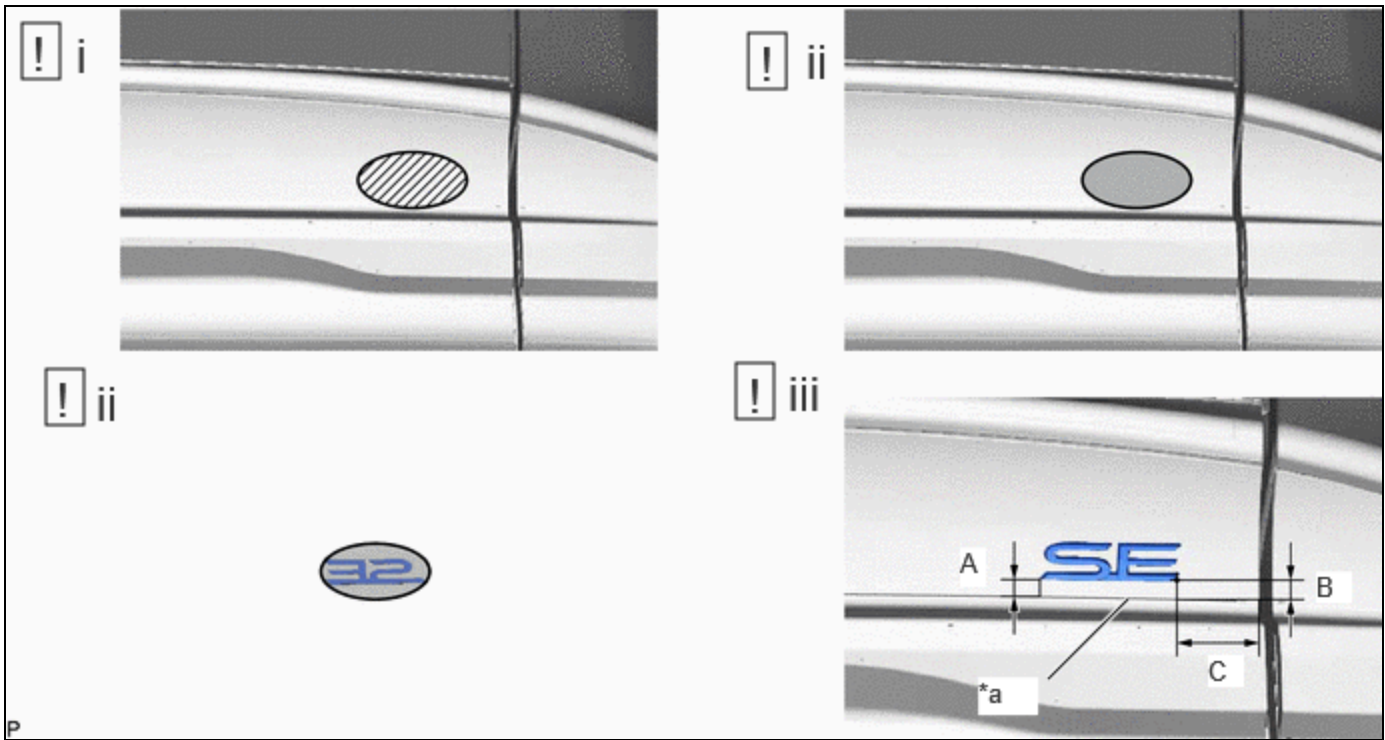

*a	R End	-	-
	Cleaning Area		Heating Area

Standard Measurement:

AREA	MEASUREMENT	AREA	MEASUREMENT
A	6.7 mm (0.264 in.)	B	7.1 mm (0.28 in.)
C	36.9 mm (1.45 in.)	-	-

(1) Clean the No. 4 back door name plate surface.

1. Using a heat light, heat the double-sided tape remaining on the rear light assembly and No. 4 back door name plate.

Heating Temperature

AREA	TEMPERATURE	AREA	TEMPERATURE
Rear Light Assembly	20 to 30 °C (68 to 86 °F)	No. 4 Back Door Name Plate	20 to 30 °C (68 to 86 °F)

CAUTION:

- Do not touch the heat light and heated parts, touching the heat light may result in burns.
- Touching heated parts for a long time may result in burns.

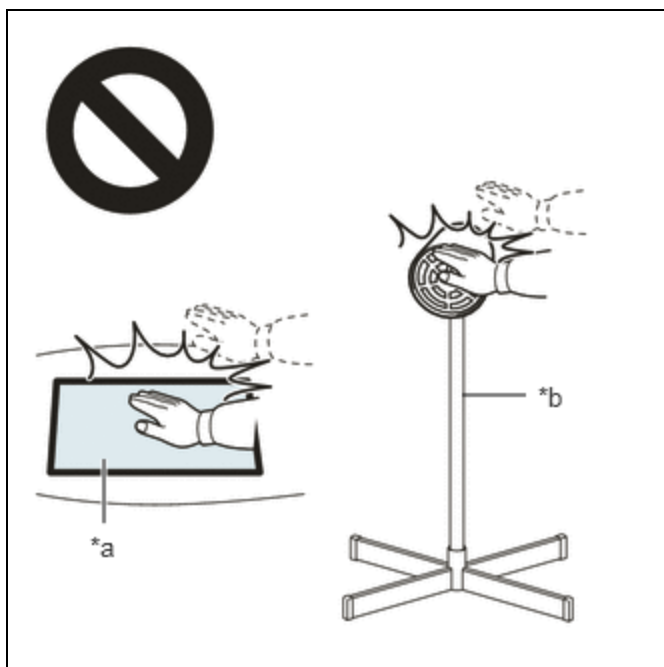

*a	Heated Part
*b	Heat Light

NOTICE:

Do not heat the back door name plate excessively.

2. Remove any remaining double-sided tape from the rear light assembly.
 3. Wipe off any tape adhesive residue with cleaner.
- (2) Using a heat light, heat the rear light assembly and a new No. 4 back door name plate.
- (3) Install a new No. 4 back door name plate.
1. Using a heat light, heat the back door name plate surface.
 2. Remove the release paper from the No. 4 back door name plate.

HINT:

After removing the release paper, keep the exposed adhesive free from foreign matter.



3. Install the No. 4 back door name plate as shown in the illustration.

HINT:

Press the No. 2 back door emblem firmly to install it.

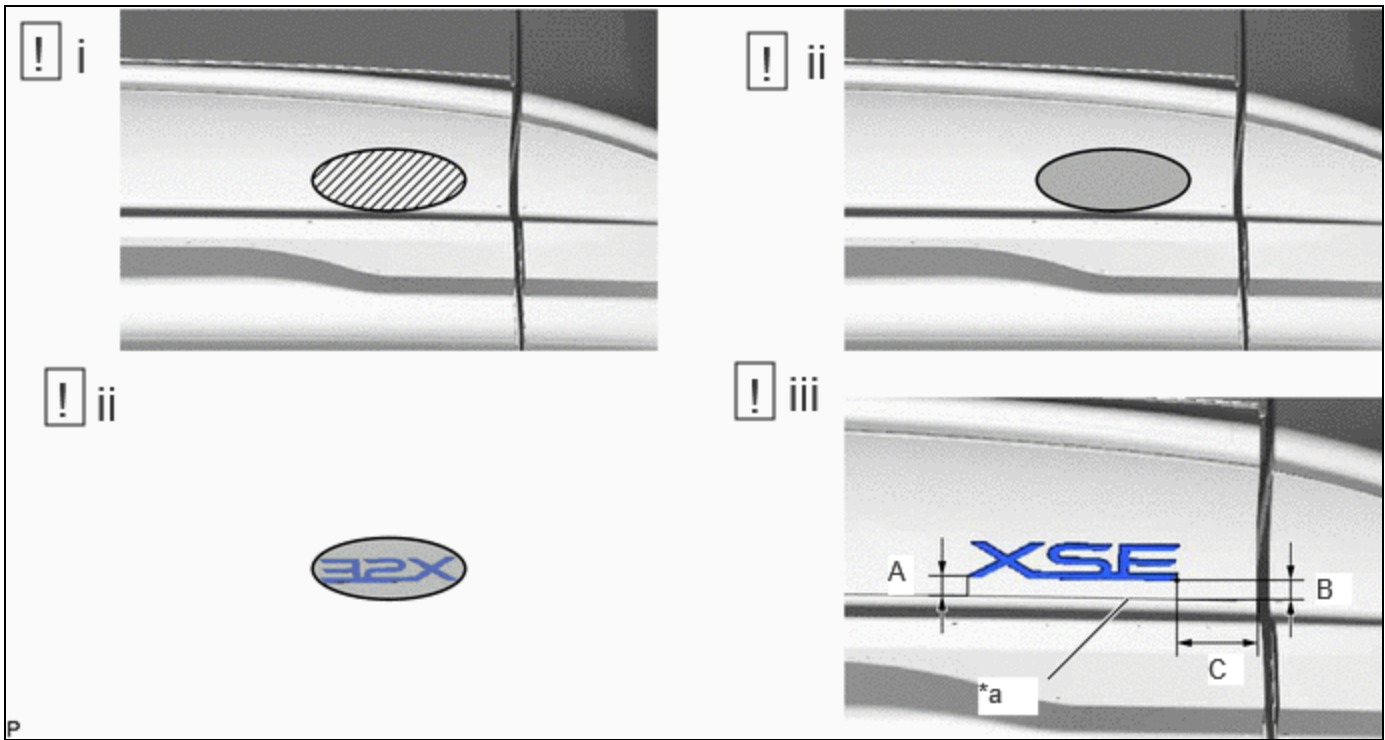
- (d) for XSE Plate:



*a	R End	-	-
	Cleaning Area		Heating Area

Standard Measurement:

AREA	MEASUREMENT	AREA	MEASUREMENT
A	6.7 mm (0.264 in.)	B	7.1 mm (0.28 in.)
C	36.9 mm (1.45 in.)	-	-

(1) Clean the No. 4 back door name plate surface.

- Using a heat light, heat the double-sided tape remaining on the rear light assembly and No. 4 back door name plate.

Heating Temperature

AREA	TEMPERATURE	AREA	TEMPERATURE
Rear Light Assembly	20 to 30 °C (68 to 86 °F)	No. 4 Back Door Name Plate	20 to 30 °C (68 to 86 °F)

CAUTION:

- Do not touch the heat light and heated parts, touching the heat light may result in burns.
- Touching heated parts for a long time may result in burns.

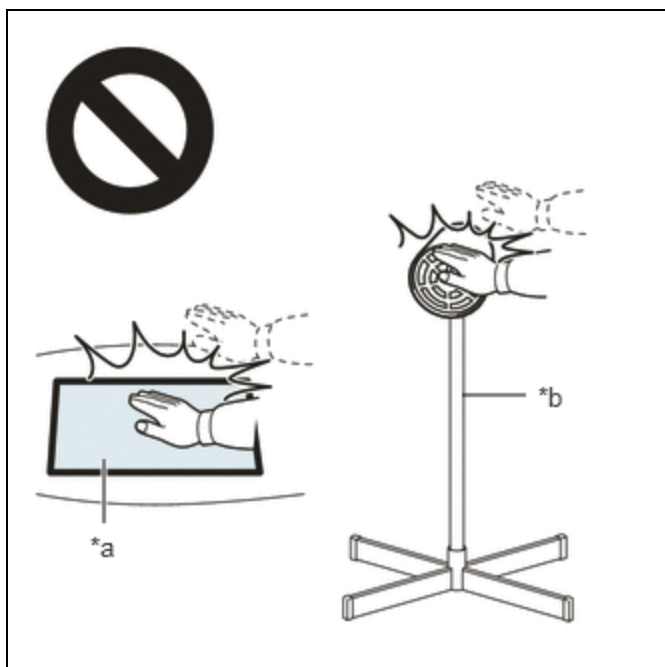

*a	Heated Part
*b	Heat Light

NOTICE:

Do not heat the back door name plate excessively.

2. Remove any remaining double-sided tape from the rear light assembly.
 3. Wipe off any tape adhesive residue with cleaner.
- (2) Using a heat light, heat the rear light assembly and a new No. 4 back door name plate.
- (3) Install a new No. 4 back door name plate.
1. Using a heat light, heat the back door name plate surface.
 2. Remove the release paper from the No. 4 back door name plate.

HINT:

After removing the release paper, keep the exposed adhesive free from foreign matter.



3. Install the No. 4 back door name plate as shown in the illustration.

HINT:

Press the No. 2 back door emblem firmly to install it.

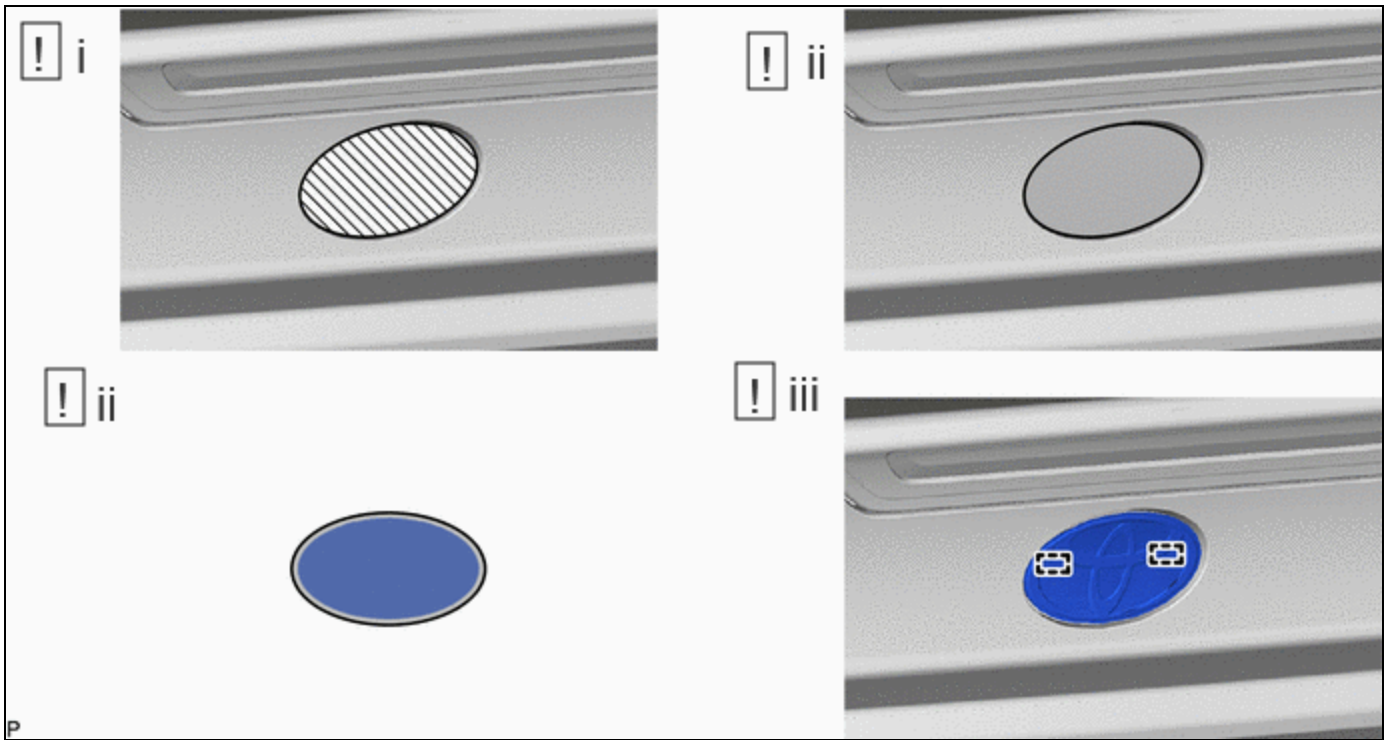
6. INSTALL NO. 1 BACK DOOR EMBLEM



	Cleaning Area		Heating Area
-----------------------------------------------------------------------------------	---------------	-----------------------------------------------------------------------------------	--------------

(1) Clean the No. 1 back door emblem surface.

- Using a heat light, heat the double-sided tape remaining on the rear light assembly and No. 1 back door emblem.

Heating Temperature

AREA	TEMPERATURE	AREA	TEMPERATURE
Rear Light Assembly	20 to 30 °C (68 to 86 °F)	No. 1 Back Door Emblem	20 to 30 °C (68 to 86 °F)

CAUTION:

- Do not touch the heat light and heated parts, touching the heat light may result in burns.
- Touching heated parts for a long time may result in burns.

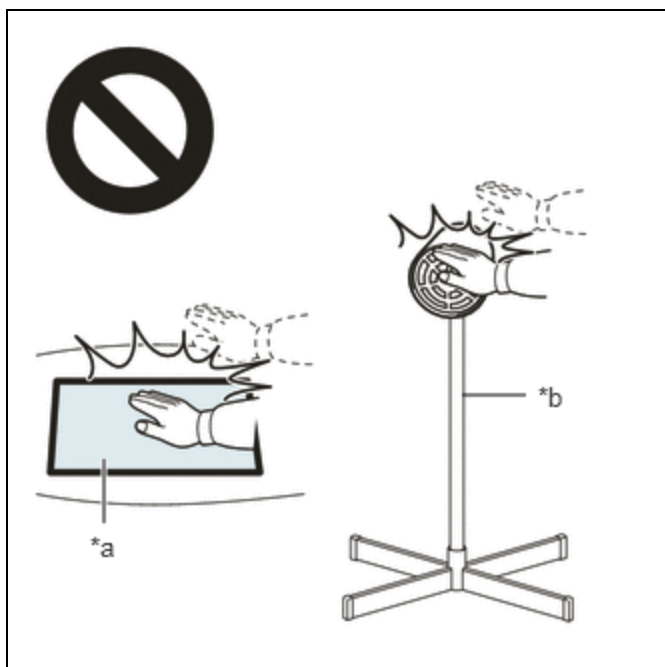

*a	Heated Part
*b	Heat Light

NOTICE:

Do not heat the No. 1 back door emblem excessively.

2. Remove any remaining double-sided tape from the rear light assembly.
 3. Wipe off any tape adhesive residue with cleaner.
- (2) Using a heat light, heat the rear light assembly and a new No. 1 back door emblem.
- (3) Install a new No. 1 back door emblem.
1. Using a heat light, heat the No. 1 back door emblem surface.
 2. Remove the release paper from the No. 1 back door emblem.

HINT:

After removing the release paper, keep the exposed adhesive free from foreign matter.



3. Engage the 2 pins and install the No. 1 back door emblem.

NOTICE:

Press the No. 1 back door emblem firmly to install it.

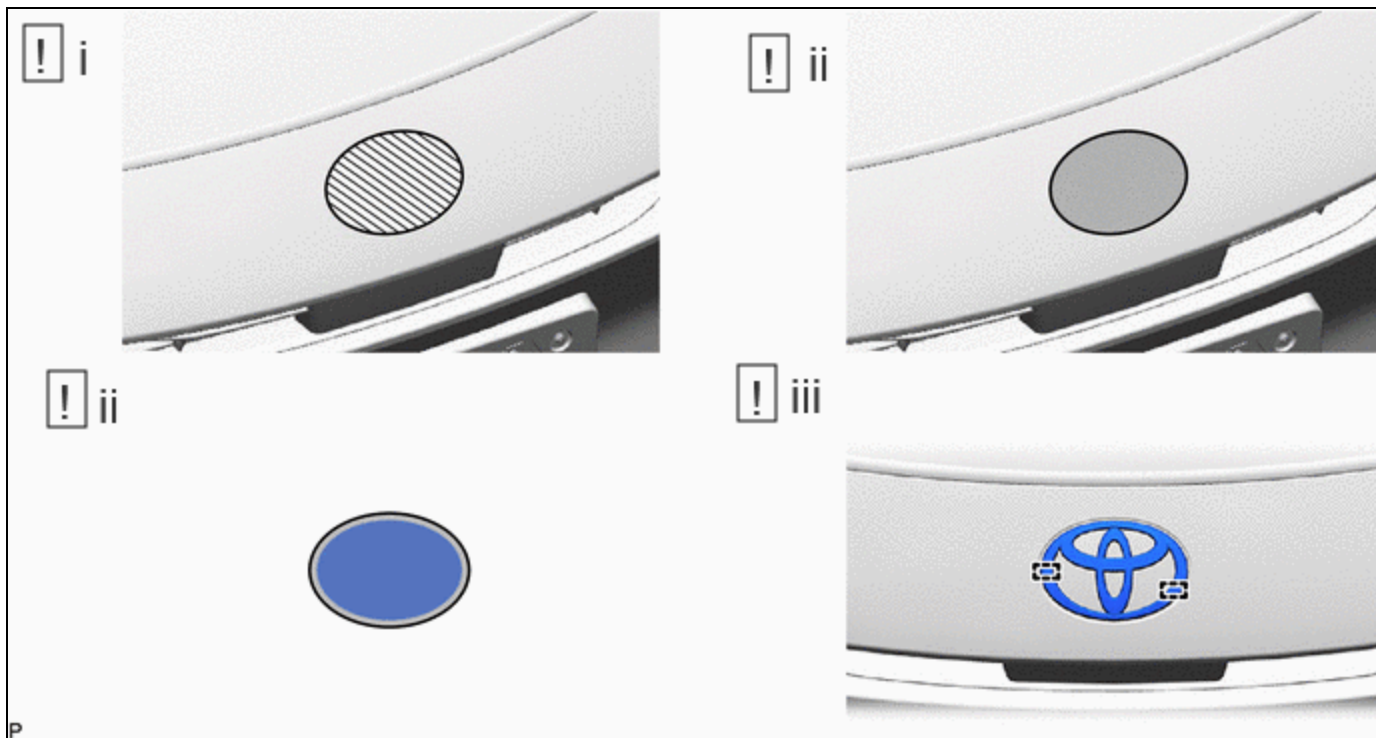
7. INSTALL RADIATOR GRILLE (OR FRONT PANEL) EMBLEM



	Cleaning Area		Heating Area
-----------------------------------------------------------------------------------	---------------	-----------------------------------------------------------------------------------	--------------

(1) Clean the radiator grille (or front panel) emblem surface.

- Using a heat light, heat the double-sided tape remaining on the front bumper cover and radiator grille (or front panel) emblem.

Heating Temperature

AREA	TEMPERATURE	AREA	TEMPERATURE
Front Bumper Cover	20 to 30 °C (68 to 86 °F)	Radiator Grille (or front panel) Emblem	20 to 30 °C (68 to 86 °F)

CAUTION:

- Do not touch the heat light and heated parts, touching the heat light may result in burns.
- Touching heated parts for a long time may result in burns.

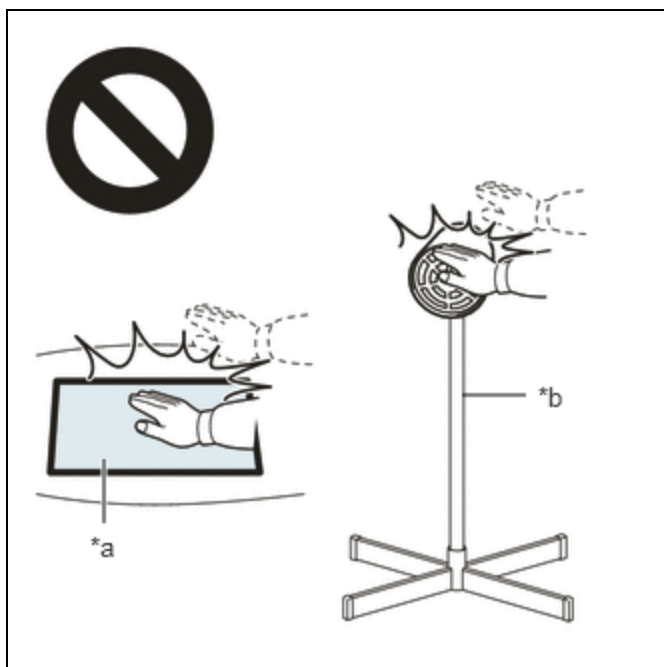

*a	Heated Part
*b	Heat Light

NOTICE:

Do not heat the radiator grille (or front panel) emblem excessively.

2. Remove any remaining double-sided tape from the front bumper cover.
 3. Wipe off any tape adhesive residue with cleaner.
- (2) Using a heat light, heat the front bumper cover and a new radiator grille (or front panel) emblem.
- (3) Install a new radiator grille (or front panel) emblem.
1. Using a heat light, heat the radiator grille (or front panel) emblem surface.
 2. Remove the release paper from the radiator grille (or front panel) emblem.

HINT:

After removing the release paper, keep the exposed adhesive free from foreign matter.

3. Engage the 2 pins and install the radiator grille (or front panel) emblem.

NOTICE:

Press the radiator grille (or front panel) emblem firmly to install it.

