

Last Modified: 12-04-2024	6.11:8.1.0	Doc ID: RM10000002BKE7
Model Year Start: 2023	Model: Prius Prime	Prod Date Range: [03/2023 -]
Title: ADVANCED DRIVER ASSISTANCE SYSTEM: FRONT CAMERA: REMOVAL; 2023 - 2024 MY Prius Prius Prime [03/2023 -]		

REMOVAL

CAUTION / NOTICE / HINT

The necessary procedures (adjustment, calibration, initialization or registration) that must be performed after parts are removed and installed, or replaced during forward recognition camera removal/installation are shown below.

Necessary Procedures After Parts Removed/Installed/Replaced

REPLACED PART OR PERFORMED PROCEDURE	NECESSARY PROCEDURES	EFFECT/INOPERATIVE FUNCTION WHEN NECESSARY PROCEDURES ARE NOT PERFORMED	LINK
Forward recognition camera	Update ECU security key	Vehicle Control History (RoB) is stored	INFO
	Software version confirmation	<ul style="list-style-type: none"> Front Camera System Automatic High Beam System Traffic Jam Assist System 	INFO
	Adjust forward recognition camera	<ul style="list-style-type: none"> Front Camera System Automatic High Beam System Traffic Jam Assist System 	One Time Recognition: INFO Driving Adjustment: INFO Camera Axis Adjustment Value Write: INFO

CAUTION / NOTICE / HINT

NOTICE:

- When replacing the forward recognition camera, replace it with a new one.
- Do not touch the camera lens or the front windshield glass in front of the camera.
- If the forward recognition camera has been struck or dropped, replace it with a new one.
- When replacing the windshield glass of a vehicle equipped with a forward recognition camera, make sure to use a Toyota genuine part. If a non-Toyota genuine part is used, the forward recognition camera may not be able to be installed due to a missing bracket. Also, the front camera system, automatic high beam system or traffic jam assist system may not operate properly due to a difference in the transmissivity or black ceramic border.

CAUTION / NOTICE / HINT

COMPONENTS (REMOVAL)

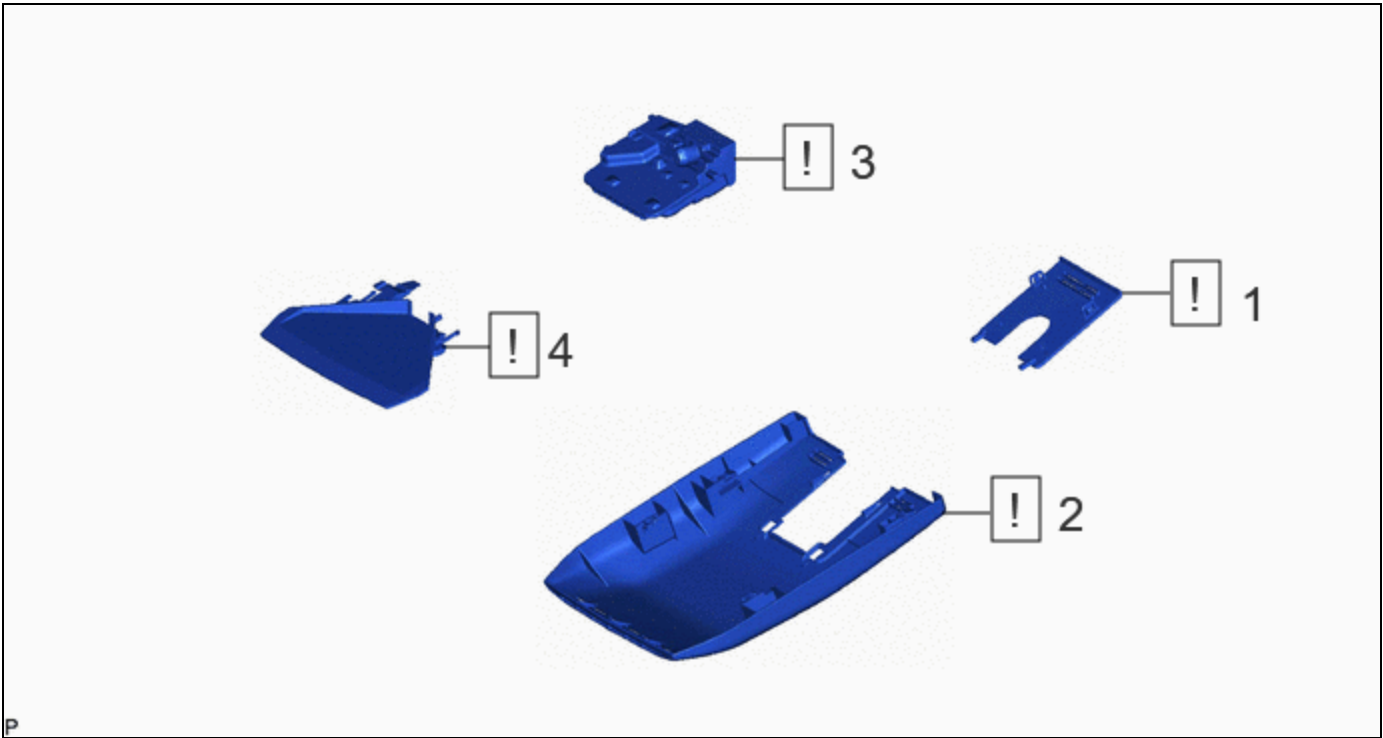



	PROCEDURE	PART NAME CODE	!	📄	⚙️
1	NO. 2 FORWARD RECOGNITION COVER	86466E	INFO	-	-
2	NO. 1 FORWARD RECOGNITION COVER	86466D	INFO	-	-
3	FORWARD RECOGNITION CAMERA	8646C	INFO	-	-
4	FORWARD RECOGNITION HOOD	86461	INFO	-	-

PROCEDURE

1. REMOVE NO. 2 FORWARD RECOGNITION COVER

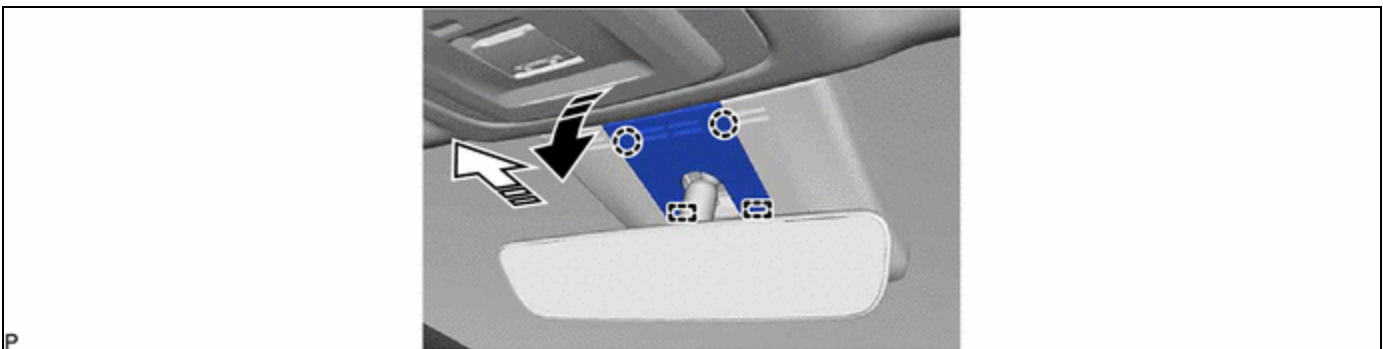
!	<p>NOTICE:</p> <p>If these claws are disengaged separately, they may break. Insert a molding remover between them and pull it down to disengage the claws simultaneously.</p>
---	--

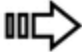

	Remove in this Direction (1)		Remove in this Direction (2)
---	------------------------------	---	------------------------------

2. REMOVE NO. 1 FORWARD RECOGNITION COVER

	<p>NOTICE:</p> <p>To avoid damaging the guides, always slide the No. 1 forward recognition cover parallel to the windshield glass.</p>
---	---

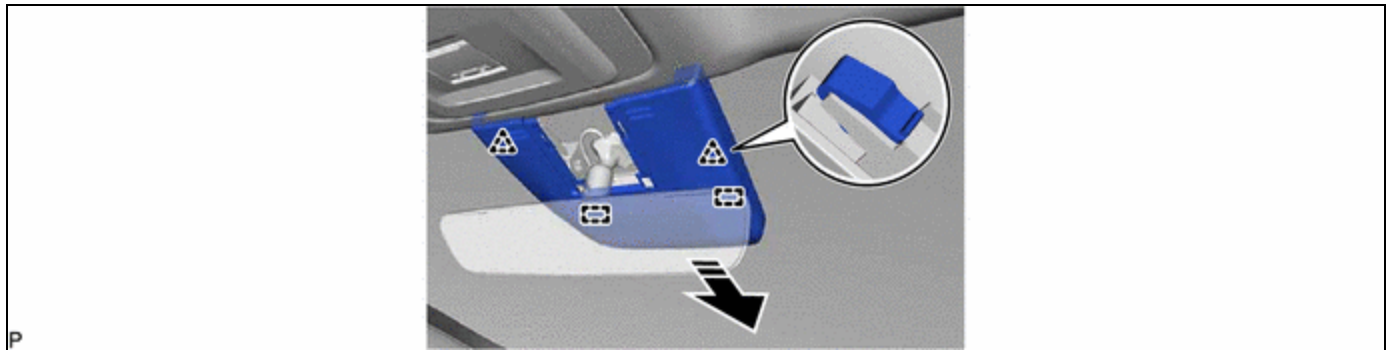

	Remove in this Direction	-	-
---	--------------------------	---	---

3. REMOVE FORWARD RECOGNITION CAMERA

	<p>NOTICE:</p> <ul style="list-style-type: none"> • If the forward recognition camera has been struck or dropped, replace it with a new one. • Do not pull the harness forcibly when disconnecting the connector. • Do not touch the camera lens. • If the forward recognition camera bracket is deformed or damaged, replace it together with the windshield glass.
---	---

HINT:

The illustrations are representative examples, and details may differ.

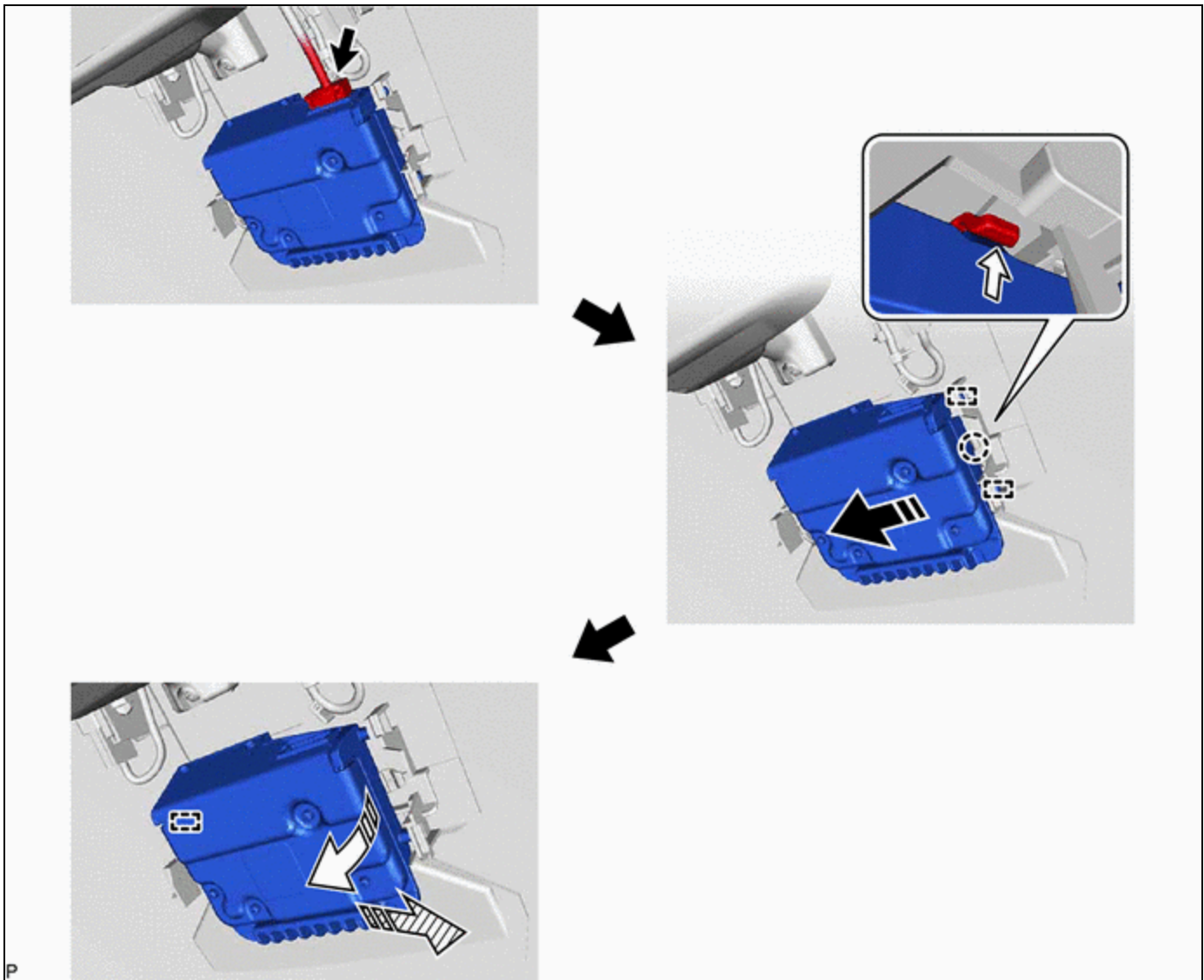

	Remove in this Direction (1)		Remove in this Direction (2)
	Remove in this Direction (3)		Push



4. REMOVE FORWARD RECOGNITION HOOD

HINT:

Perform this procedure only when replacement of the forward recognition hood is necessary.

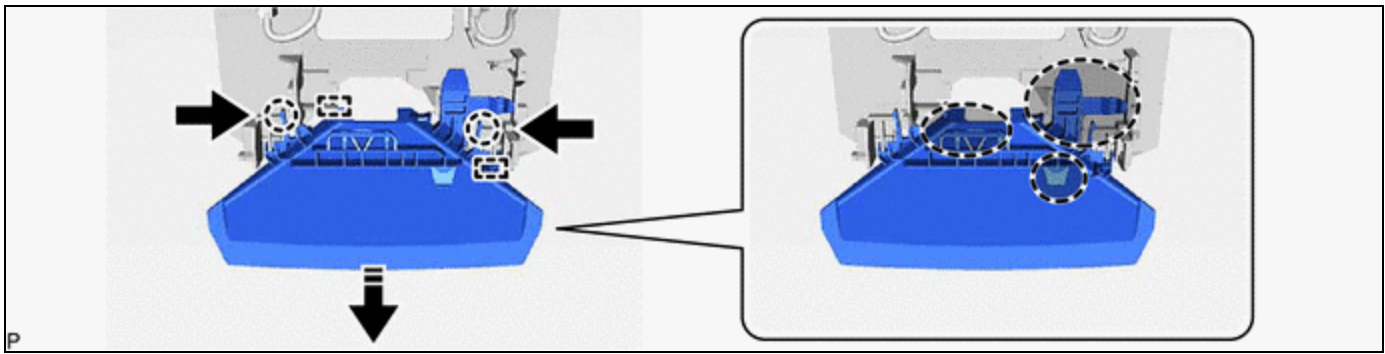
	<p>NOTICE:</p> <p>If the inner surface of the windshield glass in the area in front of the forward recognition camera is dirty, remove the forward recognition hood, clean the glass, then reinstall the forward recognition hood and forward recognition camera.</p>
--	--



	Do not touch		Remove in this Direction
	Push	-	-

(1) Perform the following procedure to remove the forward recognition hood.

1. Disengage the 2 claws as shown in the illustration.
2. As shown in the illustration, slide the 2 claws of the 2 guides parallel to the surface of the glass to remove the forward recognition hood.

NOTICE:

Do not touch the areas shown in the illustration as application of load may cause bending.

