

Last Modified: 12-04-2024	6.11:8.1.0	Doc ID: RM100000028UXQ
Model Year Start: 2023	Model: Prius Prime	Prod Date Range: [12/2022 -]
Title: SUPPLEMENTAL RESTRAINT SYSTEMS: AIRBAG SYSTEM: FREEZE FRAME DATA; 2023 - 2024 MY Prius Prius Prime [12/2022 -]		

FREEZE FRAME DATA

DESCRIPTION

- (a) When an airbag system DTC is stored, the airbag ECU assembly stores the current vehicle (ECU, sensor or squib) state as Freeze Frame Data.

CHECK FREEZE FRAME DATA

CAUTION:

Never measure the resistance of the SRS parts because current from the tester may cause the SRS parts to deploy.

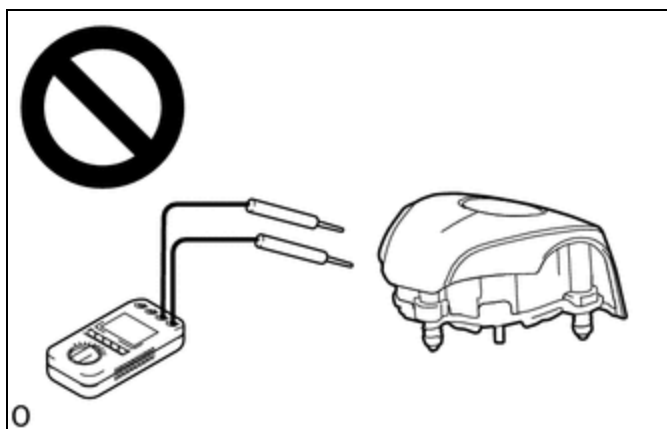

- (a) Check for DTCs.

Body Electrical > SRS Airbag > Trouble Codes

- (b) According to the GTS display, select a DTC that stored freeze frame data.
(c) Read the freeze frame data recorded when the DTC was stored.

Body Electrical > SRS Airbag

TESTER DISPLAY	MEASUREMENT ITEM	RANGE	NORMAL CONDITION	DIAGNOSTIC NOTE
Total Distance Traveled	-	-	-	Not applicable
Total Distance Traveled - Unit	-	-	-	Not applicable
IG Voltage	IGR power supply voltage supplied to airbag ECU assembly	0 to 25.5 V	12 V	-
Voltage After Pressure Rising	Airbag ECU assembly internal voltage	0 to 51 V	23.5 V	-

TESTER DISPLAY	MEASUREMENT ITEM	RANGE	NORMAL CONDITION	DIAGNOSTIC NOTE
Squib Driver Voltage	Airbag ECU assembly internal voltage	0 to 51 V	23.5 V	-
Satellite Sensor Power Supply Voltage	Airbag ECU assembly internal voltage	0 to 25.5 V	9.4 V	-
Microcomputer/Sensor Voltage	Airbag ECU assembly internal voltage	0 to 12.75 V	3.3 V	-
Passenger Seat Buckle Switch Terminal Current (Live)	Current applied to front passenger seat buckle switch (when energized)	0 to 38.25 mA	LO output (not fastened): 6 mA HI output (fastened): 14.4 mA	w/ Occupant Classification System
Passenger Seat Buckle Switch Terminal Voltage (Inactive)	Voltage applied to front passenger seat buckle switch (when not energized)	0 to 12.75 V	0.2 V	w/ Occupant Classification System
Satellite G Sensor Output Value	Satellite G sensor output value	-100.000 to 99.804 %	0 %	-
Satellite P Sensor Output Value	Satellite pressure sensor output value	0 to 33.759 %	0 %	-
Satellite P Sensor Absolute Pressure 1	Absolute pressure output of satellite pressure sensor at initial diagnosis	35.9223 to 147.5607 kPa(abs)	-	-
Satellite P Sensor Absolute Pressure 2	Absolute pressure output of satellite pressure sensor at initial diagnosis	35.9223 to 147.5607 kPa(abs)	-	-
Driver Seat Airbag Squib Resistance Value	Squib resistance value	0 to 655.35 OHM	2.10 to 4.20 OHM	-
Driver Seat Airbag Squib Resistance Value Diagnosis Result	Diagnostic result of squib resistance value	Normal or Abnormal	Normal	-
Passenger Seat Airbag Squib Resistance Value	Squib resistance value	0 to 655.35 OHM	1.80 to 3.00 OHM	-

TESTER DISPLAY	MEASUREMENT ITEM	RANGE	NORMAL CONDITION	DIAGNOSTIC NOTE
Passenger Seat Airbag Squib Resistance Value Diagnosis Result	Diagnostic result of squib resistance value	Normal or Abnormal	Normal	-
Driver Seat 2nd Airbag Squib Resistance Value	Squib resistance value	0 to 655.35 OHM	2.10 to 4.20 OHM	w/ Occupant Classification System
Driver Seat 2nd Airbag Squib Resistance Value Diagnosis Result	Diagnostic result of squib resistance value	Normal or Abnormal	Normal	w/ Occupant Classification System
Passenger Seat 2nd Airbag Squib Resistance Value	Squib resistance value	0 to 655.35 OHM	1.80 to 3.00 OHM	w/ Occupant Classification System
Passenger Seat 2nd Airbag Squib Resistance Value Diagnosis Result	Diagnostic result of squib resistance value	Normal or Abnormal	Normal	w/ Occupant Classification System
Driver Seat Knee Airbag Squib Resistance Value	Squib resistance value	0 to 655.35 OHM	2.10 to 4.20 OHM	w/o Occupant Classification System
Driver Seat Knee Airbag Squib Resistance Value Diagnosis Result	Diagnostic result of squib resistance value	Normal or Abnormal	Normal	w/o Occupant Classification System
Right Side 1st Seat Side-airbag Squib Resistance Value	Squib resistance value	0 to 655.35 OHM	1.80 to 3.00 OHM	-
Right Side 1st Seat Side-airbag Squib Resistance Value Diagnosis Result	Diagnostic result of squib resistance value	Normal or Abnormal	Normal	-
Left Side 1st Seat Side-airbag Squib Resistance Value	Squib resistance value	0 to 655.35 OHM	1.80 to 3.00 OHM	-
Left Side 1st Seat Side-airbag Squib Resistance Value Diagnosis Result	Diagnostic result of squib resistance value	Normal or Abnormal	Normal	-

TESTER DISPLAY	MEASUREMENT ITEM	RANGE	NORMAL CONDITION	DIAGNOSTIC NOTE
Driver Seat Pretensioner Squib Resistance Value	Squib resistance value	0 to 655.35 OHM	2.10 to 4.20 OHM	-
Driver Seat Pretensioner Squib Resistance Value Diagnosis Result	Diagnostic result of squib resistance value	Normal or Abnormal	Normal	-
Passenger Seat Pretensioner Squib Resistance Value	Squib resistance value	0 to 655.35 OHM	1.80 to 3.00 OHM	-
Passenger Seat Pretensioner Squib Resistance Value Diagnosis Result	Diagnostic result of squib resistance value	Normal or Abnormal	Normal	-
Right Side Curtain Shield Airbag Squib Resistance Value	Squib resistance value	0 to 655.35 OHM	1.80 to 3.00 OHM	-
Right Side Curtain Shield Airbag Squib Resistance Value Diagnosis Result	Diagnostic result of squib resistance value	Normal or Abnormal	Normal	-
Left Side Curtain Shield Airbag Squib Resistance Value	Squib resistance value	0 to 655.35 OHM	1.80 to 3.00 OHM	-
Left Side Curtain Shield Airbag Squib Resistance Value Diagnosis Result	Diagnostic result of squib resistance value	Normal or Abnormal	Normal	-
Right Side 2nd Seat Side-airbag Squib Resistance Value	Squib resistance value	0 to 655.35 OHM	1.80 to 3.00 OHM	w/ Occupant Classification System
Right Side 2nd Seat Side-airbag Squib Resistance Value Diagnosis Result	Diagnostic result of squib resistance value	Normal or Abnormal	Normal	w/ Occupant Classification System
Left Side 2nd Seat Side-airbag Squib Resistance Value	Squib resistance value	0 to 655.35 OHM	1.80 to 3.00 OHM	w/ Occupant Classification System
Left Side 2nd Seat Side-airbag Squib Resistance Value Diagnosis Result	Diagnostic result of squib resistance value	Normal or Abnormal	Normal	w/ Occupant Classification System

TESTER DISPLAY	MEASUREMENT ITEM	RANGE	NORMAL CONDITION	DIAGNOSTIC NOTE
Right Side 2nd Seat Pretensioner Squib Resistance Value	Squib resistance value	0 to 655.35 OHM	1.80 to 3.00 OHM	-
Right Side 2nd Seat Pretensioner Squib Resistance Value Diagnosis Result	Diagnostic result of squib resistance value	Normal or Abnormal	Normal	-
Left Side 2nd Seat Pretensioner Squib Resistance Value	Squib resistance value	0 to 655.35 OHM	1.80 to 3.00 OHM	-
Left Side 2nd Seat Pretensioner Squib Resistance Value Diagnosis Result	Diagnostic result of squib resistance value	Normal or Abnormal	Normal	-

