

Last Modified: 12-04-2024	6.11:8.1.0	Doc ID: RM100000029ODU
Model Year Start: 2023	Model: Prius Prime	Prod Date Range: [12/2022 -]
Title: WIPER / WASHER: WASHER NOZZLE (for Rear Television Camera): REMOVAL; 2023 - 2024 MY Prius Prius Prime [12/2022 -]		

REMOVAL

CAUTION / NOTICE / HINT

The necessary procedures (adjustment, calibration, initialization or registration) that must be performed after parts are removed and installed, or replaced during washer nozzle removal/installation are shown below.

Necessary Procedures After Parts Removed/Installed/Replaced

REPLACED PART OR PERFORMED PROCEDURE	NECESSARY PROCEDURES	EFFECT/INOPERATIVE FUNCTION WHEN NECESSARY PROCEDURES ARE NOT PERFORMED	LINK
Rear television camera assembly	<ul style="list-style-type: none"> Parking assist monitor system initialization* Rear television camera assembly optical axis (Back camera position setting)* 	Parking Assist Monitor System	INFO
	Rear television camera view adjustment*	Parking Support Brake system	INFO
		Panoramic View Monitor System	INFO
		Advanced Park	INFO
Camera cleaner setting operation*1	Multimedia switch is not displayed	INFO	
Replacement or removal and installation of 2 or more parts: <ul style="list-style-type: none"> Front television camera assembly, Radiator grille or Front bumper assembly Rear television camera assembly Side television camera assembly LH, Parking assist light LH or Outer rear view mirror assembly LH Side television camera assembly RH, Parking assist light RH or Outer 	Television camera view adjustment	Panoramic View Monitor System	INFO

*: Even when not replacing the part, it is necessary to perform the specified necessary procedures after installation.

*1: w/ Rear Camera Cleaner System

REPLACED PART OR PERFORMED PROCEDURE	NECESSARY PROCEDURES	EFFECT/INOPERATIVE FUNCTION WHEN NECESSARY PROCEDURES ARE NOT PERFORMED	LINK
rear view mirror assembly RH			

*: Even when not replacing the part, it is necessary to perform the specified necessary procedures after installation.

*1: w/ Rear Camera Cleaner System

CAUTION / NOTICE / HINT

COMPONENTS (REMOVAL)

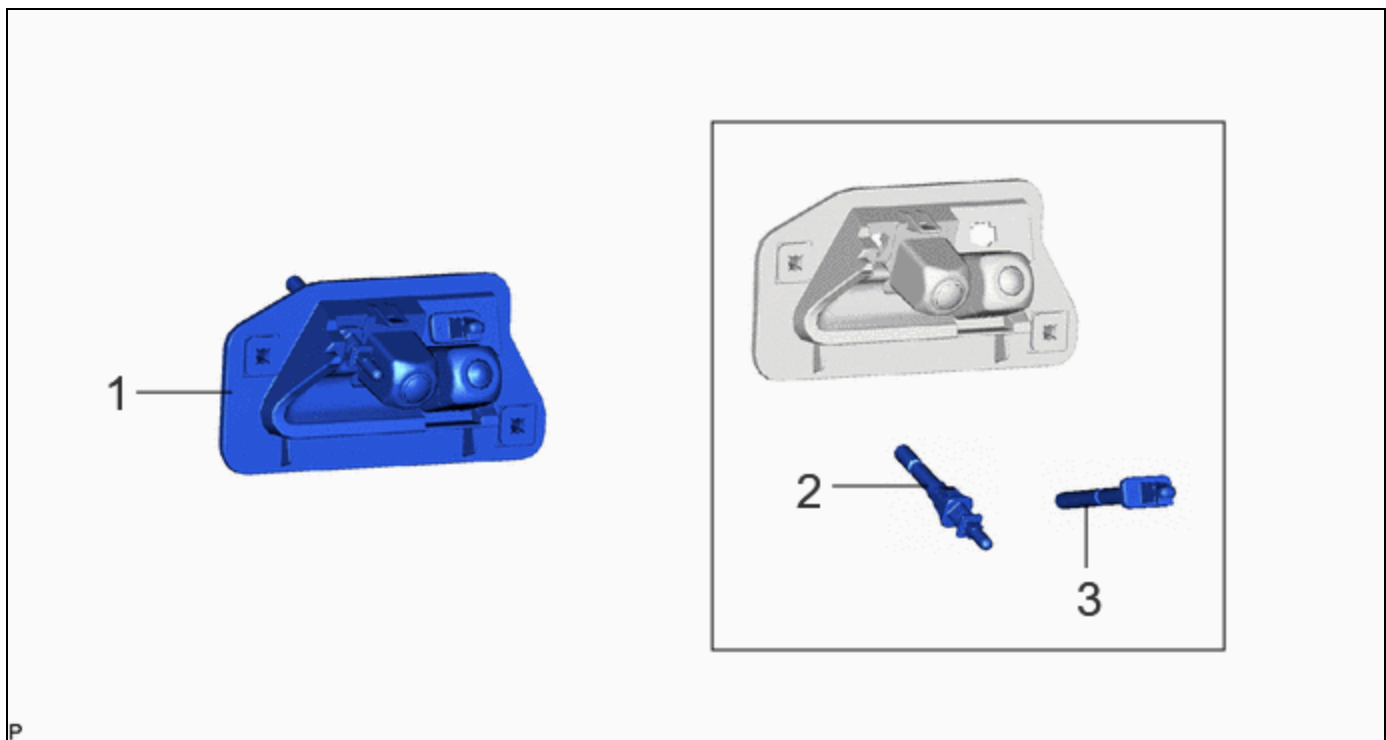

PROCEDURE	PART NAME CODE	!	📄	⚙️
1 REAR TELEVISION CAMERA ASSEMBLY	86790D	-	-	-
2 NO. 1 CAMERA CLEANER NOZZLE ASSEMBLY	867F0A	-	-	-
3 NO. 2 CAMERA CLEANER NOZZLE ASSEMBLY	867F0B	-	-	-

PROCEDURE

1. REMOVE REAR TELEVISION CAMERA ASSEMBLY

Click here [INFO](#)

2. REMOVE NO. 1 CAMERA CLEANER NOZZLE ASSEMBLY

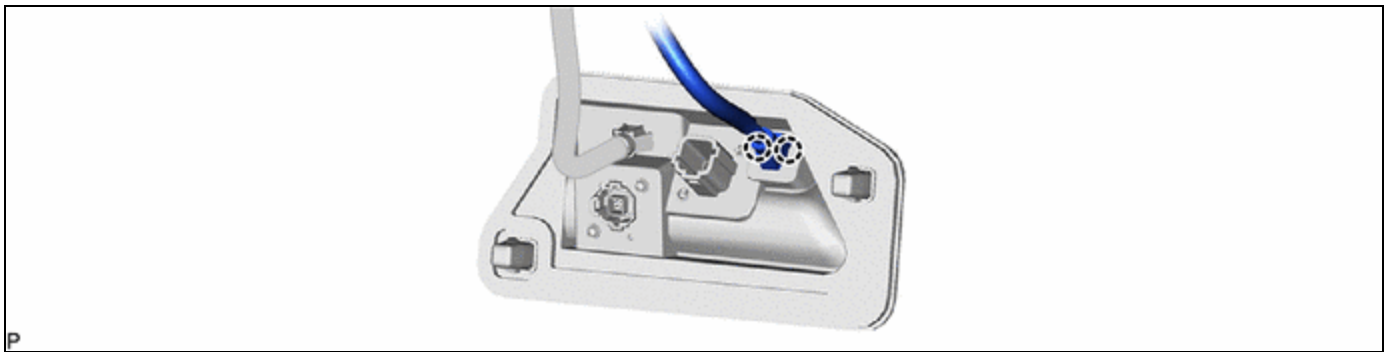

3. REMOVE NO. 2 CAMERA CLEANER NOZZLE ASSEMBLY

