

Last Modified: 12-04-2024	6.11:8.1.0	Doc ID: RM100000002BJBT
Model Year Start: 2023	Model: Prius Prime	Prod Date Range: [03/2023 -]
Title: EXTERIOR PANELS / TRIM: REAR DOOR BELT MOULDING: REMOVAL; 2023 - 2024 MY Prius Prius Prime [03/2023 -]		

REMOVAL

CAUTION / NOTICE / HINT

The necessary procedures (adjustment, calibration, initialization or registration) that must be performed after parts are removed and installed, or replaced during rear door belt moulding assembly removal/installation are shown below.

Necessary Procedures After Parts Removed/Installed/Replaced

REPLACED PART OR PERFORMED PROCEDURE	NECESSARY PROCEDURES	EFFECT/INOPERATIVE FUNCTION WHEN NECESSARY PROCEDURES ARE NOT PERFORMED	LINK
<ul style="list-style-type: none"> • Power window regulator motor assembly LH • Power window regulator motor assembly RH • Rear door window regulator sub-assembly LH* • Rear door window regulator sub-assembly RH* • Rear door glass sub-assembly LH* • Rear door glass sub-assembly RH* • Rear door glass run LH* • Rear door glass run RH* 	Initialize power window control system	<ul style="list-style-type: none"> • Auto up and down function • Remote control function • Key-off operation function • Wireless transmitter-linked function • Key-linked function • Window open warning function • Catch protection function • Jam protection function 	INFO
*: Even when not replacing the part, it is necessary to perform the specified necessary procedures after installation.			

CAUTION / NOTICE / HINT

NOTICE:

- After the ignition switch is turned off, the radio and display receiver assembly records various types of memory and settings. As a result, after turning the ignition switch off, make sure to wait at least 3 minutes before disconnecting the cable from the negative (-) auxiliary battery terminal.

Click here [INFO](#)

- When the cable is disconnected from the negative (-) auxiliary battery terminal and the security lock setting has been enabled, multi-display operations will be disabled upon next startup unless the password is entered. Be sure to check the security lock setting before disconnecting the cable from the negative (-) auxiliary battery terminal.

[Click here](#) [INFO](#)

CAUTION / NOTICE / HINT

HINT:

- When the cable is disconnected / reconnected to the auxiliary battery terminal, systems temporarily stop operating. However, each system has a function that completes learning the first time the system is used.

Learning completes when vehicle is driven

EFFECT/INOPERATIVE FUNCTION WHEN NECESSARY PROCEDURES ARE NOT PERFORMED	NECESSARY PROCEDURES	LINK
Front Camera System	Drive the vehicle straight ahead at 35 km/h (22 mph) or more for 5 seconds or more.	INFO

Learning completes when vehicle is operated normally

EFFECT/INOPERATIVE FUNCTION WHEN NECESSARY PROCEDURES ARE NOT PERFORMED	NECESSARY PROCEDURES	LINK
Power Door Lock Control System*1 <ul style="list-style-type: none"> Back door opener 	Perform door unlock operation with door control switch or electrical key transmitter sub-assembly switch.	INFO
Power Back Door System*2	Reset back door close position	INFO
Air Conditioning System	<p>for HEV Model:</p> <p>After the ignition switch is turned to ON, the servo motor standard position is recognized.</p> <p>for PHEV Model:</p> <p>After the ignition switch is turned to ON, the servo motor and expansion valve standard position is recognized.</p>	-
*1: w/o Power Back Door System		
*2: w/ Power Back Door System		

- Use the same procedure for the RH side and LH side.
- The following procedure is for the LH side.

CAUTION / NOTICE / HINT

COMPONENTS (REMOVAL)

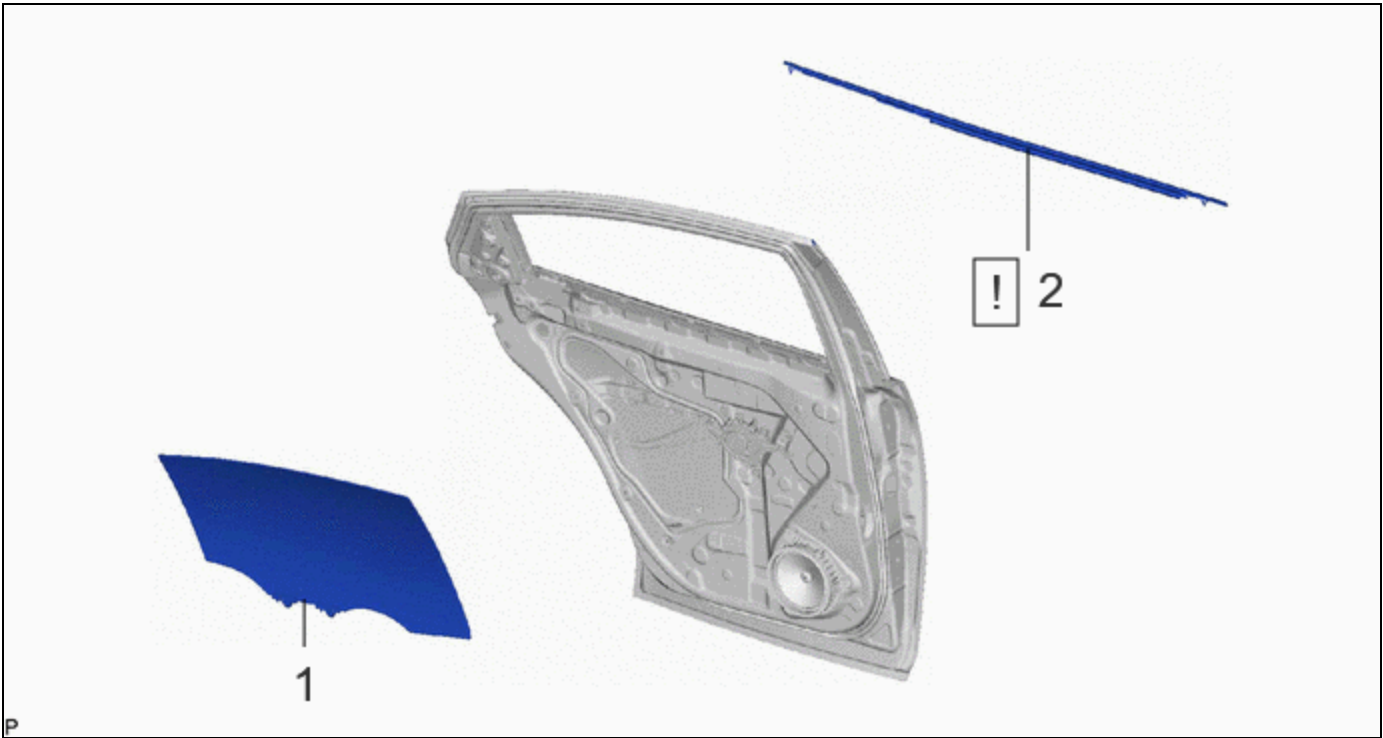

PROCEDURE		PART NAME CODE	!		
1	REAR DOOR GLASS SUB-ASSEMBLY	68104	-	-	-
2	REAR DOOR BELT MOULDING ASSEMBLY	75740	INFO	-	-

PROCEDURE

1. REMOVE REAR DOOR GLASS SUB-ASSEMBLY

Click here [INFO](#)

2. REMOVE REAR DOOR BELT MOULDING ASSEMBLY

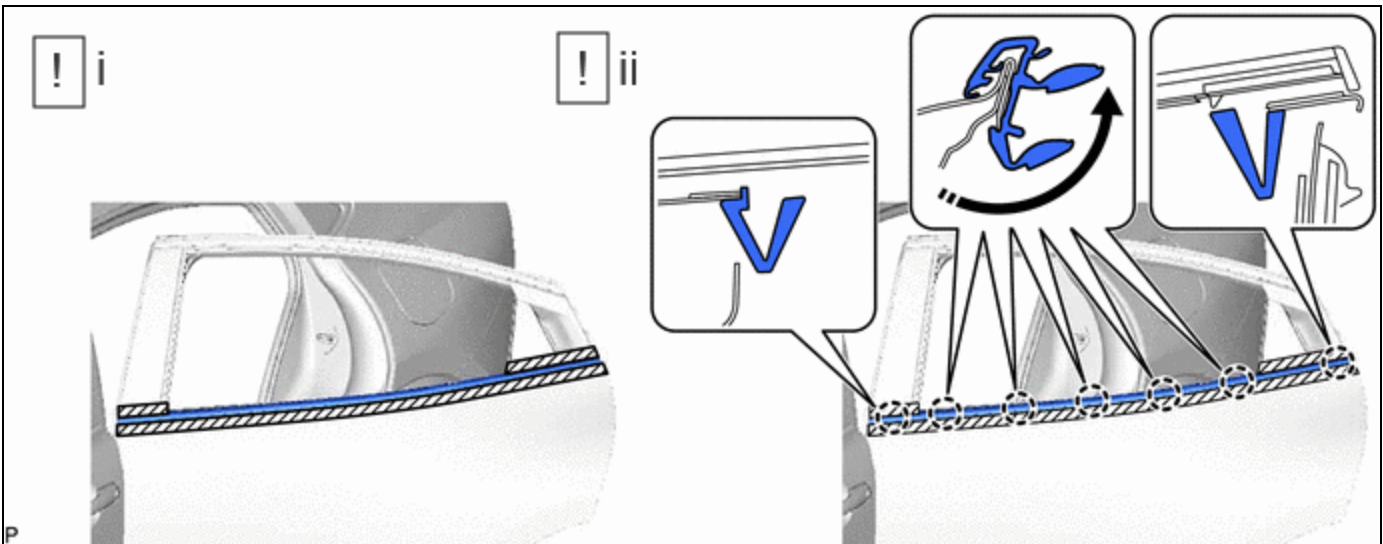

	Remove in this Direction	-	-
---	--------------------------	---	---

- (1) Apply protective tape around the rear door belt moulding assembly as shown in the illustration.
- (2) Disengage the 7 claws as shown in the illustration.

