

<b>Last Modified:</b> 12-04-2024	6.11:8.1.0	<b>Doc ID:</b> RM100000002BJBP
<b>Model Year Start:</b> 2023	<b>Model:</b> Prius Prime	<b>Prod Date Range:</b> [03/2023 - ]
<b>Title:</b> EXTERIOR PANELS / TRIM: FRONT DOOR BELT MOULDING: REMOVAL; 2023 - 2024 MY Prius Prius Prime [03/2023 - ]		

## REMOVAL

### CAUTION / NOTICE / HINT

The necessary procedures (adjustment, calibration, initialization or registration) that must be performed after parts are removed and installed, or replaced during front door belt moulding assembly removal/installation are shown below.

#### **Necessary Procedures After Parts Removed/Installed/Replaced**

REPLACED PART OR PERFORMED PROCEDURE	NECESSARY PROCEDURES	EFFECT/INOPERATIVE FUNCTION WHEN NECESSARY PROCEDURES ARE NOT PERFORMED	LINK
<ul style="list-style-type: none"> <li>Outer rear view mirror assembly LH*</li> <li>Outer rear view mirror assembly RH*</li> </ul>	Side television camera view adjustment	Parking Support Brake system	<a href="#">INFO</a>
		Panoramic View Monitor System	<a href="#">INFO</a>
		Advanced Park	<a href="#">INFO</a>
<b>Replacement or removal and installation of 2 or more parts:</b> <ul style="list-style-type: none"> <li>Front television camera assembly, Radiator grille or Front bumper assembly</li> <li>Rear television camera assembly</li> <li>Side television camera assembly LH, Parking assist light LH or Outer rear view mirror assembly LH</li> <li>Side television camera assembly RH, Parking assist light RH or Outer rear view mirror assembly RH</li> </ul>	Television camera view adjustment	Panoramic View Monitor System	<a href="#">INFO</a>
<ul style="list-style-type: none"> <li>Power window regulator motor assembly LH</li> <li>Power window regulator motor assembly RH</li> <li>Front door window regulator sub-assembly LH*</li> <li>Front door window regulator sub-assembly RH*</li> <li>Front door glass sub-assembly LH*</li> </ul>	Initialize power window control system	<ul style="list-style-type: none"> <li>Auto up and down function</li> <li>Remote control function</li> <li>Key-off operation function</li> <li>Wireless transmitter-linked function</li> <li>Key-linked function</li> <li>Window open warning function</li> <li>Catch protection function</li> <li>Jam protection function</li> </ul>	<a href="#">INFO</a>
*: Even when not replacing the part, it is necessary to perform the specified necessary procedures after installation.			

REPLACED PART OR PERFORMED PROCEDURE	NECESSARY PROCEDURES	EFFECT/INOPERATIVE FUNCTION WHEN NECESSARY PROCEDURES ARE NOT PERFORMED	LINK
<ul style="list-style-type: none"> <li>Front door glass sub-assembly RH*</li> <li>Front door glass run LH*</li> <li>Front door glass run RH*</li> </ul>			
*: Even when not replacing the part, it is necessary to perform the specified necessary procedures after installation.			

## CAUTION / NOTICE / HINT

### HINT:

- When the cable is disconnected / reconnected to the auxiliary battery terminal, systems temporarily stop operating. However, each system has a function that completes learning the first time the system is used.

#### Learning completes when vehicle is driven

EFFECT/INOPERATIVE FUNCTION WHEN NECESSARY PROCEDURES ARE NOT PERFORMED	NECESSARY PROCEDURES	LINK
Front Camera System	Drive the vehicle straight ahead at 35 km/h (22 mph) or more for 5 seconds or more.	<a href="#">INFO</a>

#### Learning completes when vehicle is operated normally

EFFECT/INOPERATIVE FUNCTION WHEN NECESSARY PROCEDURES ARE NOT PERFORMED	NECESSARY PROCEDURES	LINK
Power Door Lock Control System*1 <ul style="list-style-type: none"> <li>Back door opener</li> </ul>	Perform door unlock operation with door control switch or electrical key transmitter sub-assembly switch.	<a href="#">INFO</a>
Power Back Door System*2	Reset back door close position	<a href="#">INFO</a>
Air Conditioning System	<b>for HEV Model:</b> After the ignition switch is turned to ON, the servo motor standard position is recognized. <b>for PHEV Model:</b> After the ignition switch is turned to ON, the servo motor and expansion valve standard position is recognized.	-
*1: w/o Power Back Door System		
*2: w/ Power Back Door System		

- Use the same procedure for the RH side and LH side.
- The following procedure is for the LH side.

## CAUTION / NOTICE / HINT

### COMPONENTS (REMOVAL)

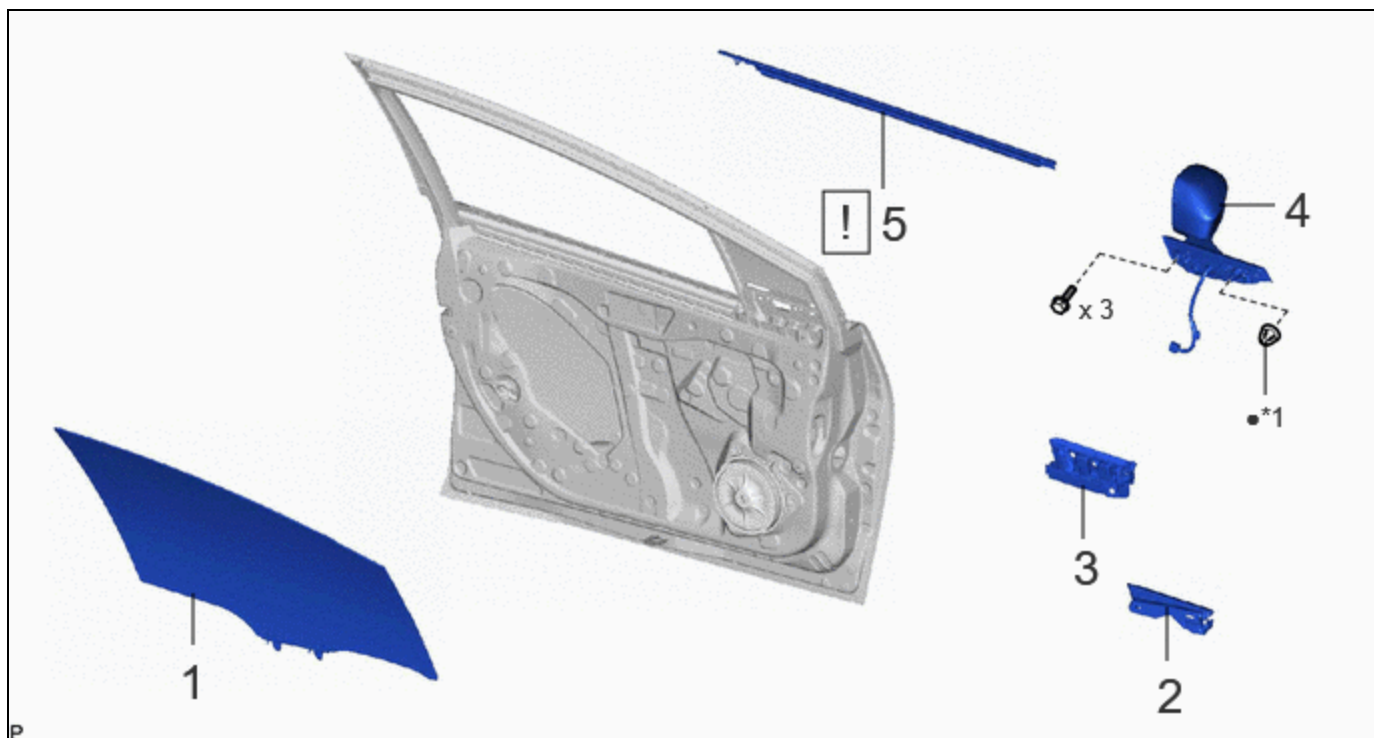

PROCEDURE		PART NAME CODE			
1	FRONT DOOR GLASS SUB-ASSEMBLY	68102	-	-	-
2	FRONT DOOR LOWER FRAME BRACKET GARNISH	67492A	-	-	-
3	NO. 3 FRONT DOOR SERVICE HOLE COVER	67836C	-	-	-
4	OUTER REAR VIEW MIRROR ASSEMBLY	87940	-	-	-
5	FRONT DOOR BELT MOULDING ASSEMBLY	75720	<a href="#">INFO</a>	-	-

*1	HOOK	-	-
•	Non-reusable part	-	-

## PROCEDURE

### 1. REMOVE FRONT DOOR GLASS SUB-ASSEMBLY

Click here [INFO](#)

### 2. REMOVE FRONT DOOR LOWER FRAME BRACKET GARNISH

Click here [INFO](#)

### 3. REMOVE NO. 3 FRONT DOOR SERVICE HOLE COVER

Click here [INFO](#)

### 4. REMOVE OUTER REAR VIEW MIRROR ASSEMBLY

Click here [INFO](#)

### 5. REMOVE FRONT DOOR BELT MOULDING ASSEMBLY

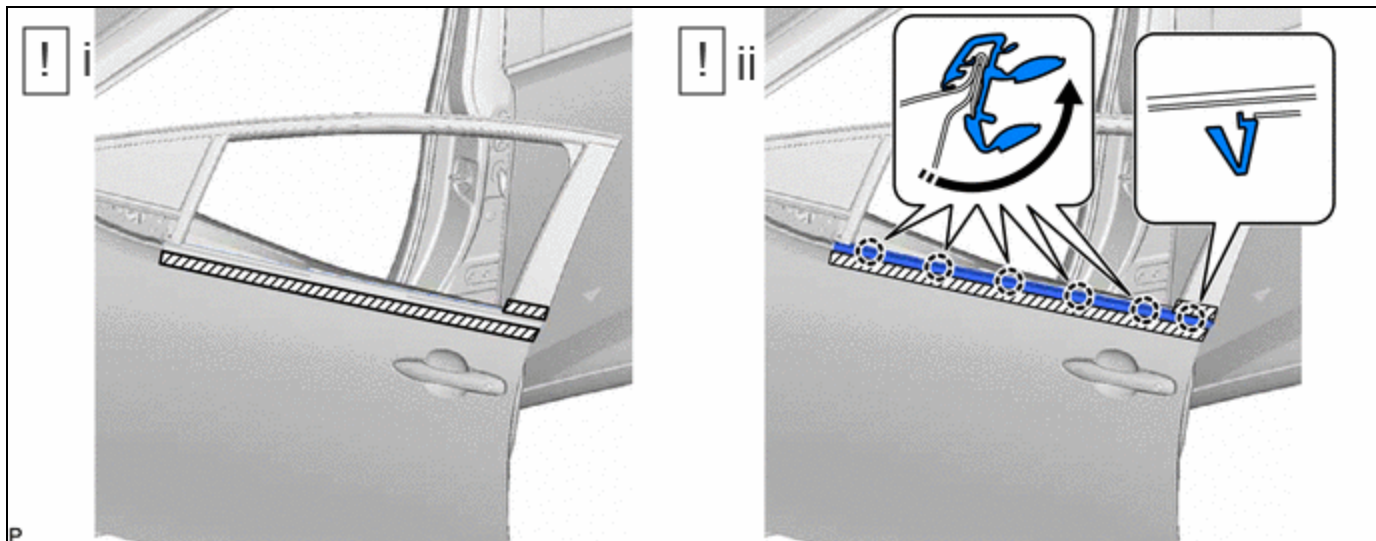

	Remove in this Direction	-	-
---	--------------------------	---	---

- (1) Apply protective tape around the front door belt moulding assembly as shown in the illustration.
- (2) Disengage the 6 claws as shown in the illustration.

