

Last Modified: 12-04-2024	6.11:8.1.0	Doc ID: RM100000002B18G
Model Year Start: 2023	Model: Prius Prime	Prod Date Range: [03/2023 -]
Title: DOOR / HATCH: CHARGE LID OPENER UNIT: REMOVAL; 2023 - 2024 MY Prius Prius Prime [03/2023 -]		

REMOVAL

CAUTION / NOTICE / HINT

The necessary procedures (adjustment, calibration, initialization or registration) that must be performed after parts are removed and installed, or replaced during battery charger connector opening lid sub-assembly removal/installation are shown below.

CAUTION:

- Orange wire harnesses and connectors indicate high-voltage circuits. To prevent electric shock, always follow the procedure described in the repair manual.

[Click here](#) INFO



- To prevent electric shock, wear insulated gloves when working on wire harnesses and components of the high



voltage system.

NOTICE:

- After the ignition switch is turned off, the radio and display receiver assembly records various types of memory and settings. As a result, after turning the ignition switch off, make sure to wait at least 3 minutes before disconnecting the cable from the negative(-) auxiliary battery terminal.
- When the cable is disconnected from the negative (-) auxiliary battery terminal and the security lock setting has been enabled, multi-display operations will be disabled upon next startup unless the password is entered. Be sure to check the security lock setting before disconnecting the cable from the negative (-) auxiliary battery terminal.

CAUTION / NOTICE / HINT

HINT:

- When the cable is disconnected / reconnected to the auxiliary battery terminal, systems temporarily stop operating. However, each system has a function that completes learning the first time the system is used.
 - Learning completes when vehicle is driven

EFFECT/INOPERATIVE FUNCTION WHEN NECESSARY PROCEDURES ARE NOT PERFORMED	NECESSARY PROCEDURES	LINK
Front Camera System	Drive the vehicle straight ahead at 35 km/h (22 mph) or more for 5 seconds or more.	INFO

- Learning completes when vehicle is operated normally

EFFECT/INOPERATIVE FUNCTION WHEN NECESSARY PROCEDURES ARE NOT PERFORMED	NECESSARY PROCEDURES	LINK
Power Door Lock Control System*1 <ul style="list-style-type: none"> Back door opener 	Perform door unlock operation with door control switch or electrical key transmitter sub-assembly switch.	INFO
Power Back Door System*2	Reset back door close position	INFO
Air Conditioning System	After the ignition switch is turned to ON, the servo motor and expansion valve standard position is recognized.	-
*1: w/o Power Back Door System		
*2: w/ Power Back Door System		

- Use the same procedure for the RH side and LH side.
- The following procedure is for the LH side.

CAUTION / NOTICE / HINT

COMPONENTS (REMOVAL)

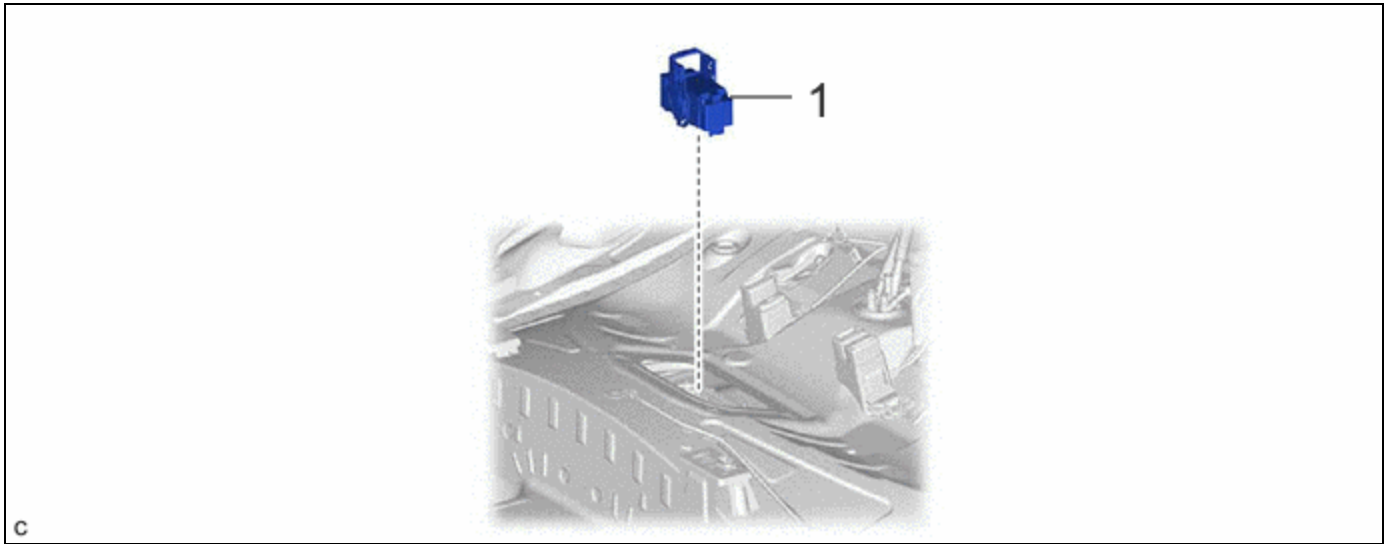

	PROCEDURE	PART NAME CODE	!	📄	⚙️
1	SERVICE PLUG GRIP	G3834	-	-	-

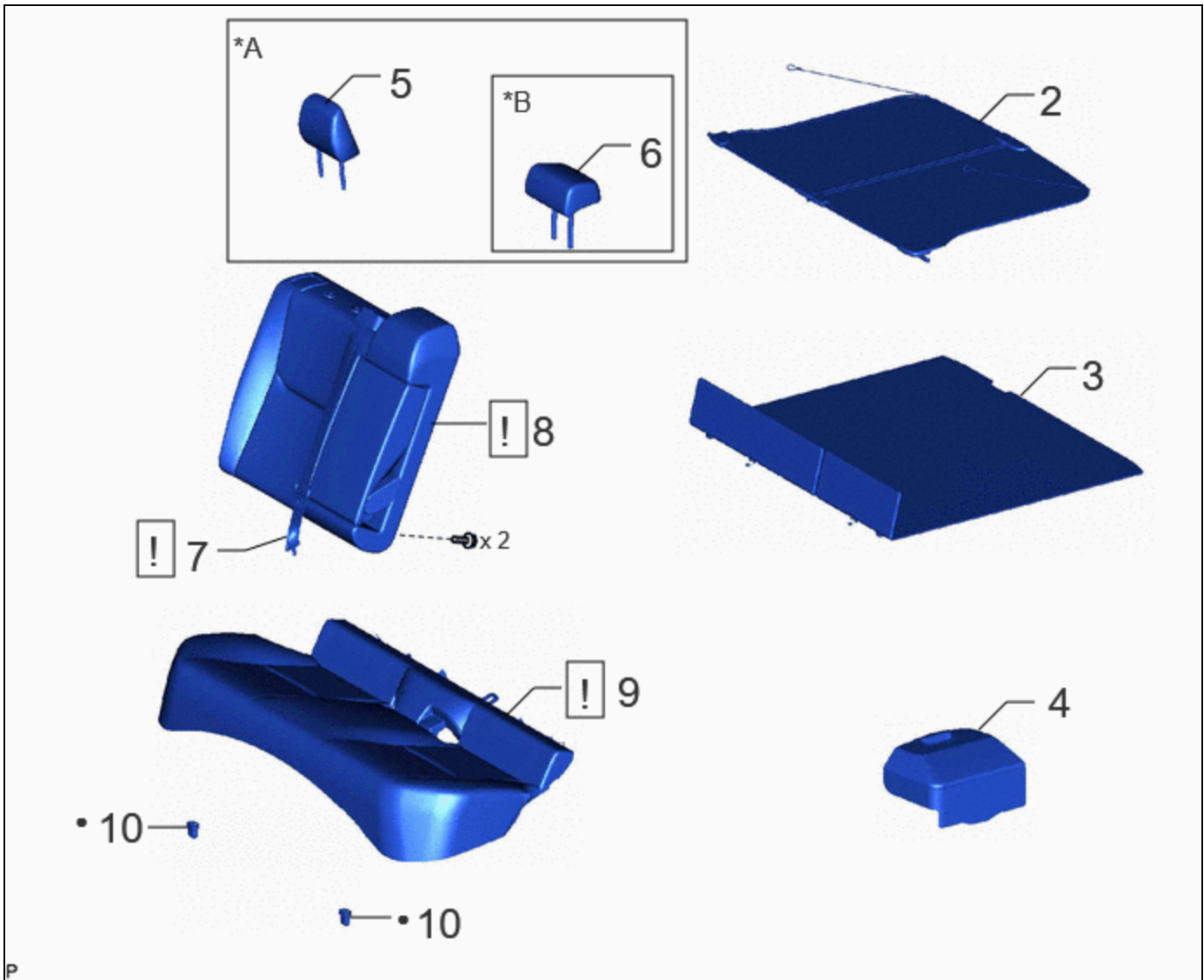

PROCEDURE		PART NAME CODE			
2	TONNEAU COVER ASSEMBLY	64910J	-	-	-
3	DECK BOARD ASSEMBLY	58410B	-	-	-
4	BATTERY SERVICE HOLE COVER ASSEMBLY	58440	-	-	-
5	REAR SEAT HEADREST ASSEMBLY	71940A	-	-	-
6	REAR SEAT CENTER HEADREST ASSEMBLY	71960B	-	-	-
7	REAR CENTER SEAT OUTER BELT ASSEMBLY	73350C	INFO	-	-
8	REAR SEATBACK ASSEMBLY RH	-	INFO	-	-
9	REAR SEAT CUSHION ASSEMBLY	-	INFO	-	-
10	REAR SEAT CUSHION LOCK HOOK	72693	-	-	-

*A	for RH Side	*B	w/ Center Headrest
----	-------------	----	--------------------

•	Non-reusable part	-	-
---	-------------------	---	---

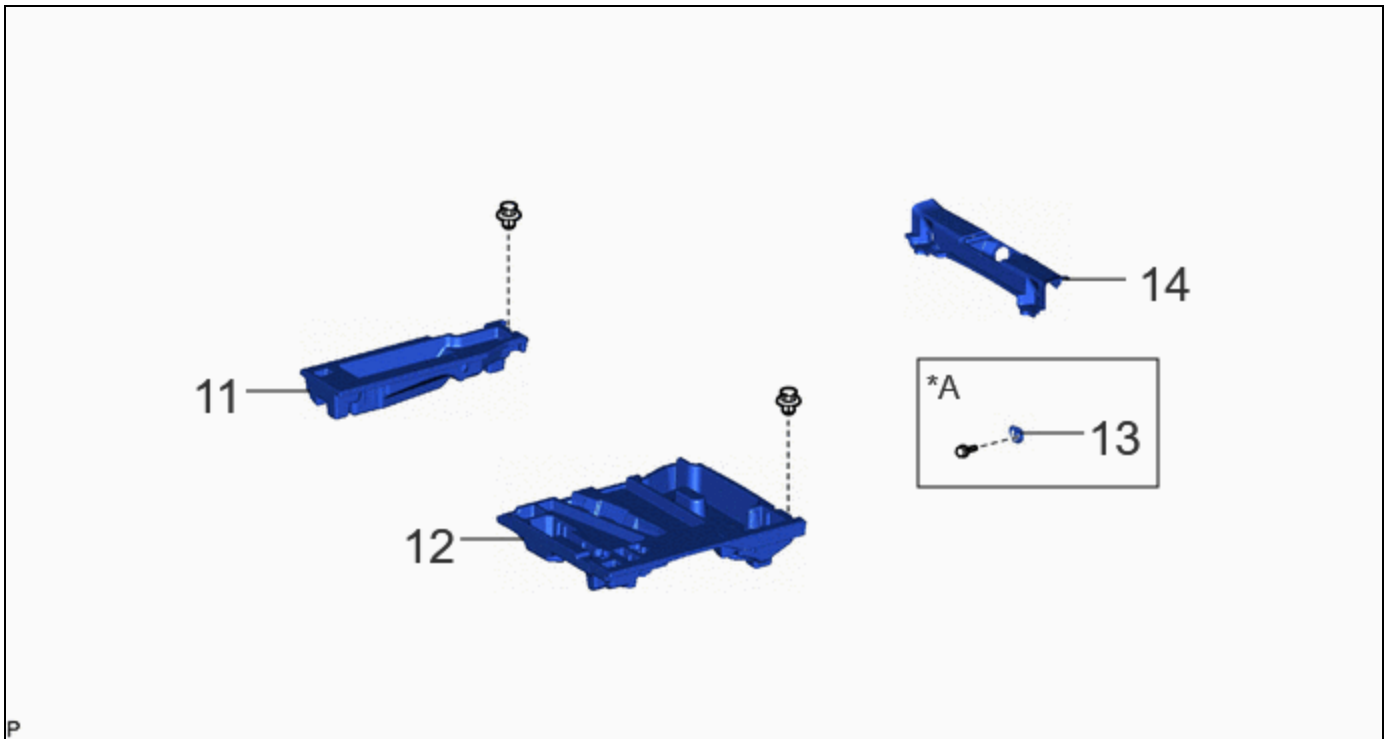

PROCEDURE		PART NAME CODE			
11	DECK FLOOR BOX RH	64995	-	-	-
12	DECK FLOOR BOX LH	64997	-	-	-
13	LUGGAGE HOLD BELT STRIKER ASSEMBLY	58460D	-	-	-
14	REAR DECK TRIM COVER	64716D	-	-	-

*A	for Rear Side	-	-
----	---------------	---	---

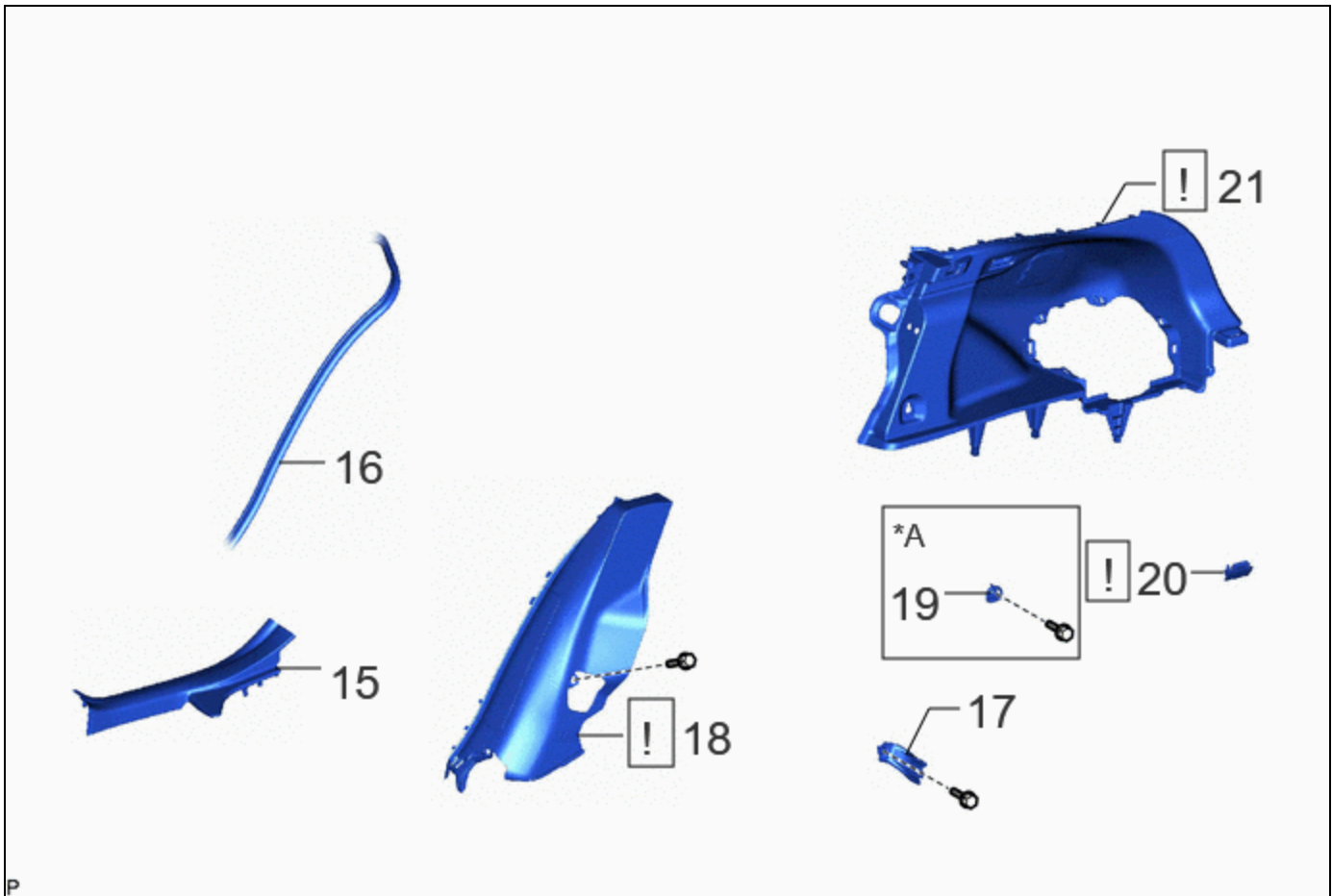

PROCEDURE		PART NAME CODE			
15	REAR DOOR SCUFF PLATE INSIDE RH	67917F	-	-	-
16	REAR DOOR OPENING TRIM WEATHERSTRIP RH	62331A	-	-	-
17	REAR SEAT BACK HINGE SUB-ASSEMBLY RH	71303C	-	-	-
18	REAR SEAT SIDE GARNISH RH	62551F	INFO	-	-
19	LUGGAGE HOLD BELT STRIKER ASSEMBLY	58460D	-	-	-
20	NO. 1 LUGGAGE COMPARTMENT LIGHT ASSEMBLY	81330	INFO	-	-
21	DECK TRIM SIDE PANEL ASSEMBLY RH	64730B	INFO	-	-

*A	for RH Side	-	-
----	-------------	---	---

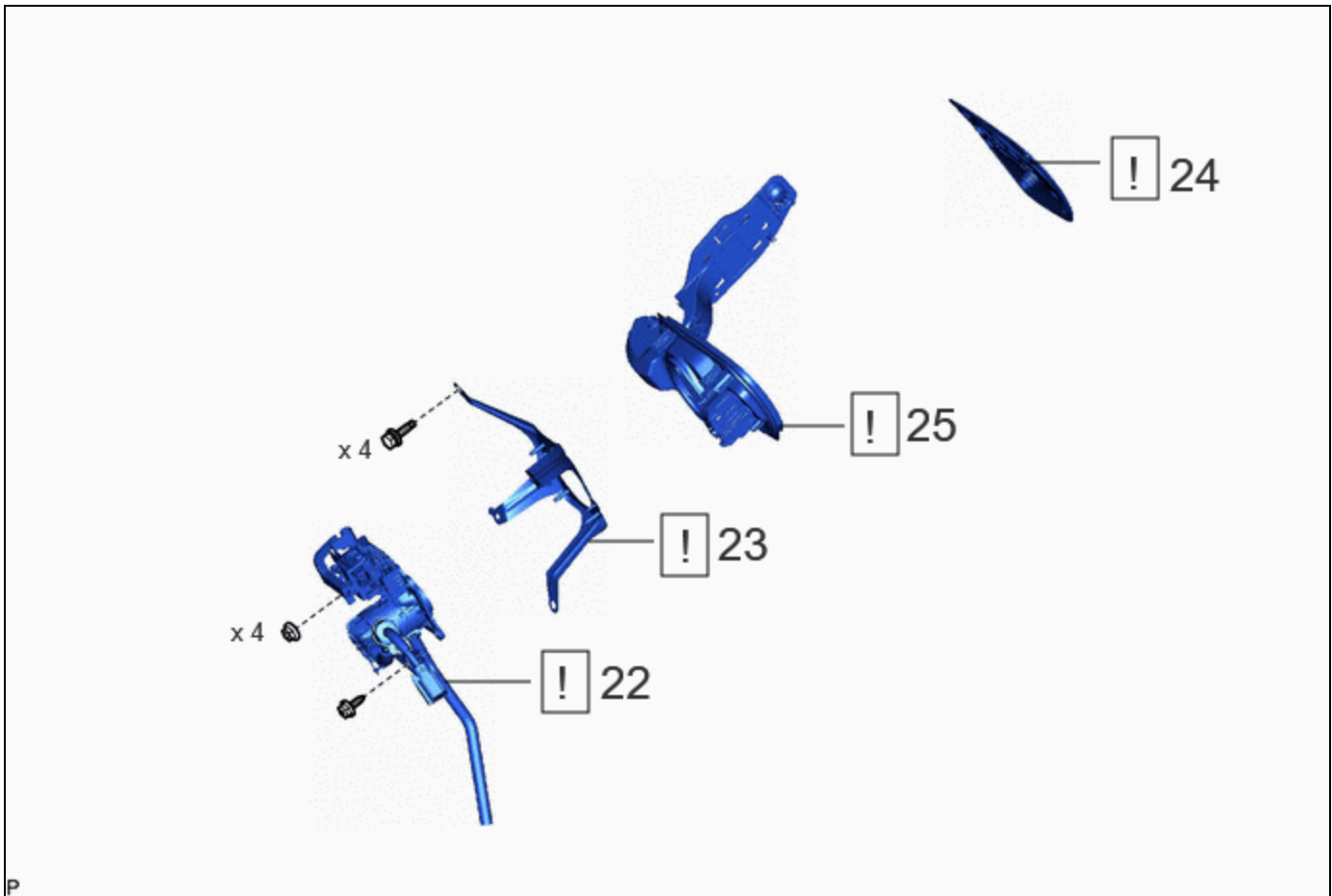

PROCEDURE		PART NAME CODE			
22	AC CHARGER INLET CABLE	G9081C	INFO	-	-
23	FUEL TANK CAP PLATE	-	INFO	-	-
24	BATTERY SERVICE OPENING LID SUB-ASSEMBLY	58209F	INFO	-	-
25	BATTERY CHARGER CONNECTOR OPENING LID SUB-ASSEMBLY	58409E	INFO	-	-

PROCEDURE

1. REMOVE SERVICE PLUG GRIP

Click here [INFO](#)

2. REMOVE TONNEAU COVER ASSEMBLY

Click here [INFO](#)

3. REMOVE DECK BOARD ASSEMBLY

Click here [INFO](#)

4. REMOVE BATTERY SERVICE HOLE COVER ASSEMBLY

Click here [INFO](#)

5. REMOVE REAR SEAT HEADREST ASSEMBLY (for RH Side)

Click here [INFO](#)

6. REMOVE REAR SEAT CENTER HEADREST ASSEMBLY (for RH Side)

(a) w/ Center Headrest:

Click here [INFO](#)

7. DISCONNECT REAR CENTER SEAT OUTER BELT ASSEMBLY

	Click here INFO
---	---------------------------------

8. REMOVE REAR SEATBACK ASSEMBLY RH

	Click here INFO
---	---------------------------------

9. REMOVE REAR SEAT CUSHION ASSEMBLY

	Click here INFO
---	---------------------------------

10. REMOVE REAR SEAT CUSHION LOCK HOOK

Click here [INFO](#)

11. REMOVE DECK FLOOR BOX RH

Click here [INFO](#)

12. REMOVE DECK FLOOR BOX LH

Click here [INFO](#)

13. REMOVE LUGGAGE HOLD BELT STRIKER ASSEMBLY (for Rear Side)

Click here [INFO](#)

14. REMOVE REAR DECK TRIM COVER

Click here [INFO](#)

15. REMOVE REAR DOOR SCUFF PLATE INSIDE RH

(a) Use the same procedure as for the LH side.

Click here [INFO](#)

16. DISCONNECT REAR DOOR OPENING TRIM WEATHERSTRIP RH

(a) Use the same procedure as for the LH side.

Click here [INFO](#)

17. REMOVE REAR SEAT BACK HINGE SUB-ASSEMBLY RH

(a) Use the same procedure as for the LH side.

Click here [INFO](#)

18. REMOVE REAR SEAT SIDE GARNISH RH



HINT:

Use the same procedure as for the LH side.

Click here [INFO](#)

19. REMOVE LUGGAGE HOLD BELT STRIKER ASSEMBLY (for RH Side)

Click here [INFO](#)

20. REMOVE NO. 1 LUGGAGE COMPARTMENT LIGHT ASSEMBLY



Click here [INFO](#)

21. REMOVE DECK TRIM SIDE PANEL ASSEMBLY RH



HINT:

Use the same procedure as for the LH side.

Click here [INFO](#)

22. DISCONNECT AC CHARGER INLET CABLE



CAUTION:

Be sure to wear insulated gloves.

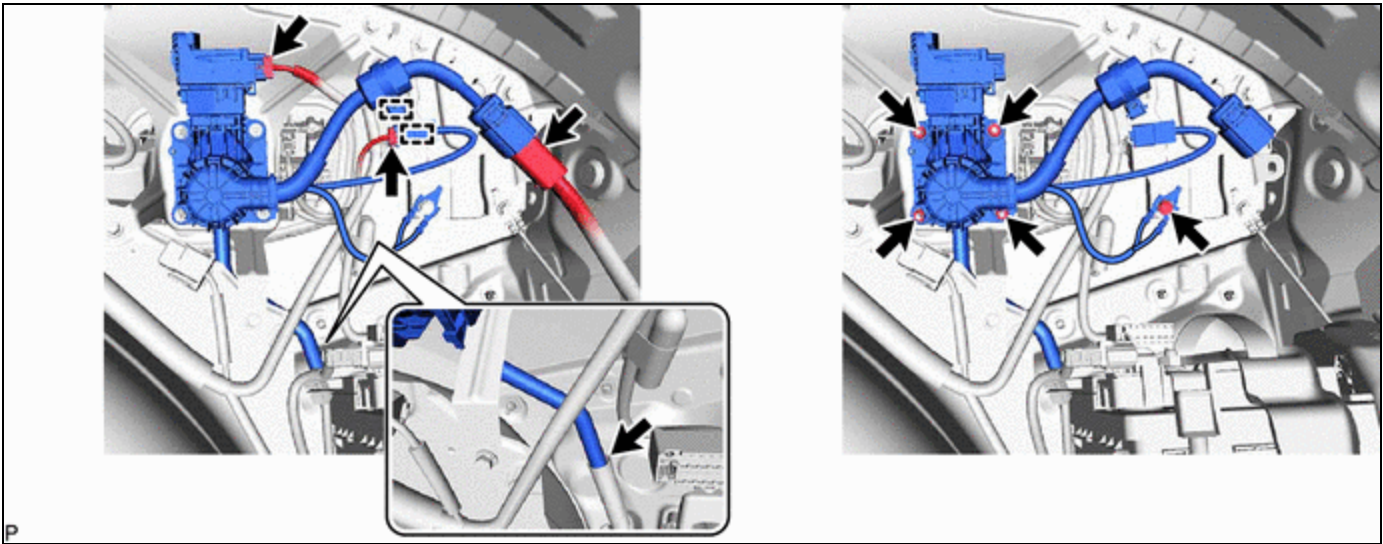

23. REMOVE FUEL TANK CAP PLATE

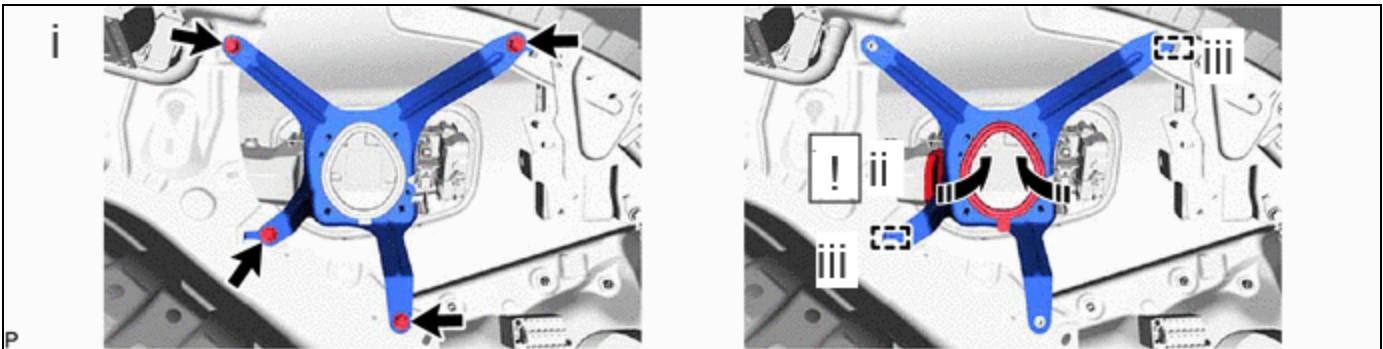

	Disconnect in this Direction	-	-
--	------------------------------	---	---

- (1) Remove the 4 bolts.
- (2) Disconnect the fuel tank cap plate as shown in the illustration.
- (3) Disengage the 2 guides to remove the fuel tank cap plate.

24. REMOVE BATTERY SERVICE OPENING LID SUB-ASSEMBLY

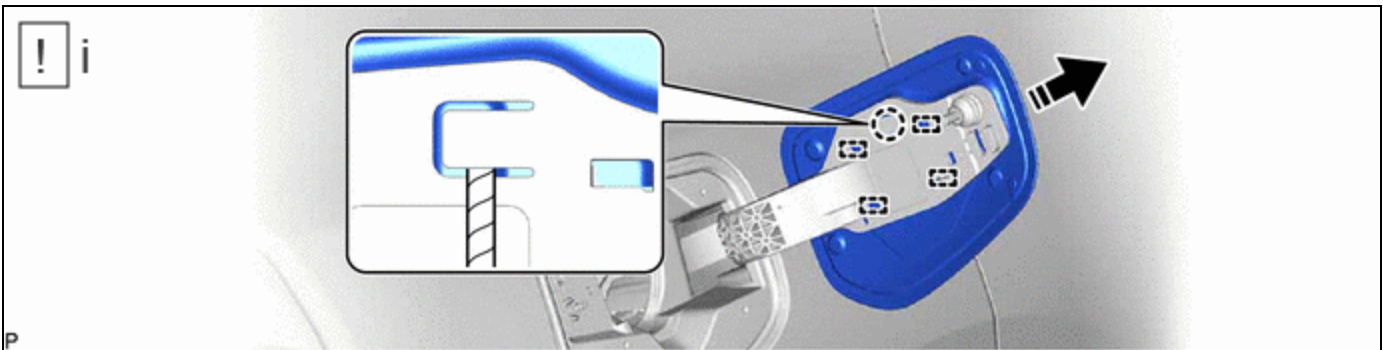

	Remove in this Direction	-	-
--	--------------------------	---	---

- (1) Using a screwdriver with its tip wrapped with protective tape, disengage the claw and 4 guides to remove the fuel filler outer opening lid as shown in the illustration.

25. REMOVE BATTERY CHARGER CONNECTOR OPENING LID SUB-ASSEMBLY

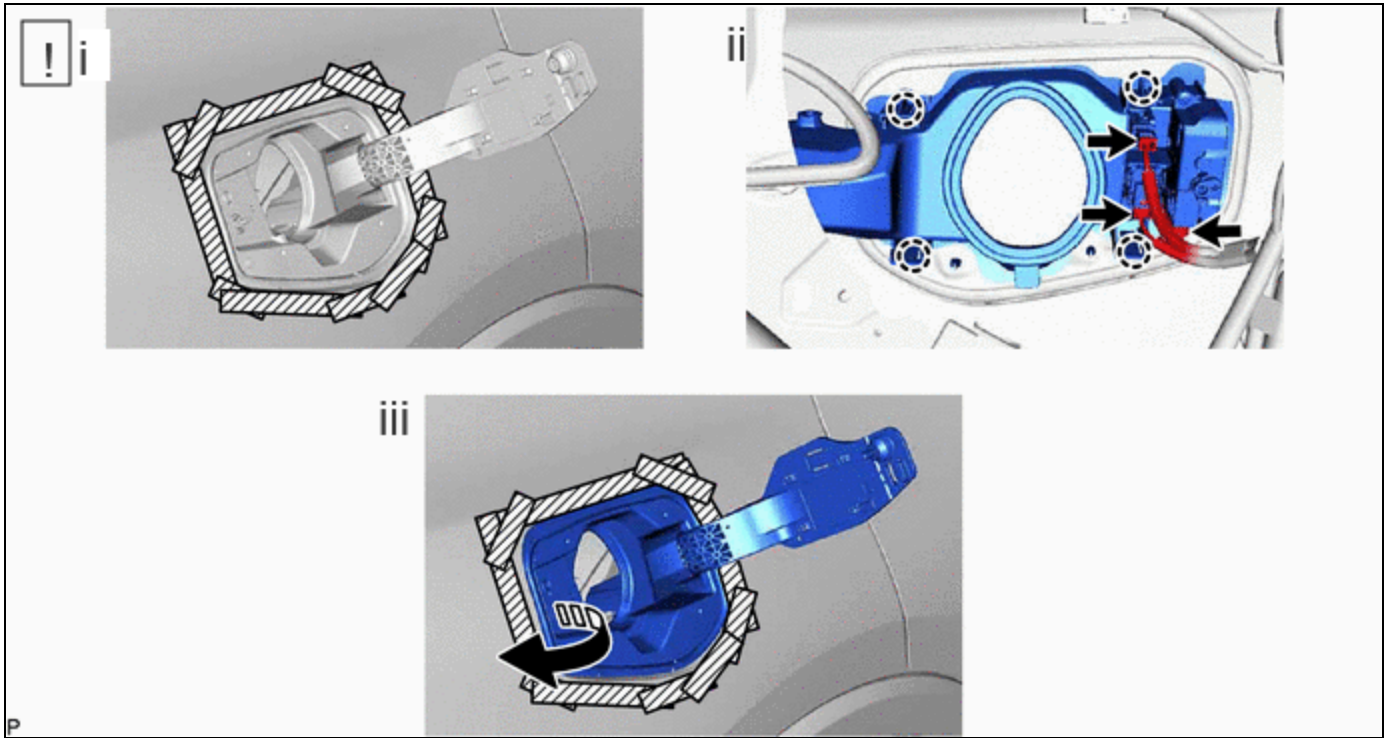

	Remove in this Direction	-	-
---	--------------------------	---	---

- (1) Apply protective tape around the battery charger connector opening lid sub-assembly.
- (2) Disconnect the 3 connectors and 4 claws.
- (3) Remove the battery charger connector opening lid sub-assembly as shown in the illustration.

