

Last Modified: 12-04-2024	6.11:8.1.0	Doc ID: RM100000029HI1
Model Year Start: 2023	Model: Prius	Prod Date Range: [12/2022 -]
Title: REAR SUSPENSION: REAR LOWER ARM (for HEV Model 2WD): REMOVAL; 2023 - 2024 MY Prius [12/2022 -]		

REMOVAL

CAUTION / NOTICE / HINT

The necessary procedures (adjustment, calibration, initialization, or registration) that must be performed after parts are removed and installed, or replaced during rear suspension arm assembly removal/installation are shown below.

Necessary Procedures After Parts Removed/Installed/Replaced

REPLACED PART OR PERFORMED PROCEDURE	NECESSARY PROCEDURE	EFFECT/INOPERATIVE FUNCTION WHEN NECESSARY PROCEDURE NOT PERFORMED	LINK
Rear wheel alignment adjustment	Perform "Calibration"	<ul style="list-style-type: none"> • DTCs are stored • ABS warning light illuminates • Brake system warning light (yellow indicator) illuminates • Slip indicator light illuminates • Electronically controlled brake system disabled or malfunctions 	INFO
Tires	<ul style="list-style-type: none"> • Initialization*1*2 • Tire Position Identification*1*2 	Tire Pressure Warning System	Refer to Procedures Necessary When Replacing Parts (for Tire Pressure Warning System) INFO
	Rear television camera assembly optical axis (Back camera position setting)*3	Parking Assist Monitor System	INFO
	Parking assist ECU initialization*3	Panoramic View Monitor System	INFO
Advanced Park		INFO	
Suspension parts	Rear television camera assembly optical axis (Back camera position	Parking Assist Monitor System	INFO

*1: Also necessary after performing a tire rotation.

*2: It is not necessary to perform this procedure if the tire pressure warning valve and transmitters are installed to the same location.

*3: The vehicle height changes because of suspension or tire replacement.

REPLACED PART OR PERFORMED PROCEDURE	NECESSARY PROCEDURE	EFFECT/INOPERATIVE FUNCTION WHEN NECESSARY PROCEDURE NOT PERFORMED	LINK
	setting)		
	Parking assist ECU initialization	Panoramic View Monitor System	INFO
		Advanced Park	INFO

*1: Also necessary after performing a tire rotation.

*2: It is not necessary to perform this procedure if the tire pressure warning valve and transmitters are installed to the same location.

*3: The vehicle height changes because of suspension or tire replacement.

CAUTION / NOTICE / HINT

HINT:

- Use the same procedure for the RH and LH sides.
- The following procedure is for the LH side.

CAUTION / NOTICE / HINT

COMPONENTS (REMOVAL)

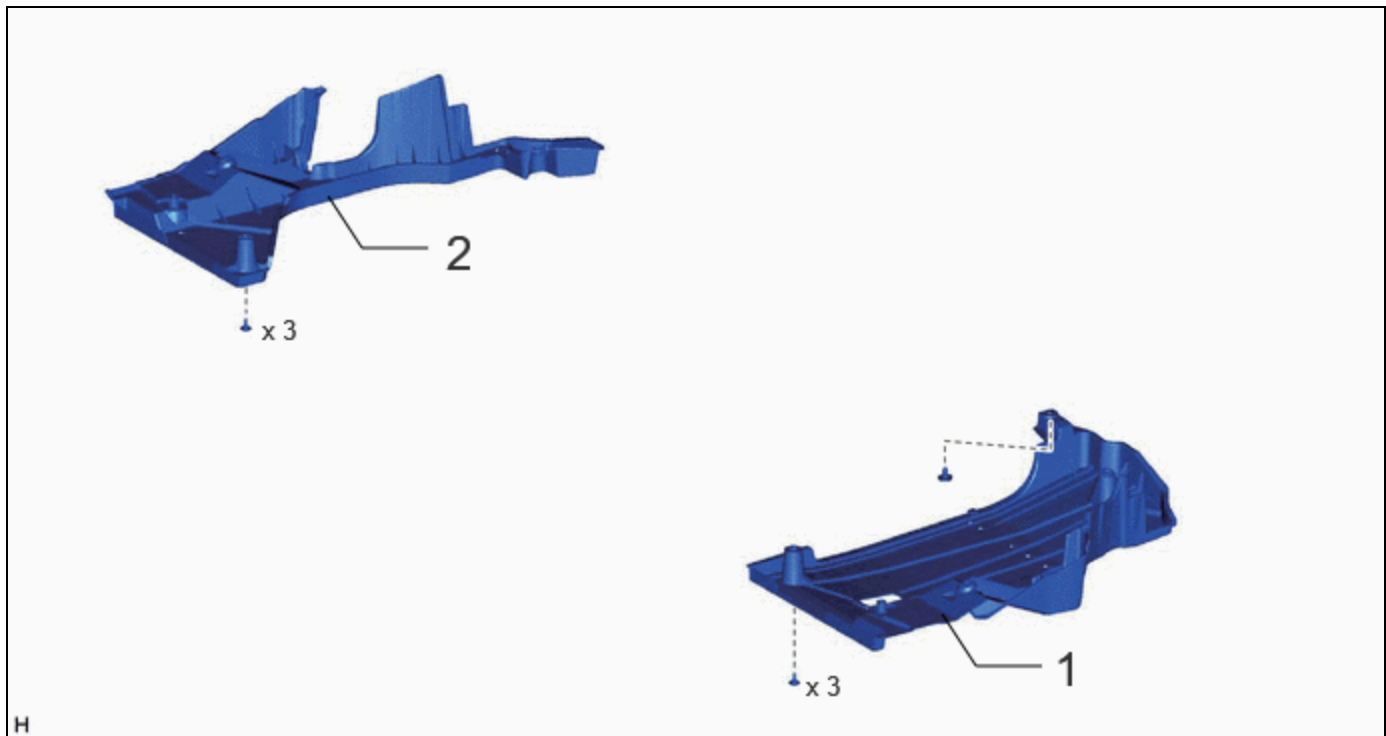

PROCEDURE	PART NAME CODE			
1 REAR FLOOR SIDE MEMBER COVER LH	57628E	-	-	-

	PROCEDURE	PART NAME CODE	!	📄	⚙️
2	REAR FLOOR SIDE MEMBER COVER RH	57627G	-	-	-

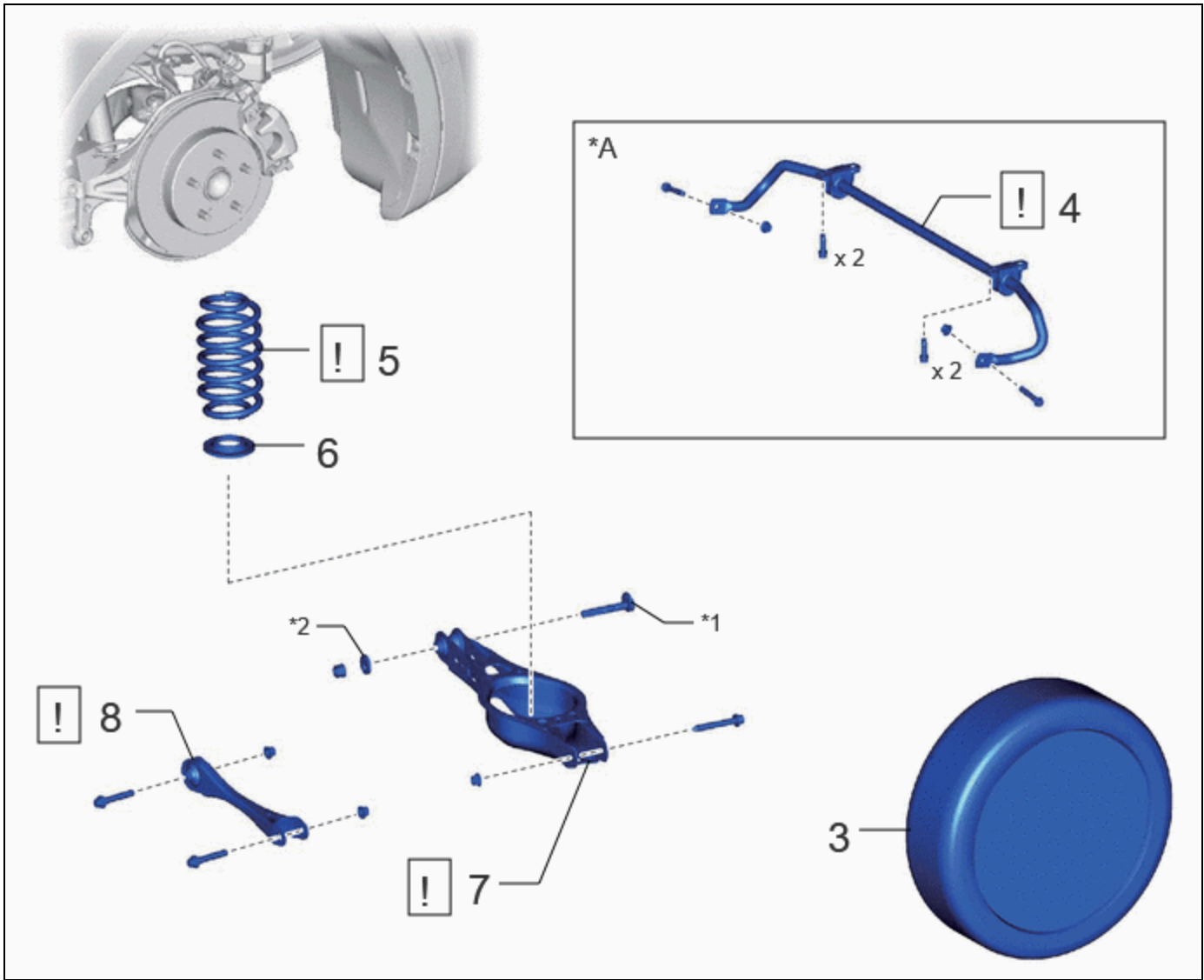

	PROCEDURE	PART NAME CODE	!	📄	⚙️
3	REAR WHEEL	-	-	-	-
4	REAR STABILIZER BAR	48812	INFO	-	-
5	REAR COIL SPRING	48231B	INFO	-	-
6	REAR LOWER COIL SPRING INSULATOR	48258C	-	-	-
7	REAR NO. 2 SUSPENSION ARM ASSEMBLY	48740F	INFO	-	-
8	REAR NO. 1 SUSPENSION ARM ASSEMBLY	48720A	INFO	-	-

*A	w/ Stabilizer Bar	-	-
*1	REAR SUSPENSION TOE ADJUST CAM SUB-ASSEMBLY	*2	NO. 2 CAMBER ADJUST CAM

PROCEDURE

1. REMOVE REAR FLOOR SIDE MEMBER COVER LH

Click here [INFO](#)

2. REMOVE REAR FLOOR SIDE MEMBER COVER RH

Click here [INFO](#)

3. REMOVE REAR WHEEL

Click here [INFO](#)

4. REMOVE REAR STABILIZER BAR (w/ Stabilizer Bar)

	Click here INFO
---	---------------------------------

5. REMOVE REAR COIL SPRING

	Click here INFO
---	---------------------------------

6. REMOVE REAR LOWER COIL SPRING INSULATOR

Click here [INFO](#)

7. REMOVE REAR NO. 2 SUSPENSION ARM ASSEMBLY

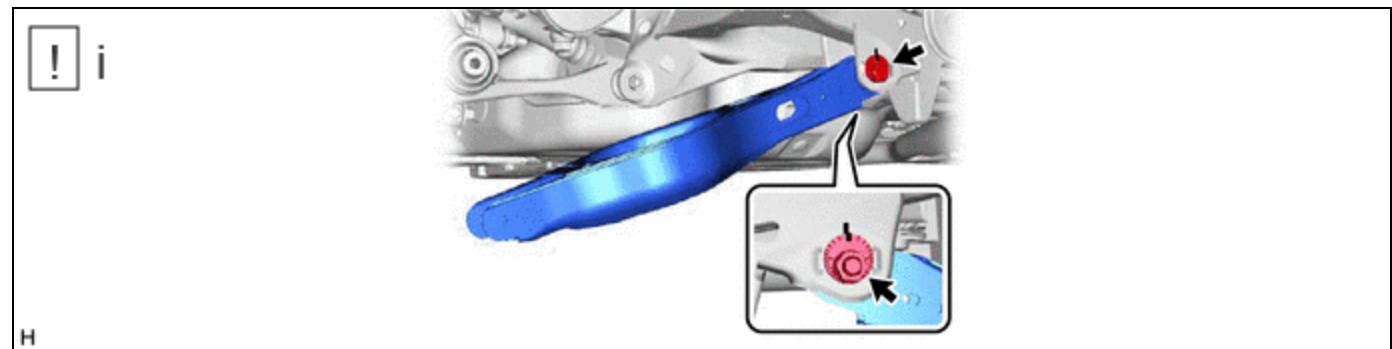

- (1) Remove the nut, No. 2 camber adjust cam, rear suspension toe adjust cam sub-assembly and rear No. 2 suspension arm assembly.

NOTICE:

Hold the rear suspension toe adjust cam sub-assembly while rotating the nut.

8. REMOVE REAR NO. 1 SUSPENSION ARM ASSEMBLY

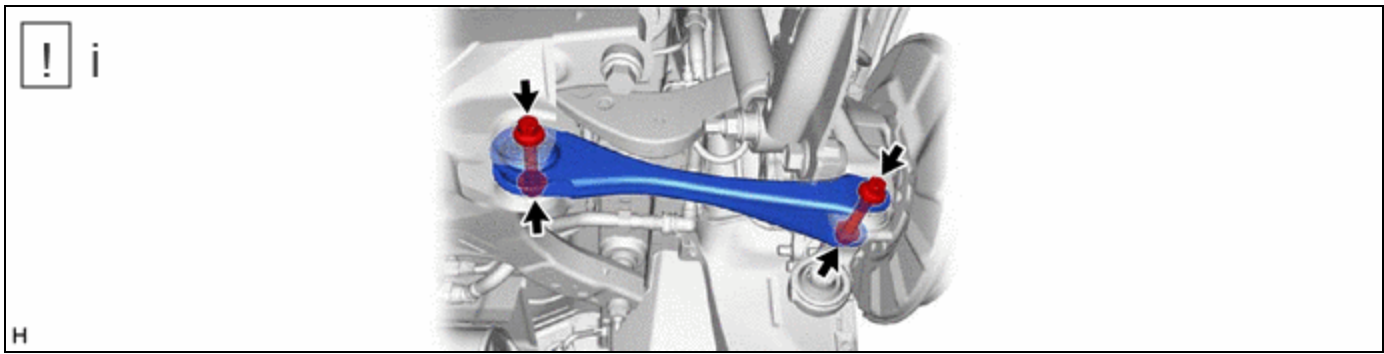

- (1) Remove the 2 bolts, 2 nuts and rear No. 1 suspension arm assembly from the rear axle carrier sub-assembly and rear suspension member sub-assembly.

NOTICE:

Because the nut has its own stopper, do not turn the nut. Loosen the bolt with the nut secured.

