

Last Modified: 12-04-2024	6.11:8.1.0	Doc ID: RM100000002BO77
Model Year Start: 2023	Model: Prius Prime	Prod Date Range: [03/2023 -]
Title: FRONT SUSPENSION: FRONT LOWER BALL JOINT: REMOVAL; 2023 - 2024 MY Prius Prius Prime [03/2023 -]		

REMOVAL

CAUTION / NOTICE / HINT

The necessary procedures (adjustment, calibration, initialization, or registration) that must be performed after parts are removed and installed, or replaced during front lower ball joint assembly removal/installation are shown below.

Necessary Procedures After Parts Removed/Installed/Replaced

REPLACED PART OR PERFORMED PROCEDURE	NECESSARY PROCEDURE	EFFECT/INOPERATIVE FUNCTION WHEN NECESSARY PROCEDURE NOT PERFORMED	LINK
Front wheel alignment adjustment	Perform "Calibration"	<ul style="list-style-type: none"> • DTCs are stored • ABS warning light illuminates • Brake system warning light (yellow indicator) illuminates • Slip indicator light illuminates • Electronically controlled brake system disabled or malfunctions 	INFO
Tires	<ul style="list-style-type: none"> • Initialization*1*2 • Tire Position Identification*1*2 	Tire Pressure Warning System	Refer to Procedures Necessary When Replacing Parts (for Tire Pressure Warning System) table below INFO
	Rear television camera assembly optical axis (Back camera position setting)	Parking Assist Monitor System	INFO
	Parking assist ECU initialization*3	Panoramic View Monitor System	INFO
		Advanced Park	INFO

*1: Also necessary after performing a tire rotation.

*2: It is not necessary to perform this procedure if the tire pressure warning valve and transmitters are installed to the same location.

*3: The vehicle height changes because of tire replacement.

HINT:

When the cable is disconnected / reconnected to the auxiliary battery terminal, systems temporarily stop operating. However, each system has a function that completes learning the first time the system is used.

Learning completes when vehicle is driven

EFFECT/INOPERATIVE FUNCTION WHEN NECESSARY PROCEDURE NOT PERFORMED	NECESSARY PROCEDURE	LINK
Front Camera System	Drive the vehicle straight ahead at 35 km/h (22 mph) or more for 5 second or more.	INFO

Learning completes when vehicle is operated normally

EFFECT/INOPERATIVE FUNCTION WHEN NECESSARY PROCEDURE NOT PERFORMED	NECESSARY PROCEDURE	LINK
Power Door Lock Control System*1 <ul style="list-style-type: none"> Back door opener 	Perform door unlock operation with door control switch or electrical key transmitter sub-assembly switch.	INFO
Power Back Door System*2	Reset back door close position	INFO
Air Conditioning System	<p>for HEV Model:</p> <p>After the ignition switch is turned to ON, the servo motor standard position is recognized.</p> <p>for PHEV Model:</p> <p>After the ignition switch is turned to ON, the servo motor and expansion valve standard position is recognized.</p>	-
*1: w/o Power Back Door System		
*2: w/ Power Back Door System		

NOTICE:

- When the brake pedal is first depressed after replacing the brake pads or pushing back the disc brake piston, DTCs may be stored. As there is no malfunction, clear the DTC.
- While the auxiliary battery is connected, even if the ignition switch is off, the brake control system activates when the brake pedal is depressed or any door courtesy switch turns on. Therefore, when servicing the brake system components, do not operate the brake pedal or open/close the doors while the auxiliary battery is connected.

HINT:

- Use the same procedure for the RH side and LH side.
- The following procedure is for the LH side.

CAUTION / NOTICE / HINT

COMPONENTS (REMOVAL)

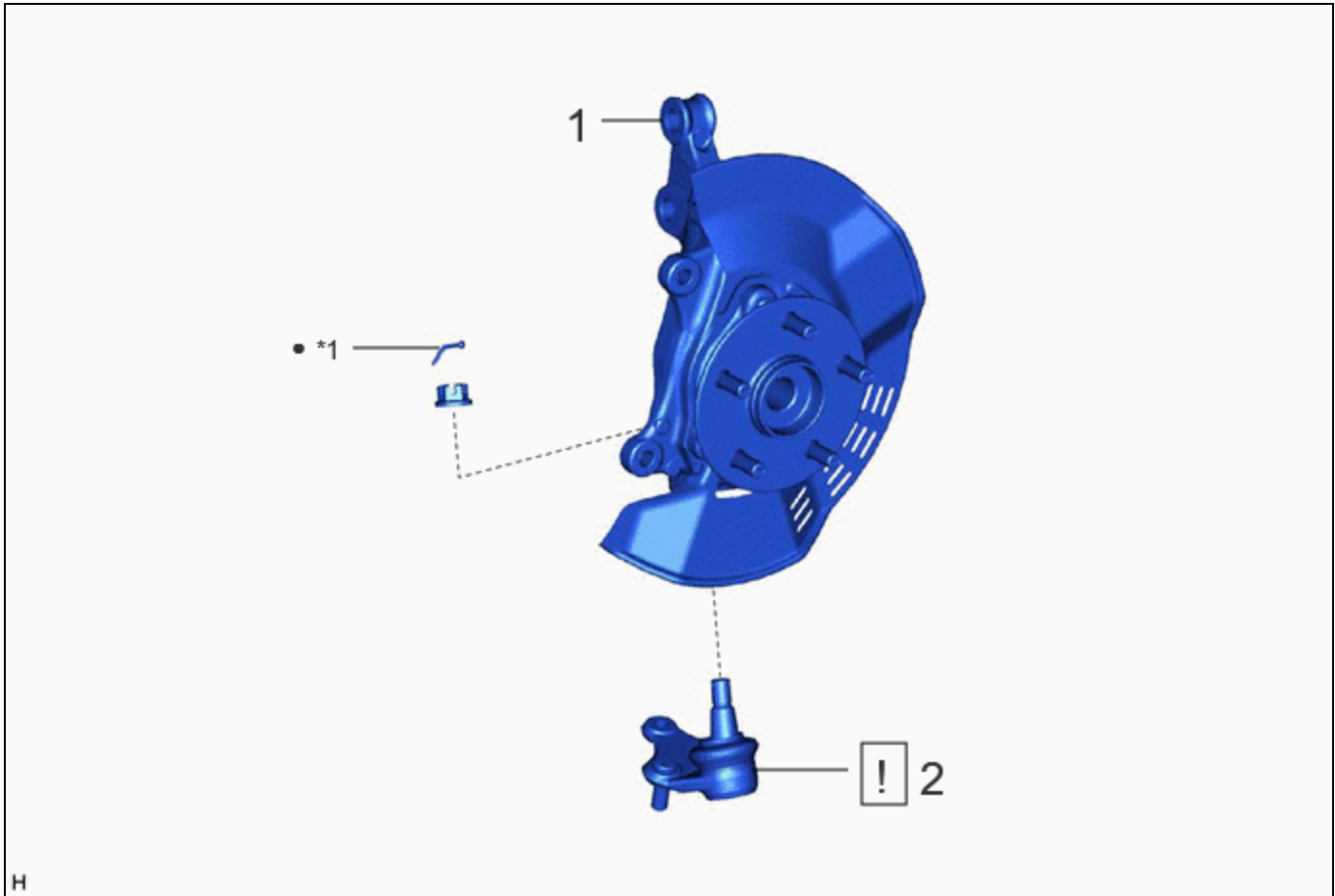

PROCEDURE		PART NAME CODE			
1	FRONT AXLE ASSEMBLY	-	-	-	-
2	FRONT LOWER BALL JOINT ASSEMBLY	43340A	INFO	-	-

*1	COTTER PIN	-	-
•	Non-reusable part	-	-

PROCEDURE

1. REMOVE FRONT AXLE ASSEMBLY

Click here [INFO](#)

2. REMOVE FRONT LOWER BALL JOINT ASSEMBLY

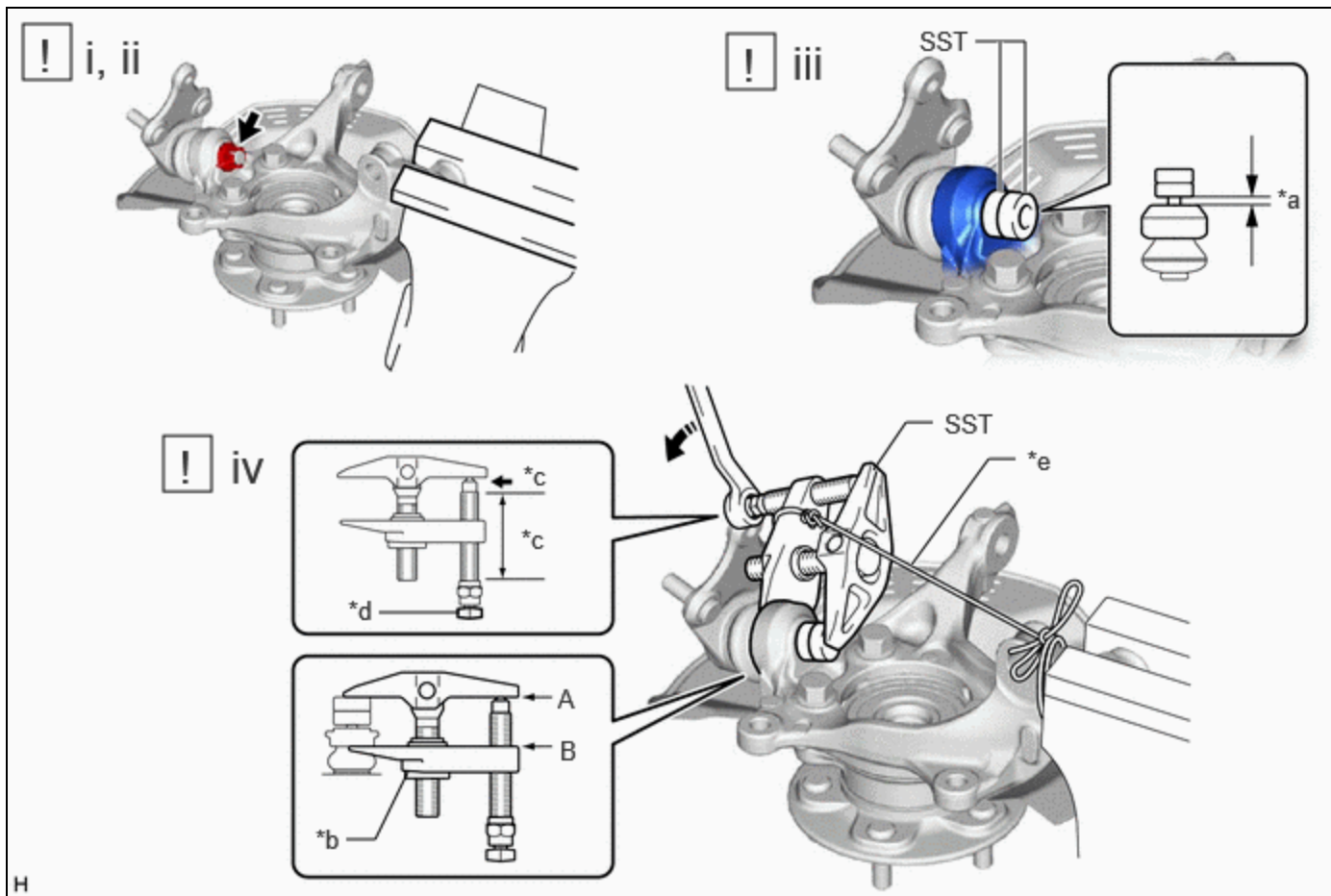

*a	1 mm (0.0394 in.)	*b	Center Nut
*c	Molybdenum Grease Application Area	*d	Place wrench here
*e	String	-	-
	Turn	-	-

(1) Secure the front axle assembly in a vise using aluminum plates.

NOTICE:

Do not overtighten the vise.

(2) Remove the cotter pin and nut.

(3) Install SST to the front lower ball joint assembly as shown in the illustration.

SST: 09960-20010

09961-02050

NOTICE:

Check that the clearance measurement between SST and the front axle assembly is 1 mm (0.0394 in.).

(4) Using SST, remove the front lower ball joint assembly from the front axle assembly as shown in the illustration.

SST: 09960-20010

09961-02010

09961-02050

CAUTION:

Apply molybdenum grease to the threads and end of the SST bolt.

NOTICE:

- Be sure to tighten the string firmly to secure SST to the front axle assembly to prevent SST from falling off.
- Install SST with the center nut so that (A) and (B) shown in the illustration are parallel. Otherwise, the front lower ball joint dust cover may be damaged.
- Be sure to place a wrench on the part shown in the illustration.
- Do not damage the front lower ball joint dust cover.
- Do not damage the steering knuckle.
- Do not damage the front disc brake dust cover.

