

Last Modified: 12-04-2024	6.11:8.1.0	Doc ID: RM100000002C013
Model Year Start: 2023	Model: Prius Prime	Prod Date Range: [03/2023 -]
Title: POWER DISTRIBUTION: MAIN BODY ECU: REMOVAL; 2023 - 2024 MY Prius Prius Prime [03/2023 -]		

REMOVAL

CAUTION / NOTICE / HINT

The necessary procedures (adjustment, calibration, initialization or registration) that must be performed after parts are removed and installed, or replaced during main body ECU (multiplex network body ECU) removal/installation are shown below.

Necessary Procedure After Parts Removed/Installed/Replaced

REPLACED PART OR PERFORMED PROCEDURE	NECESSARY PROCEDURE	EFFECT/INOPERATIVE FUNCTION WHEN NECESSARY PROCEDURE NOT PERFORMED	LINK
Main body ECU (multiplex network body ECU)	ECU configuration	-	INFO
	Code registration	<ul style="list-style-type: none"> • Wireless Door Lock Control System • Smart Key System (for Entry function) • Smart Key System (for Start function) • Hybrid control system cannot be started • Digital Key System 	INFO

NOTICE:

After turning the ignition switch off, waiting time may be required before disconnecting the cable from the negative (-) auxiliary battery terminal.

Click here [INFO](#)

HINT:

When the cable is disconnected/reconnected to the auxiliary battery terminal, systems temporarily stop operating. However, each system has a function that completes learning the first time the system is used.

Items for which learning is completed by driving the vehicle

EFFECT/INOPERATIVE FUNCTION WHEN NECESSARY PROCEDURES ARE NOT PERFORMED	NECESSARY PROCEDURES	LINK
Front Camera System	Drive the vehicle straight ahead at 35 km/h (22 mph) or more for 5 second or more.	INFO



Items for which learning is completed by operating the vehicle normally

EFFECT/INOPERATIVE FUNCTION WHEN NECESSARY PROCEDURES ARE NOT PERFORMED	NECESSARY PROCEDURES	LINK
Power Door Lock Control System*1 <ul style="list-style-type: none"> ◦ Back door opener 	Perform door unlock operation with door control switch or electrical key transmitter sub-assembly	INFO
*1: w/o Power Back Door System		
*2: w/ Power Back Door System		

EFFECT/INOPERATIVE FUNCTION WHEN NECESSARY PROCEDURES ARE NOT PERFORMED	NECESSARY PROCEDURES	LINK
	switch.	
Power Back Door System*2	Reset back door close position	INFO
Air Conditioning System	<p>for HEV Model: After the ignition switch is turned to ON, the servo motor standard position is recognized.</p> <p>for PHEV Model: After the ignition switch is turned to ON, the servo motor and expansion valve standard position is recognized.</p>	-
<p>*1: w/o Power Back Door System</p> <p>*2: w/ Power Back Door System</p>		

CAUTION / NOTICE / HINT

COMPONENTS (REMOVAL)

	PROCEDURE	PART NAME CODE			
7	FRONT DOOR OPENING TRIM WEATHERSTRIP LH	62312B	-	-	-
8	INSTRUMENT SIDE PANEL LH	55318C	-	-	-
9	LOWER INSTRUMENT PANEL FINISH PANEL ASSEMBLY	55480D	-	-	-
10	LOWER NO. 1 INSTRUMENT PANEL AIRBAG ASSEMBLY	73900	INFO	-	-
11	INSTRUMENT CLUSTER FINISH PANEL ASSEMBLY	55410C	INFO	-	-
12	NO. 1 INSTRUMENT PANEL GARNISH SUB-ASSEMBLY	55011A	-	-	-
13	NO. 2 KNEE PROTECTOR BRACKET	55462C	-	-	-
14	NO. 3 INSTRUMENT PANEL TO COWL BRACE SUB-ASSEMBLY	55308B	-	-	-
15	JUNCTION BLOCK BRACKET WITH POWER DISTRIBUTION BOX ASSEMBLY	-	INFO	-	-
16	POWER DISTRIBUTION BOX ASSEMBLY	82730G	-	-	-
17	MAIN BODY ECU (MULTIPLEX NETWORK BODY ECU)	89221	INFO	-	-

*A	w/o Knee Airbag	*B	w/ Knee Airbag
*1	JUNCTION BLOCK BRACKET	-	-

PROCEDURE

1. PRECAUTION

	<p>NOTICE:</p> <ul style="list-style-type: none"> Do not remove the main body ECU (multiplex network body ECU) except when replacing it. When removing the main body ECU (multiplex network body ECU), always replace it with a new one.
---	---

2. DISCONNECT CABLE FROM NEGATIVE AUXILIARY BATTERY TERMINAL

(a) for M20A-FXS:

Click here [INFO](#)

(b) for 2ZR-FXE:

Click here [INFO](#)

3. REMOVE FRONT DOOR SCUFF PLATE LH

Click here [INFO](#)

4. REMOVE COWL SIDE TRIM BOARD LH

Click here [INFO](#)

5. REMOVE NO. 1 INSTRUMENT PANEL UNDER COVER SUB-ASSEMBLY

Click here [INFO](#)

6. REMOVE LOWER CENTER INSTRUMENT PANEL FINISH PANEL

Click here [INFO](#)

7. DISCONNECT FRONT DOOR OPENING TRIM WEATHERSTRIP LH

Click here [INFO](#)

8. REMOVE INSTRUMENT SIDE PANEL LH

Click here [INFO](#)

9. REMOVE LOWER INSTRUMENT PANEL FINISH PANEL ASSEMBLY

Click here [INFO](#)

10. REMOVE LOWER NO. 1 INSTRUMENT PANEL AIRBAG ASSEMBLY (w/ Knee Airbag)

	Click here INFO
---	---------------------------------

11. REMOVE INSTRUMENT CLUSTER FINISH PANEL ASSEMBLY

	Click here INFO
--	---------------------------------

12. REMOVE NO. 1 INSTRUMENT PANEL GARNISH SUB-ASSEMBLY

Click here [INFO](#)

13. REMOVE NO. 2 KNEE PROTECTOR BRACKET

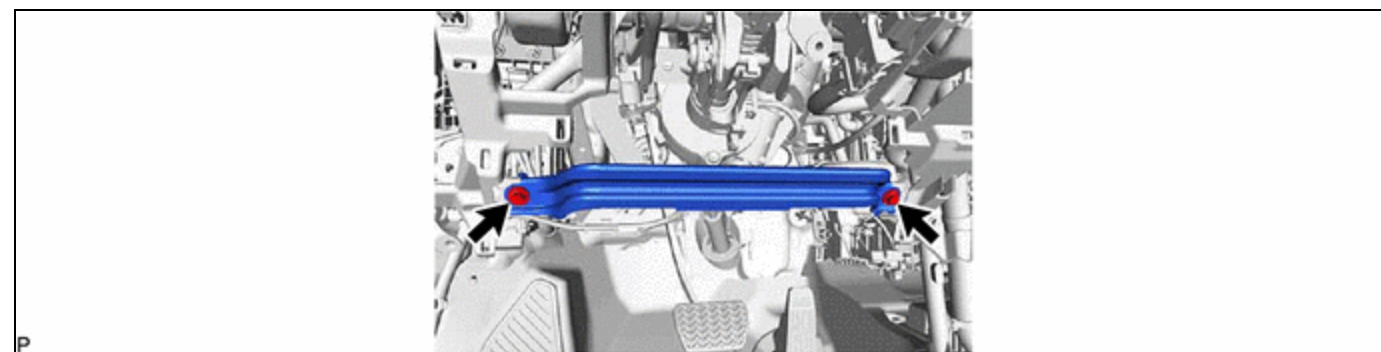

14. REMOVE NO. 3 INSTRUMENT PANEL TO COWL BRACE SUB-ASSEMBLY

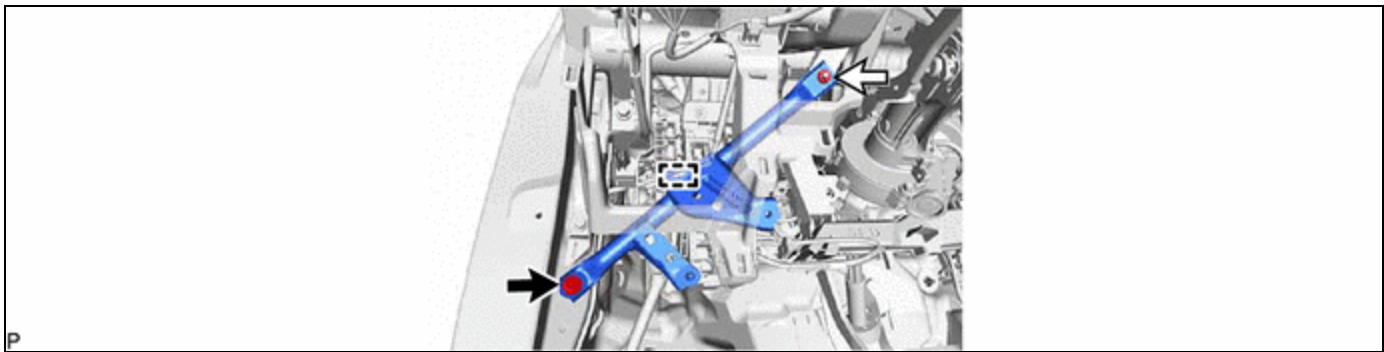

	Bolt		Nut
---	------	---	-----

15. REMOVE JUNCTION BLOCK BRACKET WITH POWER DISTRIBUTION BOX ASSEMBLY

	NOTICE:
<p>When disconnecting a wire harness of any component connected to the supply power of the integrated capacitor (integration control supply) or when removing the integrated capacitor (integration control supply), make sure to wait 5 minutes or more after turning the ignition switch off for self-diagnosis to complete and the voltage of the integrated capacitor (integration control supply) to discharge.</p>	

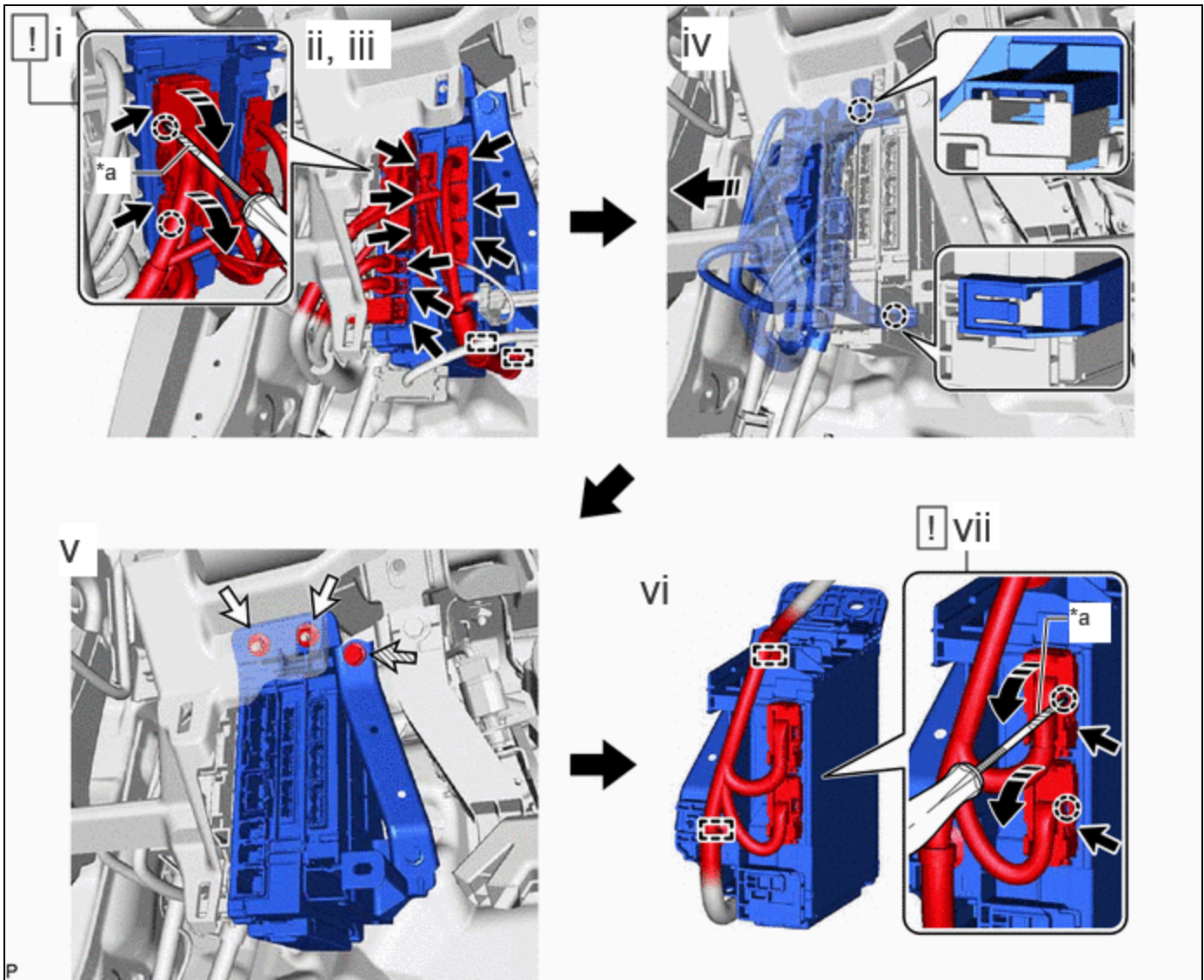

*a	Protective Tape	-	-
	Remove in this Direction		Connector
	Nut		Bolt

- (1) Using a thin-bladed screwdriver with its tip wrapped with protective tape, disengage the 2 claws and disconnect the 2 lever connectors.
- (2) Disconnect the 8 connectors.
- (3) Disengage the 2 clamps.
- (4) As shown in the illustration, disengage the clamp and claw and disconnect the connector holder.
- (5) Remove the bolt and 2 nuts.
- (6) Disengage the 2 clamps.
- (7) Using a thin-bladed screwdriver with its tip wrapped with protective tape, disengage the 2 claws, disconnect the 2 lever connectors, and remove the junction block bracket with power distribution box assembly.

16. REMOVE POWER DISTRIBUTION BOX ASSEMBLY

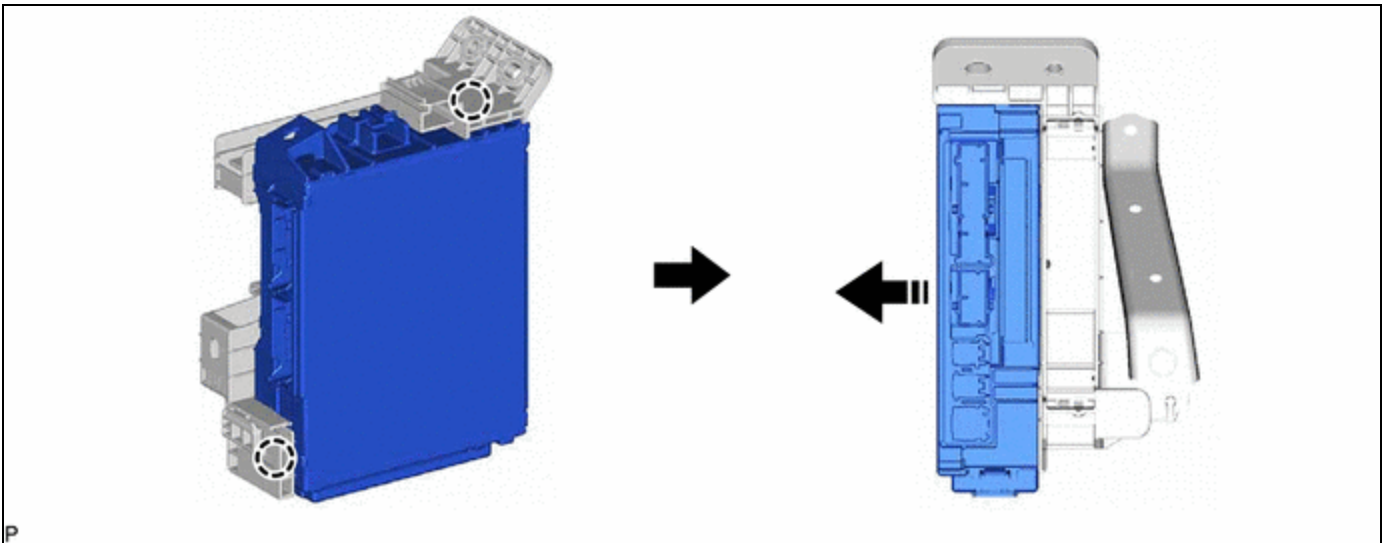

17. REMOVE MAIN BODY ECU (MULTIPLEX NETWORK BODY ECU)

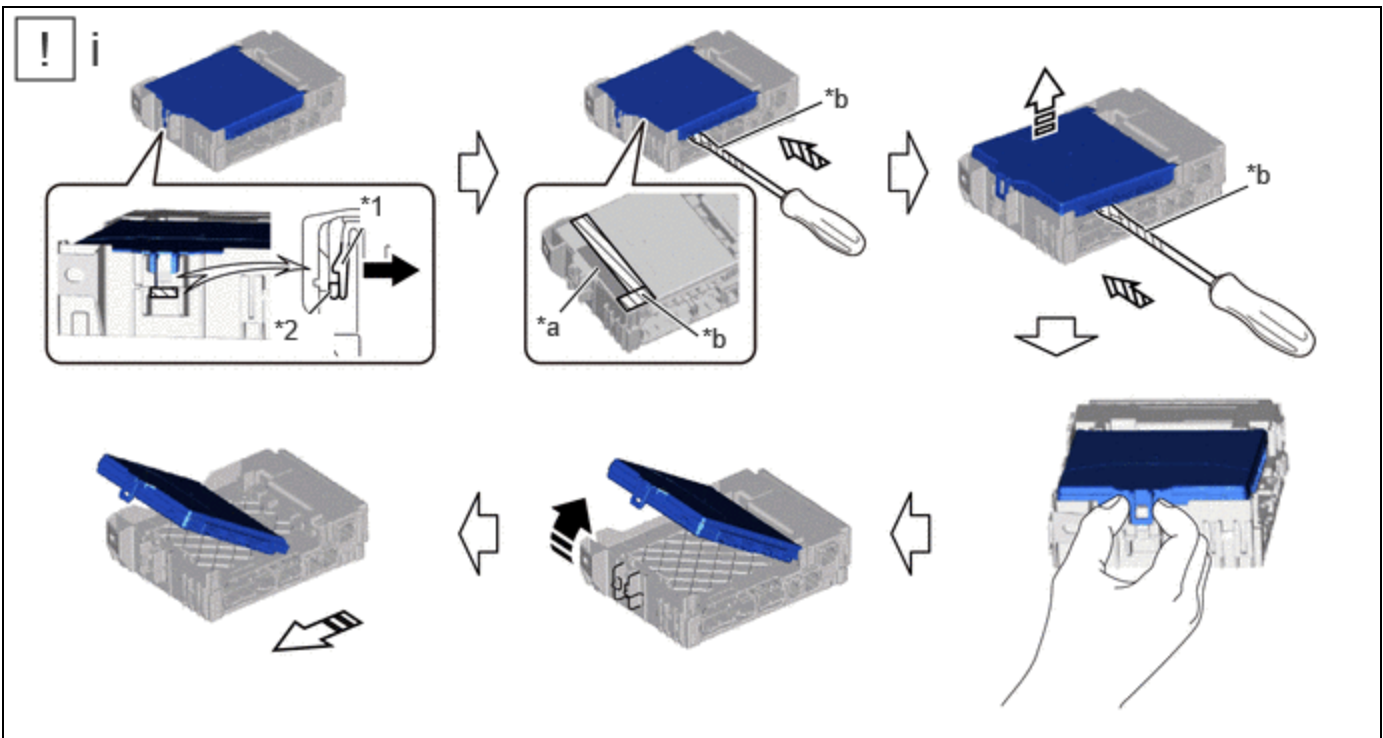

*1	POWER DISTRIBUTION BOX	*2	MAIN BODY ECU (MULTIPLEX NETWORK BODY ECU)
*a	Internal Connector	*b	Protective Tape
	Push in this Direction		Insert in this Direction
	Rotate in this Direction		Remove in this Direction

(1) Remove the main body ECU (multiplex network body ECU) using the following procedure.

1. Press the lock of the power distribution box and release the lock of the main body ECU (multiplex network body ECU) as shown in the illustration.
2. While pressing the lock, horizontally insert a thin-bladed screwdriver with its tip wrapped with protective tape between the main body ECU (multiplex network body ECU) and power distribution box (near the internal connector).
3. When the thin-bladed screwdriver with its tip wrapped with protective tape is inserted, the internal connector lock is released.

NOTICE:

Replace the power distribution box when the connector terminal, the locking section, or the case is damaged or deformed.

4. Hold the rib of the main body ECU (multiplex network body ECU).
5. While rotating the main body ECU (multiplex network body ECU), completely release the lock.
6. Remove the main body ECU (multiplex network body ECU) from the power distribution box.

