

Last Modified: 12-04-2024	6.11:8.1.0	Doc ID: RM1000000028K53
Model Year Start: 2023	Model: Prius Prime	Prod Date Range: [12/2022 -]
Title: MAINTENANCE: TRANSMITTER BATTERY: INSTALLATION; 2023 - 2024 MY Prius Prius Prime [12/2022 -]		

INSTALLATION

CAUTION / NOTICE / HINT

COMPONENTS (INSTALLATION)

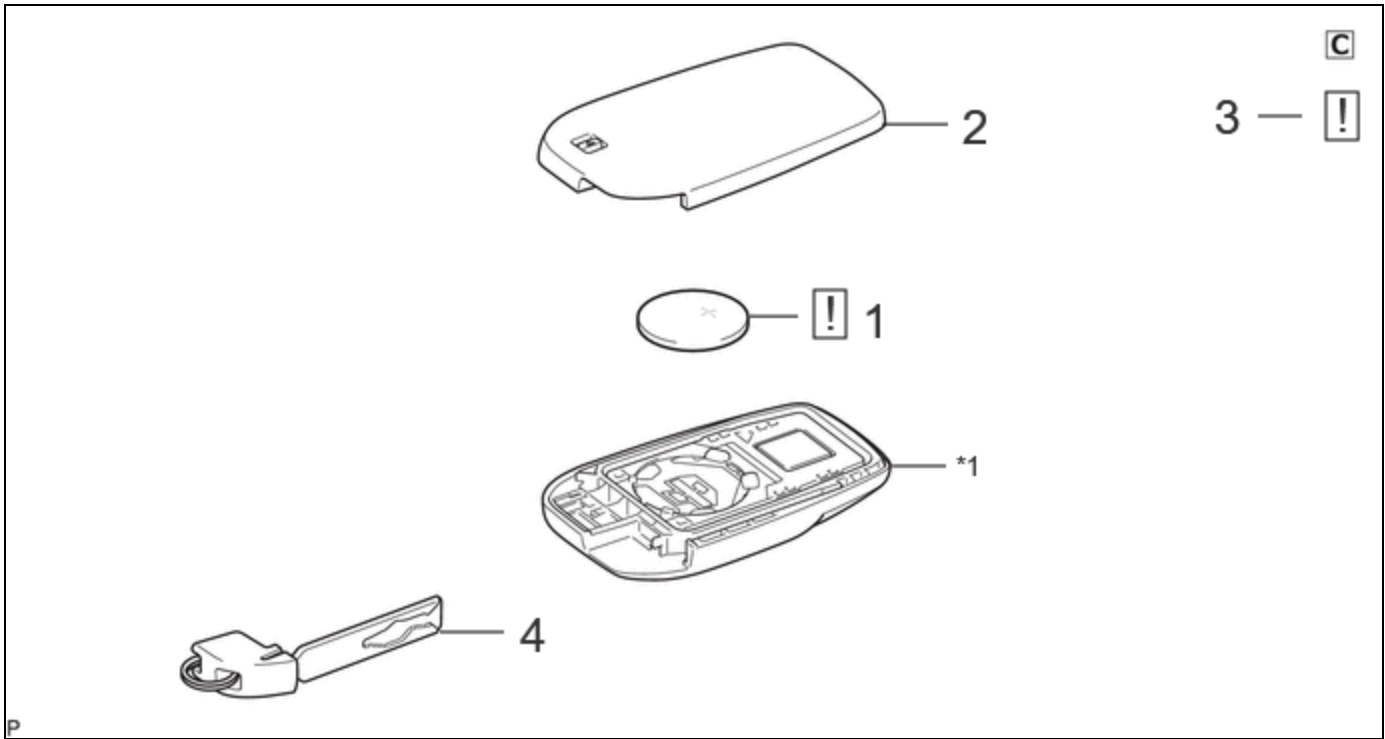

	PROCEDURE	PART NAME CODE			
1	TRANSMITTER BATTERY	89745A	INFO	-	-
2	TRANSMITTER BATTERY HOUSING COVER	-	-	-	-
3	INSPECT TRANSMITTER LED ILLUMINATION	-	INFO	-	-
4	CUT KEY	69503B	-	-	-

*1	TRANSMITTER HOUSING CASE	-	-
----	--------------------------	---	---

PROCEDURE

1. INSTALL TRANSMITTER BATTERY

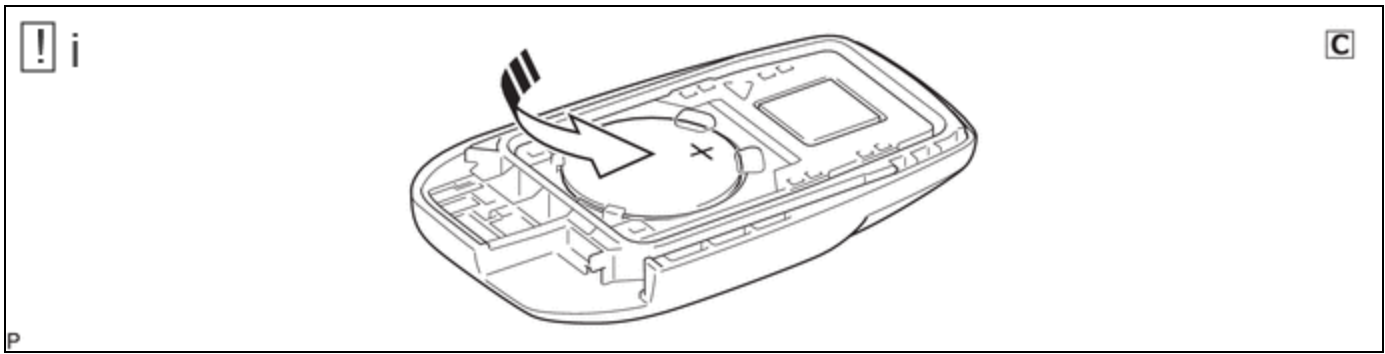

	Install in this Direction	-	-
--	---------------------------	---	---

(1) Install the transmitter battery (lithium battery: CR2450) with the positive (+) side facing upward, as shown in the illustration.

NOTICE:

- Do not push the terminals with your finger.
- Do not forcibly pry up the transmitter battery (lithium battery: CR2450) as the terminals may be damaged.
- Do not touch the transmitter battery (lithium battery: CR2450) with wet hands. Moisture may cause rust.
- Do not touch or move any components inside the transmitter housing case. It may interfere with proper operation.
- When replacing the transmitter battery (lithium battery: CR2450), before starting work, remove static electricity that has built up in the body by touching, for example, the vehicle to prevent the electrical key transmitter sub-assembly from being damaged.

2. INSTALL TRANSMITTER BATTERY HOUSING COVER

3. INSPECT TRANSMITTER LED ILLUMINATION

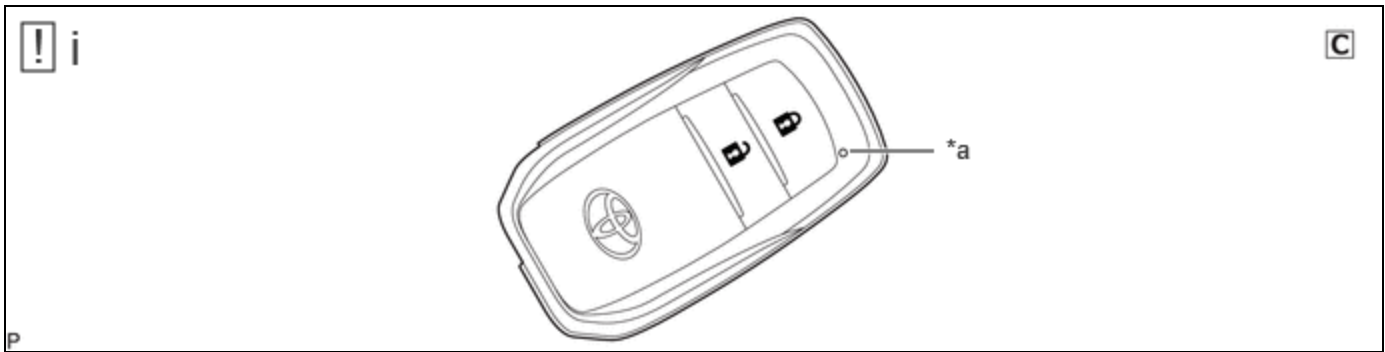

*a	LED	-	-
----	-----	---	---

(1) Press one of the transmitter switches and check that the LED illuminates.

OK:

Transmitter LED illuminates when a switch is pressed.

4. INSTALL CUT KEY

