

Last Modified: 12-04-2024	6.11:8.1.0	Doc ID: RM10000002BNTY
Model Year Start: 2023	Model: Prius Prime	Prod Date Range: [03/2023 -]
Title: M20A-FXS (EMISSION CONTROL): EGR VALVE: REMOVAL; 2023 - 2024 MY Prius Prius Prime [03/2023 -]		

REMOVAL

CAUTION / NOTICE / HINT

The necessary procedures (adjustment, calibration, initialization or registration) that must be performed after parts are removed and installed, or replaced during EGR valve assembly removal/installation are shown below.

Necessary Procedures After Parts Removed/Installed/Replaced

REPLACED PART OR PERFORMED PROCEDURE	NECESSARY PROCEDURE	EFFECT/INOPERATIVE FUNCTION WHEN NECESSARY PROCEDURE NOT PERFORMED	LINK
<ul style="list-style-type: none"> Replacement of EGR valve assembly Gas leaks from exhaust system is repaired 	Inspection after repair	<ul style="list-style-type: none"> Poor idle, etc. Engine start function, etc. 	

NOTICE:

- After turning the power switch off, waiting time may be required before disconnecting the cable from the negative (-) auxiliary battery terminal.

Click here [INFO](#)

- This procedure includes the installation of small-head bolts. Refer to Small-Head Bolts of Basic Repair Hint to identify the small-head bolts.

Click here

HINT:

When the cable is disconnected/reconnected to the auxiliary battery terminal, systems temporarily stop operating. However, each system has a function that completes learning the first time the system is used.

Learning completes when vehicle is driven

EFFECT/INOPERATIVE FUNCTION WHEN NECESSARY PROCEDURES ARE NOT PERFORMED	EFFECT/INOPERATIVE FUNCTION WHEN NECESSARY PROCEDURES ARE NOT PERFORMED	LINK
Front Camera System	Drive the vehicle straight ahead at 35 km/h (22 mph) or more for 5 seconds or more.	INFO

Learning completes when vehicle is operated normally



EFFECT/INOPERATIVE FUNCTION WHEN NECESSARY PROCEDURES ARE NOT PERFORMED	EFFECT/INOPERATIVE FUNCTION WHEN NECESSARY PROCEDURES ARE NOT PERFORMED	LINK
Power Door Lock Control System*1 <ul style="list-style-type: none"> Back door opener 	Perform door unlock operation with door control switch or electrical key transmitter sub-assembly switch.	INFO
Power Back Door System*2	Reset back door close position	INFO
Air Conditioning System	<p>for HEV Model:</p> <p>After the ignition switch is turned to ON, the servo motor standard position is recognized.</p> <p>for PHEV Model:</p> <p>After the ignition switch is turned to ON, the servo motor and expansion valve standard position is recognized.</p>	-
<p>*1: w/o Power Back Door System</p> <p>*2: w/ Power Back Door System</p>		

CAUTION / NOTICE / HINT

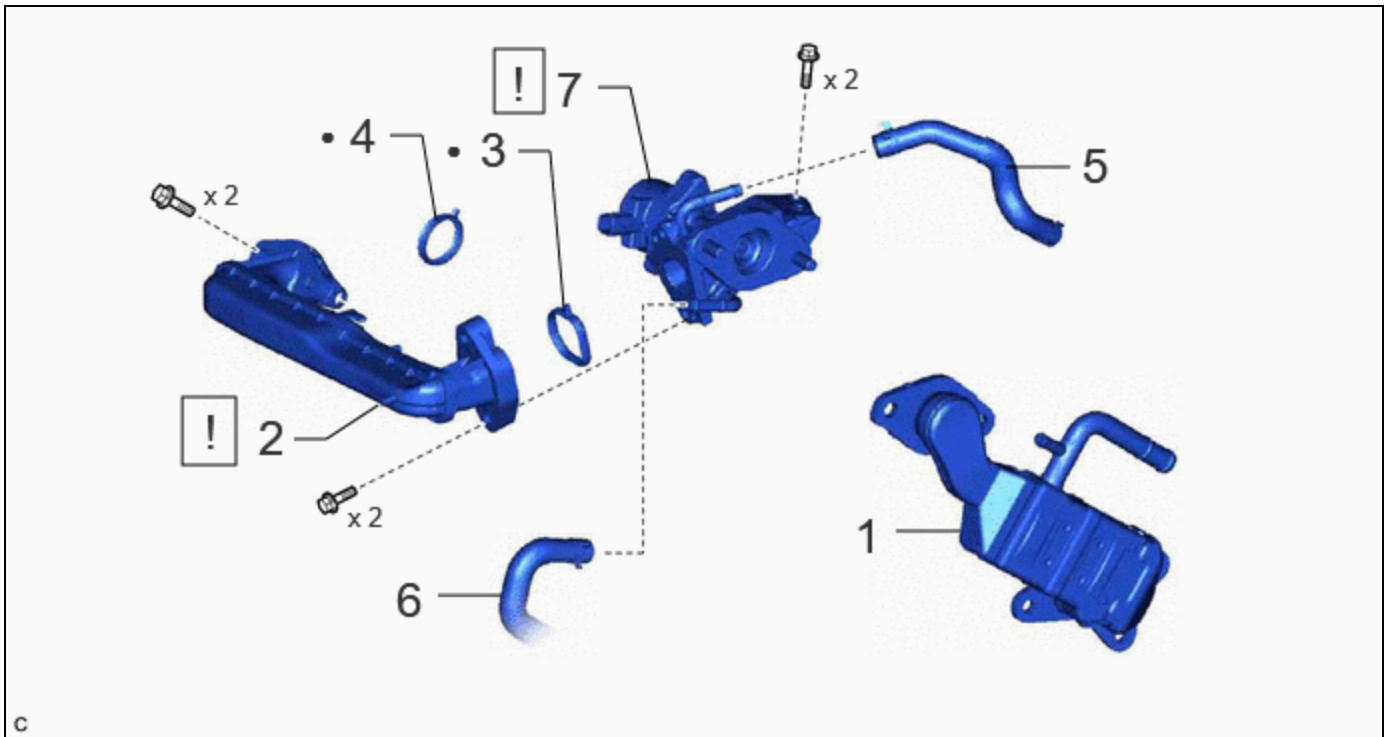
COMPONENTS (REMOVAL)



PROCEDURE	PART NAME CODE	!	📄	⚙️
1 EGR COOLER ASSEMBLY	25680	-	-	-
2 NO. 1 EGR PIPE SUB-ASSEMBLY	25601	INFO	-	-

	PROCEDURE	PART NAME CODE			
3	EGR VALVE ADAPTER GASKET	25629	-	-	-
4	EGR INLET GASKET	25628	-	-	-
5	NO. 4 WATER BY-PASS HOSE	16281	-	-	-
6	NO. 8 WATER BY-PASS HOSE	16296	-	-	-
7	EGR VALVE ASSEMBLY	25620	INFO	-	-

•	Non-reusable part	-	-
---	-------------------	---	---

PROCEDURE

1. REMOVE EGR COOLER ASSEMBLY

Click here [INFO](#)

2. REMOVE NO. 1 EGR PIPE SUB-ASSEMBLY

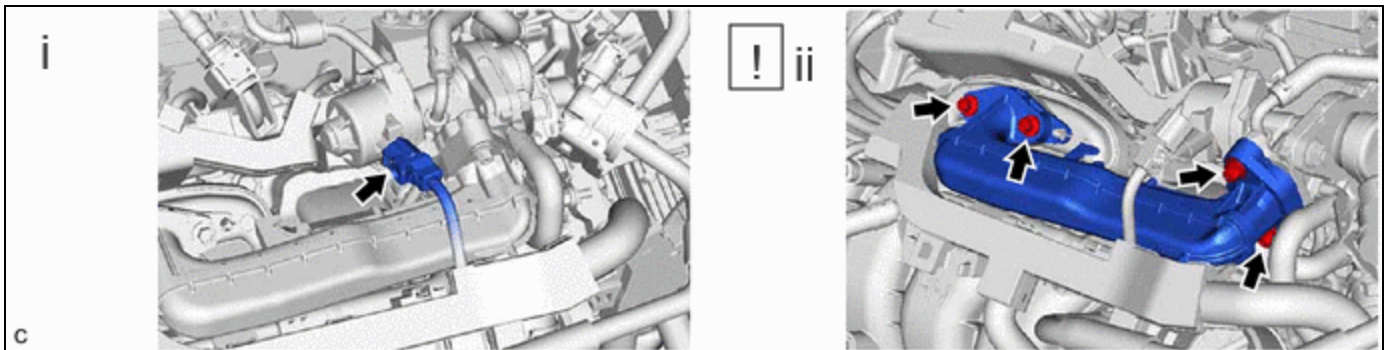

- (1) Disconnect the EGR valve assembly connector.
- (2) Using an 8 mm socket wrench, remove the 4 bolts and No. 1 EGR pipe sub-assembly from the intake manifold and EGR valve assembly.

3. REMOVE EGR VALVE ADAPTER GASKET

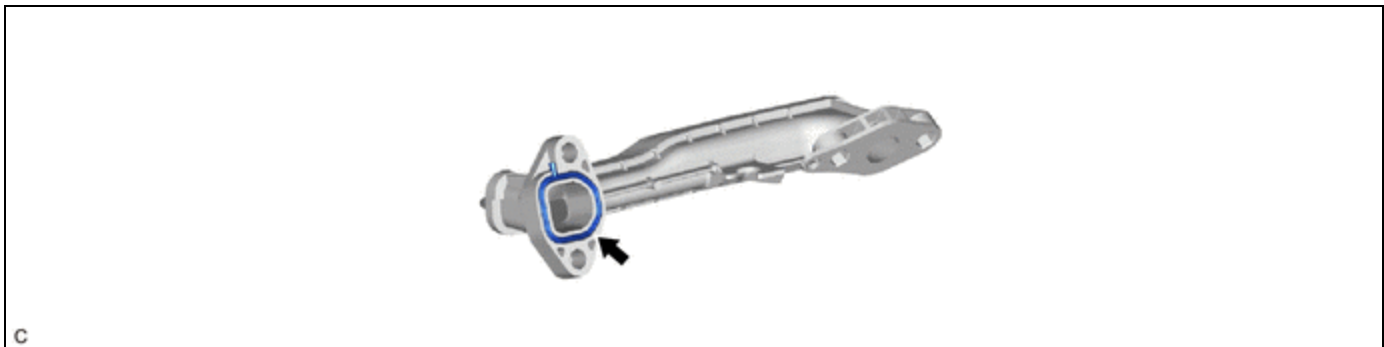

4. REMOVE EGR INLET GASKET

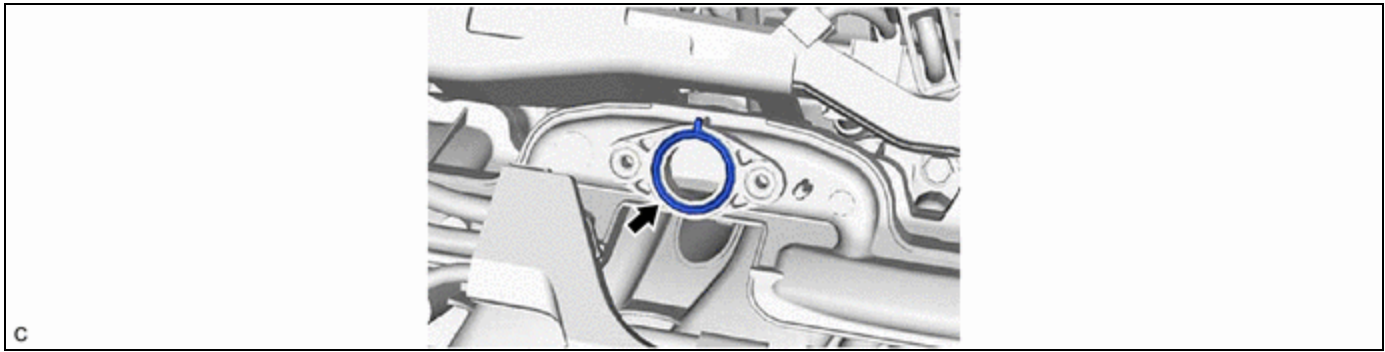

5. REMOVE NO. 4 WATER BY-PASS HOSE

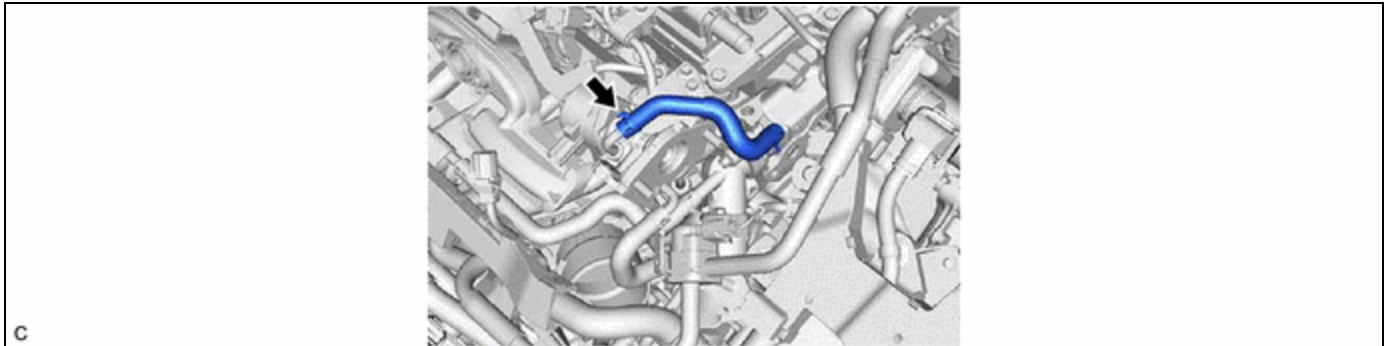

6. DISCONNECT NO. 8 WATER BY-PASS HOSE

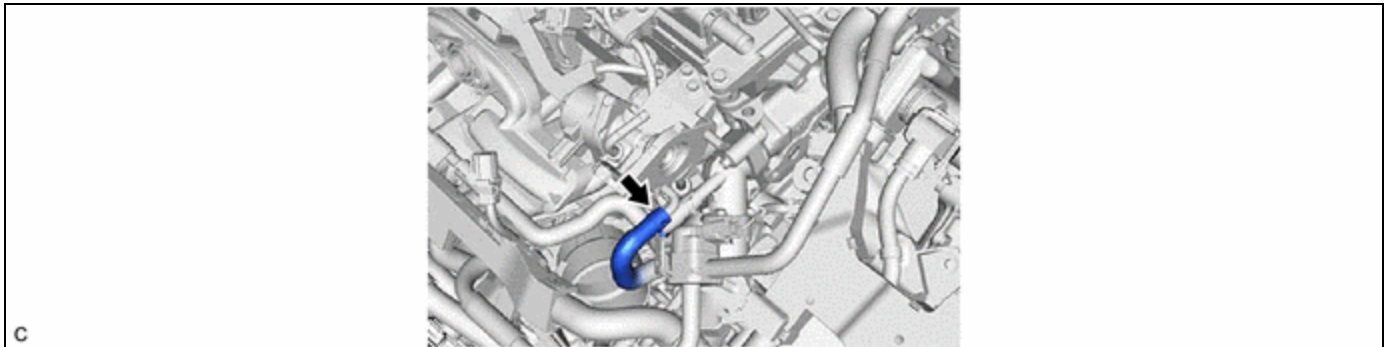

7. REMOVE EGR VALVE ASSEMBLY

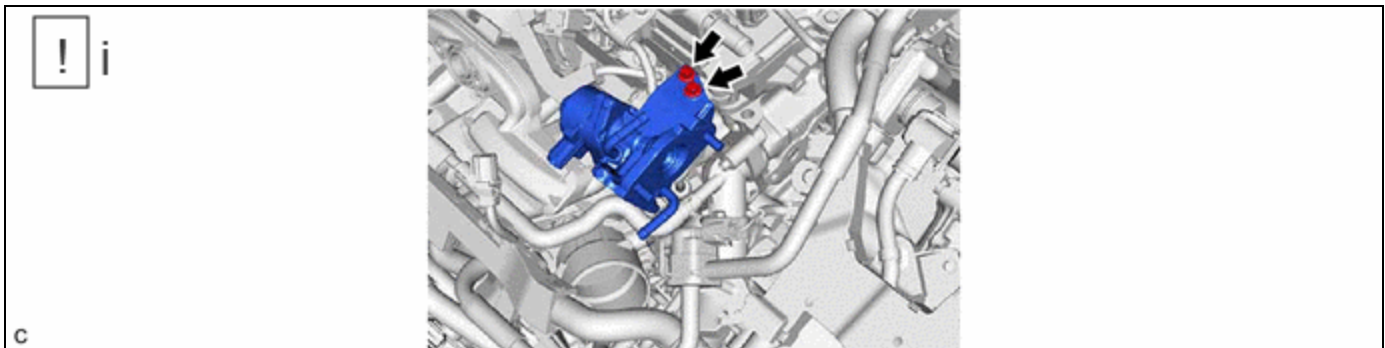

(1) Using the 8 mm socket wrench, remove the 2 bolts and EGR valve assembly.

