

Last Modified: 12-04-2024	6.11:8.1.0	Doc ID: RM10000002BLZM
Model Year Start: 2023	Model: Prius Prime	Prod Date Range: [03/2023 -]
Title: PARK ASSIST / MONITORING: BLIND SPOT MONITOR SENSOR: REMOVAL; 2023 - 2024 MY Prius Prius Prime [03/2023 -]		

REMOVAL

CAUTION / NOTICE / HINT

The necessary procedures (adjustment, calibration, initialization or registration) that must be performed after parts are removed and installed, or replaced during blind spot monitor sensor removal/installation are shown below.

Necessary Procedures After Parts Removed/Installed/Replaced

REPLACED PART OR PERFORMED PROCEDURE	NECESSARY PROCEDURES	EFFECT/INOPERATIVE FUNCTION WHEN NECESSARY PROCEDURES ARE NOT PERFORMED	LINK
Blind spot monitor sensor	ECU configuration	-	INFO
	Blind spot monitor beam axis adjustment	<ul style="list-style-type: none"> • Parking Support Brake System • Blind Spot Monitor System • Traffic Jam Assist System 	Driving Adjustment: INFO ECU DATA SAVE/WRITE: INFO Target Adjustment(Triangle Target): INFO

CAUTION / NOTICE / HINT

COMPONENTS (REMOVAL)

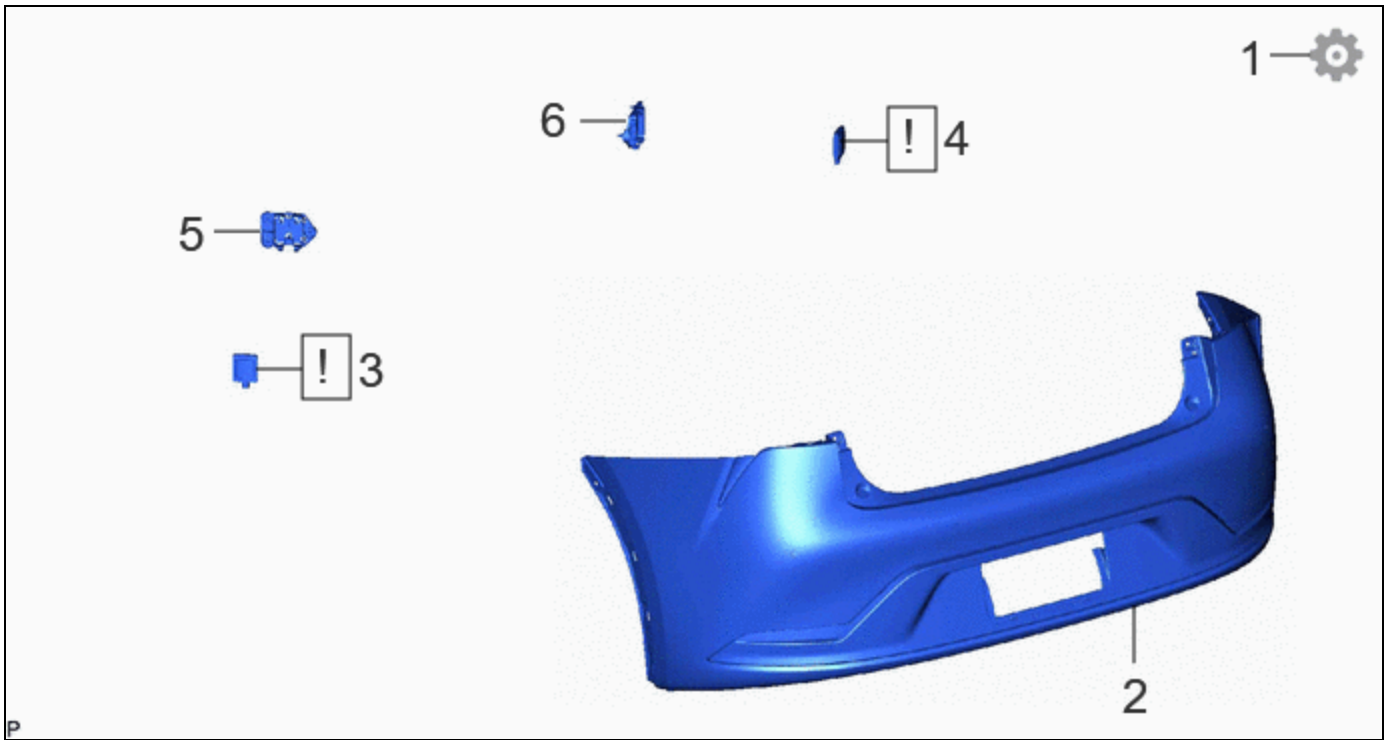

PROCEDURE		PART NAME CODE			
1	BSM ECU DATA SAVE	-	-	-	INFO
2	REAR BUMPER ASSEMBLY	-	-	-	-
3	BLIND SPOT MONITOR SENSOR LH	88172	INFO	-	-
4	BLIND SPOT MONITOR SENSOR RH	88162	INFO	-	-
5	BLIND SPOT MONITOR BRACKET LH	88171	-	-	-
6	BLIND SPOT MONITOR BRACKET RH	88161	-	-	-

PROCEDURE

1. BSM ECU DATA SAVE

Click here [INFO](#)

2. REMOVE REAR BUMPER ASSEMBLY

Click here [INFO](#)

3. REMOVE BLIND SPOT MONITOR SENSOR LH

	<p>NOTICE:</p> <ul style="list-style-type: none"> Do not drop the blind spot monitor sensor LH. If the blind spot monitor sensor LH is dropped, replace it with a new one.
--	---

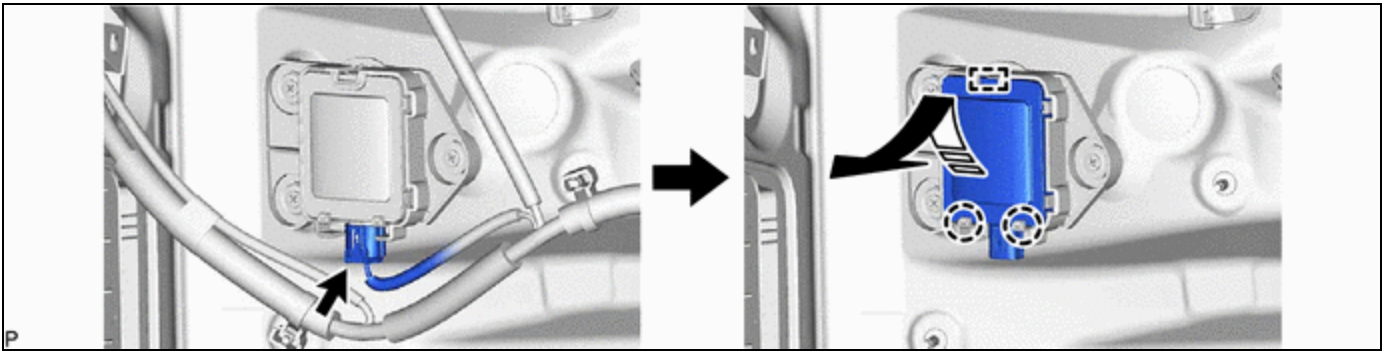

	Remove in this Direction	-	-
---	--------------------------	---	---

4. REMOVE BLIND SPOT MONITOR SENSOR RH



(a) Use the same procedure described for the LH side.

5. REMOVE BLIND SPOT MONITOR BRACKET LH

HINT:

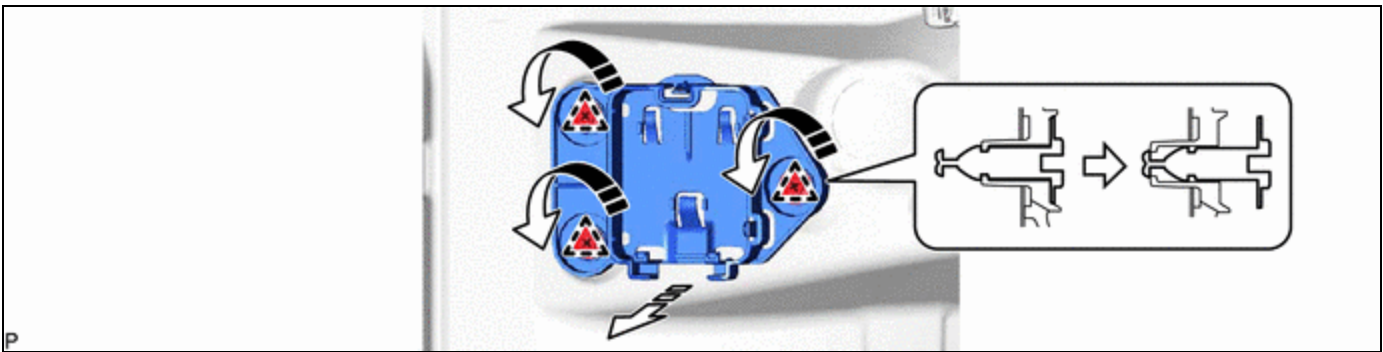
Perform this procedure only when replacement of the blind spot monitor bracket LH is necessary.



	Remove in this Direction (1)		Remove in this Direction (2)
---	------------------------------	---	------------------------------

6. REMOVE BLIND SPOT MONITOR BRACKET RH

(a) Use the same procedure described for the LH side.

