

<b>Last Modified:</b> 12-04-2024	6.11:8.1.0	<b>Doc ID:</b> RM10000002BKGO
<b>Model Year Start:</b> 2023	<b>Model:</b> Prius Prime	<b>Prod Date Range:</b> [03/2023 - ]
<b>Title:</b> NAVIGATION / MULTI INFO DISPLAY: NAVIGATION ANTENNA: REMOVAL; 2023 - 2024 MY Prius Prius Prime [03/2023 - ]		

## REMOVAL

### CAUTION / NOTICE / HINT

The necessary procedures (adjustment, calibration, initialization or registration) that must be performed after parts are removed and installed, or replaced during navigation antenna assembly removal/installation are shown below.

**CAUTION:**

Be sure to read Precaution thoroughly before servicing.



[Click here](#) INFO

**NOTICE:**

After the ignition switch is turned off, there may be a waiting time before disconnecting the negative (-) auxiliary battery terminal.

[Click here](#) INFO

**HINT:**

When the cable is disconnected / reconnected to the auxiliary battery terminal, systems temporarily stop operating. However, each system has a function that completes learning the first time the system is used.

**Learning completes when vehicle is driven**

EFFECT/INOPERATIVE FUNCTION WHEN NECESSARY PROCEDURES ARE NOT PERFORMED	NECESSARY PROCEDURES	LINK
Front Camera System	Drive the vehicle straight ahead at 35 km/h (22 mph) or more for 5 seconds or more.	<span style="background-color: #0056b3; color: white; padding: 2px 5px;">INFO</span>

**Learning completes when vehicle is operated normally**



\*1: w/o Power Back Door System

EFFECT/INOPERATIVE FUNCTION WHEN NECESSARY PROCEDURES ARE NOT PERFORMED	NECESSARY PROCEDURES	LINK
Power Door Lock Control System*1 <ul style="list-style-type: none"> <li>Back door opener</li> </ul>	Perform door unlock operation with door control switch or electrical key transmitter sub-assembly switch.	<a href="#">INFO</a>
Power Back Door System*2	Reset back door close position	<a href="#">INFO</a>
Air Conditioning System	<p><b>for HEV Model:</b></p> <p>After the ignition switch is turned to ON, the servo motor standard position is recognized.</p> <p><b>for PHEV Model:</b></p> <p>After the ignition switch is turned to ON, the servo motor and expansion valve standard position is recognized.</p>	-
<p>*1: w/o Power Back Door System</p> <p>*2: w/ Power Back Door System</p>		

## CAUTION / NOTICE / HINT

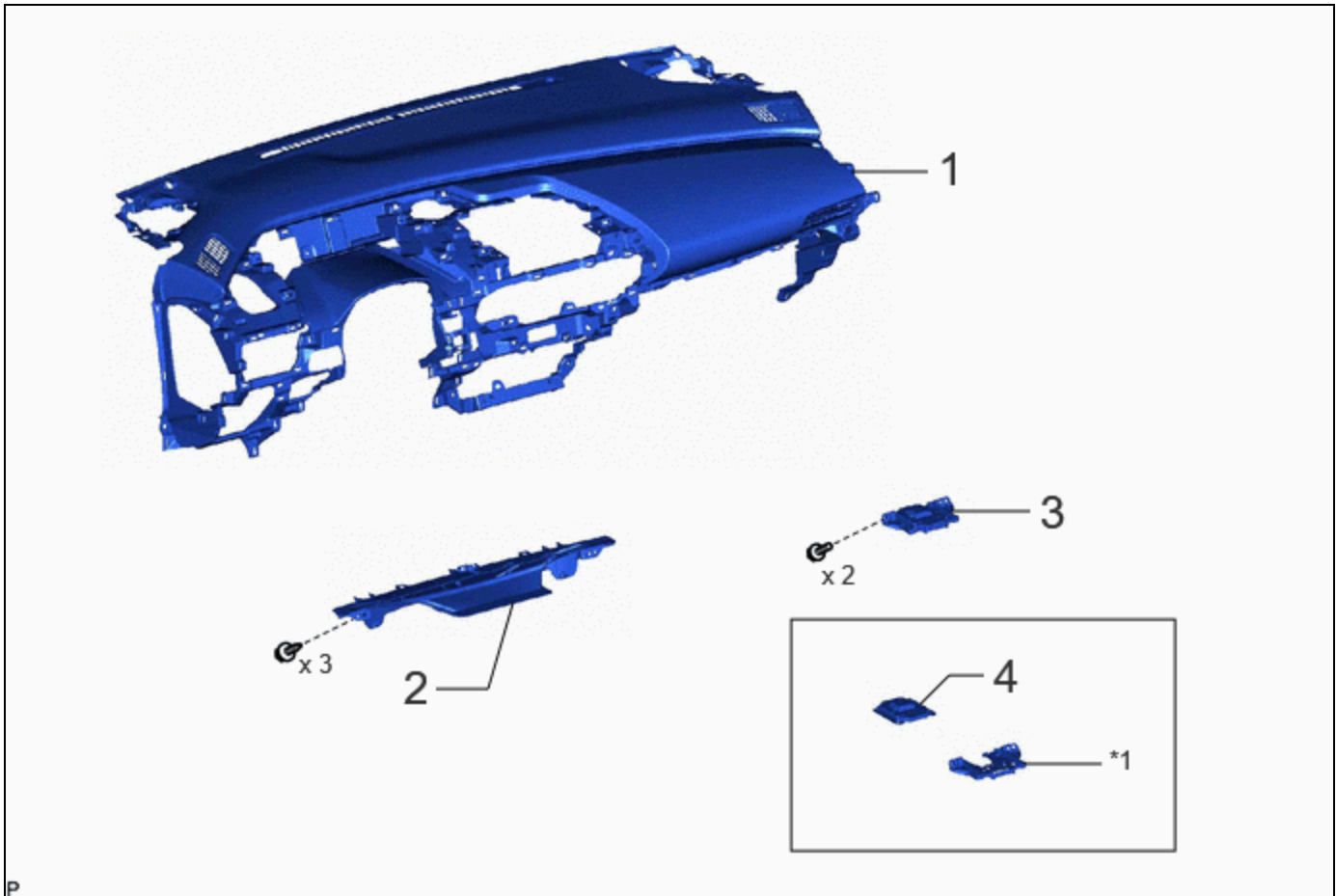
### COMPONENTS (REMOVAL)



	PROCEDURE	PART NAME CODE			
1	INSTRUMENT PANEL SAFETY PAD SUB-ASSEMBLY	-	-	-	-
2	DEFROSTER NOZZLE ASSEMBLY	55950G	-	-	-
3	NAVIGATION ANTENNA ASSEMBLY WITH BRACKET	-	-	-	-
4	NAVIGATION ANTENNA ASSEMBLY	86860	-	-	-

*1	NAVIGATION ANTENNA BRACKET	-	-
----	----------------------------	---	---

## PROCEDURE

### 1. REMOVE INSTRUMENT PANEL SAFETY PAD SUB-ASSEMBLY

Click here [INFO](#)

### 2. REMOVE DEFROSTER NOZZLE ASSEMBLY

Click here [INFO](#)

### 3. REMOVE NAVIGATION ANTENNA ASSEMBLY WITH BRACKET

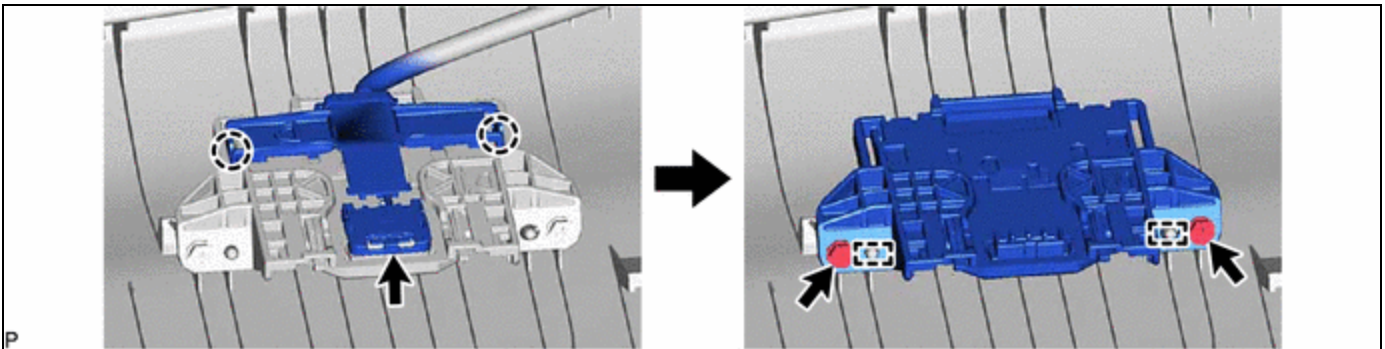

### 4. REMOVE NAVIGATION ANTENNA ASSEMBLY

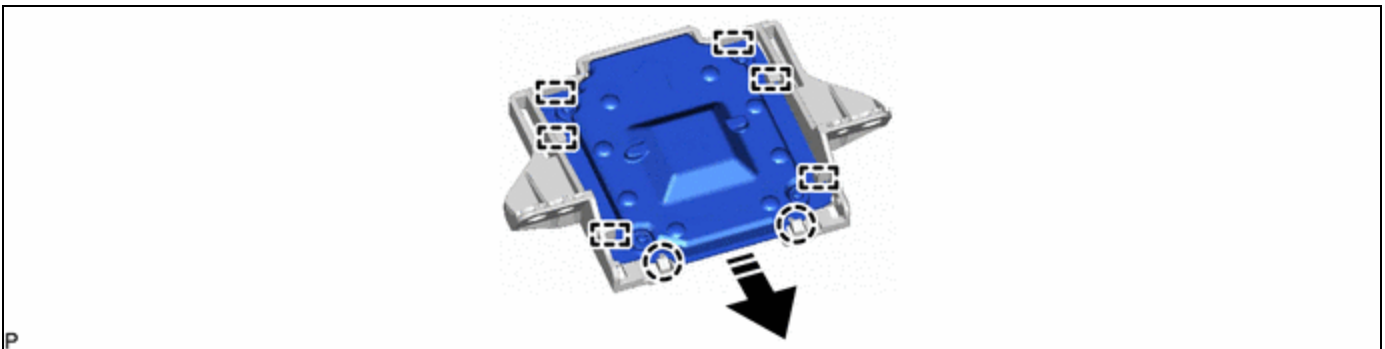

	Remove in this Direction	-	-
---	--------------------------	---	---

