

<b>Last Modified:</b> 12-04-2024	6.11:8.1.0	<b>Doc ID:</b> RM100000002BWI1
<b>Model Year Start:</b> 2023	<b>Model:</b> Prius Prime	<b>Prod Date Range:</b> [03/2023 - ]
<b>Title:</b> ADVANCED DRIVER ASSISTANCE SYSTEM: FRONT CAMERA: INSTALLATION; 2023 - 2024 MY Prius Prius Prime [03/2023 - ]		

## INSTALLATION

### CAUTION / NOTICE / HINT

**NOTICE:**



After replacing the forward recognition camera, make sure to perform update ECU security key.

### CAUTION / NOTICE / HINT

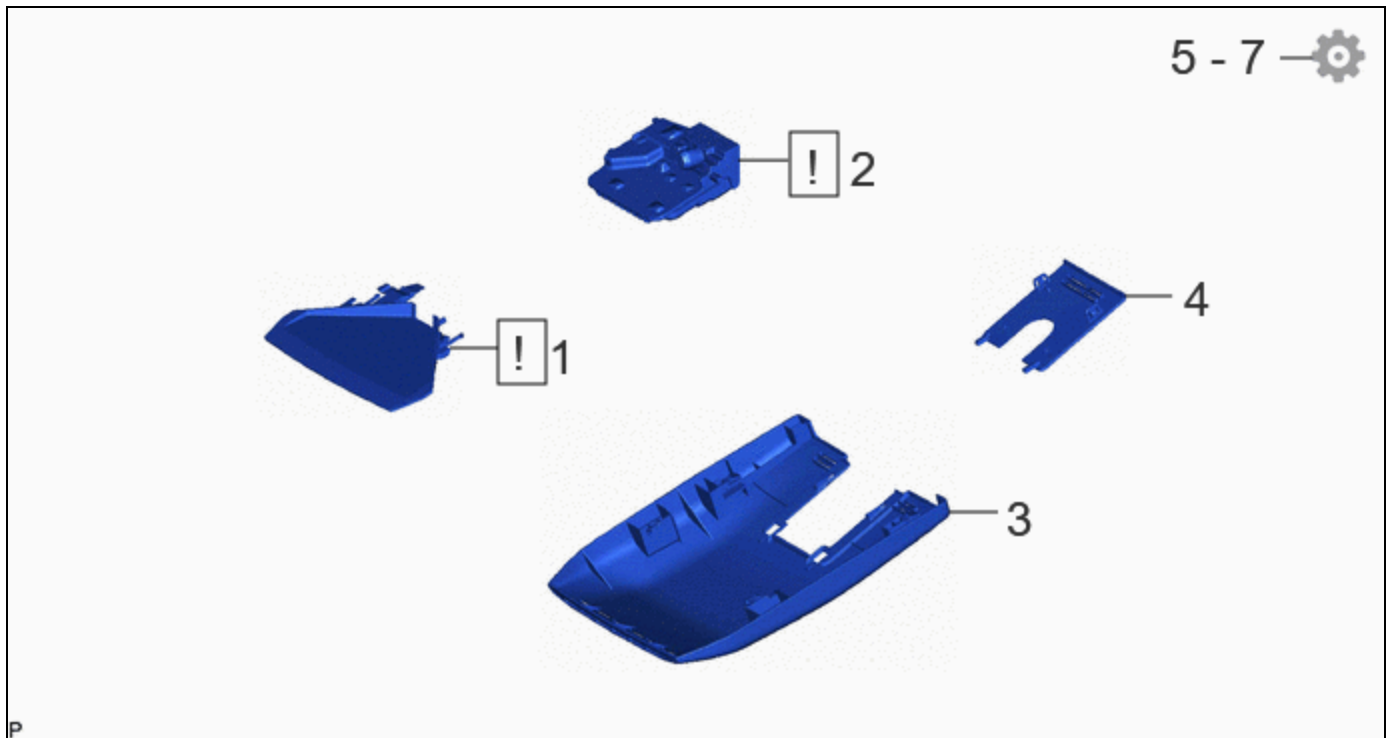
#### COMPONENTS (INSTALLATION)



	PROCEDURE	PART NAME CODE			
1	FORWARD RECOGNITION HOOD	86461		-	-
2	FORWARD RECOGNITION CAMERA	8646C		-	-
3	NO. 1 FORWARD RECOGNITION COVER	86466D	-	-	-
4	NO. 2 FORWARD RECOGNITION COVER	86466E	-	-	-
5	UPDATE ECU SECURITY KEY	-	-	-	
6	SOFTWARE VERSION CONFIRMATION	-	-	-	

PROCEDURE		PART NAME CODE			
7	ADJUST FORWARD RECOGNITION CAMERA	8646C	-	-	<a href="#">INFO</a>

## PROCEDURE

### 1. INSTALL FORWARD RECOGNITION HOOD

**HINT:**

Perform this procedure only when replacement of the forward recognition hood is necessary.

	<p><b>NOTICE:</b></p> <p>If the inner surface of the windshield glass in the area in front of the forward recognition camera is dirty, remove the forward recognition hood, clean the glass, then reinstall the forward recognition hood and forward recognition camera.</p>
---	--

**NOTICE:**

Do not touch the areas shown in the illustration as application of load may cause bending.

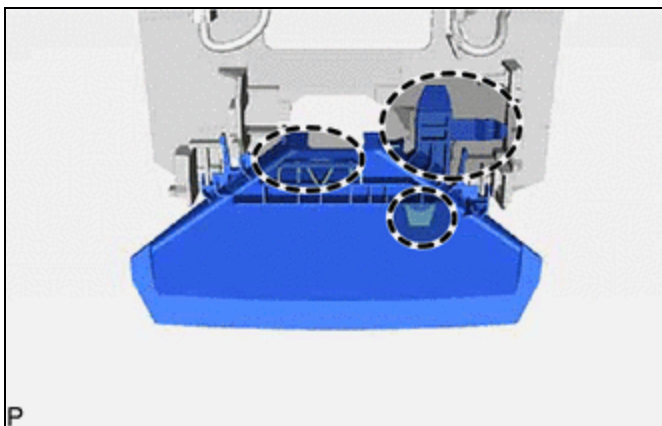

	Do not touch
---	--------------

### 2. INSTALL FORWARD RECOGNITION CAMERA

	<p><b>NOTICE:</b></p> <ul style="list-style-type: none"> <li>• When replacing the forward recognition camera, replace it with a new one.</li> <li>• If the forward recognition camera has been struck or dropped, replace it with a new one.</li> <li>• If the forward recognition camera is not properly installed, forward recognition camera optical axis learning cannot be performed properly. Make sure the forward recognition camera is installed securely.</li> <li>• Do not touch the camera lens. If the camera lens has been touched, do not use the forward recognition camera.</li> <li>• Replace the forward recognition camera if there is any foreign matter on the camera lens.</li> <li>• If the forward recognition camera bracket is deformed or damaged, replace it together with the windshield glass.</li> <li>• When replacing the windshield glass of a vehicle equipped with a forward recognition camera, make sure to use a Toyota genuine part. If a non-Toyota genuine part is used, the forward recognition camera may not be able to be installed due to a missing bracket. Also, the front</li> </ul>
---	---

camera system, automatic high beam system or traffic jam assist system may not operate properly due to a difference in the transmissivity or black ceramic border.

- If the inner surface of the windshield glass in the area in front of the forward recognition camera is dirty, remove the forward recognition hood, clean the glass, then reinstall the forward recognition hood and forward recognition camera.

Forward recognition hood removal:

[Click here](#) [INFO](#)

Forward recognition hood installation:

[Click here](#) [INFO](#)

### 3. INSTALL NO. 1 FORWARD RECOGNITION COVER

### 4. INSTALL NO. 2 FORWARD RECOGNITION COVER

### 5. UPDATE ECU SECURITY KEY

[Click here](#) [INFO](#)

### 6. SOFTWARE VERSION CONFIRMATION

[Click here](#) [INFO](#)

### 7. ADJUST FORWARD RECOGNITION CAMERA



#### NOTICE:

- When replacing only the forward recognition camera, Camera Axis Adjustment Value Write can be performed.
- If the forward recognition camera and millimeter wave radar sensor assembly are replaced at the same time, Camera Axis Adjustment Value Write cannot be used.
- If Camera Axis Adjustment Value Write can be performed, the adjustment procedure can be omitted.

(a) If the forward recognition camera is replaced with a new one, perform forward recognition camera adjustment.

#### HINT:

Forward recognition camera learning can be performed by using either Target Adjustment (One Time Recognition), Camera Axis Adjustment Value Write or Driving Adjustment.

- Target Adjustment (One Time Recognition):

[Click here](#) [INFO](#)

- Driving Adjustment:

[Click here](#) [INFO](#)

- Camera Axis Adjustment Value Write:

[Click here](#) [INFO](#)

(b) If the windshield glass has been replaced or removed and installed, perform forward recognition camera adjustment.

#### HINT:

Forward recognition camera learning can be performed by using either Target Adjustment (One Time Recognition) or Driving Adjustment.

- Target Adjustment (One Time Recognition):

[Click here](#) [INFO](#)

- Driving Adjustment:



[Click here](#)

