

Front Bulkhead-Side Frame Assembly

Removal

Cut and remove the front bulkhead-side frame assembly.

Ⓐ: Grind the fillet weld from the passenger compartment.

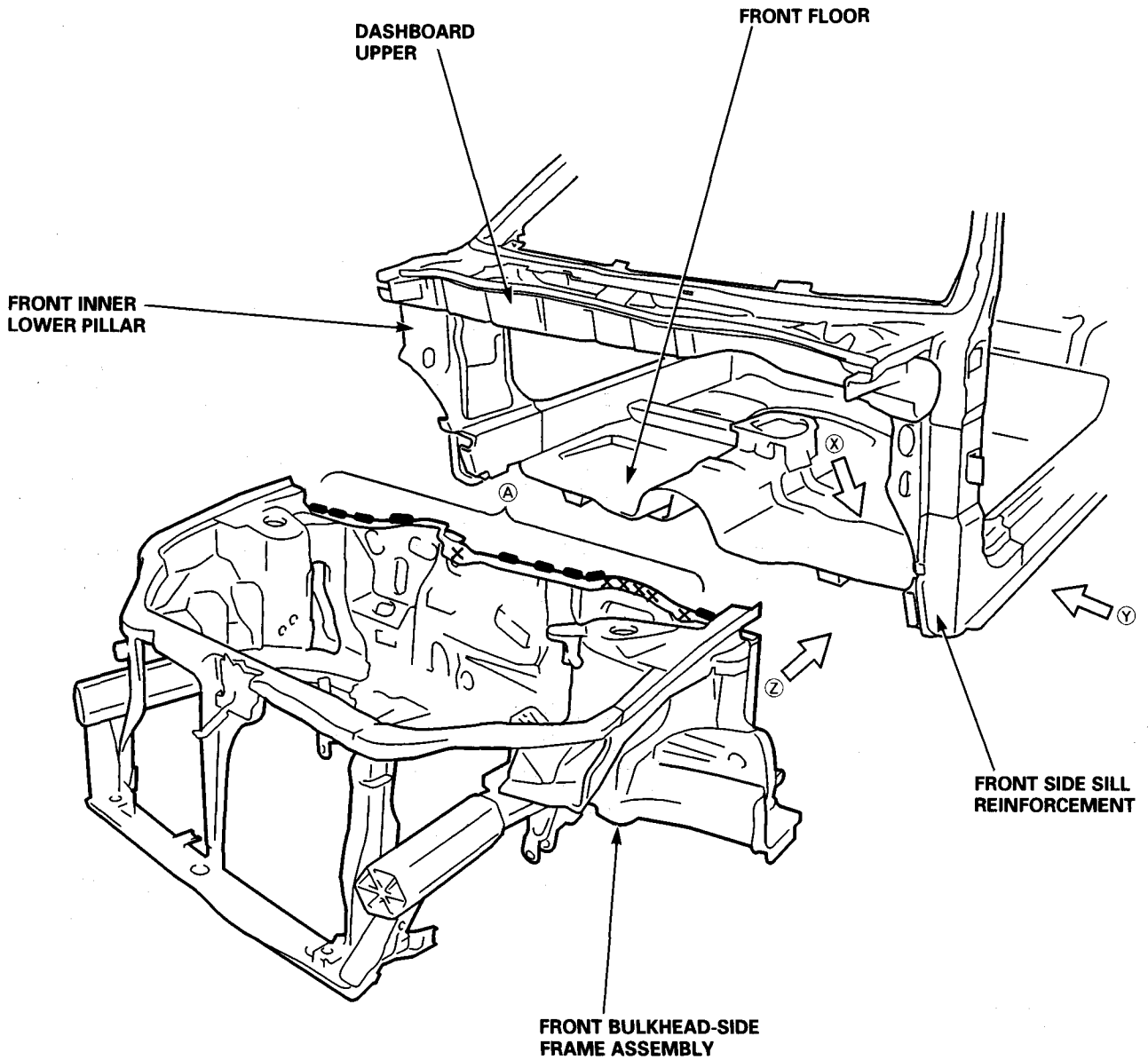

- Drill holes completely through the parts since the replacement front bulkhead-side frame assembly will be attached by plug welding.

Passenger Compartment:

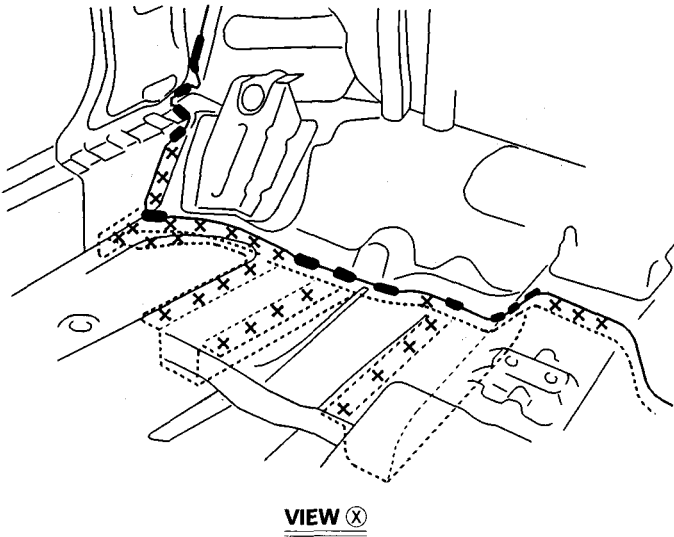

VIEW X

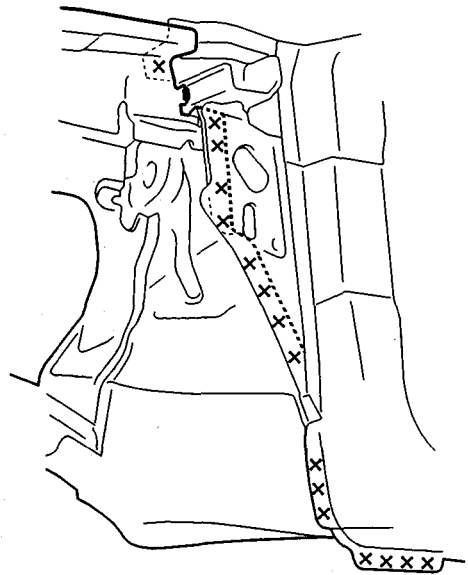

VIEW Y

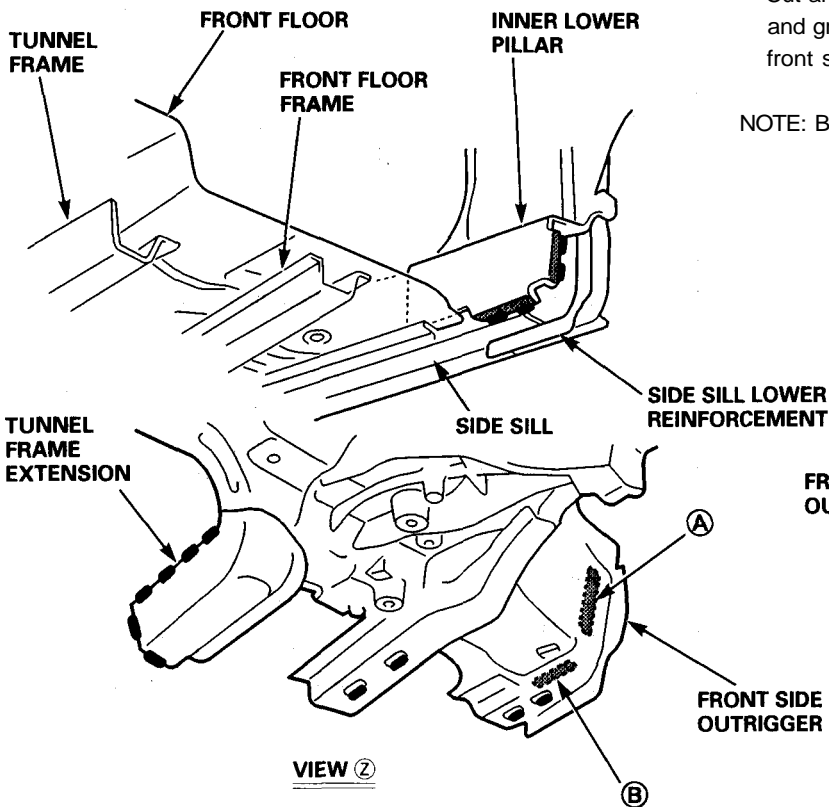

VIEW Z

- Cut and pry off the front side outrigger (A, B positions), and grind the fillet welds of the front inner lower pillar and front side outrigger.

NOTE: Be careful not to damage the front inner lower pillar.

