

2000-06 ACCESSORIES & EQUIPMENT

Openers - Insight

COMPONENT LOCATION INDEX

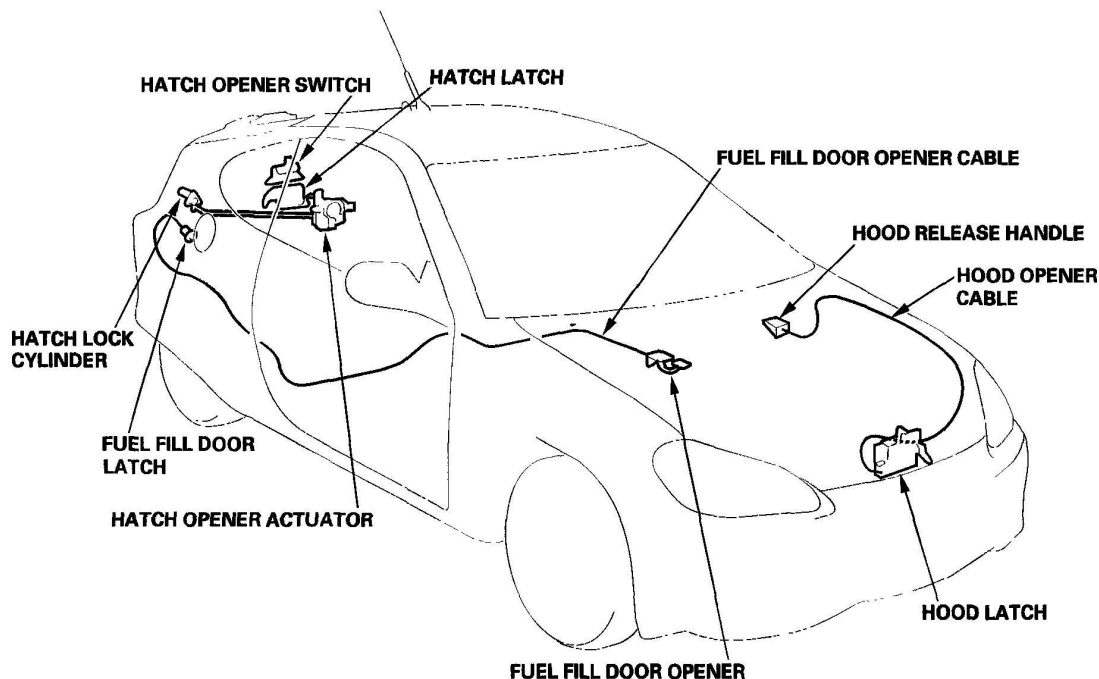

G03682636

Fig. 1: Locating Openers Components
Courtesy of AMERICAN HONDA MOTOR CO., INC.

HOOD OPENER CABLE REPLACEMENT

- NOTE:**
- Put on gloves to protect your hands.
 - Take care not to scratch the body and related parts.
 - Take care not to kink the cable.

1. Remove the front inner fender (see **FRONT INNER FENDER REPLACEMENT**).
2. If equipped, remove the clip (A), then remove the condenser upper seal (B). Disconnect the hood opener cable (C) from the hood latch (D) (see **HOOD LATCH REPLACEMENT**), and remove the bolts (E), then remove the hood

release handle (F) from the body.

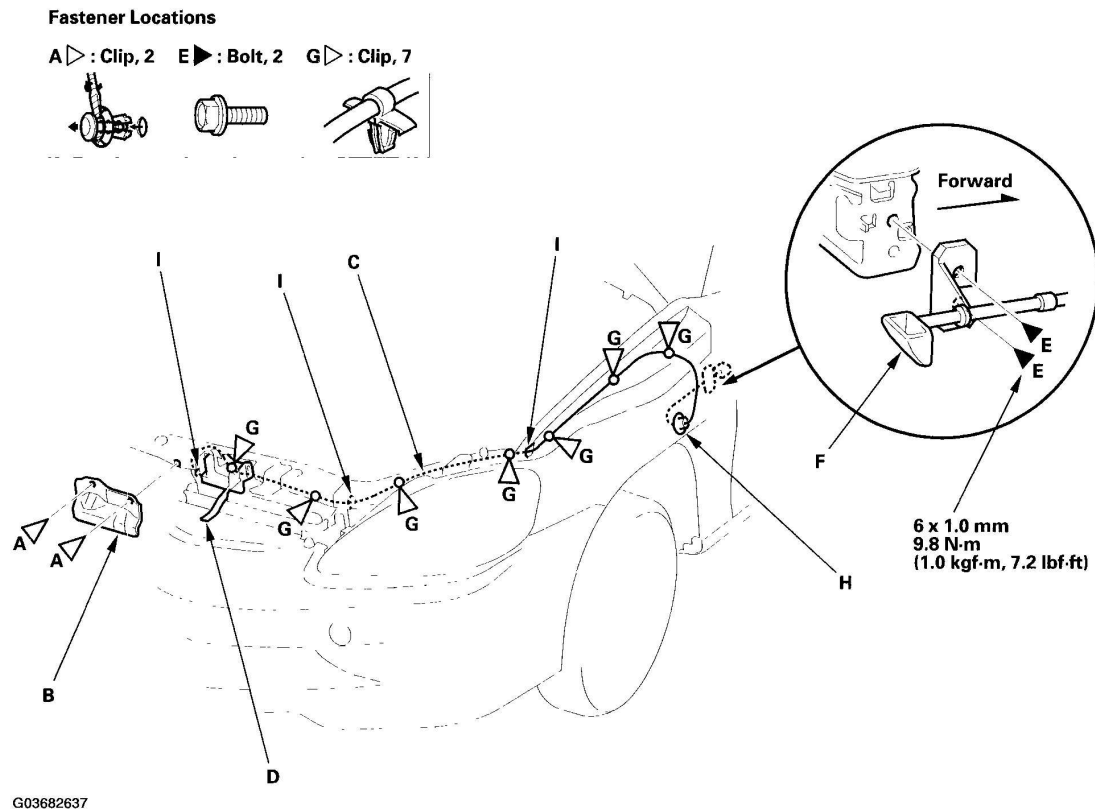

Fig. 2: Removing Front Inner Fender And Torque Specifications
Courtesy of AMERICAN HONDA MOTOR CO., INC.

3. Using a clip remover, detach the clips (G) and remove the grommet (H) from the body, then remove the hood opener cable. Take care not to kink the cable.
4. Install the hood opener cable in the reverse order of removal, and note these items:
 - Check for damaged or stress-whitened clips, and replace them with new ones.
 - Route the cable through the holes (I) in the body.

FUEL FILL DOOR OPENER CABLE REPLACEMENT

NOTE: • Put on gloves to protect your hands.

- Take care not to scratch the body and related parts.
- Take care not to kink the cable.

1. Remove these items:

- Middle floor panel (see **MIDDLE FLOOR PANEL REPLACEMENT**)
- Right trunk side bulkhead (see **IMA CASE REPLACEMENT**)
- Carpet, as necessary (see **CARPET REPLACEMENT**)

2. Disconnect the fuel fill door opener cable (A) from the fuel fill door opener (B), and remove the fuel fill door latch (C) from the body by turning it 90°.

Fastener Locations

D ▷ : Clip, 4 E ▷ : Clip, 1 F ▷ : Cable cushion, 4

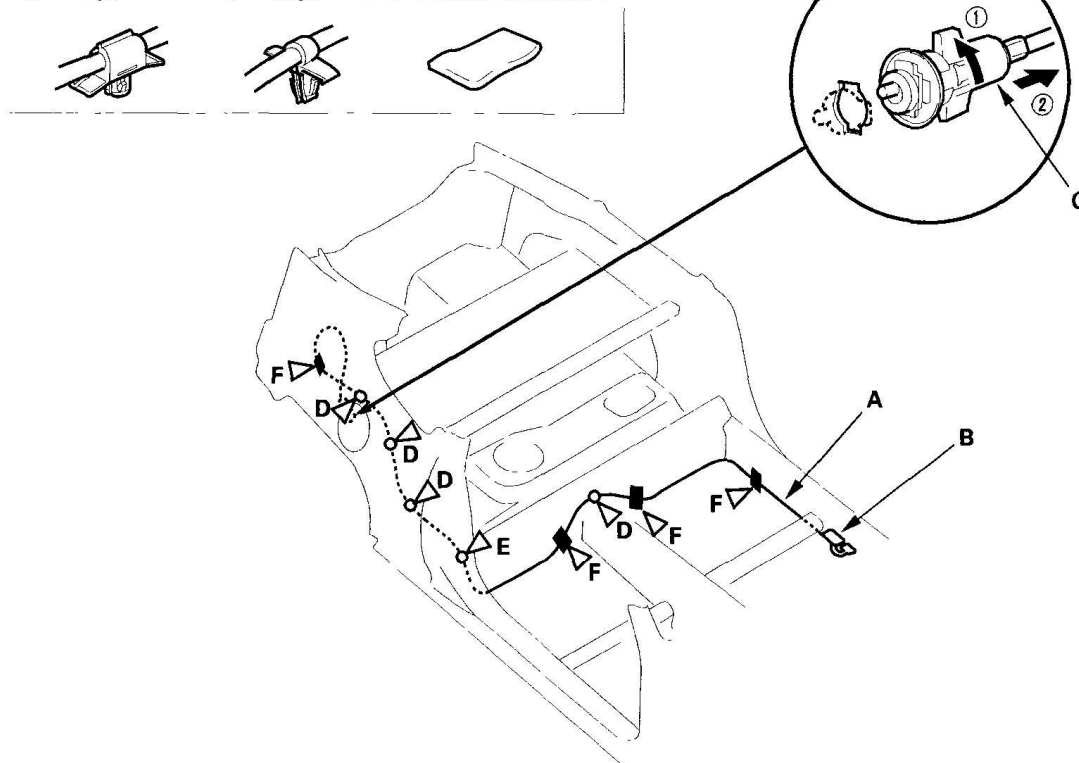

G03682638

Fig. 3: Disconnecting Fuel Fill Door Opener Cable From Fuel Fill Door Opener

Courtesy of AMERICAN HONDA MOTOR CO., INC.

3. Using a clip remover, detach the clips (D, E) and remove the cable cushion (F) from the body, then remove the fuel fill door opener cable. Take care not to kink the cable.
4. Install the cable in the reverse order of removal, and check for damaged or stress-whitened clips, and replace them with new ones.

HOOD LATCH REPLACEMENT

NOTE: Take care not to kink the cable.

REPLACEMENT

1. Remove the hood latch as shown.
2. Install the hood latch in the reverse order of removal, and note these items:
 - Apply multipurpose grease to the hood latch.
 - Make sure the hood opener cable is connected properly.
 - Adjust the hood latch alignment (see step 3 on **HOOD FRONT SEAL REPLACEMENT**).
 - Make sure the hood locks securely.

Fastener Locations

► : Bolt*, 3

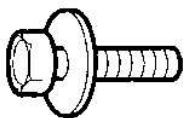

*: CORROSION-RESISTANT BOLT

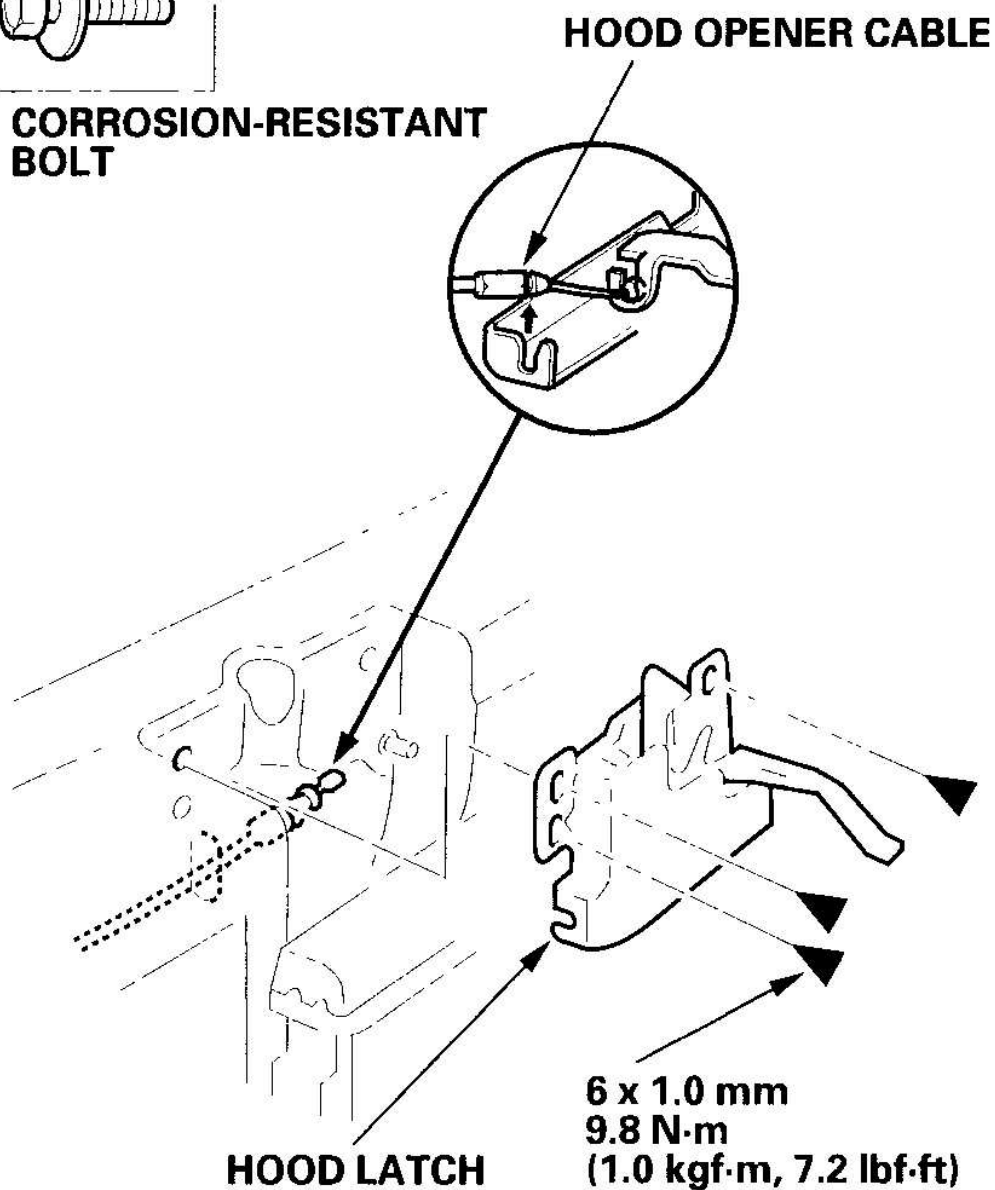

G03682639

Fig. 4: Adjusting Hood Latch Alignment And Torque Specifications

2006 Honda Insight
2000-06 ACCESSORIES & EQUIPMENT Openers - Insight

Courtesy of AMERICAN HONDA MOTOR CO., INC.

GREASE APPLICATION

1. Remove the latch cover, and apply multipurpose grease to each location of the hood latch indicated by the arrows.

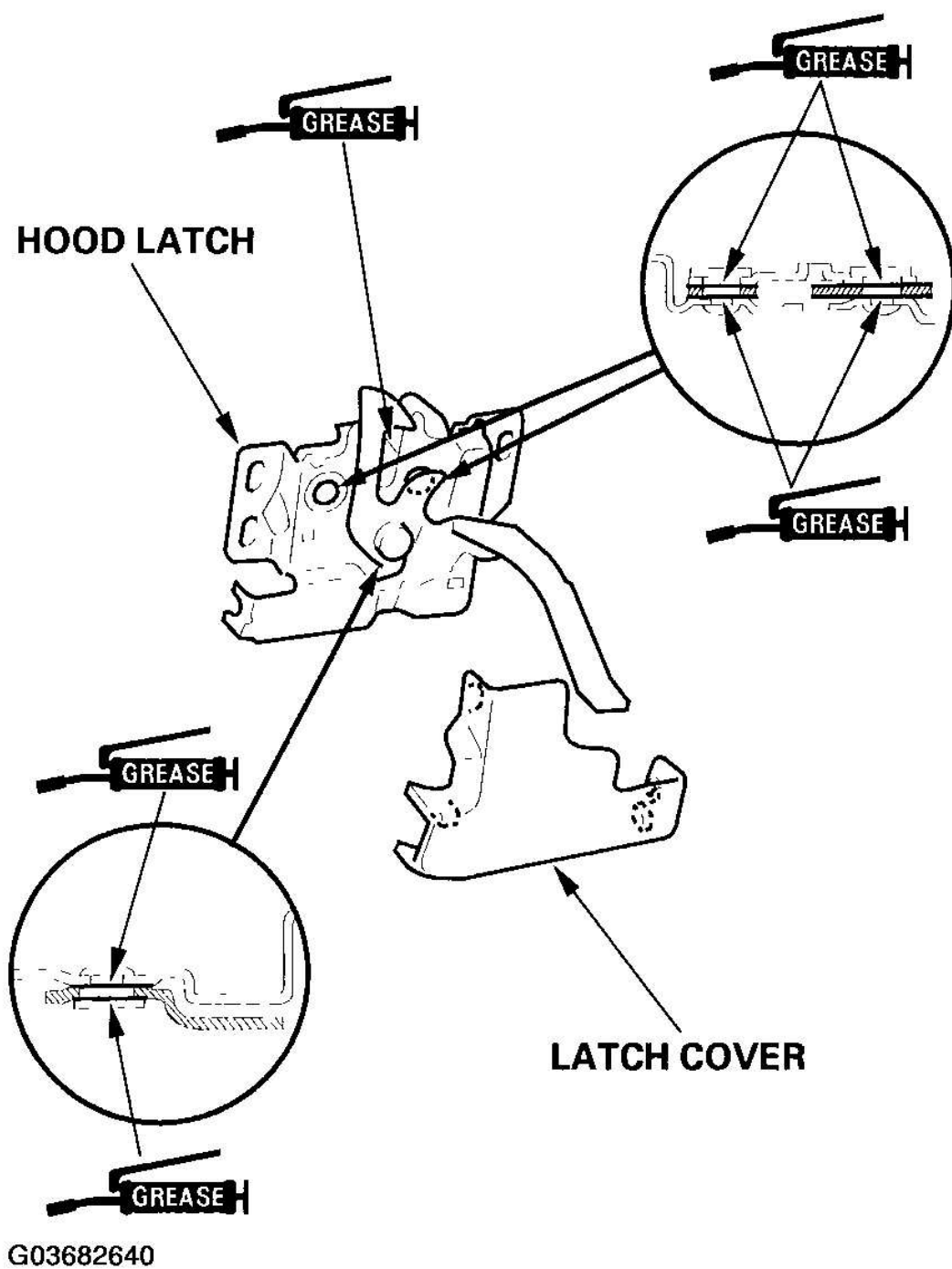

Fig. 5: Removing Latch Cover
Courtesy of AMERICAN HONDA MOTOR CO., INC.

FUEL FILL DOOR OPENER REPLACEMENT

NOTE: Take care not to kink the cable.

1. Remove the carpet as necessary (see **CARPET REPLACEMENT**).
2. Remove the fuel fill door opener as shown.
3. Install the fuel fill door opener in the reverse order of removal, and note these items:
 - Make sure the fuel fill door opener cable is connected properly.
 - Make sure the fuel fill door opens properly.

Fastener Locations

► : Screw, 2

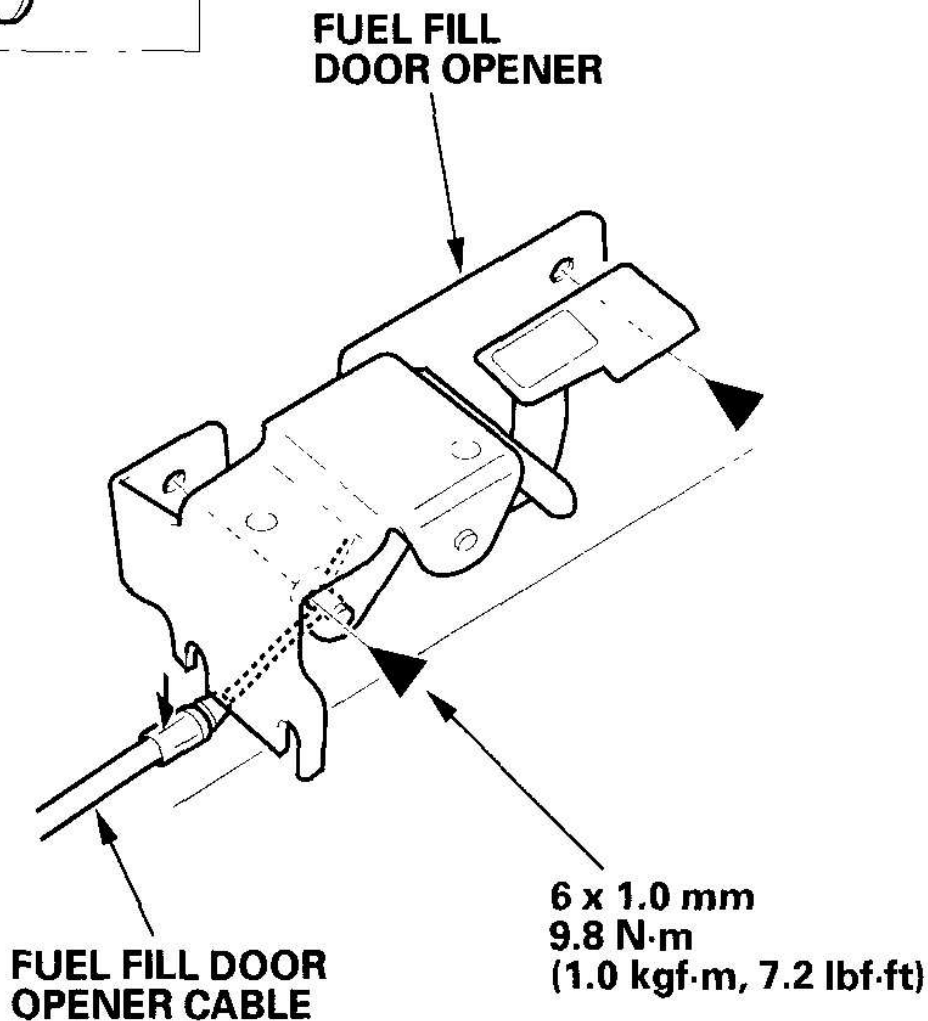
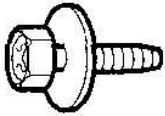

G03682641

Fig. 6: Removing Fuel Fill Door Opener And Torque Specifications
Courtesy of AMERICAN HONDA MOTOR CO., INC.

NOTE:

- **Take care not to scratch the hatch.**
- **Put on gloves to protect your hands.**

1. Remove the hatch trim panel (see **TRIM REMOVAL/INSTALLATION - HATCH AREA**).
2. Remove the hatch opener switch as shown.
3. Install the hatch opener switch in the reverse order of removal, and note these items:
 - Make sure the connector is plugged in properly.
 - Make sure the hatch opens properly.

Fastener Locations

► : Bolt, 2

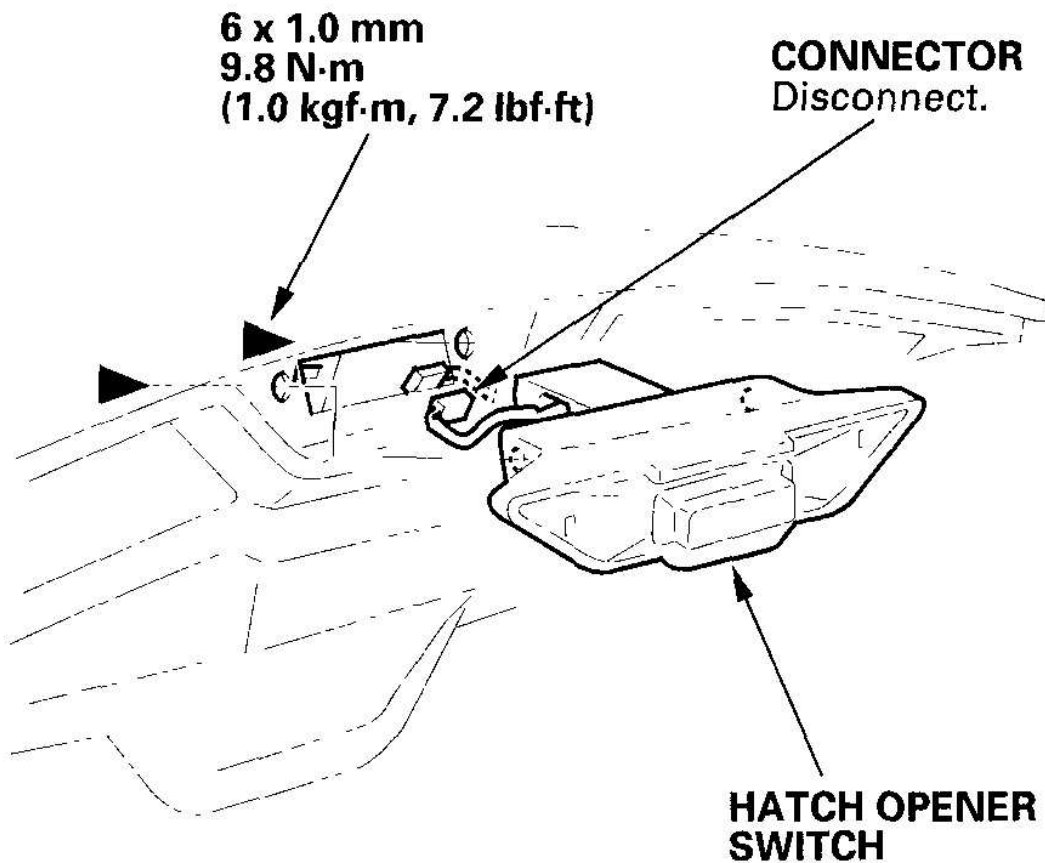
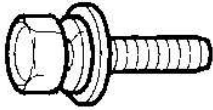

G03682642

Fig. 7: Removing Hatch Trim Panel And Torque Specifications
Courtesy of AMERICAN HONDA MOTOR CO., INC.

HATCH LATCH AND HATCH OPENER ACTUATOR REPLACEMENT

NOTE:

- **Put on gloves to protect your hands.**
- **Take care not to scratch the body.**
- **Take care not to bend the cylinder rod.**

1. Remove the rear trim panel and cargo box (see **TRIM REMOVAL/INSTALLATION - CARGO AREA**).
2. Remove the hatch latch and hatch opener actuator as shown.
3. Install the hatch latch and hatch opener actuator in the reverse order of removal, and note these items:
 - Make sure the connectors are plugged in properly and the cylinder rod is connected properly.
 - Make sure the hatch opens properly and locks securely.

2006 Honda Insight

2000-06 ACCESSORIES & EQUIPMENT Openers - Insight

Fastener Locations

A ► : Bolt, 4 B ► : Screw, 3

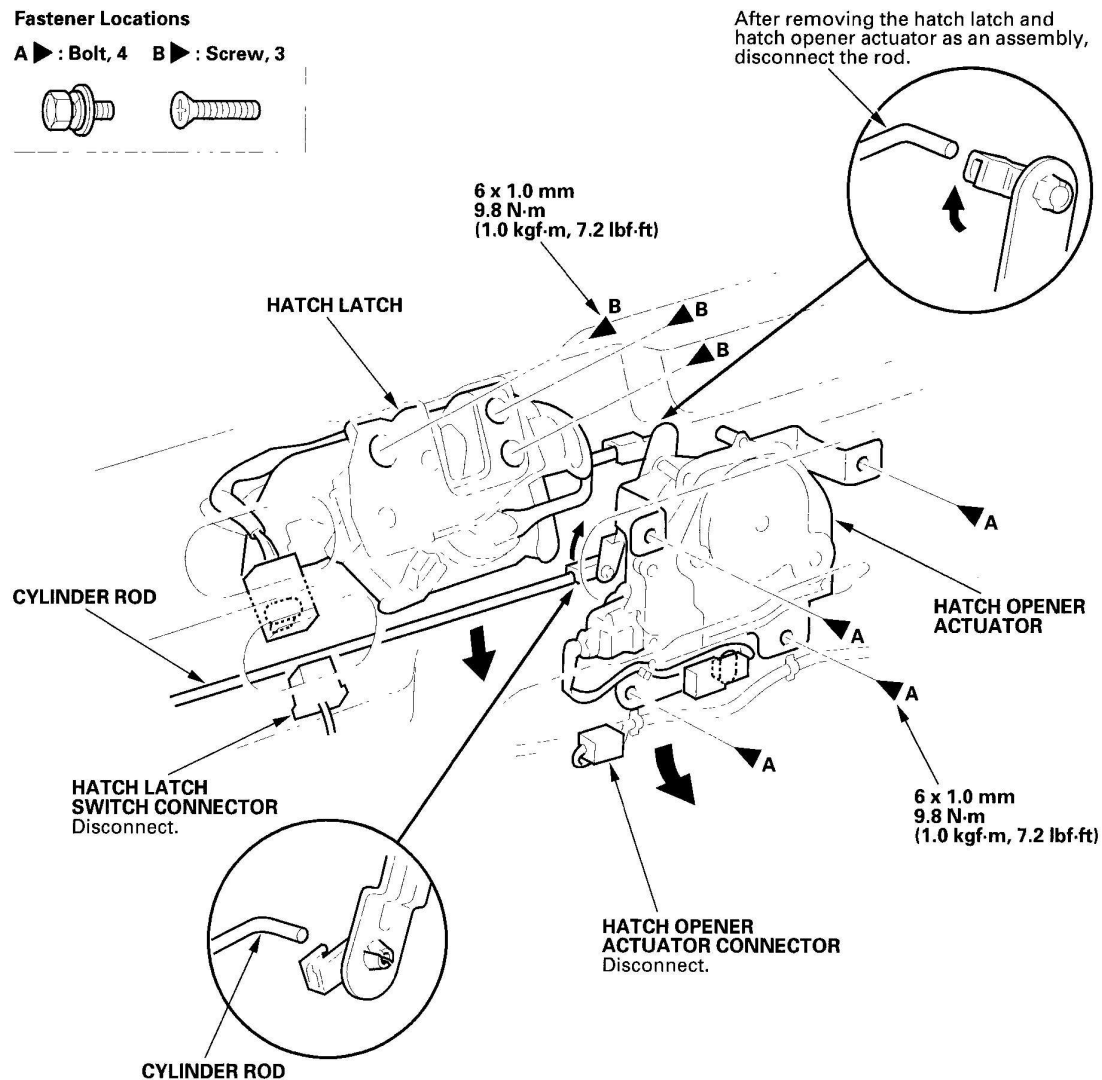

G03682643

Fig. 8: Removing Rear Trim Panel And Cargo Box With Specified Torques

Courtesy of AMERICAN HONDA MOTOR CO., INC.

HATCH LOCK CYLINDER REPLACEMENT

NOTE:

- Take care not to scratch the body.
- Take care not to bend the cylinder rod.

1. Remove the right side of the rear trim panel (see **TRIM**

REMOVAL/INSTALLATION - CARGO AREA).

2. Remove the hatch lock cylinder as shown.
3. Install the hatch lock cylinder in the reverse order of removal, and note these items:
 - Make sure the cylinder switch connector is plugged in properly and the cylinder rod is connected properly.
 - Make sure the hatch opens properly and locks securely.

Fastener Locations

A ► : Bolt, 1 B ► : Screw, 1

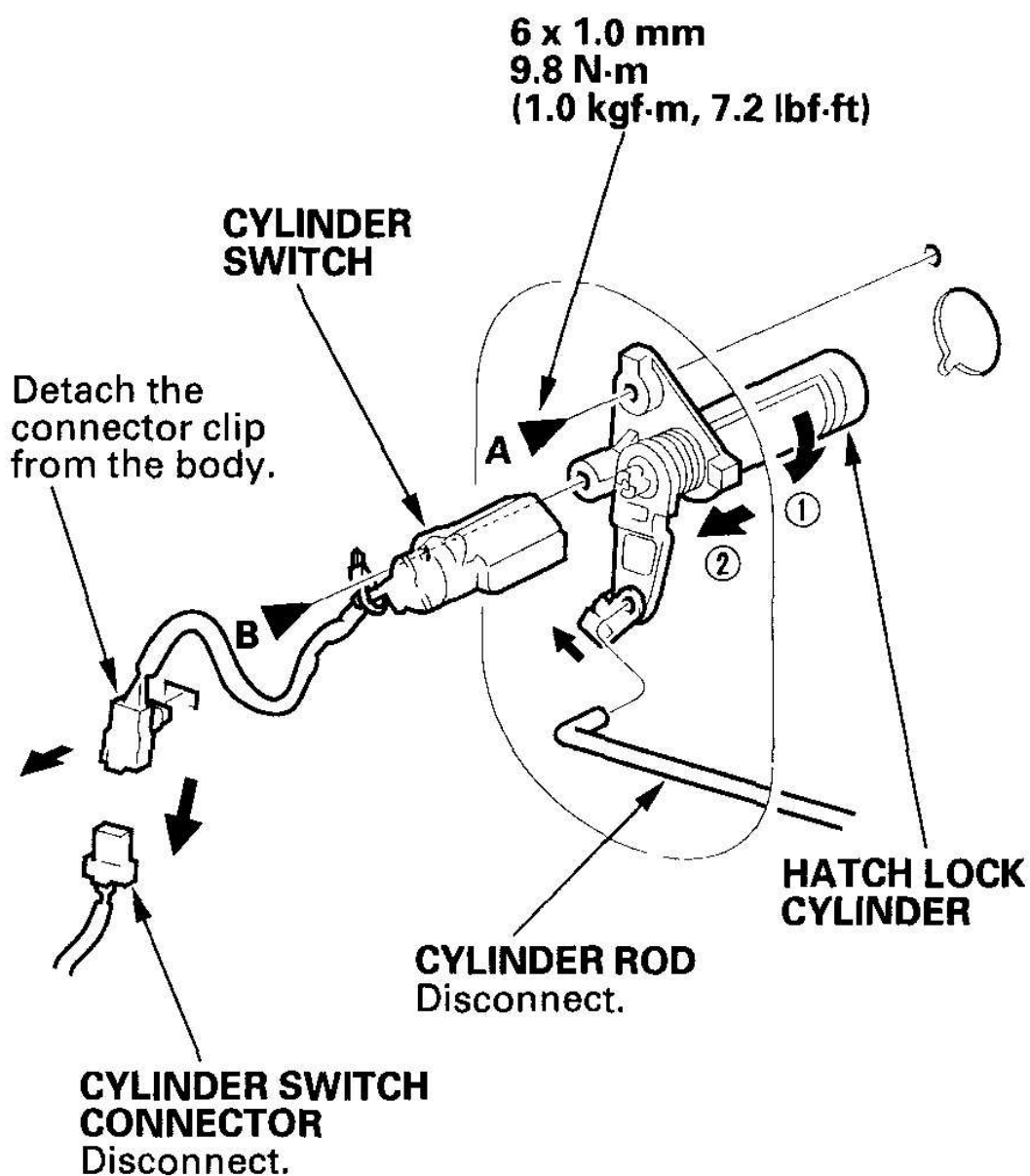

Fig. 9: Removing Hatch Lock Cylinder And Torque Specifications
Courtesy of AMERICAN HONDA MOTOR CO., INC.